

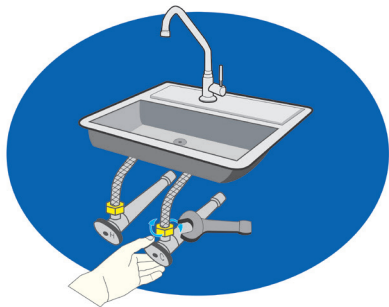

Quick Installation Instructions

Version 1.3, August 2023



1 To ensure your system is ready to install, try to give the top part of the housing a firm clockwise twist, like you are tightening the lid on a jar. It is common for the lid to already be tightened and **not** turn further, this just means your system did not come loose while shipping.

2 Identify the cold water shutoff valve by turning on your faucet's cold water. The shutoff that makes the water stop is the cold water shutoff. The water should remain turned off throughout installation.

3 Slide the plastic ring on included plastic tube so it is 1/2 inch from the brass-reinforced end. Push this end into the cold water shutoff valve. While securing the valve with your hand, tighten the the nut as tight as you can get it with your fingers, plus an additional 270-360 degree rotation with an adjustable wrench. **NOTE: When properly tightened, the plastic ring & brass nut should compress the plastic tubing sufficiently to not allow slippage or removal by hand. It is important to ensure that this is securely connected, because water damage can occur in the event of a leak or disconnection.**

4 Place the housing in a location where the plastic tube can reach without crimping. A good place is often on the cabinet sidewall closest to the cold water shutoff valve.

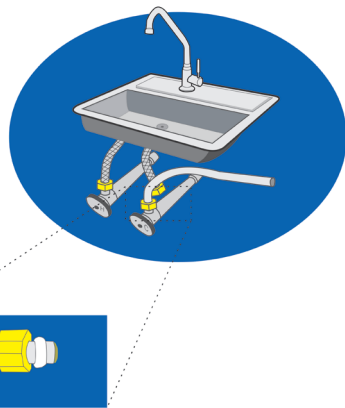

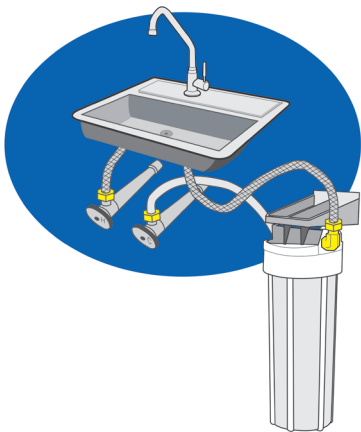

5 Firmly insert the plastic tube into the white fitting until the tube bottoms out. Tug the plastic tube to set the connection.

6 Connect the faucet's cold water line to the brass fitting on filter housing. Tighten the nut as tight as you can get it with your fingers, plus an additional 180-270 degree rotation with an adjustable wrench.

7 Restore the cold water flow by turning the cold water valve counter-clockwise. When the water is turned on the first time, it is normal to hear a "whooshing" noise.

8 Allow the system to flush for 3 minutes to properly flush the cartridge. For the first day or so, the water may appear cloudy as tiny air bubbles are pushed out of the cartridge. The water is perfectly safe to drink!

Use & Care

Change your filter every 6 months or at 600 gallons, whichever comes first. Replacement Elements can be purchased at www.hydroviv.com/rene.

Never run hot water through the filter as this may damage the filter.

A mild soap and soft cloth may be used to clean the housing.

It is normal for the flow rate to rise over the first week as the filter “breaks in.”

Check the system periodically for leaks at the connection points. We also recommend using a leak detector to be on the safe side.

For any additional replacement parts or service questions, chat with us at hydroviv.com or email us at hello@hydroviv.com.



HYDROVIV