

HeliumX[®] for Bass

User Manual

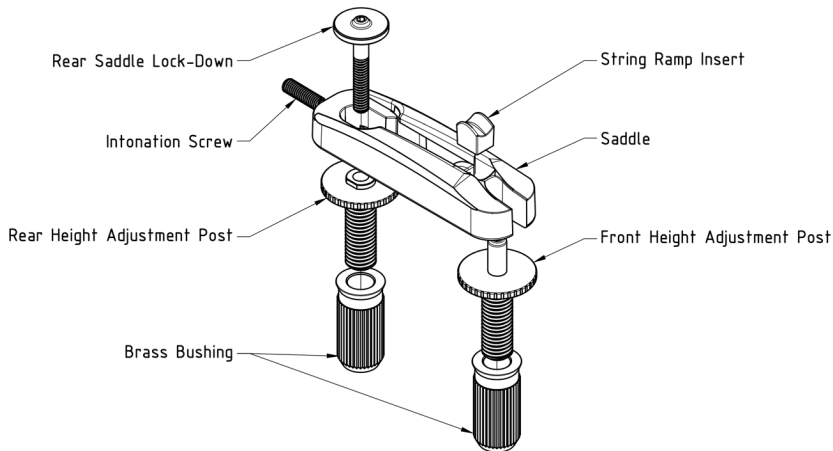

A. Adjusting String Height and Intonation

Step 1

Loosen string to relieve tension on the Saddle.

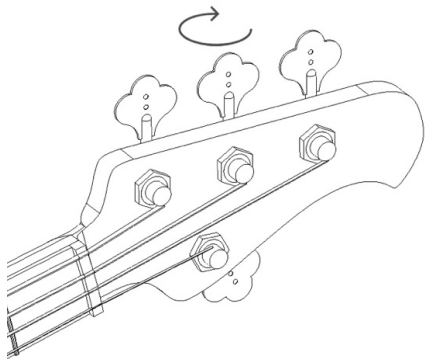

Step 2

Unscrew Rear Saddle Lock-Down half a turn.

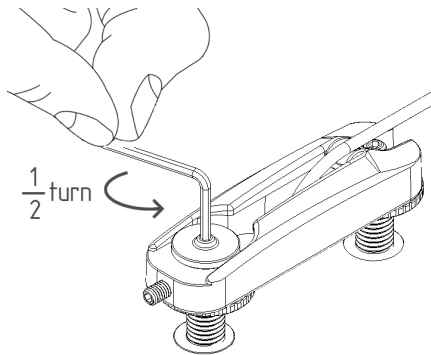

Step 3: Intonation Adjustment

Adjust Intonation Screw, moving Saddle forward/backward to adjust intonation.

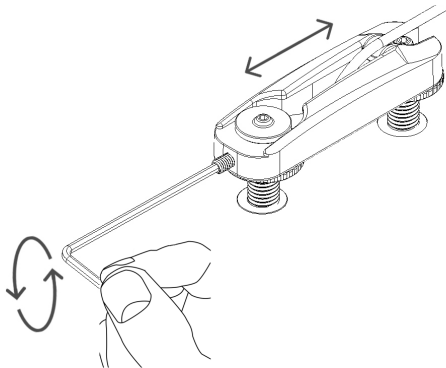

Step 4: Setting The String Height

Raise or lower the Front Height Adjustment Post to make adjustments to string height.

IMPORTANT!

Do not adjust up or down more than 2 mm (.08"). For adjustments greater than this, please remove the Saddle first (see **B. Removing the Saddle**).

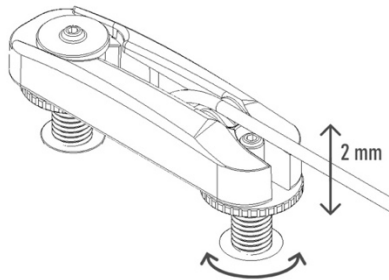

Step 5

Tighten the Rear Saddle Lock-Down so it secures the Saddle.

Do not over-tighten as this can lead to damage to the Saddle and/or the post.

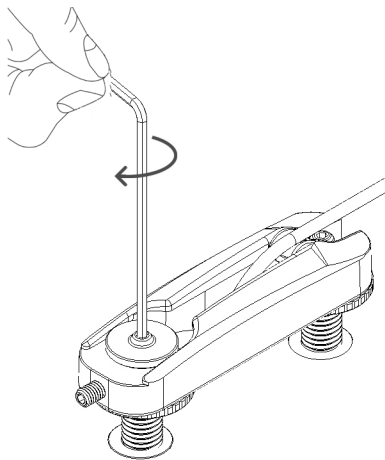

Step 6

Install the string into the machine head, making sure the string is lying on the String Ramp Insert. Tune the string to pitch.

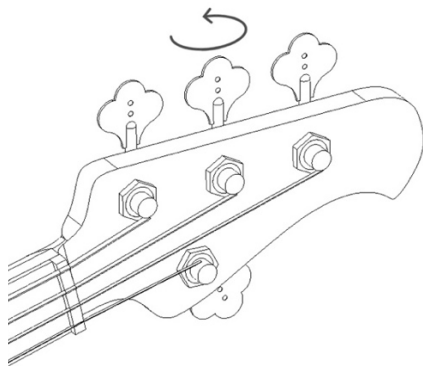

B. Removing the Saddle

Step 1

Loosen string to relieve tension on the Saddle.

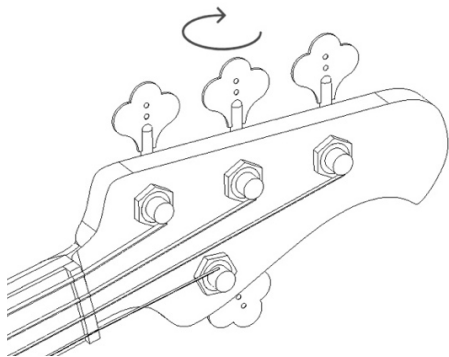

Step 2

Unscrew and remove Rear Saddle Lock-Down.

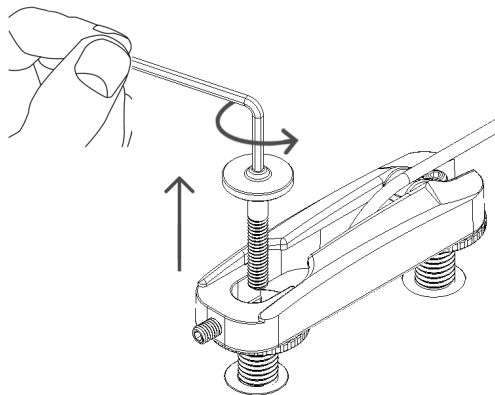

Step 3

Lift Saddle off the Front and Rear Posts. Proceed to adjust height of posts. Post heights should be even at desired height.

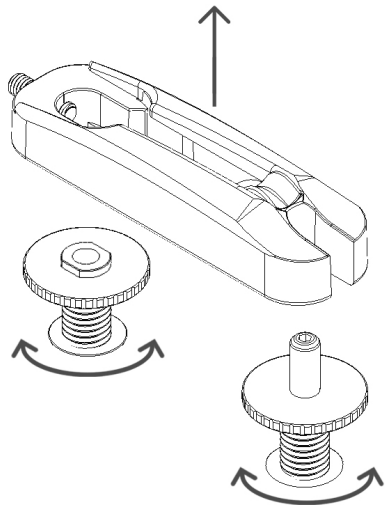

C. Installing the Saddle

Step 1

Ensure proper alignment of Rear Post in relation to the Saddle slot.

Rear Post should lock into the Saddle slot and not rotate.

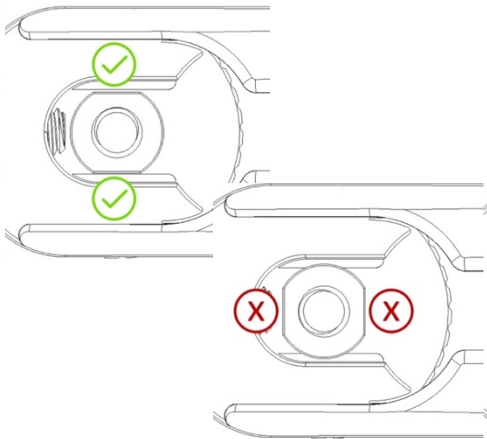

Step 2

Place the Saddle onto the posts, with the Intonation Screw closest to the Rear Post.

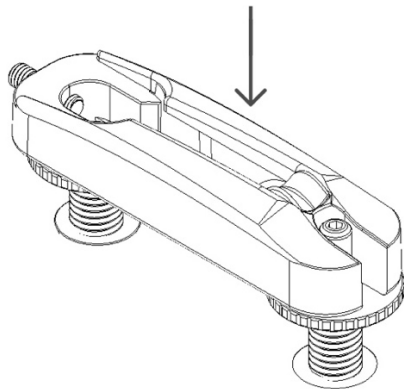

Step 3

Install the string.

Top-loading String Mount:

For a top-mounted string installation, feed the Rear Saddle Lock-Down through the ball end of the string.

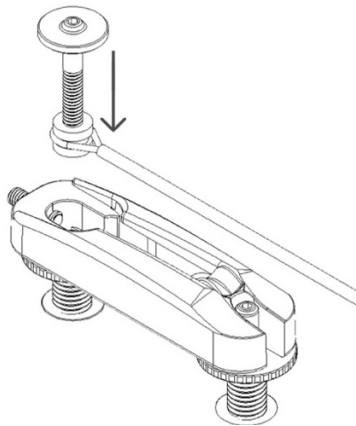

Through-body String Mount:

For a through-mounted string installation, feed string through the body of the instrument and up through the slot of the Saddle, allowing string to rest on the String Ramp Insert.

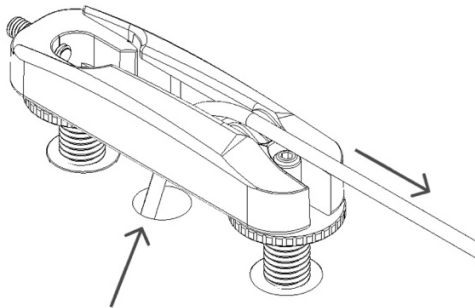

Step 4

Screw down the Rear Saddle Lock-Down.

If needed, slightly loosen Intonation Screw or slide Saddle back, so the ball end does not catch on the screw if string is top-mounted.

Ensure the Rear Height Adjustment Post is aligned correctly with the Saddle slot and does not rotate.

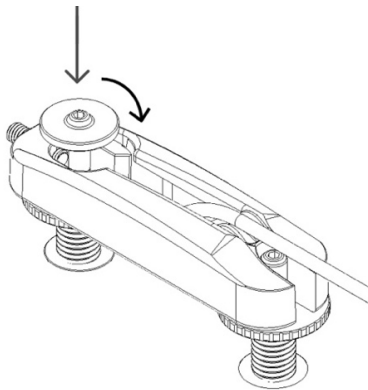

Step 5

Install the string into the machine head, making sure the string is lying on the String Ramp Insert. Tune the string to pitch.

