

TESLONG

Articulating Borescope

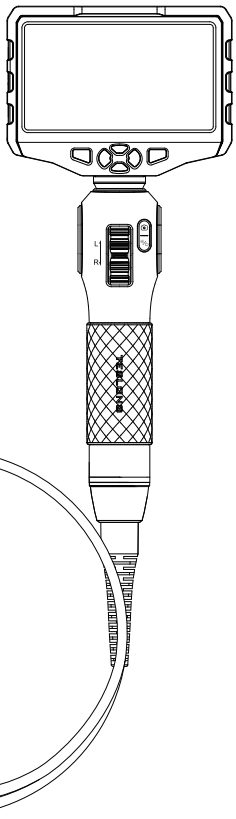

Model No.: TD500

The Teslong TD500 articulating Borescope is an exciting add-ition to Teslong's product line for do-it-yourself mechanics and experienced professionals. This borescope is particularly adept at inspecting narrow spaces with bends and turns, such as car engines, combustion chambers, and exhaust manifolds.

This endoscope is an important product for the car aftermarket. It has a unique temperature protection function and is equipped with a two-way 180°steering detection function, which allows users to take small probes into a small space, and then transmit vivid, clear and all-round video and pictures to the mobile phone through the cable and shown on the screen.

⚠ Warning: Please read this manual carefully before using this product, and follow the instructions to avoid the damage caused by improper use.

Product Appearance

1. Display Screen
2. OK
3. Power Button
4. Down Key
5. Rotate Wheel
6. Up Key
7. Set UP
8. Mode
9. Photo/video
10. LEDS
11. Speaker
12. TF Memory Card
13. Micro Charging Port
14. Reset
15. Snake Tube
16. Camera

No. Name

1	Display Screen
2	OK
3	Power Button
4	Down Key
5	Rotate Wheel
6	Up Key
7	Set UP
8	Mode
9	Photo/video
10	LEDS
11	Speaker
12	TF Memory Card
13	Micro Charging Port
14	Reset
15	Snake Tube
16	Camera

Note: The probe temperature of this product can not exceed 70 °C and is not waterproof.

Icon State

a. Photo/video:

Photo Mode

Photo Mode

b. TF card:

No TF Card

With TF Card

b. WIFI:

Connected

Not Connected

Do Not Show Disconnect WIFI

d. Battery:

Power 25%

Power 50%

Power 75%

Full Battery

Charged Up Immediately

Charging

Operation Guide

ⓐ Power On/Off:
Long Press the monitor 2 sec to power on, the handle and monitor will display green light, Long press 2 sec to power off.

ⓑ LED Adjustment:
Power on, LED shows brightness (three levels). Press the button once to toggle through three levels of brightness, the fourth press will turn the LED off.

MODE				
Mode 1	Taking Pic	Amplification	Image Reversal	·WIFI Switch ·(Refer to the 3 page)
Mode 2	Stop or Finish Video	Amplification	Image Reversal	·Resolution ·Date Stamp
Mode 3	Play or Pause After Selecting Video	Page up and down	Page up and down	·Delete ·Protection ·Slideshow

After the date stamp is turned on, when you take a photo or video, the date will be displayed in the lower right corner of the photo or video.

In the photo or video mode, press the monitor twice to access the following setting:
Automatic shutdown: you can choose "Off", "3 minutes", "5 minutes", or "10 minutes", Automatic shutdown occurs after the minutes you choose unless you choose "Off" and the feature is disabled.

Language setting:
Support "Simplified Chinese", "Traditional Chinese", "Japanese", "English", "Korean", "French", "German", "Russian" and "Spanish", default "Simplified Chinese"

WIFI switch:



Step 1: Search for "Smart Endoscope"

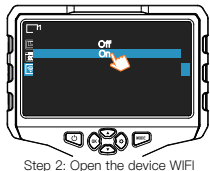

Step 2: Open the device WIFI



Step 3: Connect the WIFI (At this time, the host's WIFI indicator blinks.)

Long press to close the WIFI connection and resume the host operation.



Step 4: ranning the App

Specification

Handle	Camera Diameter	6.2mm	8.5mm
	Snake Tube Length	5ft (1.55m)	5ft (1.55m)
	Snake Tube Material	Flexible metal spring hoses	Flexible metal shaped tubes
	FOV	80°	80°
	Depth of Field	15~100mm	15~100mm
	Camera Light Source	6 Bright LED lights	8 Bright LED Lights
	Sensor	1/9" COMS	1/5" COMS
	Rotation Angle	Maximum 210 °	Maximum 210 °
Monitor	Screen Size	5 inch	
	LED Adjustment	Support	
	Power Supply	3000mAh Polymer Lithium Battery	
	Work Time	About 6h	
	WIFI Connection	Support	
	Language	Support 8 Different Languages	
Storage		Standard 32GB-TF Card (Aaximum Support 64GB)	

Application Environment

For professional maintenance and inspection personnel, this portable, articulating endoscope can be used to inspect many locations invisible to the human eye without disassembly or damage. This is the perfect tool to perform precision inspection of engine, automobile, HVAC, plumbing, computers, buildings, electrical and more...

Operating Environment	Snake tube	In The Air: -10°C to 50°C
Input Voltage	Machine	In The Air: -10°C to 50°C
Humidi		DC5V
Protection Class		10% to 90%
		Do Not Operate in The Rain/Do Not Operate in The Liquids

NOTICE

- Please read this manual carefully before using this product, and follow the instructions to avoid the damage caused by improper use.
- Disassembly of this product is forbidden, and the company is not responsible for any loss caused unauthorized disassembly of this product.
 - Do not rub the product against hard objects to avoid scratches, abrasion, or other hardware by damage.
 - Please note that the exposed metal parts of this product are conductive, please avoid exposure to live electrical circuits.
 - Keep this product out of the reach of children.
 - This is not a medical product, it is NOT intended to be used in any animal body.
 - Keep the product clean and avoid direct exposure to oil or corrosive liquids.
 - This product is not waterproof, please avoid contact with liquids.
 - Make sure the dial returns to the neutral position before pulling out the coiled tubing. Do not turn the dial violently.
 - Do not twist or pull the articulating probe at the front of the coil.
 - Please handle gently, do not bend the camera probe excessively, the bending limit of the tube is one circle.



Customer Service

Please contact us if you have any questions,
We're glad to hear from you.

- 12-month Limited Warranty
- Lifetime Technical Support
- info@teslong.com | support@teslong.com
- 1-877-899-8809(US)
(Mon-Fri 8:00 AM-5:00 PM PST)

© TESLONG TD500 B0323V2.0
30601-0077-01
Made in China