



5

COLLECTION

The stool specimens for this test must be collected on three separate days. It is preferable, but not necessary, to collect on consecutive days but the final collection must be made within seven days of the first.

DAY 1 COLLECTION		DAY 2 COLLECTION	
Use Contents from DAY 1 Bag		Use Contents from DAY 2 Bag	
Make sure that the patient's name, date of birth and the date of collection are written on the vial.			
Remove the cap from the BLACK top vial and add stool following the instructions on page 4.			
Place the BLACK top vial back into the DAY 1 zip-lock bag.	Place the BLACK top vial back into the DAY 2 zip-lock bag.		
Store bags in refrigerator prior to shipping. Do not freeze.			

DAY 3 COLLECTION

Use Contents from DAY 3 Bag

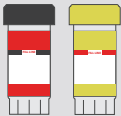
Make sure that the patient's name, date of birth and the date of collection are written on all vials.	
Remove the cap from the WHITE top vial and add stool following the instructions on page 4. This vial does not need to be shaken. Place the WHITE top vial into the separate bag provided and seal. Place the Polar Ice Pack into the pouch on the back of this bag and place in the freezer. Freeze for a minimum of 6 hours.	
Remove the caps from the YELLOW top vial and the BLACK top vial and add stool following the instructions on page 4. Place the YELLOW top vial and the BLACK top vial back into the DAY 3 zip-lock bag. Store bag in refrigerator prior to shipping. Do not freeze.	

6

SHIPPING

PREPARE THE PACKAGE

1. Fill out the Test Requisition:

- ✓ Patient name, date of birth, gender, and date of collection is recorded
- ✓ Payment type is completed and payment included, if required

2. After at least 6 hours, remove bag containing WHITE top vial from the freezer. Place the Specimen bag along with the Polar Ice Pack into the kit box.

3. Place DAY 1, DAY 2 and DAY 3 collection bags into the kit box. Place any unused vials (in collection bags) in the box. Place the Test Requisition into the kit box and close.

4. Open up the FedEx plastic Clinical Pak and affix the provided Prepaid label onto the bag in the designated location. Record the tracking number printed on the label if you want to track this delivery.

5. Place the cardboard box inside the Clinical Pak and seal to securely close.

Please ship as soon as possible. If you cannot ship the specimen on the day of collection, store the White top vial in the freezer and the other vials in the refrigerator until ready to ship.

SCHEDULE A PICK-UP (USA ONLY)

To schedule a pickup, call FedEx toll-free at 1-800-463-3339 (1-800-GO FEDEX). When you hear the automated greeting, say "Schedule a pick up." The next prompt asks if the shipment is more than 150lbs, say "No." At the next prompt, say "Schedule a Pick up with a Label or Stamp." Reply "YES" when asked if the word "Stamp" is written on the waybill. You will then be asked for your address information. **DO NOT USE A DROP BOX or leave your kit outside (especially in warm temperatures).**

In some cases, Doctor's Data provides prepaid shipping from certain countries outside the United States. If that policy pertains to this collection kit, then country specific shipping materials (including an Air Waybill and instructions) will be included in the kit contents. If there are not any shipping materials included or you choose to use a different courier or level of service than provided, you must make your own shipping arrangements at your own expense.

CSA+P



Comprehensive Stool Analysis
+ Parasitology and GI360™

COLLECTION INSTRUCTIONS
STOOL SPECIMEN

Read all instructions before
collecting specimens.



SCIENCE + INSIGHT

2

KIT CONTENTS

If you are missing kit components, call Doctor's Data at 800.323.2784 for assistance.



Kit Box

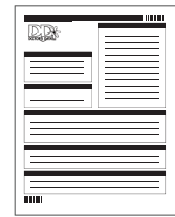

Requisition Form

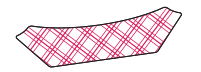

Stool Collection Containers (3)



FedEx Return Label/Stamp (USA Only)



FedEx Clinical Pak (USA only)



Ice Pack (place in freezer immediately)

DAY 1 BAG

*BLACK top vial

Glove
Absorbent material

DAY 2 BAG

*BLACK top vial

Glove
Absorbent material

DAY 3 BAG

*BLACK top vial

*YELLOW top vial

Glove
Absorbent material

+ SEPARATE DAY 3 BAG

**WHITE top vial

Absorbent material

*contains preservative. See page 4
**does not contain preservative

3

IMPORTANT PREP INFO

BEFORE YOU START: Please read all of the instructions carefully before beginning. Consult your physician for specific instructions and before stopping any medications.

DISCONTINUE THE FOLLOWING	
2 weeks before test	Antibiotics, antiparasitics, antifungals, or probiotic supplements, proton pump inhibitors (PPIs) and Bismuth
2 days before test	Aspirin and other NSAIDs, digestive enzymes, laxatives (particularly mineral oil, castor oil, and glycerin enemas/suppositories), activated charcoal, betaine HCl, antacids or bentonite clay

OTHER INFORMATION		
Do not collect samples when there is active bleeding from hemorrhoids or menstruation	Wait at least 4 weeks from a colonoscopy or barium enema before collecting	Do not contaminate the stool with urine or water

WHICH BAG CONTENTS TO USE			
	DAY 1 BAG	DAY 2 BAG	DAY 3 BAG
Collect Stool on 3 Separate Days	1st collection	2nd collection	3rd collection
Collect Stool on 2 Separate Days	X	1st collection	2nd collection
Collect Stool on 1 day	X	X	only collection

4

COLLECTION

HOW TO COLLECT YOUR STOOL SAMPLE

Write the Patient's Name, Date of Birth and the Date Collected on each Specimen Vial. Make sure to use the correct vials for each day of collection. See Page 5 for more details.

1. Put on glove and collect stool into the paper collection container supplied. If possible, void urine prior to collecting stool to avoid mixing it with the stool sample.

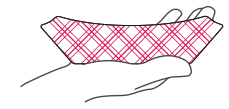

2. Remove the cap from the vial and using the attached spoon transfer stool specimen into the vial. Take multiple portions from different areas of the collection container.

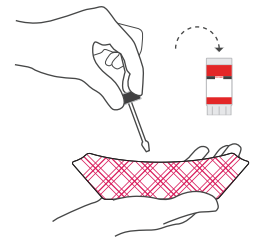

3. Add enough stool until it reaches the **fill line**. **DO NOT OVERFILL**. Screw the cap on tightly.

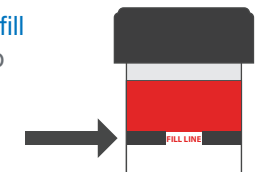

4. BLACK and YELLOW vial only: Shake the vial vigorously for approximately 30 seconds to mix stool with preservative. WHITE vial does not contain preservative, and does not need to be shaken.

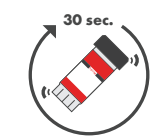

The BLACK and YELLOW top vials are filled to the middle of the vial with liquid preservative. If the liquid levels fall below the middle of the vial or there is evidence of leakage, call Customer Service for assistance. **Caution:** avoid contact of the skin and eyes with the fluid in vials. If you get fluid in your eyes, flush with water for 15 minutes. If your skin comes in contact with vial fluid, wash with soap and water. If ingested, please contact a physician.