

# Recovery Mounts

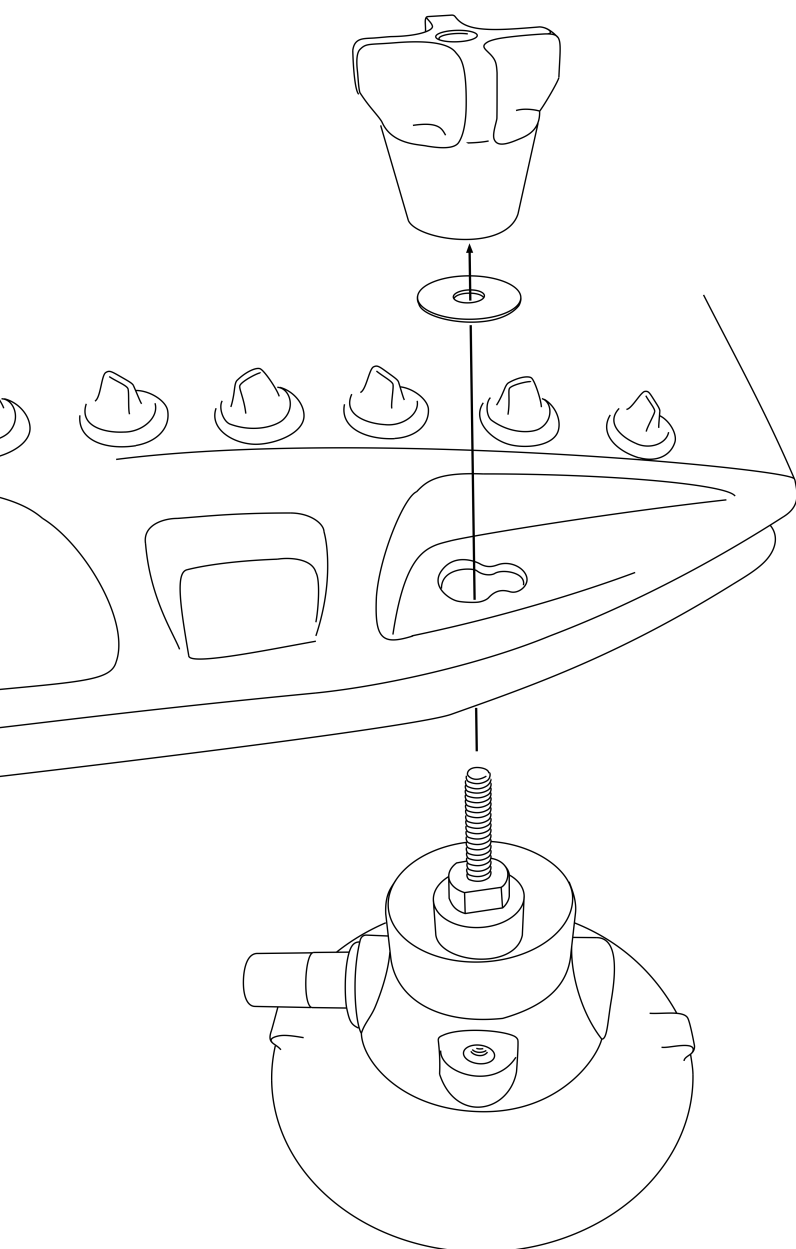

## Attaching Your Recovery Boards or Jack

SeaSucker Recovery Mounts are designed to secure a set of recovery boards or a recovery jack to your vehicle. For recovery boards, push the threaded post on top of the Recovery Mounts through the mounting holes on your recovery board, put the washer on, and then spin on the locking knob to secure the load. Turn the locking knob clockwise to tighten. Repeat the process for the remaining two Recovery Mounts. A typical attachment is pictured in the diagram to the left. For a jack, push the threaded knob through a hole on the jack's bar and secure as noted above. Repeat for the remaining two Recovery Mounts. Where possible, attach the Recovery Mounts so the the pump will be facing toward the rear of the vehicle when mounted.

## Suggested Mounting Locations

Recovery Mounts are designed to attach to a vehicle's side panels or other smooth, rigid surface.

- **DO NOT** attach your Recovery Mounts on the front windshield or hood in a position that interferes with the driver's visibility.
- **DO NOT** attach your Recovery Mounts over decals or on a wrapped vehicle.

**Each vacuum mount should attach to a clean, unobstructed metal, glass, fiberglass, or carbon fiber surface. The vacuum mounts will not attach over a seam or other surface incongruity.**

Please review the Important Warnings on the last page of these instructions.

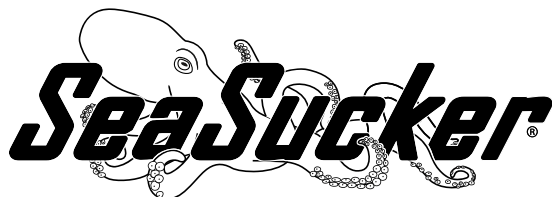

Designed and manufactured by:

**SeaSucker, LLC**  
 Bradenton, Florida  
[www.SeaSucker.com](http://www.SeaSucker.com)

### Attaching Your Recovery Mounts: Clean and Pump

Clean the surface you're going to mount the Recovery Mounts to. Dust and dirt will affect the vacuum mount's ability to create and hold vacuum. Remove the protective cover from each SeaSucker and inspect the rubber vacuum pad for damage or dirt. Do not use a vacuum mount with any visible damage to the vacuum pad. If the vacuum pad is dirty, clean it with a mild soap and water solution and a soft cloth or sponge.

It may help to moisten the bottom edge of each vacuum pad with water - do not use cleaners, lubricants or other liquids.

Press the vacuum mount against the mounting surface to make a full seal; you may need to press firmly down on the Recovery Mount to ensure that the vacuum pad is fully connecting with the mounting surface when pumping.

Pump each SeaSucker repeatedly until the plunger doesn't spring back and the indicator band is hidden inside the pump cylinder. If the plunger won't stay seated in the pump cylinder or continues to extend out immediately after pumping, you may need to clean the mounting surface or the vacuum pad or pump, perform basic maintenance on the vacuum pad or pump, or move to a more suitable mounting position. Do not use your Recovery Mounts without correcting the problem!

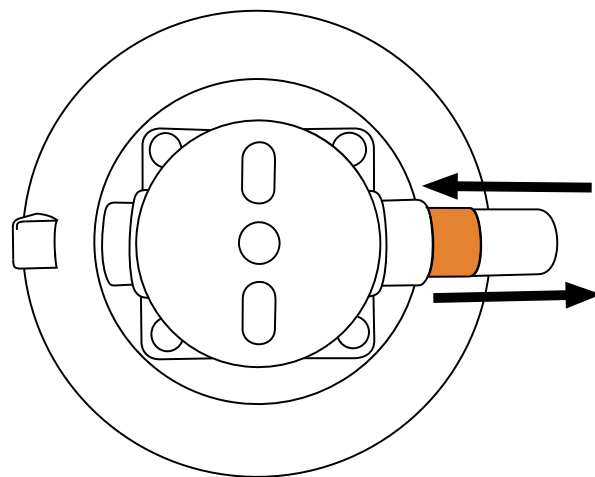

### Removing Your Recovery Mounts: Lift and Cover

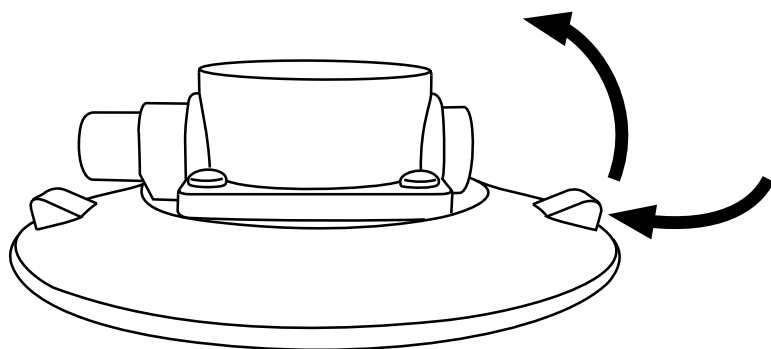

With your fingertip, use one of the tabs on the SeaSucker's vacuum pad to lift the edge of the pad up from the mounting surface and break the vacuum seal.

Always put the protective covers back on when the Recovery Mounts are not attached to your car to protect the vacuum pad's rubber. Make sure the pad is fully seated in the protective cover before storing it. The edge of the vacuum pad could be damaged or deformed if the vacuum pad isn't fully seated in the protective cover.

### Check for the Indicator Band During Use

SeaSucker vacuum mounts are not intended to be permanent fixtures on your car - they will lose vacuum over time. When your vacuum mount loses vacuum, it will warn you by extending the pump's plunger, exposing an orange band. You are required to monitor your vacuum mounts during use. When getting in or out of your car, check to see if the indicator band is visible on any of the vacuum mounts. If you see the band, simply pump the SeaSucker as described above.

If the indicator band appears less than four hours after being pumped to full strength, either cleaning, maintenance or repositioning may be required. Refer to the Troubleshooting Guide at the end of these instructions. If your Recovery Mounts are mounted on a scratched surface, move them to a more suitable position. If the mounting surface or vacuum mount is dirty, clean it. If these steps don't stop the vacuum mount from losing vacuum prematurely, discontinue use until the problem is resolved. Replace the pump on the suspect vacuum mount with the spare that came with your Recovery Mounts if necessary - additional replacement parts can be purchased in the Replacement Parts section of our on-line store.

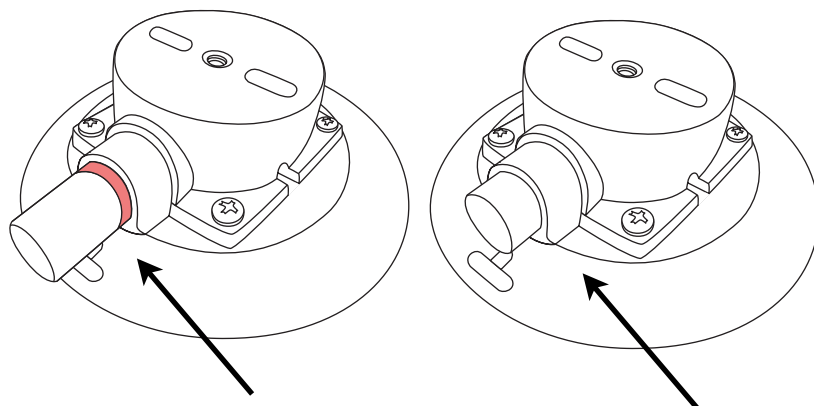

**Indicator band exposed:  
time  
to re-pump!**

**Full power!**

### **Weather Conditions**

SeaSucker products can be used in cold weather. The vacuum pads will stiffen in colder temperatures. Because the vacuum pads need to conform to the mounting surface when you attach them, it is highly recommended that you store your Recovery Mounts at room temperature (60°F+) prior to use. You will not be able to properly attach the vacuum mounts if they are too cold. Mounting surfaces must be free of ice, snow, dirt and any else that might prevent the vacuum pad from making a full seal. In freezing temperatures, we recommend not moistening the edge of your vacuum pads with water as discussed in “Attaching Your Recovery Mounts” above.

Rain and wet weather should not affect the performance of your SeaSucker vacuum mounts. If rain or water gets inside any of your vacuum pumps, pull the plunger out and dry the inside of the pump cylinder with a clean paper towel. Re-lube the plunger seal if necessary and reinsert the plunger in the pump cylinder. Screws or other metal parts that show signs of rusting or corrosion should be replaced.

### **Care and Maintenance**

To get the most out of your Recovery Mounts, inspect them regularly and store them with the vacuum mounts’ protective covers on. Check that all screws are securely tightened, including the screws attaching the vacuum pads to the SeaSucker housing and the screws attaching the SeaSuckers to the mounting deck.

Clean the vacuum pads before each use with a sponge or soft cloth, mild dish soap and water. Do not use harsh solvents or abrasive cleaning pads. Inspect the sealing edge for stiffness, cracks, roughness, or cuts. A damaged vacuum pad should be replaced.

The vacuum pump should be cleaned regularly. Pull the plunger straight out of the pump cylinder. Clean the inside of the cylinder with dish soap and a soft cloth or paper towel. Dry the inside of the cylinder – water left in the cylinder may interfere with the check-valve function of the pump.

The plunger should be wiped clean and the black rubber seal at the tip of the plunger should be re-lubed with a thin layer of silicone-based gel lubricant, such as the Lube Tube that came with your Recovery Mounts. After cleaning, push the plunger back into the cylinder and pump it several times to seat it properly and distribute the lubricant.

One replacement SeaSucker vacuum pump comes with your Recovery Mounts. Additional replacement SeaSuckers, vacuum pads, vacuum pumps, and additional tubes of Lube Tube can be purchased on-line at [www.seasucker.com](http://www.seasucker.com) in the Replacement Parts section of our on-line store.

**Lube Tube is for vacuum pump maintenance only -  
DO NOT apply lube to the vacuum pad.**

### **Warranty**

SeaSucker offers a lifetime, non-transferable warranty to the original purchaser covering defects in materials and workmanship. Defective products can be returned to SeaSucker for replacement or repair (at SeaSucker’s option). Warranty claims must be accompanied by a sales receipt or other proof of purchase document. The cost of transportation to and from SeaSucker for the repair or replacement of any defective part or accessory is not covered by this warranty and is to be paid by the owner.

This warranty does not apply to damage or failure resulting from routine wear and tear expected in the normal use of this product, or to lack of maintenance, user error, alteration or modification of the product, accidents, misuse, abuse, or neglect.

This warranty is given in lieu of all other written or oral warranties, express or implied, including without limitation implied warranties of merchantability and fitness for a particular purpose, and are limited to the duration and specifications of this warranty.

Purchaser’s exclusive remedy under this warranty is the repair or replacement of a defective product or, at SeaSucker’s option, the issuance of a refund or credit for the purchase price of the product. SeaSucker’s liability for any damages relating to any allegedly defective product, whether arising from the use or the inability to use the product and whether claimed under tort, contract or any other legal theory, shall be limited to the actual price paid for such product and shall in no event include loss of use, loss of time, incidental, consequential, special, or indirect damages of any kind, even if SeaSucker is aware of the possibility of such damages, to the full extent as such may be disclaimed by law.

It is the user’s responsibility to ensure that the use of this product is not prohibited by any applicable local or state law.

Warranty claims can be initiated by:

Submitting this form: [https://seasucker.formstack.com/forms/rma\\_request](https://seasucker.formstack.com/forms/rma_request)

Calling this number: 1-941-900-1850

Emailing this address: [info@seasucker.com](mailto:info@seasucker.com)

## Repair and Replacement

Products with non-warrantable damage may still be repaired or replaced at your expense. Discounted replacement parts, including vacuum pads, pumps, fork mounts and hardware, can be found on-line in the Replacement Parts section of SeaSucker's on-line store at [www.seasucker.com](http://www.seasucker.com).

## IMPORTANT WARNINGS

- Do not exceed the posted speed limit.
- Do not use if the indicator band is exposed on any of your SeaSucker's pumps.
- Do not use if all of the vacuum mounts cannot maintain a full vacuum seal for at least 4 hours.
- Clean the mounting surface before attaching.
- Clean SeaSuckers before attaching.
- Clean and lube your SeaSuckers' pumps regularly.
- Inspect screws, nuts, and bolts regularly and retighten if necessary.
- Make sure the vacuum pads are fully seated in the protective covers when not in use.

## Your Responsibilities

You must read and follow the instructions in this user manual. You must attach the Recovery Mounts correctly to your vehicle, check them before each use, and perform any necessary maintenance. The correct attachment of the Recovery Mounts to your vehicle is critical and is in your exclusive control.

You must inspect the indicator bands on all SeaSuckers when entering and exiting your vehicle. A quick glance will tell you if the vacuum mount is at full power. If the indicator band is visible, you must re-pump the SeaSucker before driving your vehicle.

You may need to clean, repair, or replace any of your SeaSucker vacuum mounts that do not hold vacuum for at least 4 hours. Your Recovery Mounts come with an extra SeaSucker vacuum pump; keep it in your vehicle in case you accidentally damage one.

You must obey all posted speed limits and traffic conditions; if there is no posted speed limit, we recommend not driving above 85 miles per hour. You must adapt your driving style and speed to road conditions, weather conditions, and the load on your Recovery Mounts.

### TROUBLESHOOTING GUIDE

Problem	What Might Be Wrong	How To Fix It
Slow Leakage	Dry mounting surface or vacuum pad	Moisten the mounting surface or the vacuum pad
	Nicks or cuts on vacuum pad	Replace the vacuum pad
	Dirt in pump	Clean and re-lube the plunger and pump cylinder
	Dry pump	Re-lube the plunger seal
	Dirt on vacuum pad	Clean the vacuum pad
	Dirty or uneven mounting surface	Clean the mounting surface or move to a more suitable spot
Severe Leakage	Nicks or cuts on vacuum pad	Replace the vacuum pad
	Damaged pump	Replace the vacuum pump
	Dirty or uneven mounting surface	Clean the mounting surface or move to a more suitable spot
Jammed or Sluggish Pump	Dry pump	Re-lube the plunger seal
	Obstructed valve stem	Remove the obstruction; clean and re-lube the pump
	Dirt in pump	Clean and re-lube the plunger and pump cylinder

