

What's in the Box:

Your Pallavicini Ski Rack comes with the following components and accessories:

- (2) Pallavicini Rack carriers
- (4) 6" SeaSucker vacuum mounts
- (1) 5/32 hex key for assembly
- (1) 5g Lube Tube (for vacuum pump maintenance)
- (1) SeaSucker vacuum pump (for replacement/spare)

PALLAVICINI SKI RACK

SK2425
2/23

Assembling your Rack

Your Pallavicini Ski Rack needs minor assembly before use. Push a vacuum mount onto the bottom of one of the carriers so that the carrier sits firmly in the slot on top of the vacuum mount's housing. Make sure that the bolt hole in the vacuum mount's housing is aligned with the hole in the carrier. Push a bolt through the bolt hole (see diagram below to note the difference between the bolt hole and nut hole) and carrier, then thread a nut onto the bolt from the back side. The nut should sit in the nut hole so that when you tighten the bolt, the nut won't spin. Tighten the bolt securely with the supplied hex wrench. Repeat this process for the other side of the carrier, making sure the vacuum mounts are facing in the same direction, then repeat for the other carrier.

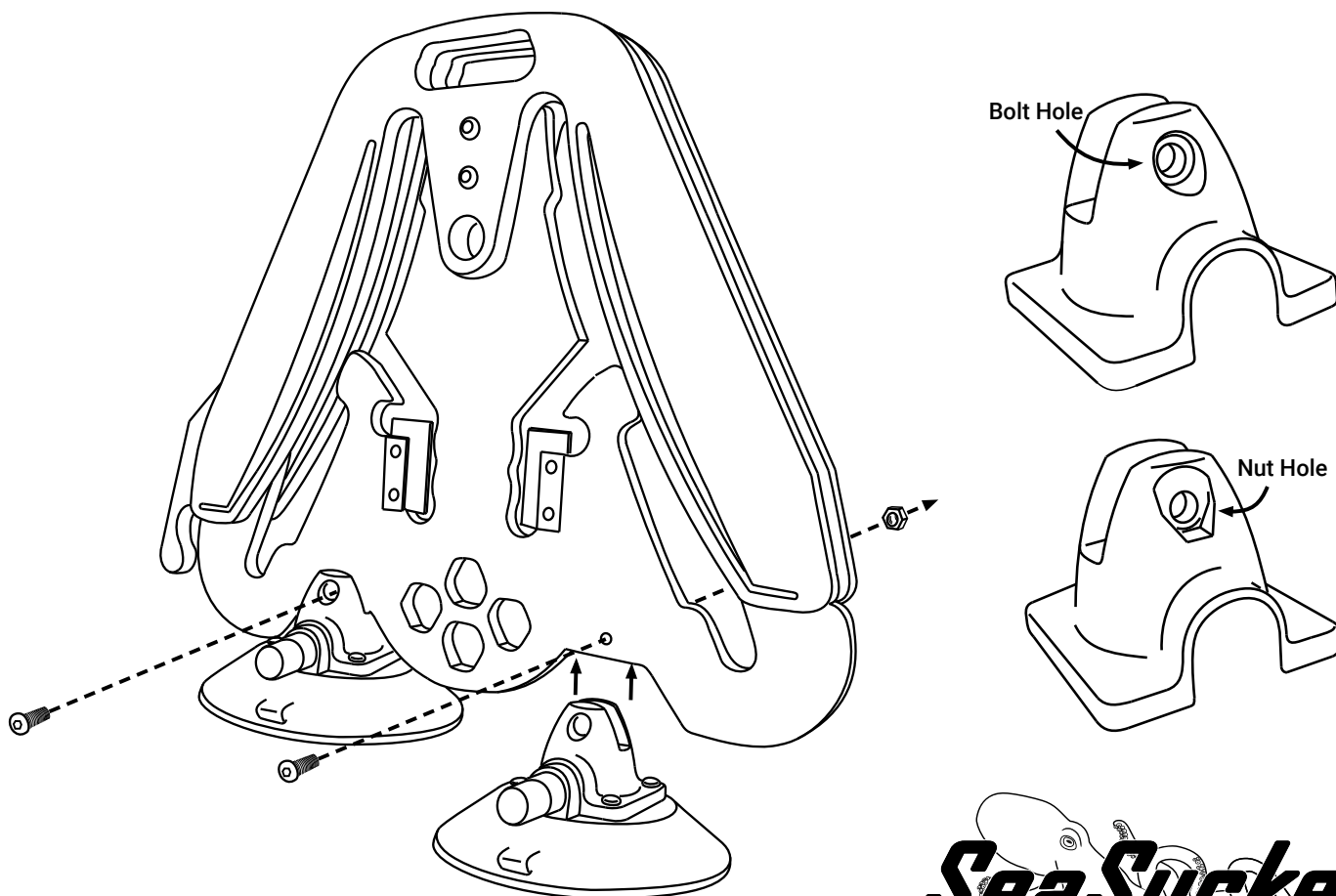

Mounting Your Skis or Snowboards on the Carrier

Separate the top half of each carrier by raising the lever to unlatch. The lever holds the halves together firmly and may take more strength to raise than you may be expecting. Pull the top half using the handhold at the top of the carrier until the two halves are separated. Referring to the diagram below, arrange your skis, poles, or snowboards on the carriers as shown. Replace the top half onto the base of the carrier and push down until you hear/feel it click into place. If the lock holes on each half are not in perfect alignment, you do not have the carrier completely reattached; press the halves together until the lock holes align. If the holes are *close* to alignment, you can finish snapping the top into place using the lever. Push the lever down and back into position to lock the top half of the carrier into place. You should hear/feel the click when the lever is fully engaged.

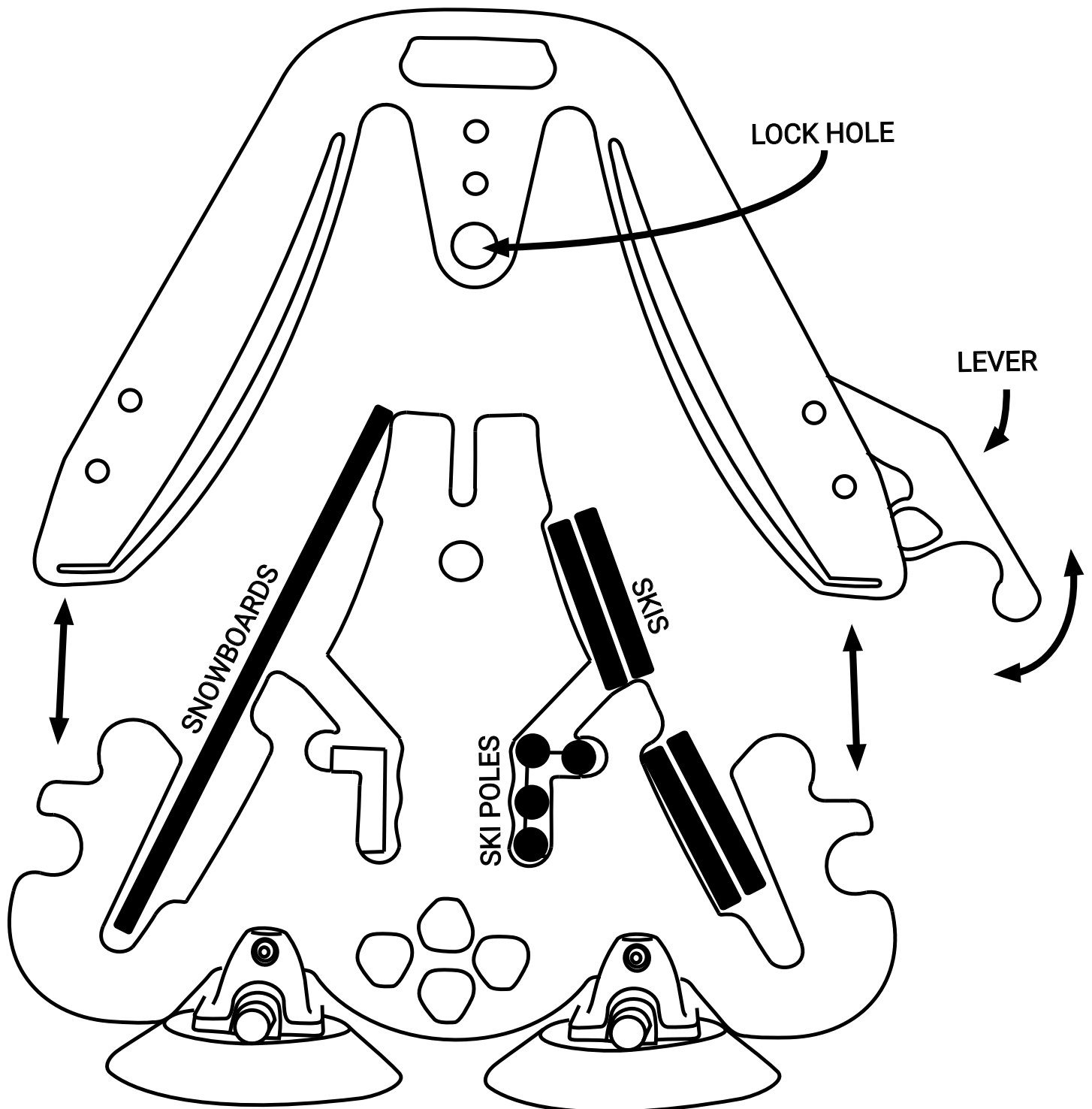

Where to Attach

See the diagrams to the right for suggested placements. If you attach your rack to your car's roof, ideally the vacuum mounts on your rack should be attached where the roof is most solid, such as the corners. The metal of some car roofs may be thin enough in the middle of the roof that the weight of the rack and skis/snowboards can cause non-permanent bowing in the metal. Another recommended mounting position is on the car's trunk or rear deck, with the skis or snowboards extending forward onto the rear windshield or the back part of the roof. The rack can also be mounted on the rear window of an SUV or hatchback so long as the rack and skis/snowboards are positioned low enough to be out of the wind stream when the vehicle is in motion. Please see the mounting position diagrams for a graphic representation of these recommendations.

Each vacuum mount on your SeaSucker rack should attach to clean, unobstructed metal or glass surface. The vacuum mounts will not attach over a seam or other surface incongruity. Attaching your rack to a sunroof is done at your own risk and we strongly recommend that you test the strength and suitability of your sunroof first.

The Pallavicini Ski Rack is designed to carry four sets of skis and poles, or two snowboards. Position the carriers near the bindings to ensure the skis or snowboards remain in the carrier even if there is some slipping or movement during transport.

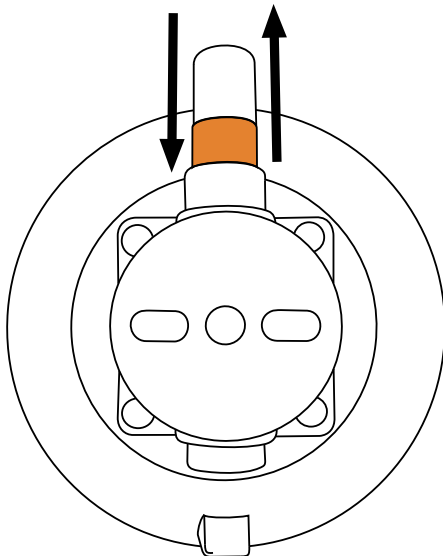
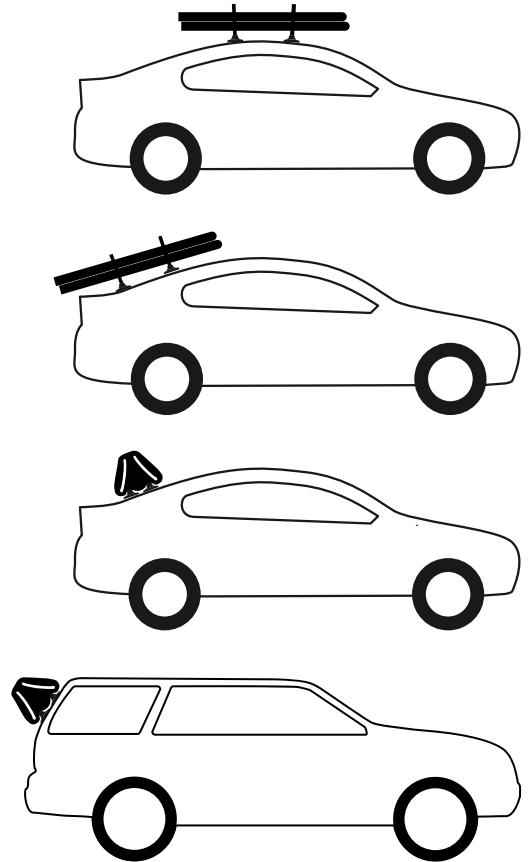

Attaching Your Rack: Clean and Pump!

Clean the surface you're going to mount the rack to. Dust and dirt will affect your vacuum mounts' ability to create and hold vacuum. Remove the protective cover from each SeaSucker and inspect the rubber vacuum pad for damage or dirt. Do not use your rack if there is any visible damage to the vacuum pad. If the vacuum pad is dirty, clean it with a mild soap and water solution and a soft cloth or sponge.

Press the vacuum mount against the mounting surface to make a full seal; you may need to press firmly down on the body of the rack to ensure that the vacuum pad is fully connecting with the mounting surface when pumping. Pump the SeaSucker repeatedly until the plunger does not spring back and the indicator band is hidden inside the pump cylinder. Repeat this for all SeaSuckers on the rack. If the plunger won't stay seated in the pump cylinder or continues to extend out immediately after pumping, you may need to clean the mounting surface or the vacuum pad or pump, perform basic maintenance on the vacuum pad or pump, or move the rack to a more suitable mounting position. Do not use your rack without correcting the problem!

Locking Your Rack

The locking hole noted in the drawing above is made for you to pass a cable lock through. The cable lock will prevent the top half of each carrier from being removed, which protects your skis or snowboards. The cable lock will also prevent someone from detaching the rack and making off with the rack and your skis or snowboards.

Weather Conditions

SeaSuckers can be used in cold weather, but the vacuum pads will stiffen in colder temperatures. If you remove the rack when not in use, the vacuum pads will need to be at approximately room temperature to re-mount (because the rubber vacuum pads need to be supple enough to conform to the mounting surface when you attach them). We recommend that you store your rack at room temperature (60F+) prior to use. You will not be able to properly attach the vacuum mounts if they are too cold. Mounting surfaces must be free of ice, snow, dirt and any other potential obstruction to making a full vacuum seal.

Rain and wet weather should not affect the performance of your SeaSucker rack. If rain or water gets inside any of your vacuum pumps, pull the plunger out and dry the inside of the pump cylinder with a paper towel. Re-lube the plunger's seal if necessary and reinsert the plunger in the pump cylinder. Screws or other metal parts that show signs of rusting or corrosion should be replaced.

Check for the Indicator Band During Use

SeaSucker vacuum mounts are not intended to be permanent fixtures on your car - they *will* lose vacuum over time. When your vacuum mount loses vacuum, it will warn you by extending the pump's plunger, exposing an orange band. You are required to monitor your vacuum mounts during use. When getting in or out of your car, check to see if the indicator band is visible on any of the rack's vacuum mounts. If you see the band, simply pump the SeaSucker as described above.

If the indicator band appears less than six hours after being pumped to full strength,

either cleaning, maintenance or repositioning may be required. If your rack is mounted on a scratched surface, move the rack to a more suitable position. If the mounting surface or vacuum pad is dirty, clean it. If these steps don't stop the vacuum mount from losing vacuum prematurely, discontinue use until the problem is resolved. If necessary - additional replacement parts can be purchased from our on-line store. The Care and Maintenance section of this user guide contains more information, as does SeaSucker's website located at www.seasucker.com.

To Remove Your Rack: Lift and Cover!

Remove skis or snowboards from the rack. With your fingertip, use one of the tabs on the SeaSucker's vacuum pad to lift the edge of each pad up from the mounting surface and break the vacuum seal.

Always put the protective covers back on your vacuum mounts when the rack is not attached to your car to protect the rubber of the vacuum pad from getting nicked or cut and to help the vacuum pad maintain its original shape. Make sure the vacuum pad is fully seated in the protective cover before storing it. The edge of the vacuum pad could be damaged or deformed if the protective cover isn't properly installed. If you lose or damage your protective covers, store your rack so that the vacuum pads do not come into contact with any object or surface.

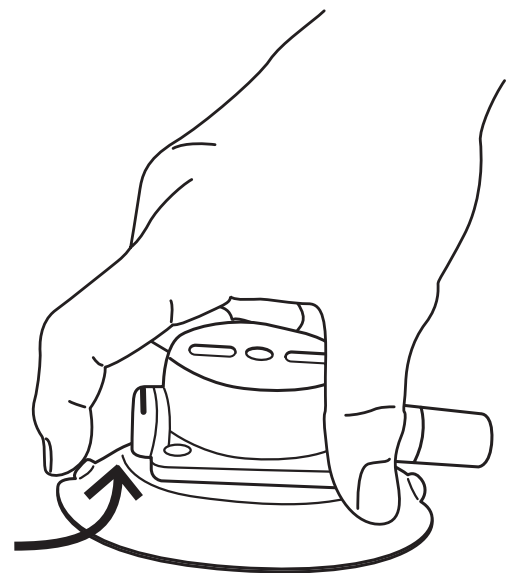
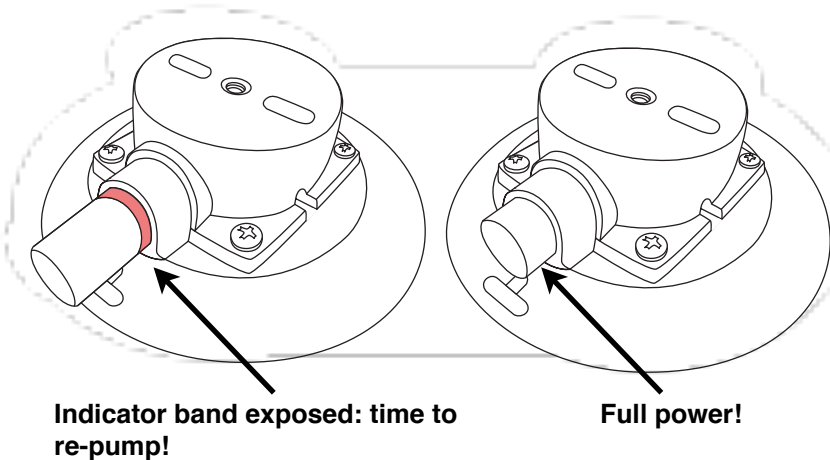

Care and Maintenance

To get the most out of your SeaSucker rack, inspect it regularly and store it with the vacuum mounts' protective covers on. Check that all screws are securely tightened, including the screws attaching the vacuum pads to the SeaSucker housing and the screws attaching the SeaSuckers to the rack ski carriers.

Clean the vacuum pads before each use with a sponge or soft cloth, mild dish soap and water. Do not use harsh solvents or abrasive cleaning pads. Make sure there is no dirt or debris on the sealing edge (the bottom outside edge) of the vacuum pad. Inspect the sealing edge for stiffness, cracks, roughness, or cuts – a cut will allow air to leak under the pad and will prevent your SeaSucker from holding vacuum. A damaged vacuum pad should be replaced.

The vacuum pump should be cleaned regularly. To clean the pump, pull the plunger straight out of the pump cylinder. Clean the inside of the cylinder with dish soap and a soft cloth or paper towel. Make sure to dry out the cylinder – water left in the cylinder can cause the pump to make a popping noise when pumped and may interfere with the check-valve function of the pump.

The plunger should be wiped clean and the black rubber seal at the tip of the plunger should be re-lubricated with a thin layer of silicone-based gel lubricant, such as the Lube Tube that came with your rack. After cleaning, push the plunger back into the cylinder and pump it several times to seat it properly and distribute the lubricant.

One replacement SeaSucker vacuum pump comes with your rack. Additional replacement SeaSuckers, vacuum pads, and vacuum pumps can be purchased on-line at www.seasucker.com in the Replacement Parts section of our on-line store. Additional tubes of Lube Tube can be found on-line in the Replacement Parts section at www.seasucker.com.

Scan this barcode or go to this URL for a video showing recommended cleaning techniques:

<https://youtu.be/KzTsJyWAAzc>



TROUBLESHOOTING GUIDE

Problem	What Might Be Wrong	How To Fix It
Slow Leakage	Dry mounting surface or vacuum pad	Moisten the mounting surface or the vacuum pad
	Nicks or cuts on vacuum pad	Replace the vacuum pad
	Dirt in pump	Clean and re-lube the plunger and pump cylinder
	Dry pump	Re-lube the plunger seal
	Dirt on vacuum pad	Clean the vacuum pad
	Dirty or uneven mounting surface	Clean the mounting surface or move to a more suitable spot
Severe Leakage	Nicks or cuts on vacuum pad	Replace the vacuum pad
	Damaged pump	Replace the vacuum pump
	Dirty or uneven mounting surface	Clean the mounting surface or move to a more suitable spot
Jammed or Sluggish Pump	Dry pump	Re-lube the plunger seal
	Obstructed valve stem	Remove the obstruction; clean and re-lube the pump
	Dirt in pump	Clean and re-lube the plunger and pump cylinder

Warranty

SeaSucker offers a lifetime, non-transferable warranty to the original purchaser covering defects in materials and workmanship. Defective products can be returned to SeaSucker for replacement or repair (at SeaSucker's option). Warranty claims must be accompanied by a sales receipt or other proof of purchase document. The cost of transportation to and from SeaSucker for the repair or replacement of any defective part or accessory is not covered by this warranty and is to be paid by the owner.

This warranty does not apply to damage or failure resulting from routine wear and tear expected in the normal use of this product, or to lack of maintenance, user error, alteration or modification of the product, accidents, misuse, abuse, or neglect.

This warranty is given in lieu of all other written or oral warranties, express or implied, including without limitation implied warranties of merchantability and fitness for a particular purpose, and are limited to the duration and specifications of this warranty.

Purchaser's exclusive remedy under this warranty is the repair or replacement of a defective product or, at SeaSucker's option, the issuance of a refund or credit for the purchase price of the product. SeaSucker's liability for any damages relating to any allegedly defective product, whether arising from the use or the inability to use the product and whether claimed under tort, contract or any other legal theory, shall be limited to the actual price paid for such product and shall in no event include loss of use, loss of time, incidental, consequential, special, or indirect damages of any kind, even if SeaSucker is aware of the possibility of such damages, to the full extent as such may be disclaimed by law.

It is the user's responsibility to ensure that the use of this product is not prohibited by any applicable local or state law.

Repair and Replacement

Products with non-warrantable damage may still be repaired or replaced at your expense. Discounted replacement parts, including vacuum pads and pumps can be found on-line in SeaSucker's on-line store at www.seasucker.com.

IMPORTANT WARNINGS

- Do not exceed the posted speed limit.
- Do not use if the indicator band is exposed on any of your SeaSucker's pumps.
- Do not use if all of the rack's mounts cannot maintain a full vacuum seal for at least 4 hours.
- Clean the mounting surface before attaching.
- Clean SeaSuckers before attaching.
- Clean and lube your SeaSuckers' pumps regularly.
- Inspect screws, nuts, and bolts regularly and retighten if necessary.
- Make sure the vacuum pads are fully seated in the protective covers when not in use.

Your Responsibilities

You must read and follow the instructions in this user manual. You must attach the rack correctly to your vehicle, check it before each use, and perform any necessary maintenance. The correct attachment of the rack to your vehicle is critical and is in your exclusive control.

You must attach your skis and snowboards correctly to the rack. The correct attachment of skis and snowboards to your rack is critical and is in your exclusive control.

You must inspect the indicator bands on all SeaSuckers when entering and exiting your vehicle. A quick glance will tell you if the rack is at full power. If the indicator band is visible, you must re-pump the SeaSucker before the rack can be used.

You may need to clean, repair, or replace any of your SeaSucker vacuum mounts that do not hold vacuum for at least 4 hours. Your rack comes with an extra SeaSucker vacuum pump; keep it with your rack in case you accidentally damage one.

You must obey all posted speed limits and traffic conditions; if there is no posted speed limit, we recommend not driving above 85 miles per hour. You must adapt your driving style and speed to road conditions, weather conditions, and the load on your SeaSucker rack.



Designed and manufactured by:
SeaSucker, LLC
Bradenton, Florida
www.SeaSucker.com

