

Monkey Bars

Monkey Bars Ridge Ready

SX6150
SX6140
2/23

What's in the Box

- (2) Front bar mounts, each with (2) standard SeaSucker vacuum mounts attached
- (2) Rear bar mounts, each with (1) standard SeaSucker vacuum mount attached
- (4) Cross bar clamps and hardware
- (2) Aluminum cross bar assemblies (48")
- (2) oval SeaSucker vacuum pads
- (1) 5g Lube Tube (for vacuum pump maintenance)
- (1) spare SeaSucker vacuum pump (for maintenance)
- (1) 5/32" hex wrench (for assembly)

What's in the Box

- (2) Front bar mounts, each with (2) oval SeaSucker vacuum mounts attached
- (2) Rear bar mounts, each with (1) oval SeaSucker vacuum mount attached
- (4) Cross bar clamps and hardware
- (2) Aluminum cross bar assemblies (48")
- (1) 5g Lube Tube (for vacuum pump maintenance)
- (1) spare SeaSucker vacuum pump (for maintenance)
- (1) 5/32" hex wrench (for assembly)

Assemble Your Monkey Bars

The SeaSucker Monkey Bars require simple assembly to be ready for use. Ideally, you will assemble your rack near your vehicle so you can custom fit the rack to your roof.

The cross bar clamps attach to the front and rear bar mounts with a nut and bolt. Drop a clamp into the pivot slot of one of the mounts; orient the clamp so that the clamp-tightening bolt is facing the same direction as the bolt hole. See the diagram to the left for a graphic description of the difference between the bolt hole and the nut hole for both the front and rear bars. Insert a 1-1/4" bolt into the bolt hole, through the clamp, and out the nut hole. Thread the nut onto the end of the bolt as tightly as you can by hand and press and hold the nut against the nut hole. Using the 5/32" hex wrench to turn the bolt, tighten the bolt until the end of the bolt is just even with the outside end of the white nylon locking insert on the inside of the nut. If you tighten the clamp beyond that, it might interfere with the clamps ability to pivot in the slot. Repeat for the other three bar mounts.

Assemble your cross bars next. First remove the protective plastic cap on the end of the threaded connector. Find the Lube Tube that came with your rack and put a drop or two on your fingertip. Spread the lube onto the exposed threads to create a thin film of lube. This will prevent the threads from seizing together once assembled so that you can unscrew the bars for easier storage or transport.

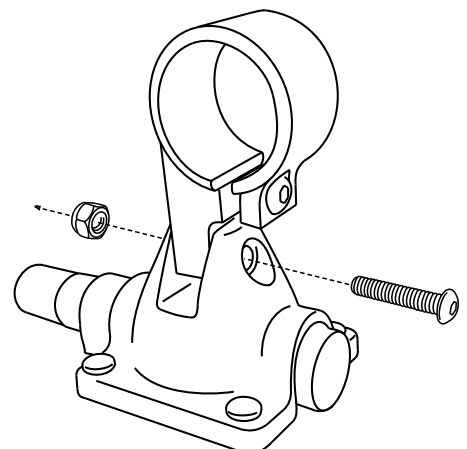
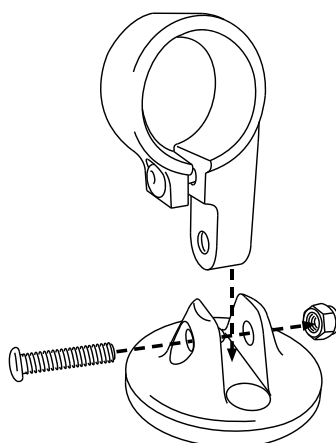
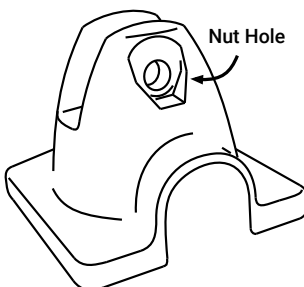
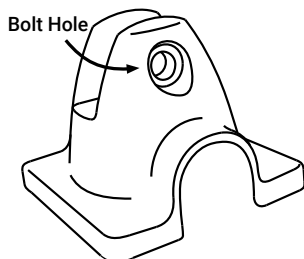
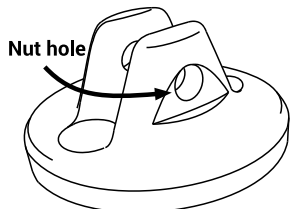
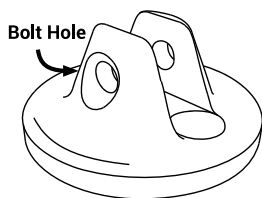

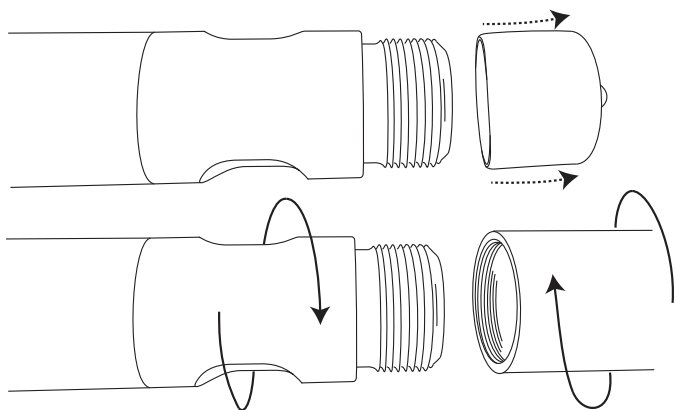

Now line up the threaded connector with the open bar end and thread the two pieces together. Continue until the threaded connector is fully seated in the bar (it should look like the other side that came preassembled from the factory). Give the bars a firm twist to complete the assembly - nothing more than hand pressure should be needed to make a secure connection. Repeat for the second bar.

Next, slide one of the front bar mounts onto one of the cross bars. Slide the other front bar mount onto the other side of the same bar; make sure the vacuum pumps on the mounts are pointing in the same direction. Remove the protective covers from the mounts and place the bar and mounts onto the roof

of your vehicle just behind the front windshield; the vacuum pumps should be pointing towards the rear of the vehicle. Position each of the front bar mounts as near to the front corners of the roof as you can (see "Where to Attach" below). Attach the vacuum mounts (see "Attaching Your Rack" below) and center the cross bar between the front bar mounts. Using the 5/16" hex wrench, tighten the clamp bolt on each front bar mount. Your front cross bar should now be custom-fit to your vehicle; you can use it or remove it from the car (see "Removing your Rack" below).

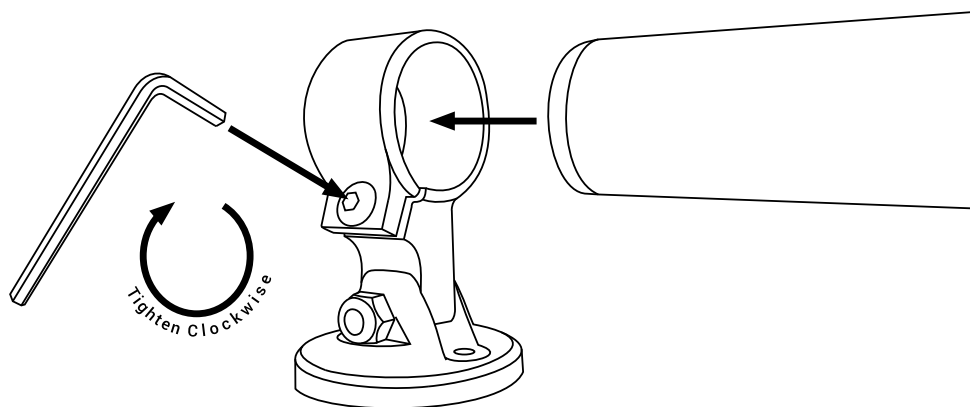

Repeat this process for the rear bar mounts and cross bar, mounting them just in front of the rear window.

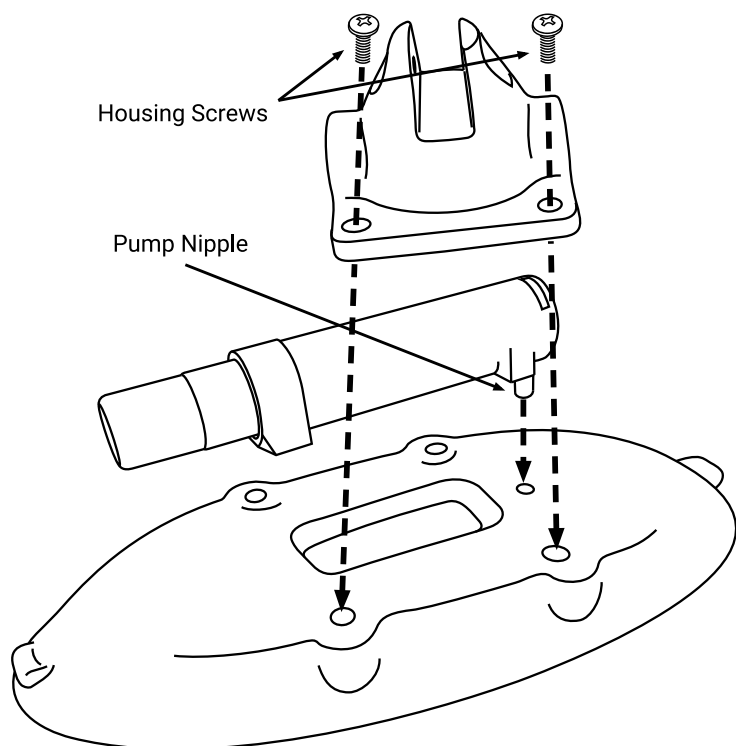

Special instructions for standard Monkey Bars:
Your rack comes with two oval vacuum pads for use if your vehicle's roof has ridges spaced too closely to use the standard round SeaSucker vacuum pads on the rear bar. To swap the pads, use a Phillips-head screwdriver to remove the four housing screws from the round vacuum mounts. Pull the housing off of the top of the pump and then remove the pump by gently twisting and pulling up. Store the unused round vacuum pad with its protective cover on. Moisten the pump nipple and gently twist it into the air hole on the oval vacuum pad until the pump is sitting flush on top of the vacuum pad. Push the housing down on top of the pump, lining up the housing's screw holes with the threaded insets molded into the oval vacuum pad. Use the screwdriver to tighten the four housing screws to secure the housing. Repeat for the rear bar's second vacuum mount.

Where to Attach

Monkey Bars are specifically designed to attach to a car's roof top. Ideally, the vacuum mounts on your rack should be attached in the front and back corners of your car's roof, where the roof is most solid. The metal in the middle of some car roofs may not be sturdy enough to support the weight of your rack and whatever you may be transporting. If you have the Ridge Ready version of the Monkey Bars, position the vacuum mounts so that they lie in the groove in between the ridges.

Each vacuum mount on your SeaSucker rack should attach to clean, unobstructed metal or glass surface. The vacuum pads will not attach over a seam or other surface incongruity.

Attaching Your Rack: Clean and Pump

Clean the surface you're going to mount the rack to. Dust and dirt will affect your SeaSuckers' ability to create and hold vacuum. Remove the protective cover from each SeaSucker and inspect the rubber vacuum pad for damage or dirt. Do not use your rack if there is any visible damage to the vacuum pad. If the vacuum pad is dirty, clean it with a mild soap and water solution and a soft cloth or sponge.

It may help to moisten the bottom edge of each vacuum pad or the mounting surface with water - do not use cleaners, lubricants, or other liquids. Press the vacuum mount against the mounting surface to make a full seal; you may need to press firmly down on the body of the rack to ensure that the vacuum pad is fully connecting with the mounting surface when pumping. This issue is more likely to arise when attaching one of the oval vacuum mounts. When attaching to a curved surface, you may need to press down on the long ends of the vacuum pads to ensure that the edge of the pad is touching the mounting surface all the way around. If the edge of the pad is not touching all the way around, the pump can not pull a vacuum and the vacuum mount will not attach.

Pump the SeaSucker repeatedly until the plunger doesn't spring back and the indicator band is hidden inside the pump cylinder. Repeat this for all SeaSuckers on the rack. If the plunger won't stay seated in the pump cylinder or continues to extend out immediately after pumping, you may need to clean the mounting surface or the vacuum pad or pump, perform basic maintenance on the vacuum pad or pump, or move the rack to a more suitable mounting position. Do not use your rack without correcting the problem!

Removing Your Rack: Lift and Cover

Remove the cargo from the rack. With your fingertip, use one of the tabs on the SeaSucker's vacuum pad to lift the edge of the pad up from the mounting surface and break the vacuum seal.

Always put the protective covers back on when the rack is not attached to your car to protect the vacuum pad's rubber. Make sure the pad is fully seated in the protective cover before storing it. The edge of the vacuum pad could be damaged or deformed if the vacuum pad isn't fully seated in the protective cover.

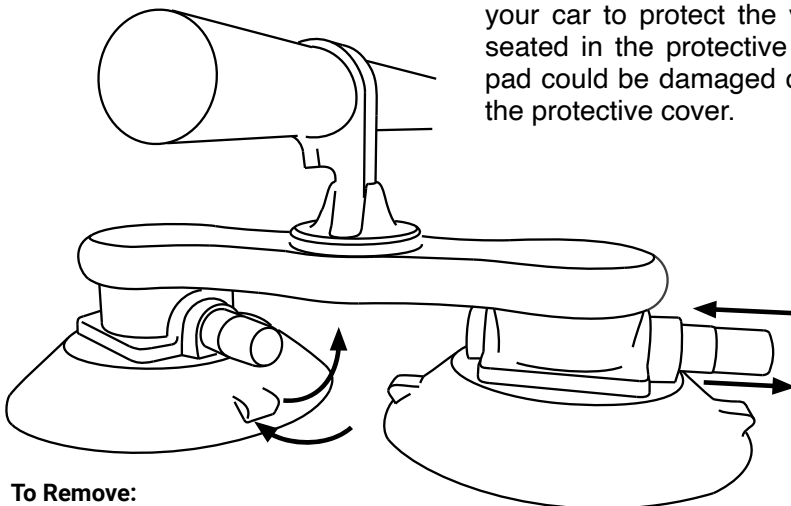

To Remove:

1. Lift edge of vacuum pad using either rubber tab.
2. Put protective cover on vacuum pad.

To Attach:

1. Remove protective cover.
2. Place SeaSucker on a clean, smooth surface.

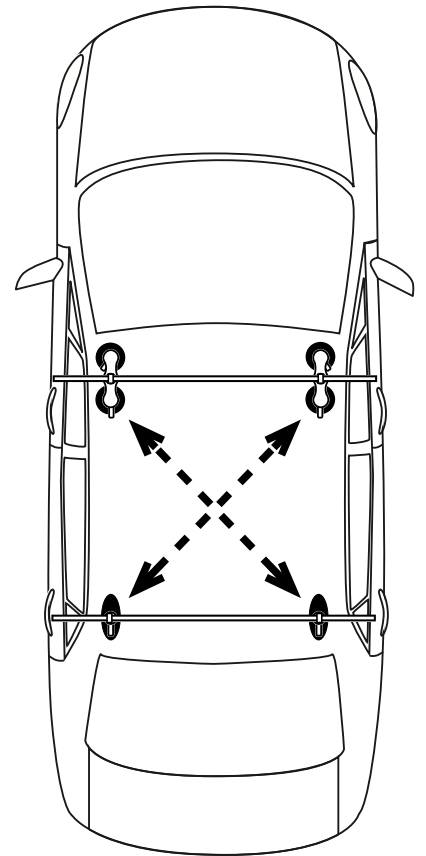

Check for the Indicator Band During Use

SeaSucker vacuum mounts are not intended to be permanent fixtures on your car - they will lose vacuum over time. When your vacuum mount loses vacuum, it will warn you by extending the pump's plunger, exposing an orange band. You are required to monitor your vacuum mounts during use. When getting in or out of your car, check to see if the indicator band is visible on any of the rack's vacuum mounts. If you see the band, simply pump the SeaSucker as described above.

If the indicator band appears less than four hours after being pumped to full strength, either cleaning, maintenance or repositioning may be required. If your rack is mounted on a scratched surface, move the rack to a more suitable position. If the mounting surface or vacuum mount is dirty, clean it. If these steps don't stop the vacuum mount from losing vacuum prematurely, discontinue use until the problem is resolved. Replace the pump on the suspect vacuum mount with the spare that came with your rack if necessary - additional replacement parts can be purchased in the Replacement Parts section of our on-line store.

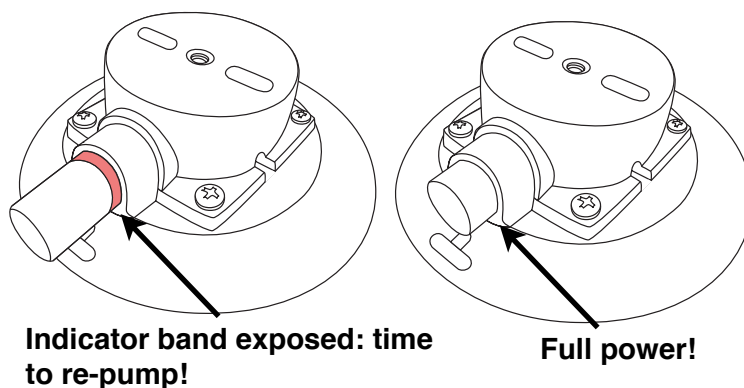

Strapping Cargo to You Monkey Bars

One of the great things about owning Monkey Bars is that you can carry almost anything you can strap to the bars. To secure cargo, such as surfboards, paddle boards, ladders, lumber, PVC pipes, or taxidermied alligators, remember this simple mantra: OVER the cargo, UNDER the bars.

Weather Conditions

SeaSucker products can be used in cold weather. The vacuum pads will stiffen in colder temperatures. Because the vacuum pads need to conform to the mounting surface when you attach them, it is highly recommended that you store your rack at room temperature (60°F+) prior to use. You will not be able to properly attach the vacuum mounts if they are too cold. Mounting surfaces must be free of ice, snow, dirt and any else that might prevent the vacuum pad from making a full seal. In freezing temperatures, we recommend not moistening the edge of your vacuum pads with water as discussed in "Attaching Your Rack" above.

Rain and wet weather should not affect the performance of your SeaSucker rack. If rain or water gets inside any of your vacuum pumps, pull the plunger out and dry the inside of the pump cylinder with a clean paper towel. Re-lube the plunger seal if necessary and reinsert the plunger in the pump cylinder. Screws or other metal parts that show signs of rusting or corrosion should be replaced.

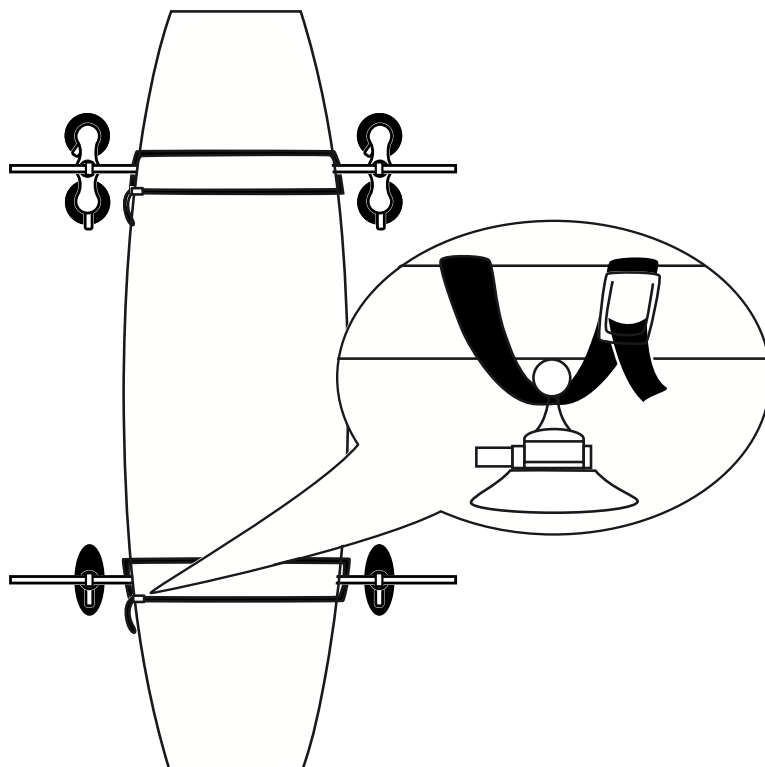

Care and Maintenance

To get the most out of your SeaSucker rack, inspect it regularly and store it with the vacuum mounts' protective covers on. Check that all screws are securely tightened, including the screws attaching the vacuum pads to the SeaSucker housing and the screws attaching the SeaSuckers to the rack deck.

Clean the vacuum pads before each use with a sponge or soft cloth, mild dish soap and water. Do not use harsh solvents or abrasive cleaning pads. Make sure there is no dirt or debris on the sealing edge (the bottom outside edge) of the vacuum pad. Inspect the sealing edge for stiffness, cracks, roughness, or cuts – a cut will allow air to leak under the vacuum pad and will prevent your SeaSucker from holding vacuum. A damaged vacuum pad should be replaced.

The vacuum pump should be cleaned regularly. To clean the pump, pull the plunger straight out of the pump cylinder. Clean the inside of the cylinder with dish soap and a soft cloth or paper towel. Make sure to dry out the cylinder – water left in the cylinder can cause the pump to make a popping noise when pumped and may interfere with the check-valve function of the pump.

The plunger should be wiped clean and the black rubber seal at the tip of the plunger should be re-lubed with a thin layer of silicone-based gel lubricant, such as the Lube Tube that came with your rack. After cleaning, push the plunger back into the cylinder and pump it several times to seat it properly and distribute the lubricant.

One replacement SeaSucker vacuum pump comes with your rack. Additional replacement SeaSucker vacuum mounts, vacuum pads, vacuum pumps, and additional tubes of Lube Tube can be purchased on-line at www.seasucker.com in the Replacement Parts section of our on-line store.

**The Lube Tube supplied with your rack is for vacuum pump maintenance only -
DO NOT apply lube to the vacuum pad.**

Warranty

SeaSucker offers a lifetime, non-transferable warranty to the original purchaser covering defects in materials and workmanship. Defective products can be returned to SeaSucker for replacement or repair (at SeaSucker's option). Warranty claims must be accompanied by a sales receipt or other proof of purchase document. The cost of transportation to and from SeaSucker for the repair or replacement of any defective part or accessory is not covered by this warranty and is to be paid by the owner.

This warranty does not apply to damage or failure resulting from routine wear and tear expected in the normal use of this product, or to lack of maintenance, user error, alteration or modification of the product, accidents, misuse, abuse, or neglect.

This warranty is given in lieu of all other written or oral warranties, express or implied, including without limitation implied warranties of merchantability and fitness for a particular purpose, and are limited to the duration and specifications of this warranty.

Purchaser's exclusive remedy under this warranty is the repair or replacement of a defective product or, at SeaSucker's option, the issuance of a refund or credit for the purchase price of the product. SeaSucker's liability for any damages relating to any allegedly defective product, whether arising from the use or the inability to use the product and whether claimed under tort, contract or any other legal theory, shall be limited to the actual price paid for such product and shall in no event include loss of use, loss of time, incidental, consequential, special, or indirect damages of any kind, even if SeaSucker is aware of the possibility of such damages, to the full extent as such may be disclaimed by law.

It is the user's responsibility to ensure that the use of this product is not prohibited by any applicable local or state law.

Repair and Replacement

Products with non-warrantable damage may still be repaired or replaced at your expense. Discounted replacement parts, including vacuum pads, pumps, and hardware, can be found on-line in the Replacement Parts section of SeaSucker's on-line store at www.seasucker.com.

IMPORTANT WARNINGS

- Do not exceed the posted speed limit.
- Do not carry more than the maximum recommended load (165 pounds).
- Do not use if the indicator band is exposed on any of your SeaSucker's pumps.
- Do not use if all of the rack's mounts cannot maintain a full vacuum seal for at least 4 hours.
- Clean the mounting surface before attaching.
- Clean SeaSuckers before attaching.
- Clean and lube your SeaSuckers' pumps regularly.
- Inspect screws, nuts, and bolts regularly and retighten if necessary.
- Make sure the vacuum pads are fully seated in the protective covers when not in use.
- Do not attempt to park your car in a garage with a cargo mounted on the roof without ensuring you have enough clearance.

YOUR RESPONSIBILITIES

You must read and follow the instructions in this user manual. You must attach the rack correctly to your vehicle, check it before each use, and perform any necessary maintenance. The correct attachment of the rack to your vehicle is critical and is in your exclusive control.

You must attach your cargo correctly to the rack. The correct attachment of cargo to your rack is critical and is in your exclusive control.

You must inspect the indicator bands on all SeaSuckers when entering and exiting your vehicle. A quick glance will tell you if the rack is at full power. If the indicator band is visible, you must re-pump the SeaSucker before the rack can be used.

You must clean, repair, or replace any of your SeaSucker vacuum mounts that do not hold vacuum for at least 4 hours. Your rack comes with an extra SeaSucker vacuum pump; keep it with your rack in case you accidentally damage one.

You must not overload your rack. The maximum recommended load is 165 pounds (74.8 kilograms). Carrying loads above 165 pounds may damage both your rack and the roof of your vehicle.

You must obey all posted speed limits and traffic conditions; if there is no posted speed limit, we recommend not driving above 85 miles per hour. You must adapt your driving style and speed to road conditions, weather conditions, and the load on your SeaSucker rack.

TROUBLESHOOTING GUIDE	Problem	What Might Be Wrong	How To Fix It
	Slow Leakage	Dry mounting surface or vacuum pad	Moisten the mounting surface or the vacuum pad
		Nicks or cuts on vacuum pad	Replace the vacuum pad
		Dirt in pump	Clean and re-lube the plunger and pump cylinder
		Dry pump	Re-lube the plunger seal
		Dirt on vacuum pad	Clean the vacuum pad
		Dirty or uneven mounting surface	Clean the mounting surface or move to a more suitable spot
	Severe Leakage	Nicks or cuts on vacuum pad	Replace the vacuum pad
		Damaged pump	Replace the vacuum pump
		Dirty or uneven mounting surface	Clean the mounting surface or move to a more suitable spot
	Jammed or Sluggish Pump	Dry pump	Re-lube the plunger seal
		Obstructed valve stem	Remove the obstruction; clean and re-lube the pump
		Dirt in pump	Clean and re-lube the plunger and pump cylinder

Designed and manufactured by:



SeaSucker, LLC
Bradenton, Florida
www.SeaSucker.com

