

Paper Towel Holder

MBS424
10/24

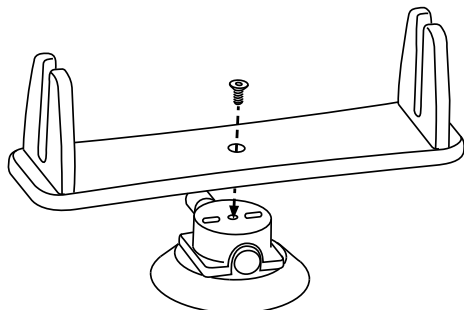

Assembly

Attach the vacuum mount to the base. Line up the tabs on the bottom of the base with the corresponding holes on top of the vacuum mount and press the vacuum mount into place. Push the bolt through the hole in the base and tighten with the included hex key.

Loading the Paper Towel Holder

Loosen the stretch cords on both sides of the base by pressing and holding the button on each of the cord locks and pulling the cord lock down towards the end cap. Take the stretch cord off of the hook end of the center bar and angle the bar upwards. Slide the roll of paper towels onto the bar and return the bar to its slot in the base. Reattach the stretch cord to the hook end of the bar. Adjust each of the cord locks to the desired amount of tension. Periodically readjust the tension as the paper towel roll gets smaller. Replacement stretch cord assemblies are available online at SeaSucker.com.

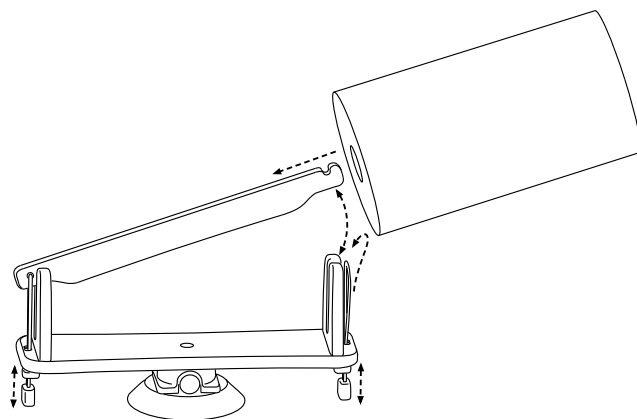

To Attach: Clean and Pump!

Clean the surface you're going to mount to. Dirt or debris will affect your vacuum mount's ability to create and hold vacuum. Remove the protective covers and inspect the rubber vacuum pad for damage or dirt. Do not use if there is any visible damage to the vacuum pad. If the vacuum pad is dirty, clean it with a mild soap and water solution and a soft cloth or sponge.

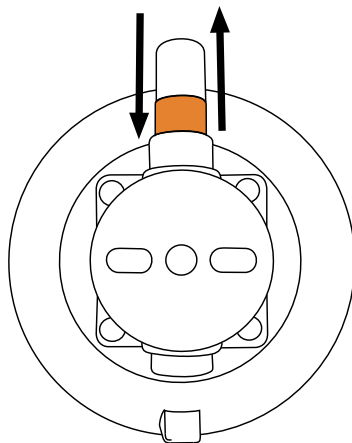

Press the vacuum pad firmly against the mounting surface to make a full seal. Pump repeatedly until the plunger does not spring back and the indicator band is hidden inside the pump cylinder. If the plunger won't stay seated in the pump cylinder or continues to extend out immediately after pumping, you may need to clean the mounting surface or the vacuum pad or pump, perform basic maintenance on the vacuum pad or pump, or move it to a more suitable mounting position.

Check for the Indicator Band During Use

When your vacuum mount loses vacuum, it will warn you by extending the pump's plunger, exposing an orange band. You are required to monitor your vacuum mount during use. If you see the orange band, simply pump as described above. If the indicator band appears less than six hours after being pumped to full strength, either cleaning, maintenance or repositioning may be required.

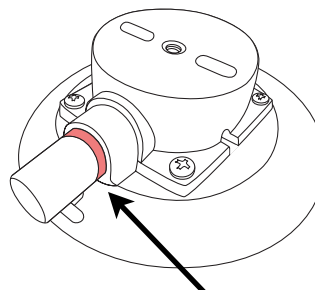

Indicator band exposed:
time to re-pump!

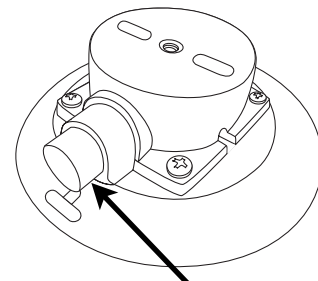

Full power!

To Remove: Lift and Cover!

With your fingertip, use one of the tabs on the vacuum pad to lift the edge of the pad up from the mounting surface and break the vacuum seal. Remember to attach the protective cover to the bottom of the vacuum pad to protect it when not mounted.

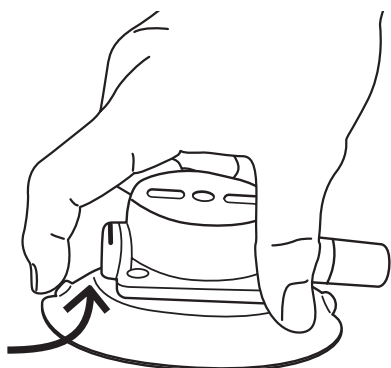

Care and Maintenance

To get the most out of your SeaSucker product, inspect it regularly, keep it clean, and store it with the vacuum mounts' protective covers on. Check that all screws are securely tightened.

Clean the vacuum pads before each use with a sponge or soft cloth, mild dish soap and water. Do not use harsh solvents or abrasive cleaning pads. Inspect the sealing edge for stiffness, cracks, roughness, or cuts. A damaged vacuum pad should be replaced.

The vacuum pump should be cleaned regularly. Pull the plunger straight out of the pump cylinder. Clean the inside of the cylinder with dish soap and a soft cloth or paper towel. Dry the inside of the cylinder – water left in the cylinder may interfere with the check-valve function of the pump.

The plunger should be wiped clean and the black rubber seal at the tip of the plunger should be re-lubed with a thin layer of silicone-based gel lubricant, such as the Lube Tube that came with your Rotopax Tank Mount. After cleaning, push the plunger back into the cylinder and pump it several times to seat it properly and distribute the lubricant.

Warranty

SeaSucker offers a lifetime, non-transferable warranty to the original purchaser covering defects in materials and workmanship. Defective products can be returned to SeaSucker for replacement or repair (at SeaSucker's option). Warranty claims must be accompanied by a sales receipt or other proof of purchase document. The cost of transportation to and from SeaSucker for the repair or replacement of any defective part or accessory is not covered by this warranty and is to be paid by the owner.

This warranty does not apply to damage or failure resulting from routine wear and tear expected in the normal use of this product, or to lack of maintenance, user error, alteration or modification of the product, accidents, misuse, abuse, or neglect.

This warranty is given in lieu of all other written or oral warranties, express or implied, including without limitation implied warranties of merchantability and fitness for a particular purpose, and are limited to the duration and specifications of this warranty.

Purchaser's exclusive remedy under this warranty is the repair or replacement of a defective product or, at SeaSucker's option, the issuance of a refund or credit for the purchase price of the product. SeaSucker's liability for any damages relating to any allegedly defective product, whether arising from the use or the inability to use the product and whether claimed under tort, contract or any other legal theory, shall be limited to the actual price paid for such product and shall in no event include loss of use, loss of time, incidental, consequential, special, or indirect damages of any kind, even if SeaSucker is aware of the possibility of such damages, to the full extent as such may be disclaimed by law.

It is the user's responsibility to ensure that the use of this product is not prohibited by any applicable local or state law.

TROUBLESHOOTING GUIDE

Problem	What Might Be Wrong	How To Fix It
Slow Leakage	Dry mounting surface or vacuum pad	Moisten the mounting surface or the vacuum pad
	Nicks or cuts on vacuum pad	Replace the vacuum pad
	Dirt in pump	Clean and re-lube the plunger and pump cylinder
	Dry pump	Re-lube the plunger seal
	Dirt on vacuum pad	Clean the vacuum pad
	Dirty or uneven mounting surface	Clean the mounting surface or move to a more suitable spot
Severe Leakage	Nicks or cuts on vacuum pad	Replace the vacuum pad
	Damaged pump	Replace the vacuum pump
	Dirty or uneven mounting surface	Clean the mounting surface or move to a more suitable spot
Jammed or Sluggish Pump	Dry pump	Re-lube the plunger seal
	Obstructed valve stem	Remove the obstruction; clean and re-lube the pump
	Dirt in pump	Clean and re-lube the plunger and pump cylinder



Designed and manufactured by:
SeaSucker, LLC
Bradenton, Florida
www.SeaSucker.com

