

TESLONG

NTG500 Digital Borescope

USER MANUAL

Thank you for choosing our NTG Rifle Borescope. This user manual is suitable for NTG500, NTG500H, NTG500P digital photo/video borescope. Please read the user manual before operating the device and maintain it properly for further reference.

⚠ This device is NOT for medical use or human examination.

Product Description

Product Specifications ▼

Model	NTG500	NTG500H	NTG500P
Probe Length	45inch	26inch	10inch
Probe	Flexible Gooseneck	Rigid Rod	Rigid Rod
Fit For	Rifle Barrel Inspection	Rifle Barrel Inspection	Pistol Barrel Inspection
Probe Diameter	0.2inch		
Camera Sensor	1.0 Megapixel CMOS		
Depth Of Field	0.4~0.6inch		
Bore Light	6 Brightness Adjustable LEDs		
Screen	5.0–inch Color HD Display		
Screen Resolution	854x480 Pixels		
Snapshot Resolution	1920x1080		
Video Recording Resolution	1280x720		
Port	Type–C charging port; TF memory card slot		
Battery Type	3500mAh Lithium Battery		
Power Input	5V USB charger		

– 1 –

NTG500 series is the stand–alone line of digital photo/video borescopes from Teslong, including the NTG500 flexible borescope, the NTG500H rigid borescope, and the NTG500P pistol borescope. The NTG500 series is equipped with a 5.0–inch color screen so that firearms enthusiasts can inspect gun barrels anytime and anywhere without the need for a phone or PC.The diameter of the borescope camera is 0.2inch, which makes it easy to access .20, and larger, caliber barrels. The detachable side view mirror allows users to check the barrel wall, or remove it and check the firing point.

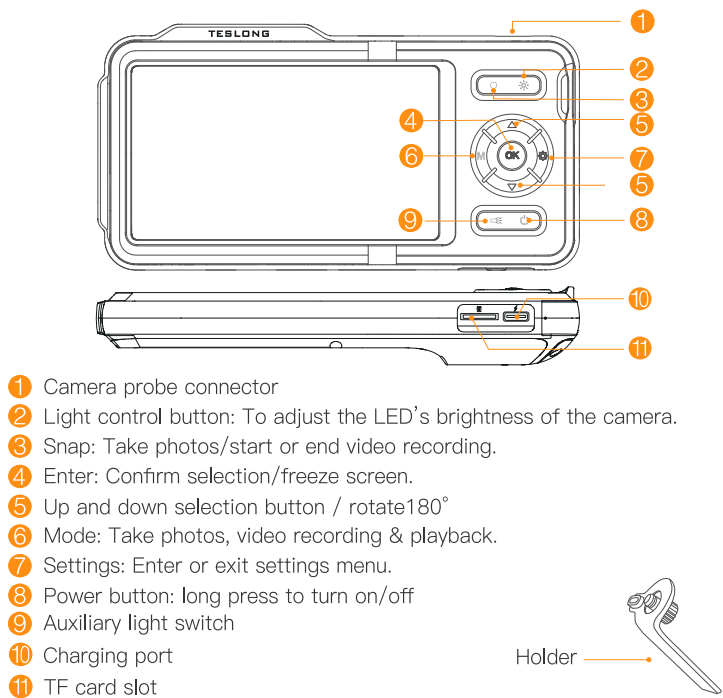

– 2 –

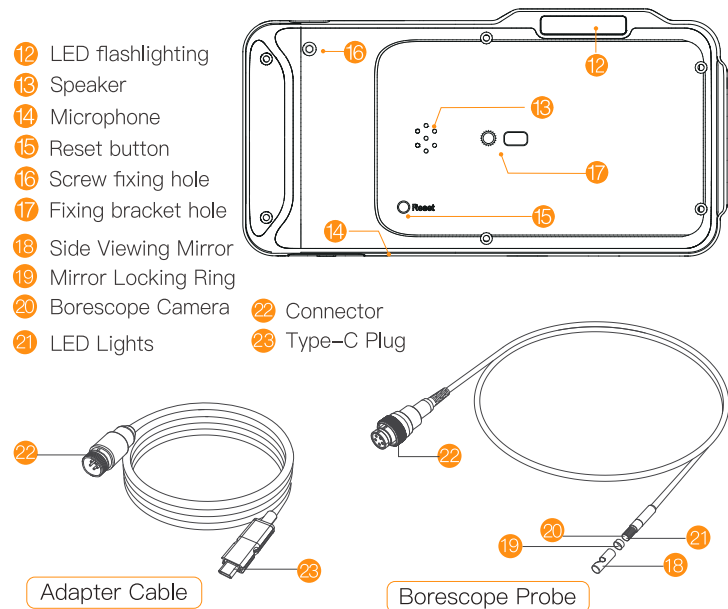

How To Use The Borescope

Connect the probe to the cable ▼

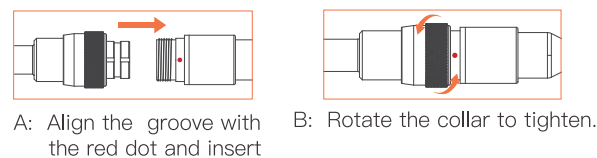

– 3 –

Adjust Side–View Focus ▼

The borescope probe has a threaded, adjustable–focus design. After installing the side–view mirror, adjust the distance between the mirror and the camera and fix the mirror with the lock ring to obtain sharper focus.

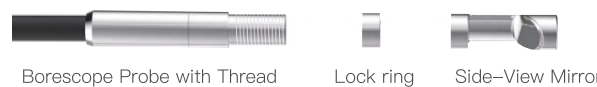

For example:

A. For a .22 caliber barrel, you need to screw the mirror out to a position farther away from the camera and fix in place with the lock ring.

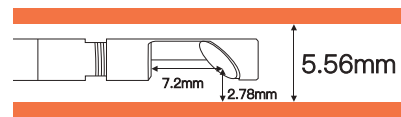

B. For a .30 caliber barrel, you need to screw the mirror into a position closer to the camera.

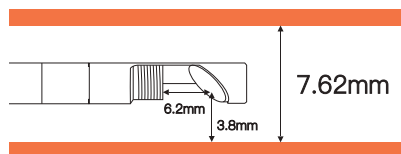

Tips: Dirty lenses and mirrors are a common cause of bad images. Please use the cloth to clean the lens and the side–view mirror to get a sharper image.

– 4 –

How To Use The Monitor

Instructions ▼

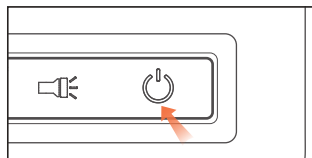

▶ Press & hold the Power button for a few second to turn ON/OFF device.

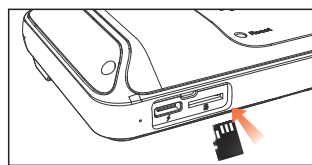

▶ The device is equipped with a TF memory card(inserted). Gently press to eject the card.

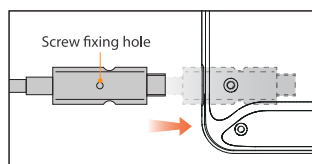

Insert the hose connector into the host interface, align it with the screw hole, and then tighten the screw to fix it.

Note: Connect camera probe before turning on device. Restart device after replacing camera probe.

Insert the Micro SD card:

- (1) Power off device first before insert TF card.
- (2) Make sure the direction and the front and back sides is correct when insert the TF card.
- (3) Do not use excessive pressure when inserting or removing the TF card to prevent damages of card slot structure.

– 5 –

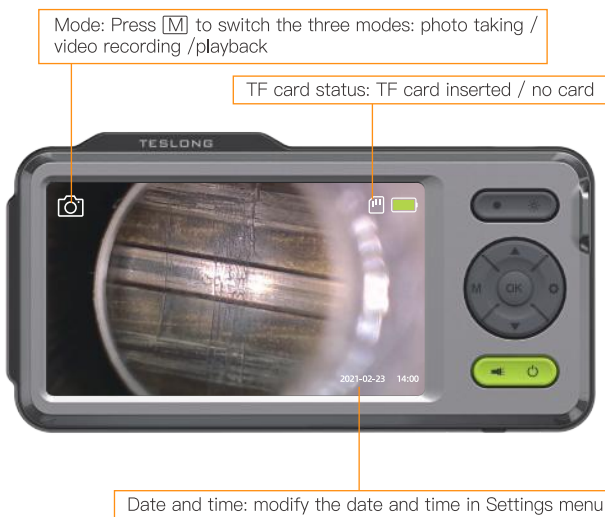

Language Settings ▼

The default language is English, and the system supports English / Chinese, German / French / Spanish / Italian / Russian and Japanese.

Setting path:

- (1) Press the button twice to enter setting page
- (2) Select second item (Language) on settings page
- (3) Press up and down keys to select the language you need
- (4) Press to save your choice

– 6 –

Photo Taking/Video Recording/Playback ▼



Press to switch to the photo taking or video recording mode, and press to take a photo or start recording.



Press to switch to playback mode, press to select photo or video to view,and press to delete a photo or video.

– 7 –

How To Copy Photos And Video Files To Your Computer ▼

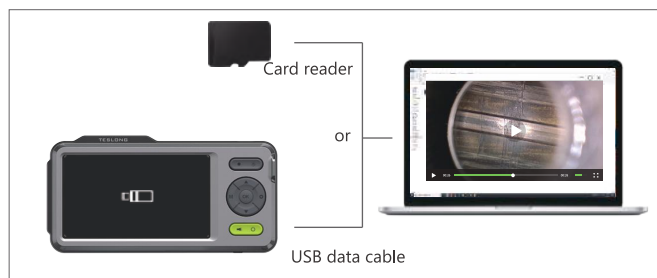

You can use a Micro SD card reader to copy data from your removed Micro SD card or use a Type–C cable to connect to a computer for copying.

⚠ please pull out probe camera first before using Type–c cable.

Charge The Monitor ▼

Please use 5V household charger that meets safety regulations to charge this device

This device can work while charging.

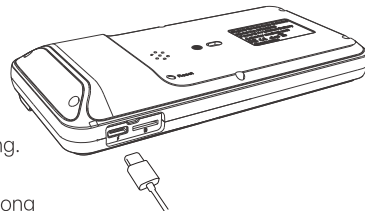

If you do not use the device for a long time, makesure to charge it at least once every 3 months to prevent irreparable damage caused by excessive battery discharge.

– 8 –



Customer Service

Please contact us if you have any questions, We'd love to hear from you.

www.teslong.com

877–899–8809(US)
(Mon.–Fri. 8:00 AM–5:00 PM PST)

support@teslong.com
info@teslong.com



©TESLONG NTG500 202103 V2.0
30601–0081–00