

The Austlift logo, featuring a stylized 'A' icon followed by the word 'AUSTLIFT' and a registered trademark symbol.

AUSTLIFT®

ALLOY CHAIN & FITTINGS

LIFTING YOUR BUSINESS TO A HIGHER LEVEL

AUSTRALIAN LIFTING CENTRE PTY LTD

1300 100 120

www.austlift.com.au

Alloy Chain & Fittings

G80 Alloy Chain, G30 Chain	21
Trailer Chain, Master Link, Master Link Multi	22
Omega Link, Chain Connector	23
Webbing Sling Connector	23
Grab Hook (Clevis, Eye)	24
Grab Hook with Safety Pin	25
Clutch Choker, Shortening Clutch	25
Sling Hook (Clevis, Eye)	27
Self Locking Hook (Clevis, Eye)	28
Grip Self Locking Hook (Clevis, Eye)	29
Sling Hook(Swivel), Self Locking Hook (Swivel)	30
Swivel Self Locking Hook (Clevis)	31
Grip Self Locking Hook (Swivel)	31
Clevis Shackle	32
Drum Hook, Elephant Foot (Clevis, Eye)	32
Foundry Hook (Clevis, Eye), Container Hook	33
Weld on Point , Universal Weld on Hook	34
Hoist Hook, Hoist Swivel Hook	35
Swivel Panel Lifter, Ring Panel Lifter	36
Spread Anchor	37
Recess Former Kit	37
Swivel (Bow/Clevis), (Eye/Bow)	38
Swivel (Bow/Bow)	39
Chain Sling Tag	39
Spare Parts	40
Advice	42
Welding Instructions	44
Swivel Panel Lifter Instructions	45
Ring Panel Lifter Instructions	46

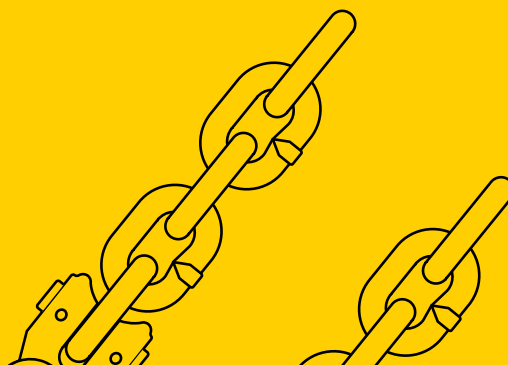



G80 Chain & Fittings

Austlift™ G80 products are manufactured & tested to the requirements of Australian Standard AS 2321 'short link chain for lifting purpose' & AS3776 'lifting components for Grade T chain slings' in extremely high quality.

All G80 products are made from alloy steel, the chemical composition conforms to EN1677:2000 specification. They are quenched & tempered & uniformly marked with equivalent chain size, grade, batch number, manufacturer's ID & product 'type code' for positive identification.

We regard your safety as our priority. Tests are applied to every batch on a random sampling. Test certificates are available upon request.



Full Member

GRADE 80 IDENTIFYING FEATURES

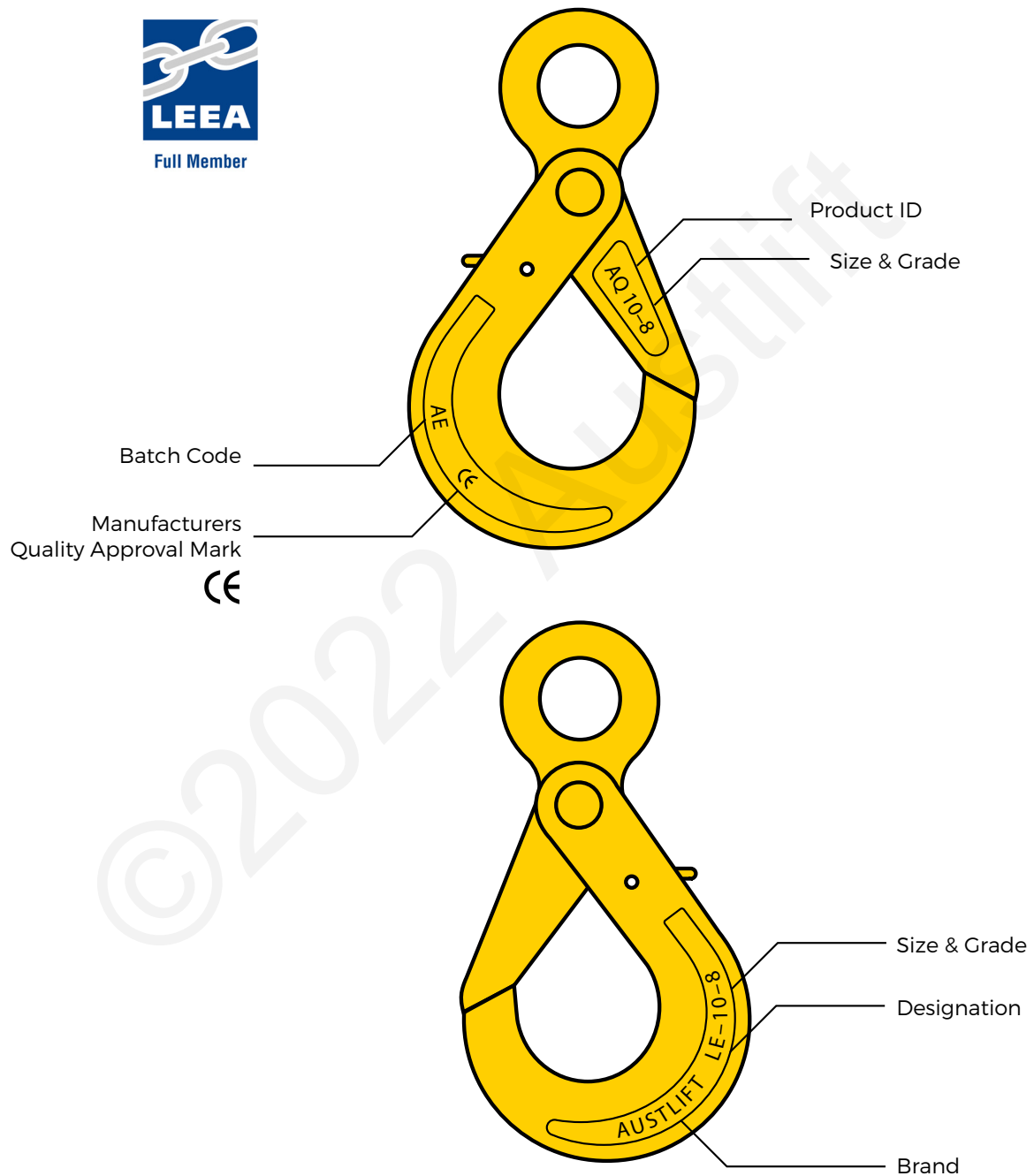

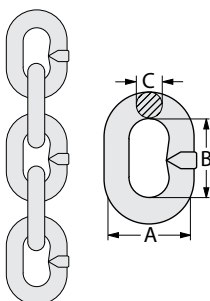
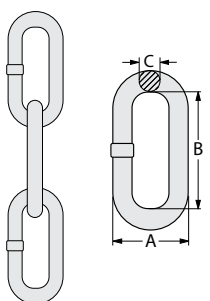
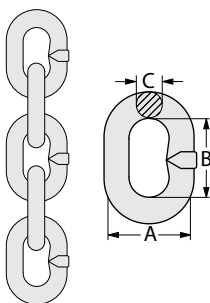

G80 Lifting Chain

Austlift Grade 80 (T) chain is designed for chain slings for industrial lifting applications. It is made from hardened and tempered alloy steel. It has a high resistance to impact and meets critical requirements of AS2321 "short link chain for lifting purposes".

- Marked with chain grade with traceability mark.
- Safety factor 4 to 1.

AS/NZS
2321

Certified

G80
Alloy Steel

Safety Factor
4-1

Size from (mm)
6-32

FULL DRUM				1M CUT LENGTH		WLL (T)	DIMENSIONS (mm)		
SIZE (mm)	CODE	Wt. (kg)	LENGTH (M)	CODE	Wt. (kg/M)		A	B	C
6.3	101506	500	600	101406	0.84	1.12	21	18	6
7.1	101507	500	500	101407	1.14	1.5	24	21	7
8	101508(Y)	500	350	101408(Y)	1.41	2	28	24	8
10	101510(Y)	500	225	101410(Y)	2.21	3.2	35	30	10
13	101513(Y)	500	135	101413(Y)	3.76	5.3	46	39	13
16	101516	500	89	101416	5.64	8	57	48	16
20	101520	500	60	101420	8.6	12.5	70	60	20
22	101522	500	50	101422	10.7	15	78	66	22
26	101526*	760	40	101426	14.8	21.2	91	78	26
32	101532*	559	30	101432	21.6	31.5	115	96	32

LONG LINK FISHING LINE CHAIN							DIMENSIONS (mm)		
SIZE (mm)	CODE	Wt. (kg)	LENGTH (M)	WLL (T)	COLOUR		A	B	C
11	101511L	500	222	3	Yellow		41	64	11
13	101513L	500	163	4.2	Black		48	80	13

(Y) 8mm, 10mm 13mm Yellow colour powder coated available.

* Package size changes as to our supplier.

G30 Chain

Austlift Grade 30 (L) calibrated chain is generally used in marine or vertical hanging support applications. It is manufactured from carbon steel which has a high resistance to impact and wear, meets AS 2321 "short link chain for lifting purposes". It is class A hot dipped galvanised.

- Marked with chain grade with traceability mark.
- Safety factor 5 to 1.

AS/NZS
2321

Certified

G30
Carbon Steel

Safety Factor
5-1

Size from (mm)
6-22

FULL DRUM				1M CUT LENGTH		WLL (T)	DIMENSIONS (mm)		
SIZE (mm)	CODE	Wt. (kg)	LENGTH (M)	CODE	Wt. (kg/M)		A	B	C
6	101606	500	550	101706	1.1	0.4	21	18	6
8	101608	500	350	101708	1.43	0.64	26	24	8
10	101610	500	220	101710	2.27	1	35	30	10
13	101613	500	132	101713	3.78	1.7	46	39	13
16	101616	500	89.4	101716	5.59	2.58	55.5	48	16
20	101620	500	57.3	101720	8.73	4.03	68	60	20
22	101622	500	46.7	101722	10.71	5.06	73.5	66	22

G30 Fathom Chain

AS/NZS
2321

Certified

G30
Carbon
Steel

Safety Factor
5-1

SIZE (mm)	CODE	Wt. (kg)	LENGTH (M)	WLL (T)	DIMENSIONS (mm)					
					A	B	C	END LINK		
								A	B	C
20	101620F	1440	165	4.03	68	60	20	90	85	25

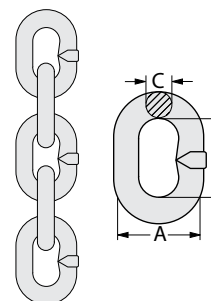

G80 Master Link (Type SD)

Austlift SD type head-rings are designed to cater for single leg and double leg chain slings or wire rope sling applications.

- Marked with single and double chain sizes, batch number, grade and Austlift branded with manufacture quality mark.
- Safety factor 4 to 1 for chain sling, 5 to 1 for wire rope sling.
- Batch tested, test certificates available upon request.
- Fatigue tested > 20,000 times.

AS/NZS
3776

Certified

G80
Alloy Steel

Chain Size (mm)
6-36

SIZE (mm)		CODE	WLL (T)	Wt. (kg)	DIMENSIONS (mm)		
1 LEG	2 LEG				B	C	D
6		101006	1.1	0.27	60	100	12
8	6	101008	2	0.44	70	120	14
10	8	101010	3.5	0.85	80	140	18
13	10	101013	5.5	1.48	95	160	22
16	13	101016	9.2	2.87	110	190	28
20	16	101020	13.8	5.66	140	240	35
22	20	101022	21.6	7.86	150	250	40
26	22	101026	26	10.15	150	250	45
32	26	101032	36.7	15.19	200	300	50
36	32	101036	54.5	24.79	200	350	60

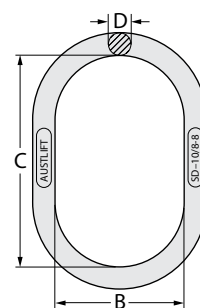

Alloy Chain &
Fittings

G80 Master Link Multi (Type MD)

Austlift MD type multi head rings are designed as a large ring with two intermediate links to cater for two, three and four leg chain sling or wire rope sling applications.

- Marked with chain sizes, batch number, grade and Austlift branded with manufacture quality mark.
- 4 times WLL breaking Force.
- Batch tested, test certificates available upon request.
- Fatigue tested > 20,000 times.

AS/NZS
3776

Certified

G80
Alloy Steel

Chain Size (mm)
6-22

SIZE (mm)	CODE	WLL (T)		Wt. (kg)	DIMENSIONS (mm)					
		0°-45°	45°-60°		A	B	D	a	b	d
6	101206	2.36	1.9	1.18	135	75	18	54	25	13
7/8	101208	4.25	3.5	2.2	160	90	22	70	34	16
10	101210	6.7	5.5	3.4	180	100	26	85	40	18
13	101213	11.2	9.2	6.1	200	110	32	115	50	22
16	101216	17	13.8	9.98	260	140	36	140	65	26
20	101220	26.5	21.6	22.5	350	190	50	180	100	32
22	101222	31.5	26.0	25.2	350	190	50	180	100	36

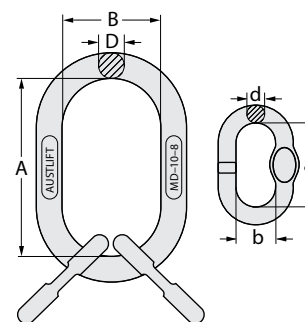

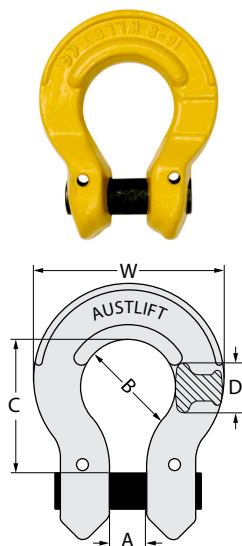

G80 Omega Link (Type OL)

Austlift omega links are commonly used in conjunction with recessed head rings and chain for chain slings and variable type slings.

- Marked with chain sizes, batch number, grade and Austlift branded with manufacture quality mark.
- Batch tested, test certificates available upon request.
- Fatigue tested > 20,000 times.

AS/NZS 3776	Certified	G80 Alloy Steel	Safety Factor 4-1	Size from (mm) 6-16
----------------	-----------	--------------------	----------------------	------------------------

SIZE (mm)	CODE	WLL (T)	Wt. (kg)	DIMENSIONS (mm)				
				A	B	C	D	W
6	104106	1.12	0.12	8	20.5	25	12	41
8	104108	2	0.22	10	23.5	35	16	52
10	104110	3.2	0.36	12	31.5	40.5	17	62
13	104113	5.3	0.71	15	41	54	20	81
16	104116	8	1.3	19	49.5	64	26	99

G80 Chain Connector (Type CL)

Austlift chain connectors are commonly used to connect head rings, chain, hooks and other lifting components for chain slings and variable type slings.

- Marked with chain sizes, batch number, grade and Austlift branded with manufacture quality mark.
- Batch tested, test certificates available upon request.
- Spare pin and studs are available.
- Fatigue tested > 20,000 times.

AS/NZS 3776	Certified	G80 Alloy Steel	Safety Factor 4-1	Chain Size (mm) 6-32
----------------	-----------	--------------------	----------------------	-------------------------

Refer to page 41 for G80 spare parts.

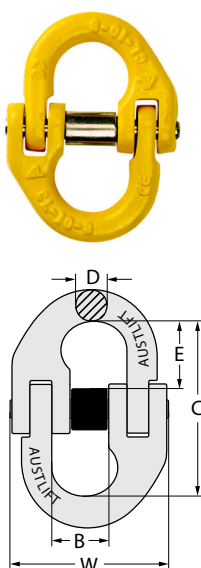

SIZE (mm)	CODE	WLL (T)	Wt. (kg)	DIMENSIONS (mm)				
				B	C	D	E	W
6	101806	1.12	0.08	15	42	7	18	43
7/8	101808	2	0.146	18	60.5	8.5	23.5	55
10	101810	3.2	0.3	25	68	11.5	27	69
13	101813	5.3	0.65	29	87	15	32	83
16	101816	8	1.15	34.5	108.4	19.8	41	102
18/20	101820	12.5	2.1	41	121.5	24	52.5	117
22	101822	15	2.87	48	141.5	26	62	143
26	101826	21.2	4.5	57.5	158	30	64	163
32	101832	31.5	8.21	67	205	37	86	199

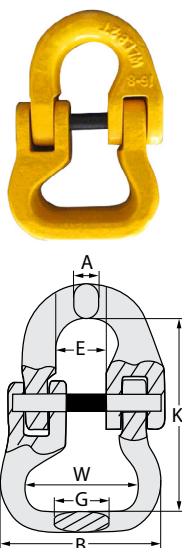

G80 Webbing Sling Connector

Austlift webbing sling connectors are commonly used to connect webbing slings.

- Marked with chain sizes, batch number, grade and Austlift branded with manufacture quality mark.
- Batch tested, test certificates available upon request.
- Fatigue tested > 20,000 times.

AS/NZS 3776	Certified	G80 Alloy Steel	Safety Factor 4-1	Chain Size (mm) 7-16
----------------	-----------	--------------------	----------------------	-------------------------

SIZE (mm)	CODE	WLL (T)	Wt. (kg)	MBF (T)	DIMENSIONS (mm)					
					A	B	K	W	G	E
7/8	104208	2.0	0.3	8.0	8.6	61.5	63.7	38	24	20
10	104210	3.2	0.68	12.6	11	74	83	45	30.5	24
13	104213	5.3	1.47	21.2	16.5	88	93.7	50	36.8	28
16	104216	8	2.3	32	19.5	106	118	64	44	34

G80 Grab Hook /Shortening Hook (Clevis Type, GC)

Austlift GC type clevis grab hook provides the flexibility to shorten chain slings and can be used for back-hooking. Austlift grab hooks come with supporting lugs to allow no reduction of the working load limit. The clevis is designed for easy connection of chain.

- Marked with chain sizes, batch number, grade and Austlift branded with manufacture quality mark.
- Batch tested, test certificates available upon request.
- Spare load pins are available.
- Fatigue tested > 20,000 times.

Refer to page 40 for G80 spare parts.

AS/NZS 3776	Certified	G80 Alloy Steel	Safety Factor 4-1	Size from (mm) 6-26
-----------------------	-----------	--------------------	-----------------------------	-------------------------------

CHAIN SIZE (mm)	CODE	WLL (T)	Wt. (kg)	DIMENSIONS (mm)					
				A	B	C	D	W	L
6	101906	1.12	0.23	78	8	32	7.5	41	46
7/8	101908	2	0.32	108	11	36	9	57	66
10	101910	3.2	0.73	127	13	46	12	70	74
13	101913	5.3	1.5	163	16	59	15	89	97
16	101916	8	2.8	204	20	70	17.5	109	124
18/20	101920	12.5	5	243	23	80	23	130	150
22	101922	15	6.3	280	26	98	25.5	151	170
26	101926	21.2	14.5	309	30	110	30	175	168

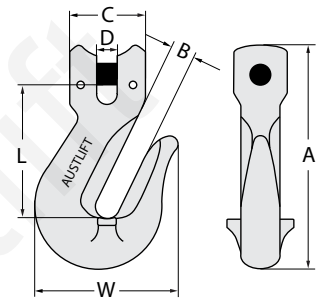

Alloy Chain &
Fittings

G80 Grab Hook /Shortening Hook (Eye Type, GE)

GE type eye grab hook provides the flexibility to shorten chain sling and can be used for back-hooking. Austlift grab hooks come with supporting lugs to allow no reduction of the working load limit. The eye is designed for easy connection of chain connector.

- Marked with sizes, batch number, grade and Austlift branded with manufacture quality mark.
- Batch tested, test certificates available upon request.
- Fatigue tested > 20,000 times.

AS/NZS 3776	Certified	G80 Alloy Steel	Safety Factor 4-1	Size from (mm) 6-32
-----------------------	-----------	--------------------	-----------------------------	-------------------------------

SIZE (mm)	CODE	WLL (T)	Wt. (kg)	DIMENSIONS (mm)					
				A	B	C	D	W	L
6	102006	1.12	0.25	75	8	8	13	45	50
7/8	102008	2	0.4	106	11	9.5	16	63	73
10	102010	3.15	0.6	126	13	12	20	79	84.5
13	102013	5.3	1.2	156	16	15	25	100	104
16	102016	8	2.7	193	20	19	28.5	123	130
18/20	102020	12.5	4.3	227	25	23	36	152	152
22	102022	15	6.4	270	26	27	46	174	186
26	102026	21.2	10.7	305	31.5	34	49	181	196
32	102032	31.5	20.65	373	41	40	65	229	246

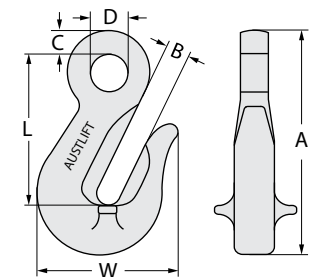

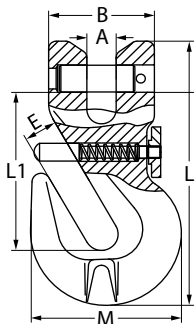

G80 Grab Hook with Safety Pin (Clevis Type) / Shortening Hook

Except for shorting chain slings, GC type clevis grab hook provides extra secure function by added secure pins, which prevents chain to disengage from the hook. Austlift GC grab hooks come with supporting lugs to allow no reduction of the working load limit, also equipped with a safety pin. the clevis is designed for easy connection of chain.

- Marked with sizes, batch number, grade and Austlift branded with manufacture quality mark.
- Batch tested, test certificates available upon request.
- Fatigue tested > 20,000 times.

AS/NZS
3776

Certified

G80
Alloy Steel

Safety Factor
4-1

Size from (mm)
6-16

SIZE (mm)	CODE	WLL (T)	Wt. (kg)	DIMENSIONS (mm)					
				A	B	E	M	L	L1
6	103206	1.12	0.205	8	32	8	43.5	75	40
7/8	103208	2	0.33	9.5	35	11	50	89	43
10	103210	3.2	0.88	12.5	45.5	13	70.5	126.5	74
13	103213	5.3	1.85	15	53	16.5	96	163.5	92
16	103216	8	3.24	18.5	69.5	19	112.5	183.5	98

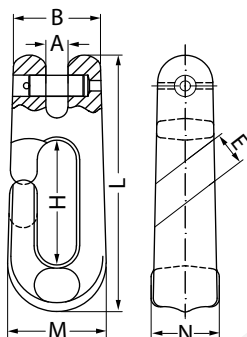

G80 Clutch Choker (Clevis Type, CC)

Austlift clevis choker hooks are a special purpose hook suitable for choke hitch applications. The narrow throat opening prevents the chain from being dislodged. The clevis allows easy connection to chain.

- Marked with sizes, batch number, grade and Austlift branded with manufacture quality mark.
- Batch tested, test certificates available upon request.
- Fatigue tested > 20,000 times.

AS/NZS
3776

Certified

G80
Alloy Steel

Safety Factor
4-1

SIZE (mm)	CODE	WLL (T)	Wt. (kg)	DIMENSIONS (mm)						
				A	B	H	M	N	E	L
8	103420	2	0.68	10.5	41	60	46.5	32	16	123

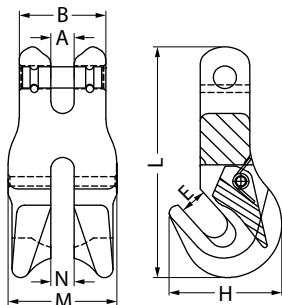

G80 Shortening Clutch (Safety Pin, Locking Clevis Type, CCL)

Austlift CCL type lockable clutches have the advantage of shortening a chain sling without the loss of the working load limit. The clevis allows easy connection to chain with the added safety of a chain locking devise to prevent the chain to dislodge from the hook.

- Marked with sizes, batch number, grade and Austlift branded with manufacture quality mark.
- Safety factor of 4 to 1. Batch tested, test certificates available upon request.
- Fatigue tested > 20,000 times.

AS/NZS
3776

Certified

G80
Alloy Steel

Safety Factor
4-1

SIZE (mm)	CODE	WLL (T)	Wt. (kg)	DIMENSIONS (mm)						
				A	B	E	M	N	H	L
10	102140	3.2	0.99	12	44.5	14	56	12	58	121

G80 Shortening Clutch (Clevis Type, CC)

Austlift CC type lockable clutches have the advantage of shortening a chain sling without loss of the working load limit of the sling. The clevis allows easy connection to chain. Not recommended for use as bottom fitting of sling for back-hooking and reeving applications.

- Marked with sizes, batch number, grade and Austlift branded with manufacture quality mark.
- Batch tested, test certificates available upon request.
- Fatigue tested > 20,000 times.

AS/NZS 3776	Certified	G80 Alloy Steel	Safety Factor 4-1	Size from (mm) 6-22
-----------------------	-----------	--------------------	-----------------------------	-------------------------------

SIZE (mm)	CODE	WLL (T)	Wt. (kg)	DIMENSIONS (mm)									
				A	B	P	C	H	S	L	φ	D	E
6	102106	1.12	0.17	8	44	7.5	7.5	10.3	12	73.5	7.8	30	33
7/8	102108	2	0.37	10.5	61.7	9.5	9.5	14	17	101	9.2	36	45
10	102110	3.2	0.97	12.4	92	13	13	18.4	28	138	13.2	48	55
13	102113	5.3	2.01	16	115	16.5	16.5	22.7	34.5	177	16.2	59	75
16	102116	8	3.32	19.5	143	21	21	28.5	40	220	20	73	93
18/20	102120	12.5	6.2	23	152	23.5	23.5	33.6	46	238	24.3	81	102
22	102122	15	8.5	26	195	25.5	25.5	39	57.5	295	28.1	98	118

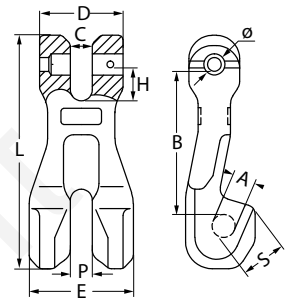

G80 Shortening Clutch (Clevis Type, CC, safety pin)

Austlift CC type lockable clutches have the advantage of shortening a chain sling without loss of the working load limit of the sling. The clevis allows easy connection to chain. Not recommended for use as bottom fitting of sling for back-hooking and reeving applications.

- Marked with sizes, batch number, grade and Austlift branded with manufacture quality mark.
- Batch tested, test certificates available upon request.
- Fatigue tested > 20,000 times.

AS/NZS 3776	Certified	G80 Alloy Steel	Safety Factor 4-1	Size from (mm) 7-13
-----------------------	-----------	--------------------	-----------------------------	-------------------------------

CHAIN SIZE (mm)	CODE	WLL (T)	Wt. (kg)	DIMENSIONS (mm)							
				A	B	C	D	M	N	P	L
7/8	102108S	2	0.41	50	9.5	33	9.5	33	23	9.2	92
10	102110S	3.2	0.75	60	12.5	43	12.5	40	26	13.3	115
13	102113S	5.3	1.67	79	15	55	12	54	34	163	149

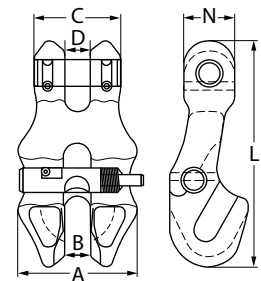



With Forged Steel Latch

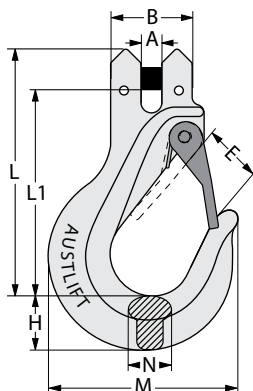

G80 Sling Hook (Clevis Type, SC)

Austlift SC type clevis sling hooks are a general purpose hook suitable for most slinging applications. They come with a cast latch for added safety. Clevis type allows easy connection to chain.

- Marked with chain sizes, batch number, grade and Austlift branded with manufacture quality mark.
- Batch tested, test certificates available upon request.
- Spare safety latch kits & load pins are available.
- Fatigue tested > 20,000 times.

AS/NZS
3776

Certified

G80
Alloy Steel

Safety Factor
4-1

Size from (mm)
6-22

CHAIN SIZE (mm)	CODE	WLL (T)	Wt. (kg)	DIMENSIONS (mm)							
				A	B	E	N	H	L	L1	M
6	102906	1.12	0.32	7.5	32	22	18	20.5	121	85	74
7/8	102908	2	0.48	9	36	25.5	18	23.5	137	94	83
10	102910	3.2	0.95	12	46	34	20	30	175.5	120	107
13	102913	5.3	1.8	15	59	41.5	29.5	37.5	210.5	145	134
16	102916	8	3.4	17.5	70	46	34	42.5	248.6	170	157
18/20	102920	12.5	6	23	80	52	45	54	309	216	189
22	102922	15	10.1	25.5	98	60	48	76	375.5	252	238

Refer to page 40 for G80 spare parts.

G80 Sling Hook (Eye Type, SE)

Austlift SE type eye sling hooks are a general purpose hook suitable for most slinging applications. They come with a heavy duty latch for added safety. Eye type allows easy connection to coup links and can be attached to lifting apparatus.

- Marked with chain sizes, batch number, grade and Austlift branded with manufacture quality mark.
- Batch tested, test certificates available upon request.
- Spare safety latch kits are available.
- Fatigue tested > 20,000 times.

AS/NZS
3776

Certified

G80
Alloy Steel

Safety Factor
4-1

Size from (mm)
6-32



With Forged Steel Latch

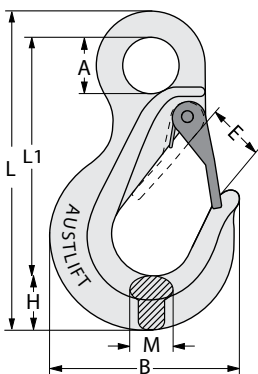

CHAIN SIZE (mm)	CODE	WLL (T)	Wt. (kg)	DIMENSIONS (mm)						
				A	B	E	H	M	L	L1
6	103006	1.1	0.3	20	74	22	20.5	18	122	92
7/8	103008	2	0.5	25.5	83	26	23.5	18	138.5	103
10	103010	3.2	0.8	32.5	107	34	30	20	176.5	133
13	103013	5.3	1.9	39.5	134.3	41	37.5	29.5	218	162
16	103016	8	3.4	50	157.5	44	42.5	34	260	192
18/20	103020	12.5	5.3	60	189	52	53	44	310	230
22	103022	15	8.9	68	239	60	74	50	375.5	269
26	103026	21.2	13.4	75	245	71	83	63	412	303
32	103032	31.5	17	88	250	102	95	76	446	340

Refer to page 40 for G80 spare parts.

G80 Self Locking Hook /Latch Lock (Clevis Type, LC)

Austlift LC type clevis self-locking hook allows the hook to remain open until the load is engaged. The hook will not open until the trigger at the back is pressed. The clevis style allows connection to the chain.

- Marked with chain sizes, batch number, grade and Austlift branded with manufacture quality mark.
- Batch tested, test certificates available upon request.
- Spare trigger kits & load pins are available.
- Fatigue tested > 20,000 times.

AS/NZS 3776	Certified	G80 Alloy Steel	Safety Factor 4-1	Size from (mm) 6-26
-----------------------	-----------	--------------------	-----------------------------	-------------------------------

CHAIN SIZE (mm)	CODE	WLL (T)	Wt. (kg)	DIMENSIONS (mm)					
				B	D	E	L	H	W
6	102206	1.1	0.5	34	32	28	96	20	69
7/8	102208	2	0.8	46	36	36	118.5	24	88
10	102210	3.2	1.5	58	46	45	144	28	107
13	102213	5.3	2.8	69	59	50	181.5	39.5	138
16	102216	8	5.6	86	70	60	216	50.5	182
18/20	102220	12.5	7.5	92	81	72	238	62	204
22	102222	15	11.5	98	98	78	276	65	205
26	102226	21.2	18.5	110	118	106	311	74.5	240

Refer to page 40 for G80 spare parts.

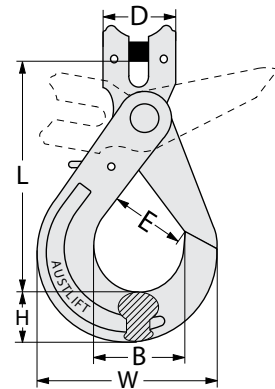

Alloy Chain & Fittings

G80 Self Locking Hook /Latch Lock (Eye Type, LE)

Austlift LE type eye self-locking hook allows the hook to remain open until the load is engaged. The hook will not open until the trigger at the back is pressed. The eye style allows easy connection to chain connectors, shackles and wire rope slings.

- Marked with chain sizes, batch number, grade and Austlift branded with manufacture quality mark.
- Batch tested, test certificates available upon request.
- Spare trigger kits are available.
- Fatigue tested > 20,000 times.

AS/NZS 3776	Certified	G80 Alloy Steel	Safety Factor 4-1	Size from (mm) 6-32
-----------------------	-----------	--------------------	-----------------------------	-------------------------------

CHAIN SIZE (mm)	CODE	WLL (T)	Wt. (kg)	DIMENSIONS (mm)						
				A	B	D	L1	H	M	L
6	102306	1.1	0.5	22	34	32.5	110.5	20	15	110.5
7/8	102308	2	0.8	25	46	37	136	24	20	136
10	102310	3.2	1.5	32	58	46	169	28	26	169
13	102313	5.3	2.8	40	69	56.5	208	40.5	32.5	208
16	102316	8	5.4	50	86	70	254.5	50.5	41	254.5
18/20	102320	12.5	7.5	61	92	87.5	290	62	50	290
22	102322	15	13	72	98	102	320	65	52	320
26	102326	21.2	18.5	80	110	119	362	75	60	362
32	102332	31.5	44.5	105	166	150	472	97	79.5	472

Refer to page 40 for G80 spare parts.

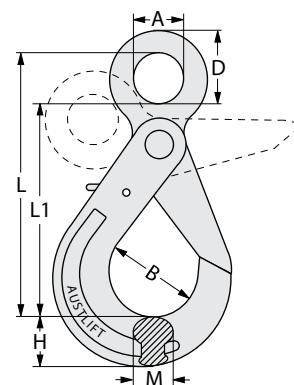



G80 Grip Self Locking Hook (Clevis Type, GLC)

Austlift GLC type eye grip-locking hook allows the hook to remain open until the load is engaged. The hook will not open until the trigger at the back is pressed. Eye style allows easy connection to the chain and also has a unique design to prevent side loading of the latch.

- Marked with chain sizes, batch number, grade and Austlift branded with manufacture quality mark.
- Batch tested, test certificates available upon request.
- Spare trigger kits and load pins are available.
- Fatigue tested > 20,000 times.

AS/NZS 3776	Certified	G80 Alloy Steel	Safety Factor 4-1	Size from (mm) 8-16
-----------------------	-----------	--------------------	-----------------------------	-------------------------------

CHAIN SIZE (mm)	CODE	WLL (T)	Wt. (kg)	DIMENSIONS (mm)						
				A	H	E	L	B	M	L1
8	102508	2	0.6	9.5	21.5	34	150	40	18	111
10	102510	3.2	1.1	12	26.2	44	189	50	22.5	139
13	102513	5.3	2	15	31	54	229	60	29	168
16	102516	8	4.2	18.5	39.5	63	299	72	35	238

Refer to page 40 for G80 spare parts.

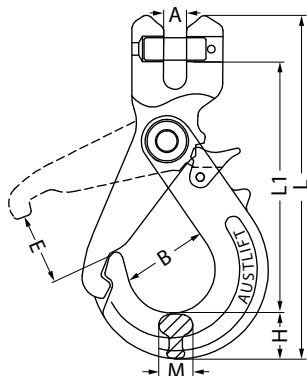

G80 Grip Self Locking Hook (Eye Type, NE)

Austlift NE type eye grip-locking hook allows the hook to remain open until the load is engaged, the hook will not open until the trigger at the back is pressed. Eye style allows easy connection to the chain and also has a unique design to prevent side loading of the latch.

- Marked with chain sizes, batch number, grade and Austlift branded with manufacture quality mark.
- Batch tested, test certificates available upon request.
- Spare trigger kits are available.
- Fatigue tested > 20,000 times.

AS/NZS 3776	Certified	G80 Alloy Steel	Safety Factor 4-1	Size from (mm) 8-16
-----------------------	-----------	--------------------	-----------------------------	-------------------------------

CHAIN SIZE (mm)	CODE	WLL (T)	Wt. (kg)	DIMENSIONS (mm)						
				A	B	E	H	L	M	L1
8	102608	2	0.75	25	40	34	21.5	163	18	131
10	102610	3.2	1.2	32	50	42	26.5	201.5	22.5	161
13	102613	5.3	2	40	60	50	31	243.5	29	195
16	102616	8	4.1	50	70	60	39.5	298	35	238

Refer to page 40 for G80 spare parts.

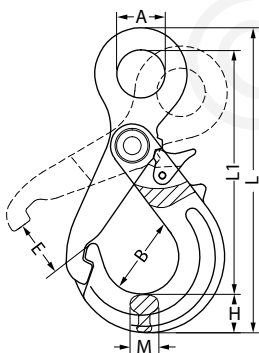

G80 Sling Hook (Swivel Type, SS)

Austlift Grade 80 swivel sling hooks are designed with a ball bearing swivel to allow the hook to swivel thus reducing the twist of a sling. Comes with heavy duty safety latch.

- Marked with chain size, batch number, grade, Austlift branded with manufacture quality mark.
- Batch tested, test certificates available upon request.
- Spare latch kits are available.
- Safety factor of 4 to 1.
- Fatigue tested > 20,000 times.

AS/NZS 3776	Certified	G80 Alloy Steel	Safety Factor 4-1	Size from (mm) 8-16
-----------------------	-----------	--------------------	-----------------------------	-------------------------------

CHAIN SIZE (mm)	CODE	WLL (T)	Wt. (kg)	DIMENSIONS (mm)								
				A	B	C	E	H	M	L1	L	N
8	103308	2	0.95	42	36	13	28.5	23	88	170	208	20
10	103310	3.2	1.71	50	42	15.5	31	29.5	105	204.8	251.7	23
13	103313	5.3	2.97	58	50	17	43.7	38	135	242	303.6	32
16	103316	8	5.3	63.5	61	21.5	45	45.4	161	291.8	360.8	37.5

Refer to page 41 for G80 spare parts.

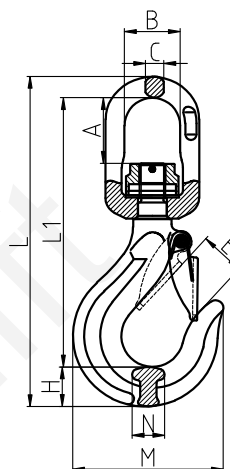

G80 Self Locking Hook (Swivel Type, LS)

Austlift LS type swivel self-locking hooks have a ball bearing swivel to allow the hook to swivel under load thus reducing the twist of a sling. Designed with enlarged eye for passing larger shackles without disassembly of the hook.

- Ball bearing swivel allows the hook to rotate under full load.
- Marked with chain sizes, batch number, grade and Austlift branded with manufacture quality mark.
- Batch tested, test certificates available upon request.
- Spare trigger kits are available.
- Fatigue tested > 20,000 times.

AS/NZS 3776	Certified	G80 Alloy Steel	Safety Factor 4-1	Size from (mm) 6-16
-----------------------	-----------	--------------------	-----------------------------	-------------------------------

CHAIN SIZE (mm)	CODE	WLL (T)	Wt. (kg)	DIMENSIONS (mm)						
				A	B	C	D	E	L	W
6	102406	1.1	0.71	15	32.5	35	11.5	28	164.5	69.7
7/8	102408	2	1.1	20	36	42	13	36.5	204	88
10	102410	3.2	2	26	42	50	15.5	45	240.5	107.7
13	102413	5.3	4.3	32.5	50	60	17	53.6	284.5	137
16	102416	8	7.3	38	61	65	21.5	61	350.5	165.5

Refer to page 40 for G80 spare parts.

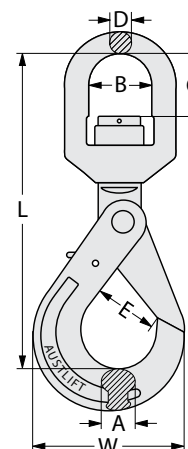

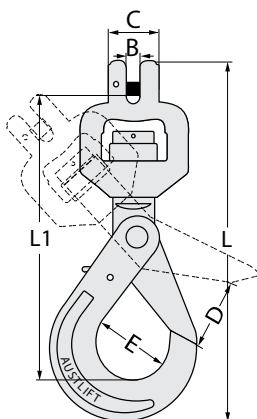

G80 Swivel Self Locking Hook (Clevis Type, LT)

Austlift LT type swivel self-locking hook, clevis type, fitted with a ball bearing which will allow the hook to swivel under load. The clevis type allows the chain to connect directly to the hook which makes the chain sling compact and friendly to use.

- Marked with chain sizes, batch number, grade and Austlift branded with manufacture quality mark.
- Batch tested, test certificates available upon request.
- Spare trigger kits are available.
- Fatigue tested > 20,000 times.

AS/NZS
3776

Certified

G80
Alloy Steel

Safety Factor
4-1

Size from (mm)
6-8

CHAIN SIZE (mm)	CODE	WLL (T)	Wt. (kg)	DIMENSIONS (mm)					
				B	C	D	E	L	L1
6	103106	1.12	0.73	8	32	28	34	180	139
8	103108	2	1.3	9.5	37	34	46	227.5	189

G80 Grip Self Locking Hook (Swivel Type, NS)

Austlift NS type swivel self-locking hooks are designed with a plain bush swivel to allow the hook to reduce twist under load. They also have a unique design to prevent side loading of the latch.

- Marked with chain size, batch number, grade, Austlift branded with manufacture quality mark.
- Batch tested, test certificates available upon request.
- Safety factor of 4 to 1.
- Spare trigger kits are available.
- Fatigue tested > 20,000 times.

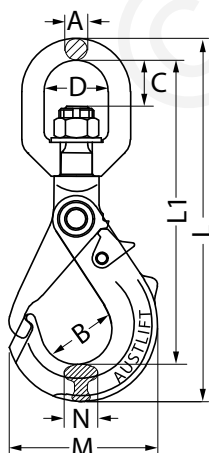

AS/NZS
3776

Certified

G80
Alloy Steel

Safety Factor
4-1

Size from (mm)
8-13

CHAIN SIZE (mm)	CODE	WLL (T)	Wt. (kg)	DIMENSIONS (mm)						
				A	B	C	D	N	M	L1
8	102708	2	0.97	12.5	40	26	35.5	18	83	216
10	102710	3.2	1.83	15	50	33	42	22.5	101	254
13	102713	5.3	3.3	18	60	39	50	29	121	300

Refer to page 40 for G80 spare parts.

G80 Clevis Shackle

Austlift G80 clevis shackle, has been designed to use as a terminal end connecting directing to the chain at the clevis end.

- Marked with chain size, batch number, grade, Austlift branded with manufacture quality mark.
- Batch tested, test certificates available upon request.
- Spare latch kits are available.
- Safety factor 4 to 1.
- Fatigue tested > 20,000 times.

AS/NZS
3776

Certified

G80
Alloy Steel

Safety Factor
4-1

Size from (mm)
7-16

CHAIN SIZE (mm)	CODE	WLL (T)	Wt. (kg)	DIMENSIONS (mm)							
				A	B	C	D	E	F	L	Φ
7/8	104308	2	0.5	31	51	36.3	9	20	36	103.5	16
10	104310	3.2	0.9	34	62	48	12.5	25	46.5	130.7	20
13	104313	5.3	1.6	49	83	64	15	31	59	160	22
16	104316	8	2.7	58	95	69.5	19	40	70	190.5	28.5

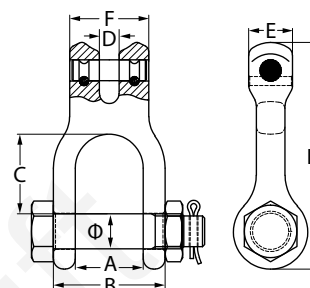

Drum Hook (Eye Type)

Austlift eye drum hooks are used in pairs. They are designed to lift and transport steel drums with the lid in place.

- Marked with chain size, batch number, WLL, grade, Austlift branded with manufacture quality mark.
- Drop forged and heat treated.
- Individually proof tested at 2 x WLL.
- Batch tested, test certificates available upon request.

Certified

G80
Alloy Steel

CODE	WLL (T)	Wt. (kg)	DIMENSIONS (mm)				
			C	C1	D	W	W1
104401	1t/pair	0.812	109	118.5	38	59	60

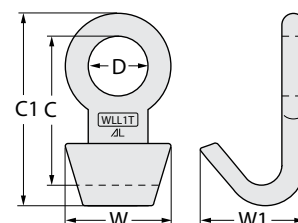

Elephant Foot

Austlift elephants foot are commonly used as a lashing point to secure trucks, cars, container chassis and other vehicles on ships and barges in the marine industry.

- Marked with batch number, WLL, grade, Austlift branded with manufacture quality mark.
- Lashing capacity of 5000kg with a minimum break load of 20 tonne.
- Batch tested, test certificates available upon request.

Certified

5000kg
Lashing
Capacity

20t
Min
Break Load

CODE	TYPE	WLL (T)	Wt. (kg)	DIMENSIONS(mm)				
				A	B	D	G	L
106100	Eye	5	0.74	28	60	16	52.5	116
106200	Clevis	5	0.99	16	46	-	59	130

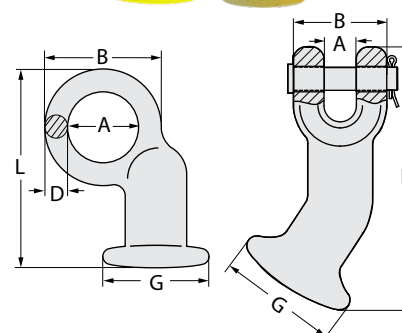

G80 Foundry Hook

Austlift foundry hooks are a special purpose hook with large mouth opening. The clevis allows easy connection to the chain. Suitable for lifting pipes and foundry applications.

- Marked with chain size, batch number, grade, Austlift branded with manufacture quality mark.
- Batch tested, test certificates available upon request.
- Safety factor 4 to 1.
- Fatigue tested > 20,000 times.

AS/NZS
3776

Certified

G80
Alloy Steel

Safety Factor
4-1

Foundry Hook (Clevis Type, FC)

CHAIN SIZE (mm)	CODE	WLL (T)	Wt. (kg)	DIMENSIONS (mm)					
				A	E	M	N	L	L1
7/8	107008	2	1.1	9.5	63.4	128	18	161	110
10	107010	3.2	2.5	13	76.9	156	32	199	137

Foundry Hook (Eye Type, FE)

CHAIN SIZE (mm)	CODE	WLL (T)	Wt. (kg)	DIMENSIONS (mm)							
				A	E	φ	H	M	N	L	L1
7/8	107108	2	1.09	39	63.5	18	31	120	25.4	163	121

Container Hook

Austlift eye type container hooks are a special purpose hook suitable for lifting containers by connection to twist lock pocket. The large diameter eye allows most hooks sizes to fit. There is left and right hand configurations and a straight configuration available.

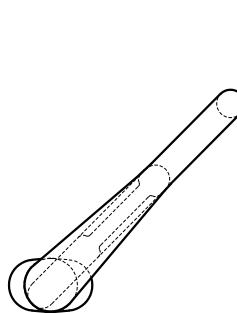
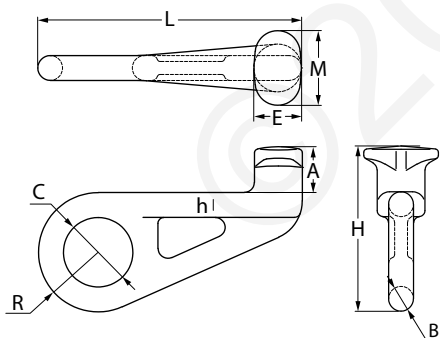

104412
Left Hand, 45°

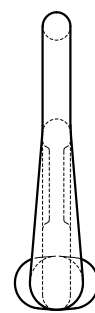

104410
Straight, 90°

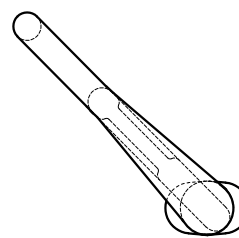

104413
Right Hand, 45°



- Marked with chain size, batch number, grade, Austlift branded with manufacture quality mark.
- Batch tested, test certificates available upon request.
- Spec sheet available on the website.

CODE	TYPE	CHAIN SIZE (mm)		WLL (T)	Wt. (kg)
		G80	G100		
104410	Straight	20	19	12.5	4
104412	LH 45°	20	19	12.5	4
104413	RH 45°	20	19	12.5	4

DIMENSIONS(mm)								
A	B	C	E	R	M	L	H	h
46	25	70	48	60	75	265	166	25

G80 Weld on Point /Lifting Lugs

Austlift WP type weld on lifting points can be welded on any carbon steel surface as a lifting point, or to be used as a fixed anchor point for spreader beam attachment. Can also be used as an anchor point for load restraint applications.

- Marked with chain size, batch number, grade, WLL, Austlift branded with manufacture quality mark.
- Batch tested, test certificates available upon request.
- Welding instructions supplied with each unit.
- Fatigue tested > 20,000 times.



Weld on Point (Type WP)

WLL (T)	CODE	Wt. (kg)	DIMENSIONS (mm)				
			B	D	C	C1	W
1	104001	0.55	55	14	35	95.7	50
3	104003	0.9	64	17	50	99	58
5	104005	1.8	70	22	70	137	64
8	104008	2.5	69	26.5	86	144	66.5

Weld on Point Compact (Type WPC)

WLL (T)	CODE	Wt. (kg)	DIMENSIONS (mm)				
			B	D	C	C1	W
1	103901	0.4	40	13	40.5	70.5	37
2	103902	0.48	42	14	48.5	81.5	40
4	103904	0.69	46	17	49	84	42.5
6	103906	1.5	55	22	57	104.5	51
9	103909	2.5	70	26	67.5	124.5	66
15	103915	5.79	98	34	94	155	90

Universal Weld on Hook (Type WH, with latch)

Austlift WH type weld-on hooks are a versatile hook for lifting and spreader beam attachment applications, they can also be used for any fixed anchor point after welding the hook on.

- Marked with chain size, batch number, grade, WLL, Austlift branded with manufacture quality mark.
- Batch tested, test certificates available upon request.
- Welding instructions supplied with each unit.
- Spare safety latches are available.



WLL (T)	CODE	Wt. (kg)	DIMENSIONS (mm)			
			B	E	L	F
1.1	103801	0.32	53	18	80	18
2	103802	0.55	63.5	26	112	34
3.2	103803	0.87	75	30	127.5	36
5.3	103805	1.75	92.5	35	160	43.5
8	103808	3.2	106	40	180	51
12.5	103812	6.16	140	51	236	58

Refer to page 42 for Welding Instructions.

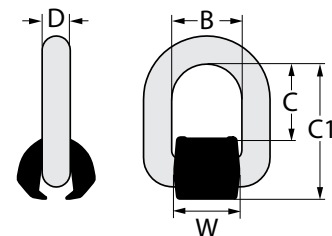
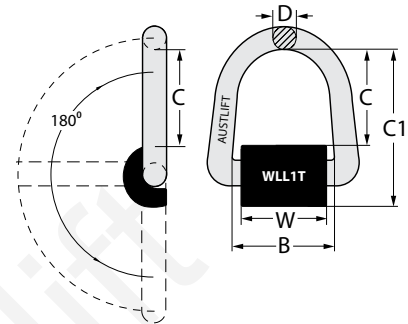

With Latch

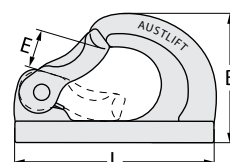
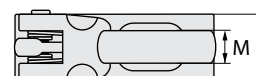



International Hoisting Hook (Eye type)

Austlift international eye hoist hooks with safety latch are commonly used for general lifting applications such as wire rope slings or winch cables.

- Marked with the working load limit and alloy. Austlift branded with manufacture quality mark.
- Batch tested, test certificates available upon request.
- Manufactured from forged alloy steel quenched and tempered.
- Spare Latch kits are available.

AS/NZS 3777	Certified	Alloy Steel	Safety Factor 4-1	Capacities 1-11t
----------------	-----------	----------------	----------------------	---------------------

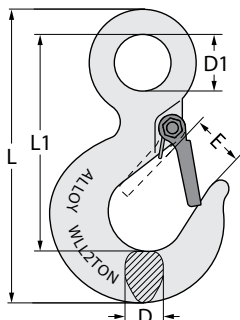

WLL (T)	CODE	Wt. (kg)	DIMENSIONS (mm)				
			L1	L	D	D1	E
1	104510	0.28	82	110	16	19	22
1.5	104515	0.4	93.5	125	17.5	23	23
2	104520	0.65	103	140.5	21	28	24
3	104530	0.94	119	162	23	31	27.5
5	104545	1.95	146	201	30	39	33
7	104570	3.77	186.5	256	38	51	40
11	104599	6.80	231.5	317	46	62	51

Refer to page 41 for Hoisting Hook spare parts.



International Hoisting Hook (Swivel type)

Austlift international swivel eye hoist hooks with safety latch are commonly used for general lifting and can also be used in towing applications.

- Marked with the working load limit and alloy. Austlift branded with manufacture quality mark.
- Batch tested, test certificates available upon request.
- Manufactured from forged alloy steel quenched and tempered.
- Spare Latch kits are available.

AS/NZS 3777	Certified	Alloy Steel	Safety Factor 4-1	Capacities 1-11t
----------------	-----------	----------------	----------------------	---------------------

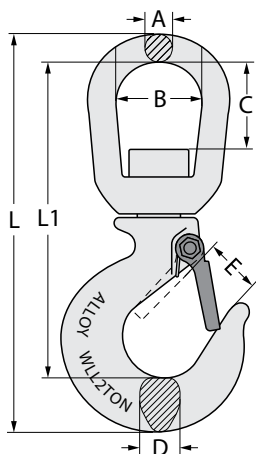

WLL (T)	CODE	Wt. (kg)	DIMENSIONS (mm)						
			A	B	C	L	L1	D	E
1	105010	0.37	9	32	22.5	136	108	16	17
1.5	105015	0.64	12	37.5	29.5	163.5	133.5	16	22.5
2	105020	1.05	15.8	42.5	33	192	150.5	17.5	26
3	105030	1.24	15.8	42.5	33	209	163	23	26
5	105045	2.25	18	48	39	246	191	31	32.5
7	105070	4.66	25	64	53	313	243.5	34	43
11	105099	7.4	28.5	70	53	364	277	41.5	49.5

*** Special Note:** This hook is a positioning device & is not intended to rotate under load. Use in salt water requires the shank & nut to be inspected regularly.

Refer to page 41 for Hoisting Hook spare parts.

Swivel Panel Lifter

Concrete Lifter/ Clutch/ Swift Lift

Austlift panel lifters are a versatile lifting product for lifting pre-cast concrete products such as construction panels, pipes, columns etc.

- Marked with the working load limit, serial number and Austlift branded.
- Individually proof tested at 2 x WLL.

* Panel lifters should be checked regularly. Follow the regularly check table.

AS/NZS
3850

Certified

G80
Alloy Steel

Safety Factor
5-1

Capacities
1-32t

WLL (T)	CODE	Wt. (kg)	DIMENSIONS (mm)						
			C	D	E	F	H	M	L
1.3	141001	1	80.4	70.5	45	73	157	11.5	181
2.5	141002	1.5	99	85	57	88	190	16	220
5	141005	3.3	133	88	69	110	233	22	271
10	141010	10	176	116	83	161	336.5	30	386
20	141020	20.37	228	133.5	107.5	182	437	42	497
32	141030	47	325	188	160	272	555	52	760

WARNING ANCHOR AND CLUTCH MUST BE MATCHED

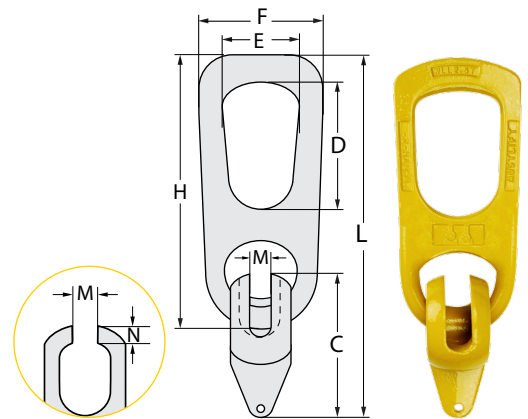

Check Table*		
WLL (T)	M max (mm)	N min (mm)
1.3	13	5.5
2.5	18	5.5
5	25	8
10	32	12
20	46	18
32	58	24

Ring Panel Lifter

Austlift ring clutch is a lifting device which is used together with Austlift cast plate anchors. Ring clutches are used for lifting large precast concrete panels. The ring head of the clutch has a locking bolt, which helps to safely lock into plate anchors while the concrete panels are in the lifting process. Austlift ring clutches are available in a variety of lifting capacities to suite to your work.

- All clutches are proof loaded.
- Batch tested, test certificates available with each unit.

* Panel lifters should be checked regularly. Follow the regularly check table.

AS/NZS
3850

Certified

Safety Factor
5-1

Capacities
2.5-10t

WLL (T)	CODE	Wt. (kg)	DIMENSIONS (mm)					
			A	B	C	D	E	L
0.7-2.5	141102	1.6	52	92	70	74	30	285
3.0-5.0	141105	3.5	71	120	86	98	36	285
5.3-10.0	141110	9	90	156	112	139	50	353

WARNING ANCHOR AND CLUTCH MUST BE MATCHED

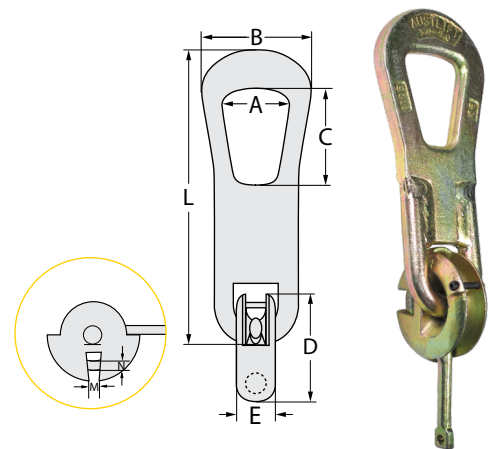

Regularly Check Table*		
WLL (T)	M max (mm)	N min (mm)
0.7-2.5	13	12
3.0-5.0	19.5	15.5
5.3-10.0	23.5	22.5

Spread Anchor

Austlift Spread Anchors are produced from high strength low alloy steel plates. Austlift Spread Anchors have high tensile strength and good elongation. Due to special material, Austlift Spread Anchors has high impact test value and can be used under low temperature circumstances (up to -20°C).

- Upper hole of Spread Anchor is used for connection with Austlift Ring Clutch. Bottom hole is used for reinforcement.
- Due to reinforcement, force is transmitted to precast concrete element.
- Austlift Spread Anchors can be used for lifting of precast concrete girders, plates other elements.

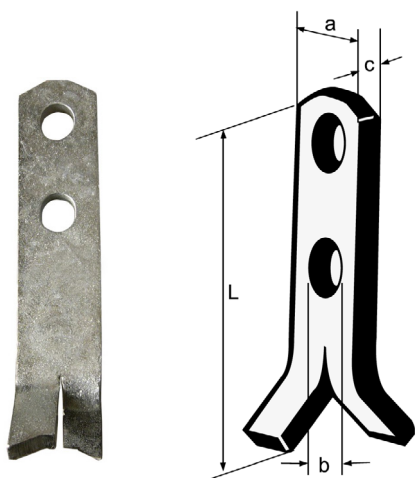

WLL (T)	CODE	Wt. (kg)	DIMENSIONS (mm)			
			a	b	c	L
0.7	730711	0.113	30	14	5	110
1.4	731411	0.136	30	14	6	110
1.4	731416	0.20	30	14	6	160
2.5	732515	0.312	30	14	10	150
2.5	732520	0.428	30	14	10	200
2.5	732525	0.514	30	14	10	250
3	733016	0.439	40	18	10	160
3	733020	0.523	40	18	10	200
3	733028	0.823	40	18	10	280
4	734018	0.60	40	18	12	180
4	734024	0.824	40	18	12	240
4	734032	1.1	40	18	12	320
5	735018	0.765	40	18	15	180
5	735024	1.0	40	18	15	240
5	735040	1.7	40	18	15	400
7.5	737526	1.7	60	26	16	260
7.5	737530	2.0	60	26	16	300
7.5	737542	2.9	60	26	16	420
10	739030	2.5	60	26	20	300
10	739037	3.1	60	26	20	370
10	739052	4.5	60	26	20	520

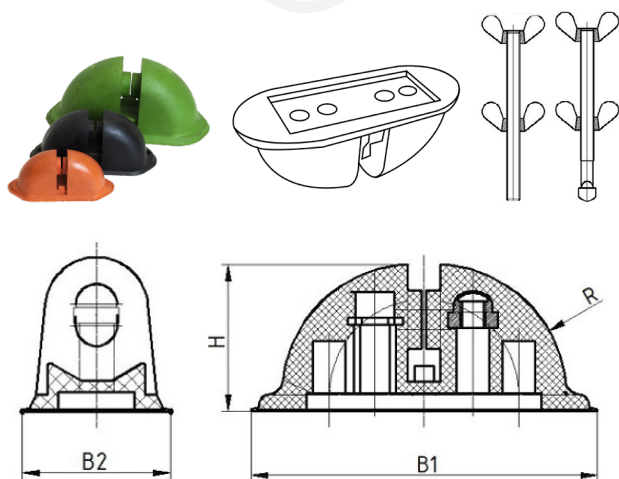

Recess Former Kit

Austlift recess former kits are special lifting accessories which used together with an Austlift lifting stud and a Austlift lifting clutch. They are needed to create a hole in the concrete element, when lifting stud is mounted to the concrete. After concrete is stable, Austlift recess former is taken out and lifting clutch is used to lift the precast concrete element.

Austlift recess formers are made from rubber. Each size has a different colour, which makes identification of load class easier.

WLL (T)	CODE	COLOR	Wt. (kg)	DIMENSIONS (mm)			
				B1	B2	R	H
2.5	141132	Orange	0.13	106	43	40	45
5	141135	Black	0.24	134	55	56	59
10	141137	Green	0.66	188	78	80	81

Swivel (Bow/Clevis Type)

Austlift swivel type bow & clevis are commonly used for marine and fishing applications. Manufactured from high tensile steel, quenched, tempered and hot dipped galvanised.

- Manufactured to ASME B30.26 specifications.
- Ultimate load is 5 times the working load limit.
- Batch tested, test certificates available upon request.

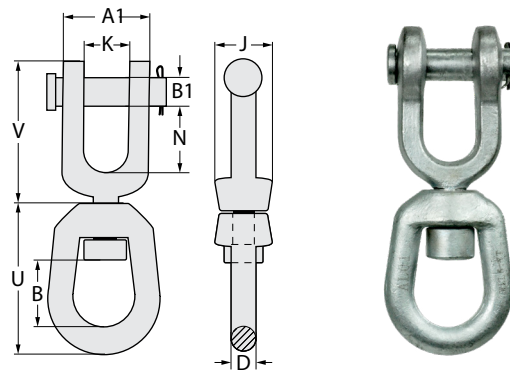

SIZE (mm)	CODE	WLL (T)	Wt. (kg)	DIMENSIONS (mm)								
				A1	B1	B	D	J	K	N	U	V
6	109206*	0.39	0.1	34	6	17.5	6	17.5	11.9	22.4	42.9	42.9
8	109208*	0.57	0.15	39	8	20.6	8	20.6	12.7	22.4	52	46
10	109210	1.02	0.3	47	10	23.9	10	25.4	16	26.9	63.5	57
12	109212	1.63	0.61	54.8	12.8	33.3	12	33.3	18.1	33.3	81	73
16	109216	2.36	1.12	78	17.5	39.5	16	41.4	23.9	38.1	98.5	87
20	109220	3.27	1.76	89	18	44.5	20	47.8	28.7	44.5	109	102
25	109225	5.67	4.46	116	29	58.5	25	67	44.5	71.5	146	151

* 6mm & 8mm limited stock available.

WARNING

Note: Swivels are intended as positioning devices and are not to rotate under load. Applications in corrosive environment requires shank and nut inspection and lubrication regularly.

Swivel (Eye/Bow Type)

Austlift swivel type eye & bow are commonly used for marine and fishing applications. Manufactured from high tensile steel, quenched, tempered and hot dipped galvanised.

- Manufactured to ASME B30.26 specifications.
- Ultimate load is 5 times the working load limit.
- Batch tested, test certificates available upon request.

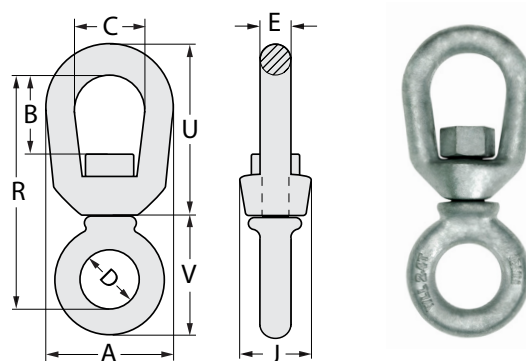

SIZE (mm)	CODE	WLL (T)	Wt. (kg)	DIMENSIONS (mm)								
				A	B	C	D	E	J	R	U	V
6	109006*	0.39	0.06	31.8	17.5	19.1	15.7	6	17.5	57	42.9	31.8
8	109008*	0.57	0.11	41.4	20.6	25.4	19.1	8	20.6	69	52.5	37.3
10	109010*	1.02	0.24	51	23.9	31.8	25.4	10	25.4	87	63.5	47.8
12	109012	1.63	0.51	63.5	33.3	38.1	31.8	12	33.3	108	81	62
16	109016	2.36	0.95	76.2	39.6	44.5	38.1	16	38.1	130	98.5	74.5
20	109020	3.27	1.4	89	44.5	51	44.5	20	47.8	147	125	88
25	109025	5.72	3.2	92	56	62	52.5	25	56.3	156	134	95

* 6mm, 8mm & 10mm limited stock available.

WARNING

Note: Swivels are intended as positioning devices and are not to rotate under load. Applications in corrosive environment requires shank and nut inspection and lubrication regularly.

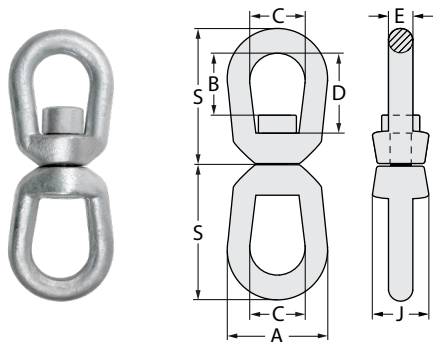

Swivel (Bow/Bow Type)

Austlift swivel type bow & bow are commonly used for marine and fishing applications. Manufactured from high tensile steel, quenched, tempered and hot dipped galvanised.

- Ultimate load is 5 times the working load limit.
- Batch tested, test certificates available upon request.



SIZE (mm)	CODE	WLL (T)	Wt. (kg)	DIMENSIONS (mm)						
				A	B	C	D	E	S	J
6	109106*	0.39	0.21	31.8	17.5	19.1	26.9	6	42.9	17.5
8	109108*	0.57	0.39	41.4	20.6	25.4	31.8	8	52	20.6
10	109110*	1.02	0.71	51	23.9	31.8	38.1	10	63.5	25.4
12	109112	1.63	1.32	63.5	33.3	38.1	51	12	81	33.3
16	109116	2.36	2.48	76	39.5	44.5	60.5	16	98.5	38.1
20	109120	3.27	4.02	89	44.5	51	67	20	109	47.8
25	109125	5.67	6.25	114	58.5	63.5	89	25	146	60.5

* 6mm, 8mm & 10mm limited stock available.

WARNING

Note: Swivels are intended as positioning devices and are not to rotate under load. Applications in corrosive environment requires shank and nut inspection and lubrication regularly.



Chain Sling WLL Tag

Austlift safe work load tags are essential to identify a chain sling's lifting capacity together with other relevant information.

- Tags for single and multi lifting are available.
- Manufactured in 304 stainless steel material.



TYPE	CODE
Single Leg Chain Sling Tag	100100
Multi Leg Chain Sling Tag	100101
Blank Tag	100103

SPARE PARTS FOR G80 FITTING



Pin for Clevis Hook

SIZE (mm)	CODE	CLEVIS HOOK			
		SLING HOOK	SELF LOCK HOOK	SHACKLE	GRAB HOOK
6	030306SP	SC-6-8	LC-6-8	-	GC-6-8
7/8	030308SP	SC-7/8-8	LC-7/8-8	104308	GC-7/8-8
10	030310SP	SC-10-8	LC-10-8	104310	GC-10-8
13	030313SP	SC-13-8	LC-13-8	104313	GC-13-8
16	030316SP	SC-16-8	LC-16-8	104316	GC-16-8
20	030320SP	SC-20-8	LC-20-8	-	GC-20-8
22	030322SP	SC-22-8	LC-22-8	-	GC-22-8
26	030326SP	SC-26-8	LC-26-8	-	GC-26-8



Safety Latch for Sling Hook



SIZE (mm)	CODE	SLING HOOK	
		EYE	CLEVIS
6	030006SP	SE-6-8	SC-6-8
7/8	030008SP	SE-7/8-8	SC-7/8-8
10	030010SP	SE-10-8	SC-10-8
13	030013SP	SE-13-8	SC-13-8
16	030016SP	SE-16-8	SC-16-8
20	030020SP	SE-20-8	SC-20-8
22	030022SP	SE-22-8	SC-22-8
26	030026SP	SE-26-8	SC-26-8
32	030032SP	SE-32-8	SC-32-8



Pin for Clevis Hook

SIZE (mm)	CODE	CLEVIS HOOK			
		FOUNDRY HOOK	SAFETY HOOK SWIVEL	GRIP HOOK	GRAB HOOK
6	030336SP	-	LT-6-8	-	GCS-6-8
7/8	030338SP	FC-7/8-8	LT-7/8-8	GLC-7/8-8	GCS-7/8-8
10	030340SP	FC-10-8	-	GLC-10-8	GCS-10-8
13	030343SP	-	-	GLC-13-8	GCS-13-8
16	030346SP	-	-	GLC-16-8	GCS-16-8



Safety Trigger Kit for Self Locking Hook (Current Model)



SIZE (mm)	CODE	GRIP SELF LOCKING HOOK		
		EYE	CLEVIS	SWIVEL
7/8	030108SPN	LE	LC	LS
10	030110SPN	LE	LC	LS



Safety Trigger Kit for Self Locking Hook (Pre-2020 Model)



SIZE (mm)	CODE	SELF LOCKING HOOK		
		EYE	CLEVIS	SWIVEL
6	030106SP	LE	LC	LS
7/8	030108SP	LE	LC	LS
10	030110SP	LE	LC	LS
13	030113SP	LE	LC	LS
16	030116SP	LE	LC	LS
20	030120SP	LE	LC	LS
22	030122SP	LE	LC	LS
26	030126SP	LE	LC	LS
32	030132SP	LE	LC	LS
SIZE (mm)	CODE	GRIP SELF LOCKING HOOK		
		EYE	CLEVIS	SWIVEL
7/8	030808SP	NE	GLC	NS
10	030810SP	NE	GLC	NS
13	030811SP	NE	GLC	NS
16	030812SP	NE	GLC	NS



Safety Latch Kit for Weld on Hook

WLL (T)	CODE	WELD ON HOOK
1.1	030201SP	WH-1-8
2	030202SP	WH-2-8
3.2	030203SP	WH-3-8
5.3	030205SP	WH-5-8
8	030208SP	WH-8-8

SPARE PARTS FOR G80 FITTING

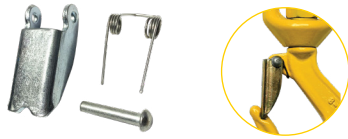

Safety Latch for Swivel Sling Hook

SIZE (mm)	CODE	SLING HOOK
		SWIVEL
8	030908SP	SS-7/8-8
10	030910SP	SS-10-8
13	030913SP	SS-13-8
16	030916SP	SS-16-8



Pin and Stud for Chain Connector

SIZE (mm)	CODE	CHAIN CONNECTOR
6	030506SP	CL-6-8
7/8	030508SP	CL-7/8-8
10	030510SP	CL-10-8
13	030513SP	CL-13-8
16	030516SP	CL-16-8
20	030520SP	CL-20-8
22	030522SP	CL-22-8
26	030526SP	CL-26-8
32	030532SP	CL-32-8

SPARE PARTS FOR HOIST HOOK



Safety Latch for Hoist Hook

WLL (T)	CODE	HOIST HOOK	
		EYE	SWIVEL
1	030210SP	104510	105010
1.5	030215SP	104515	105015
2	030220SP	104520	105020
3	030230SP	104530	105030
4.5	030245SP	104545	105045
7	030270SP	104570	105070
11	030290SP	104599	105099

ADVICE

Safe Use

- Keep a register of all slings in use.
- Never lift with a twisted chain.
- Chain slings should be shortened with a shortening hook, never by knotting.
- Protect the chain against sharp edges by proper padding.
- Never point load a hook - The load should always sit correctly in the bowl of the hook.
- Always use the correct size sling for the load allowing for the included angle and the possibility of unequal loading.
- The master link should always be able to move freely on the crane hook.
- Avoid snatch-loading at all times.

Assymetric Loading Conditions

For unequally loaded chain slings we recommend that the working load limits be determined as follows:

- 2-leg slings calculated as the corresponding 1-leg slings
- 3-leg and 4 leg slings calculated as the corresponding 2-leg slings.

Acidic Chemicals & Atmospheres

Chain and components Grade G80 must not be used in acidic conditions or corrosive environment.

Note: Hot dip galvanising or plating is not allowed outside the control of the chain manufacturer.

Use of a grab hook 6mm to 26mm does not reduce the WLL of a sling, thanks to supporting lugs on either side of hook to prevent chain link deformation. Use of a shortening hook 32mm will reduce a sling to 25% of its WLL.

Maintenance

Periodic examinations must be carried out by a competent person at least every 6 months or more frequently according to statutory regulations, type of use, past experience and harsh environment.

1. Chains with bent links or with cracks or gouges in the link should be replaced. As should deformed components such as bent master links, opened up hooks and any fitting showing signs of damage.
2. The wear and tear of the chain and components shall in no place exceed 10% - is defined as the reduction for the mean diameter of the material measured in two directions.
3. Overloaded chain slings must be taken out of service. permanent elongation of chain is max 5% and permanent increase of hook opening max 10%.

Extreme Temperature Conditions

For G100 and G80 chain slings the in-service temperature of the whole or part of the chain sling affects the working load limit as follows:

TEMPERATURE OF SLING	ALLOY PRODUCTS REDUCTION IN WORKING LOAD LIMIT
-40° to 200°C	None
200° to 300°C	10%
300° to 400°C	25%
Over 400°	DO NOT USE

All Austlift alloy products meet the requirements of AS2321 for chain and AS3776 for fittings.

All Austlift chain and fittings are manufactured to Lloyds register quality assurance.

EN ISO 9001:9004 which is the direct equivalent to AS3901.

WELDING INSTRUCTIONS

For Austlift weld on hook (WH) & lifting point (WP)

TEMPERATURES	WLL REDUCTION
-40° to 200°C	None
200° to 300°C	10%
300° to 400°C	25%
Over 400°C	Do not use

Guide for electrodes to use

AS 1553.1: E4818 Grade 4-6
AWS A5.1: E7018-1 or equivalent
BS 639: 51 56B 110 26(H)
DIN 1913: E 51 54 B10
ISO 2560: E 51 5 B 120 20H

WARNING

This chart provides the basic information of size of supporting material. The thicker the material, the bigger the plate that can be used. Please contact your nearest distributor for further information.

CODE	Max. WIDTH OF PLATE (mm)	Max. HEIGHT OF PLATE (mm)	Min. THICKNESS OF PLATE (mm)	Min. THICKNESS OF FILLET WELD (mm)	IMAGE
103801	800	800	11	11	
103802	1060	1060	14	14	
103803	1290	1290	19	19	
103805	1560	1560	24	24	
103808	1780	1780	30	30	
103812	1930	1930	35	35	
104001	800	800	6	12	
104003	1290	1290	10	15	
104005	1560	1560	12	22	
104008	1780	1780	14	24	

General

To properly install and weld an Austlift weld-on hook and lifting point it requires a competent person who has experience in the lifting or load restraint industry and in addition requires a qualified, experienced welder to perform the welding job.

Positioning

The following precaution should be observed when you are positioning the fitting.

- This product shall be in the correct position to withstand all angles of the load strain.
- Positioned so that it cannot cause any damage to the product or other parts of the equipment to which it is welded.
- The use of this product can not cause any injury to persons operating equipment.
- Cannot cause any unintentional unhooking when in use.
- Placed in a position so that it can be easily hooked and unhooked safely.
- The product does not hinder any operation e.g. lifting or excavation.
- If this product is used for an excavator it should be welded in the middle upper part of the bucket.
- A qualified person shall certify that the product can be taken into service.

Warning

UNDER NO CIRCUMSTANCES SHOULD YOU EXCEED THE WORK LOAD LIMIT OF THIS PRODUCT

- Do not use these products in an acidic environment.
- Contact your supplier for advice if these products are used in a corrosive environment.
- Do not treat this product with electric or hot dip galvanising at any time.

Lifting

- When handling loads this must be done smoothly and free from jerking motions.
- Never apply the load directly on the latch or on the tip of the hook.
- Side loading is not permitted for weld on Hooks.
- When lifting the load you should use the bottom part of the hook and the latch should be in closed position.

WARNING

Components should be taken out of service immediately if any of the above faults are detected.

Welding

1. Material

Take note of the tensile strength of supporting material to weld to. Use the guide on page 44 to determine the correct height, length and thickness to ensure the right strength of support material in mild steel.

2. Electrodes

Any welding of this product should be carried out by a qualified person. Electrodes or wire shall be for use with low alloy or non-alloy steel.

Electrodes must be free from any moisture and wire free from rust before any kind of welding is to be carried out.

Recommended welding electrode; AS/NZS 1553, ISO 2560, DIN EN 499 BS EN 499 or equivalent.

3. Welding

Make sure all areas to be welded are cleaned and free from rust, paint, dirt, etc.

- The surface to be welded should be preheated. Ensure correct welding procedures are adopted in this case.
- First position the hook or lifting point then tack weld all four corners.
- Continuously weld the bottom joint and fill weld all around. Make sure the lifting point is welded to the ends of the bow.
- To reach maximum penetration, ensure that the welding torch or electrode is held at a 45° degree angle.
- It is recommended that you weld the top joint of the hook with a larger electrode.
- Ensure that there are no cracks or pores in the welds or welded area.
- Allow the weld to cool at room temperature. Do not use water or a fan to cool the weld.
- All bare and unwelded areas should be painted to avoid rust.
- All moving parts should be well lubricated after welding.
- MIG welding has less penetration than others and it is not recommended for welding G80 components.

Inspection

A qualified person should inspect components regularly to maintain safe operating procedures.

- Check for bends, nicks, wear, stretching or elongation of the components.
- Check for any signs of corrosion.
- Check for any scoring or cracks on all welds and components.
- Check the latch, rivet and spring. Latch shall be working properly.

WELDING INSTRUCTIONS

1 POSITION

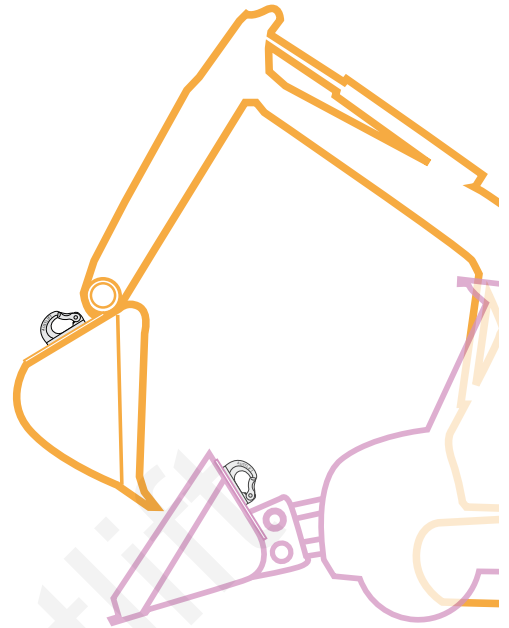
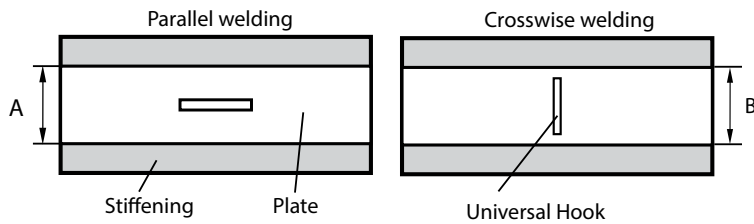

Alloy Chain & Fittings

2 WELDING

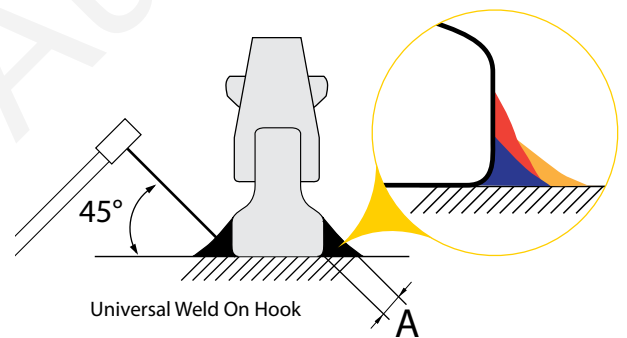
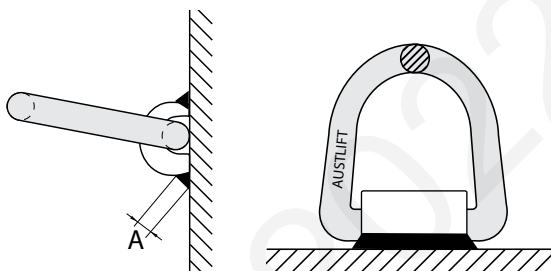

Triple weld runs may have to be conducted in order to reach minimum weld fillet area (A).

3 LOADING

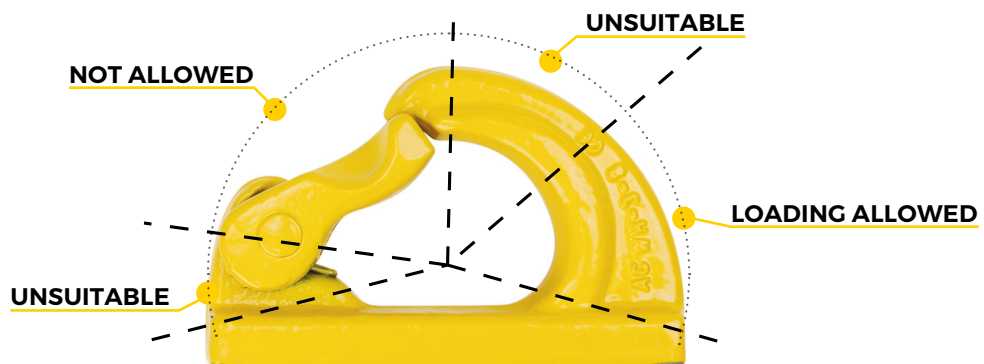

SWIVEL PANEL LIFTER INSTRUCTIONS

Coupling

1. Check the load duty of the Anchor.
2. To connect the clutch to the anchor, the sphere is pushed with its opening facing downwards over the anchor.
3. The tongue of the sphere is then turned downwards to close around the anchor.

Lifting

1. The clutch is suitable for axial loads and pitching. The unit can also be swivelled on the clutch when pitching the unit, the tongue must be in the closed position as shown.
2. Due to the counterweight of the tongue the sphere is always kept in the correct position, even if the load is released.
3. Turning the clutch Head under load is limited by friction. Small quantities of grease are permitted if necessary.

Release

1. When the load is taken off, release the clutch by turning the sphere with the tongue as shown.
2. Lift the clutch away and do not let it dangle over the anchor.

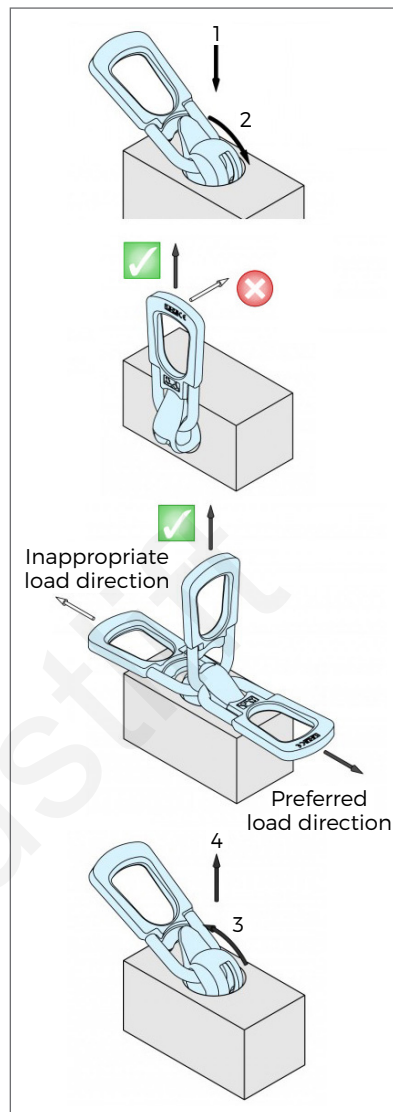

RECESS FORMER INSTRUCTIONS

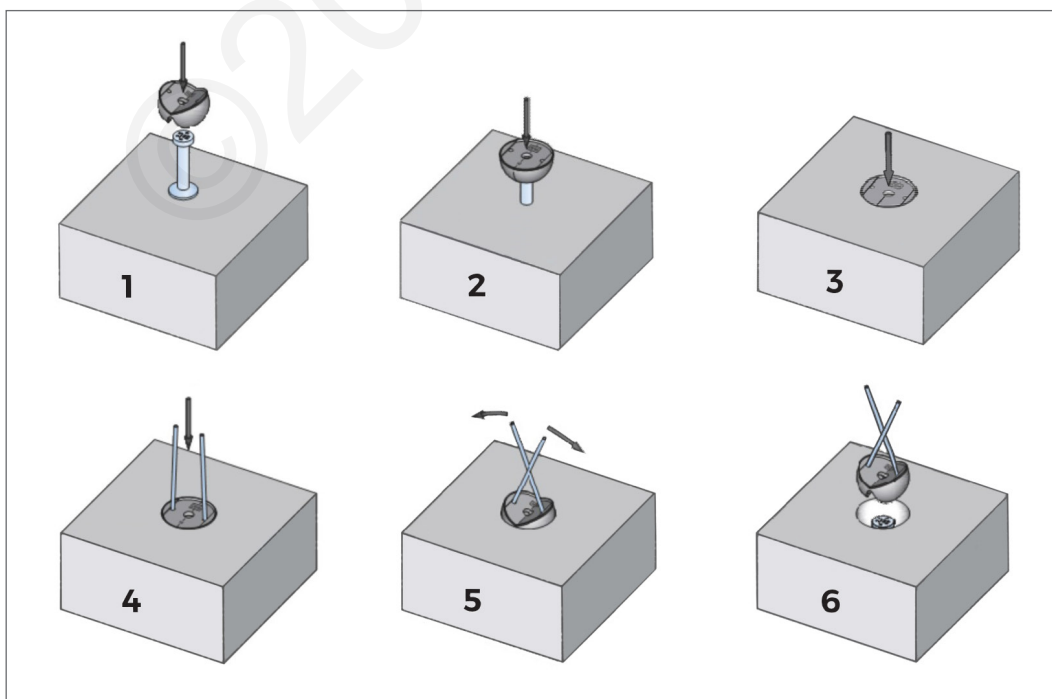

RING PANEL LIFTER INSTRUCTIONS

Before lifting the precast concrete unit, remove as many sections of the mould as possible to minimise adhesion to the mould. Inadequate demoulding is the most common cause of flaking of the precast concrete unit as the forces acting on the lift system may be several times the actual weight of the precast unit.

The ring clutch is used for all load directions. Maximum load of anchor and clutch must be considered. Angle pull caused by spreaded chain suspension is limited by a maximal 60°.

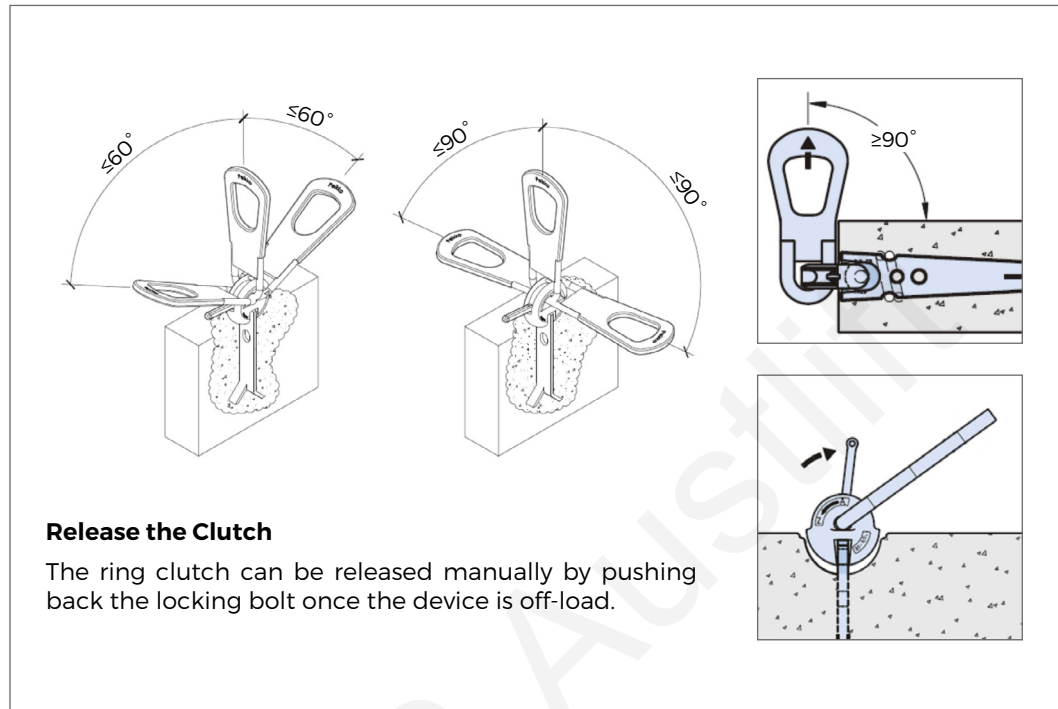

RECESS FORMER INSTRUCTIONS

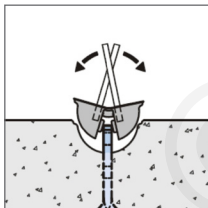

1

To demould the recess former, insert two rods into the holes and levered out with a scissor action. This procedure can avoid damage to the recess former. Attempting to remove the recess former using the tip of a carpenter's hammer will destroy it.

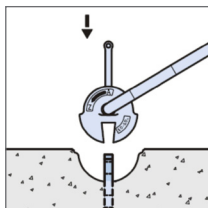

2

To transport the concrete panel, an appropriate ring clutch should be inserted over the anchor head which is in the concrete recess. The load ranges are designed to mismatch-proof.

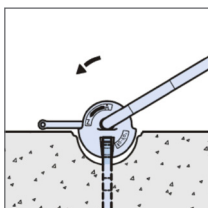

3

The ring clutch is positively locked by a simple hand-operated movement of the locking bolt resulting in a safe connection and the clutch. Then to move in any direction. The precast panel can now be lifted out of the mould for transporting.