

**FotodioX®**  
www.fotodioxpro.com

**FotodioX®**  
www.fotodioxpro.com



**Warrior**  
*150*

Warrior 150

USER MANUAL

FotodioX Inc.

1100 Lakeside Dr Gurnee, IL60031, United States

Toll Free:(866)812-1107

Local & International: (847)201-4623

Fax: (847) 261-0295

Http://www.fotodioxpro.com

## [ Warrior 150 ]

### Characteristics:

- 1.The Warrior 150 features high-power COB LEDs with a lifespan of up to 50,000 hours. These LEDs have a standardized color temperature with a CRI & TLCI  $\geq 95$  and feature less than 2% illumination decay less over 6000 hours working time.
- 2.Built-in NTC temperature detection to automatically control the fan and prevent overheating to ensure a long product life.
- 3.Dimmable from 0-100% and flicker-free due the PWM integrated design.
- 4.11 pre-installed special effect modes to help you create the perfect scene.
- 5.Control from a distance with the included remote control.
- 6.Use any Bowens mount accessory, such as the included custom designed standard reflector.
- 7.Solid aluminum shell provides durability and enhanced heat dissipation for a long product life.
- 8.Adjustable all metal yoke for safely mounting on stands and achieving any angle needed.
- 9.LED heat prevention technology ensures that your light will emit steady and accurate light under varying conditions.
- 10.The LCD displays real-time data for color temperature and brightness.
- 11.Suitable for indoor or outdoor photography and videography. Great for studio or location shoots including TV, film, portrait photography and more.

### Warnings:

- 1.ALWAYS remove the protective cover before using your light.
- 2.ALWAYS press the accessory lock button on the top of the light when removing accessories such as the standard reflector. Failure to do so may damage your light.
- 3.During use, avoid dirt or debris from contacting the surface of the COB LED to prevent damage to your light.
- 4.Do not block the heat dissipation vents on light body. Blocking these will inhibit airflow, causing the unit to overheat and stop working. This may shorten the lifespan of the light.
- 5.Do not operate with wet hands, doing so may cause electric shock.
- 6.Do not operate in environments near flammable gases or volatile liquids as this may increase the risk of explosion/fire.
- 7.Do not operate in enclosed spaces where heat buildup can be extreme, such as a car on a sunny day. The increased heat will trigger the auto heat protection function and affect use. Frequent overheating may cause premature failure of the lighting unit.
- 8.Do not damage, disassemble, twist or modify the power cord as it may increase the risk of fire or electric shock.
- 9.Do not place under heavy objects.
- 10.Keep the light surface clean with a soft, dry cloth. If build-up is noticeable, use isopropyl alcohol on a soft, clean cloth to gently remove debris.
- 11.ONLY use the power adapter/charging cable provided with this product. Should you need a replacement please contact [techsupport@fotodiox.com](mailto:techsupport@fotodiox.com).
- 12.Avoid impact to the LCD screen; impact may damage it.
- 13.Use the safety cable when hanging your light.
- 14.When using the accessories, please ensure that they are properly and securely installed. Improperly installed accessories may fall and become damaged.

### Packing List:



### Warrior 150

- |                           |                         |                           |
|---------------------------|-------------------------|---------------------------|
| ① Warrior 150 -IPC        | ② Protective cover -IPC | ③ Standard reflector -IPC |
| ④ AC Power cord -IPC      | ⑤ Safety cable -IPC     | ⑥ Remote control -IPC     |
| ⑦ Instruction manual -IPC |                         |                           |

### Optional accessories:



Octagon Softbox



Rectangular Softbox



Deep Parabolic Softbox



Optical Snoot



Standard Reflector

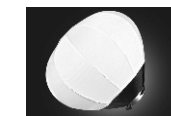

Lantern Softbox



Beauty Dish Reflector



Beauty Dish Reflector and  
Honeycomb Grid



Beauty Dish Reflector and  
Cloth Diffuser

## Parts Diagram:

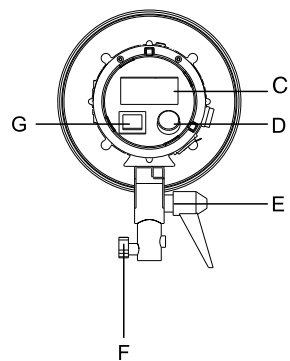
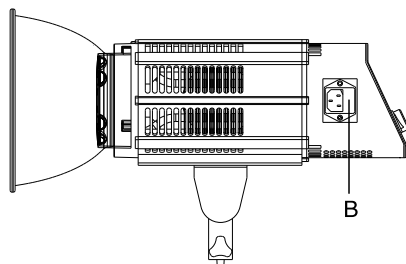
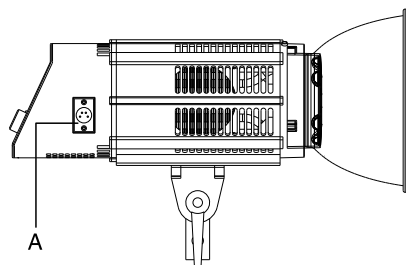

### Warrior 150

- (A) DC power socket (4 pin XLR connection)
- (B) AC power socket
- (C) LCD screen
- (D) Function adjustment knob
- (E) Angle adjustment & locking handle
- (F) Stand mount locking screw
- (G) Power switch

## Specifications:

Spec	Model
LED	Warrior 150
Beam angle	150W COB
Color temperature	120 degree , 50 degree with standard reflector
CRI	5600K±200K
TLCI	≥95
Working voltage	≥95
Cooling system	DC15-24VAC100~240V,50/60Hz
Dimension	Heat pipe radiator , Temperature controlled fan
Weight	5.07x7.44x12.6" (12.9x18.9x32cm)
Included accessory	5.4lb (2.45kg)
Optional accessory	Standard Reflector, Protective Cover, AC Power Cord, Safety Cable, Remote Control
	Light modifiers with Bowens mount

## Illuminance:

Distance	Light without reflector	Light with standard reflector
1M	5300LUX	16600LUX
2M	1400LUX	4100LUX
3M	640LUX	1800LUX
4M	390LUX	1000LUX
5M	260LUX	660LUX

## Operating instructions:

### 1. How to set up the light

(1) To mount on a light stand: loosen the stand mount locking screw by turning counterclockwise. Place the yoke onto the compatible light stand. Turn the stand mount locking screw clockwise to secure the yoke to the light stand.



(2) Adjust the light to the desired angle by loosening the angle adjustment and locking handle by turning counterclockwise. Move the light to the desired angle, then tighten the angle adjustment and locking handle by turning clockwise.



### 2. Reflector/accessory installation and removal

(1) Align the Bowens mount bayonet with the slot on the front of the light. Push reflector/accessory in and turn clockwise until you hear a "click"; the reflector is now locked into place.

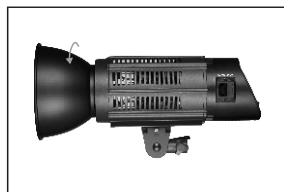

(2) To remove the reflector/accessory, press the accessory lock button on top of the light fixture. Turn the reflector/accessory counterclockwise until Bowens bayonet is aligned, then pull away from the light.

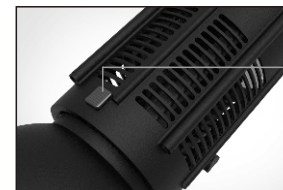

### 3. Power supply

(1) AC power supply (AC100-240V)

To power the light with AC power: Connect the AC power cable to the AC power socket on the light fixture, then plug the AC power into the AC powersource.

(2) DC power supply (DC15-24V)

To power the light with DC power: Connect DC power cable to the 4 pin XLR socket on the light fixture. Attach the other end of the DC power cable into the appropriate power source, such as a V-mount battery via D-tap connection.



## 4. Operating instructions

(1) Power on the unit by toggling the ON/OFF switch on the body of the light. The LCD screen will now show real-time brightness and color temperature data.

(2) The Warrior 150 is dimmable from 0-100%. Increase brightness by turning the function adjustment knob clockwise or decrease brightness by turning counterclockwise.

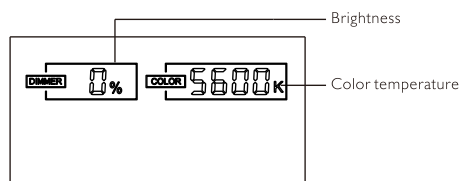

## (3) Special effects mode operation

When the light is powered on, press the function adjustment knob for approximately 3 seconds to enter the special effect mode function. Then turn it clockwise or counterclockwise to adjust between 11 different special effects modes: F1, F2, F3... F11. When you have selected your special effect mode, press the function adjustment knob one to enter brightness adjustment for that mode. Brightness can be adjusted from 0-100% in any special effect mode. To exit the special effect mode, press the function knob for approximately 3 seconds.

Note: F1-Lightning mode, F2-Fireworks mode, F3-Flash mode, F4-Breath mode, F5-Cop car mode, F6-SOS mode, F7- Fault light mode, F8-Turn signal mode, F9-Tracing mode, F10- Screen mode, F11- High and low beam mode.

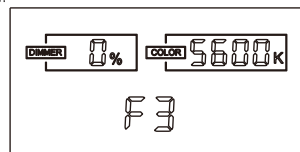

## Remote control operating instructions:



1. Power ON/OFF Button: Press the button once to turn the light on; press again to turn it off.
2. Sound Button(Pairing Button): Press the button for more than 3 seconds to turn on or off the sound.
3. Brightness Decrease Button: Each time you press the button, the brightness is decreased by 1%. To decrease intensity rapidly, press and hold the button for 2 seconds or longer.
4. Brightness Increase Button: Each time you press the button, the brightness is increased by 1%. To increase intensity rapidly, press and hold the button for 2 seconds or longer.
5. FX Decrease Button: Press once to change the special effect mode one value each time from F11-F1.
6. FX Increase Button: Press once to change the special effect mode one value each time from F1-F11.
7. Brightness Shortcut Button: Each time the button is pressed, it is cyclically switched between 25%, 50%, 75% and 100% of intensity.
8. FX Button: Press once to enter the special effect mode, press again to exit the special effect mode.

## Pairing Instructions:

- (1) Turn on the light/lights you wish to pair with the remote control.
- (2) Press and hold the Pairing Button for more than 3 seconds, until buzzer on power control box sounds.
- (3) The light/lights are now paired with your remote control.
- (4) Remote control distance: 20 meters.

Note: When pairing, all light units that are powered on will pair to a single remote control. Each light is factory paired to the included remote control.

All FotodioX products are backed by a 24-month limited warranty.