

VELORETTI
ELECTRIC

E-bike manual

Make a powerful statement.

Veloretti Brandstore

Van Woustraat 72
1073 LN Amsterdam
The Netherlands

Veloretti Headquarters

Helicopterstraat 25B
1059 CE Amsterdam
The Netherlands

www.veloretti.com
info@veloretti.com
+31 (0)20 26 11 433



Step 1

The bike

Step 2

Toolkit

The bike

Carefully remove the bike from the box and visually check for any damage.

Toolkit

Make sure the box contains all accessories and components. The Veloretti box should contain:

- Pedals (L + R)
- 1 wrench (15)
- 3 hex keys (4, 5, 6 mm)
- 2x Reflectors
- Battery charger
- Bell
- 2x keys for the battery
- 2x keys for the lock
- Manual

Step 3

Adjust the handlebars

Adjust the handlebars

Turn the handlebars to the centre position and tighten the screw with the hex key (4 by 15 N/M) to firmly secure it.

1.

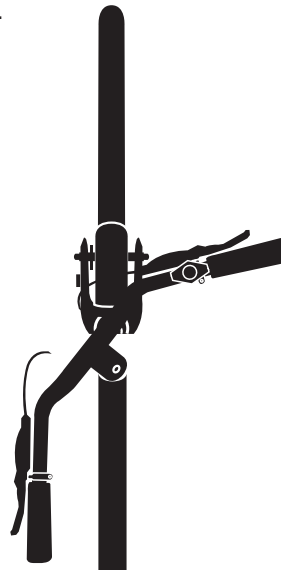

2.

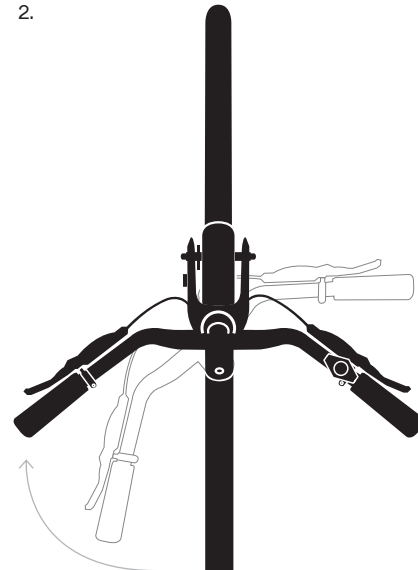

Step 4

Adjust the brake levers

Adjust the brake levers

Loosen the screw with the hex key (5) to adjust the angle of each brake lever.

Turn the brake lever until it sits at an angle of 45°.

Tighten the screw with the hex key (5). Use moderate force to ensure that the brake lever is firmly secured.

1.

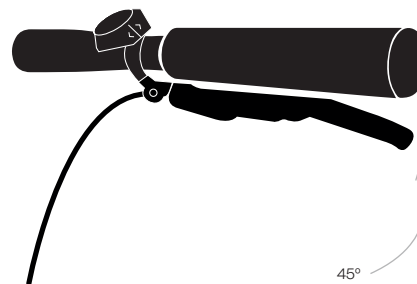

2.

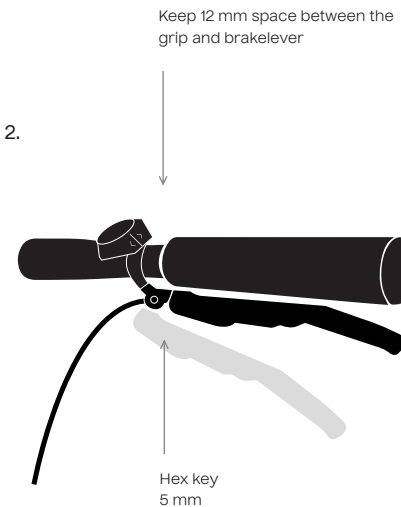

Step 5

Install the pedals

Install the pedals

Please check the markings on each pedal.
The left pedal ('L') must be fitted to the left side of the crank by turning it anti-clockwise. The right pedal ('R') must be fitted to the right side of the crank by turning it clockwise.

Install the pedals by first screwing them to the crank by hand. Do not push or tighten the pedals with excessive force until they are in place. If you experience any resistance turning the pedals into the crank, it is important not to continue. Release the pedal and try again.

Finally, to firmly secure the pedals, use the wrench (15).

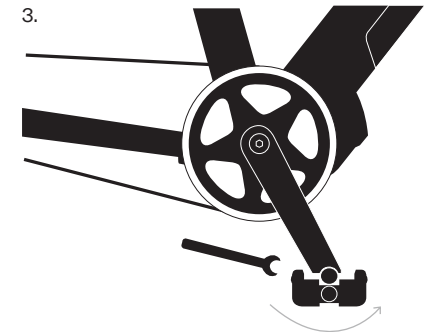
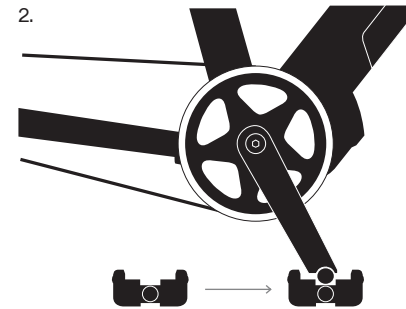
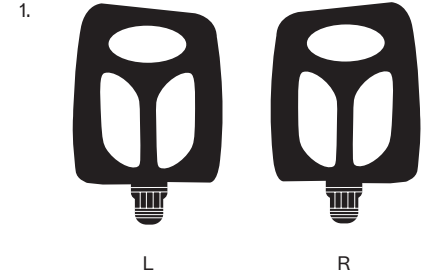

Step 6

Adjust the saddle

Adjust the saddle

Adjust the saddle to the required height. You can stand next to the bike and raise or lower the saddle to 'hip height'. You can finetune the height for your body by sitting on the saddle with your foot placed on the lower pedal. When the saddle is adjusted correctly, your leg should be slightly bent at the knee.

1.

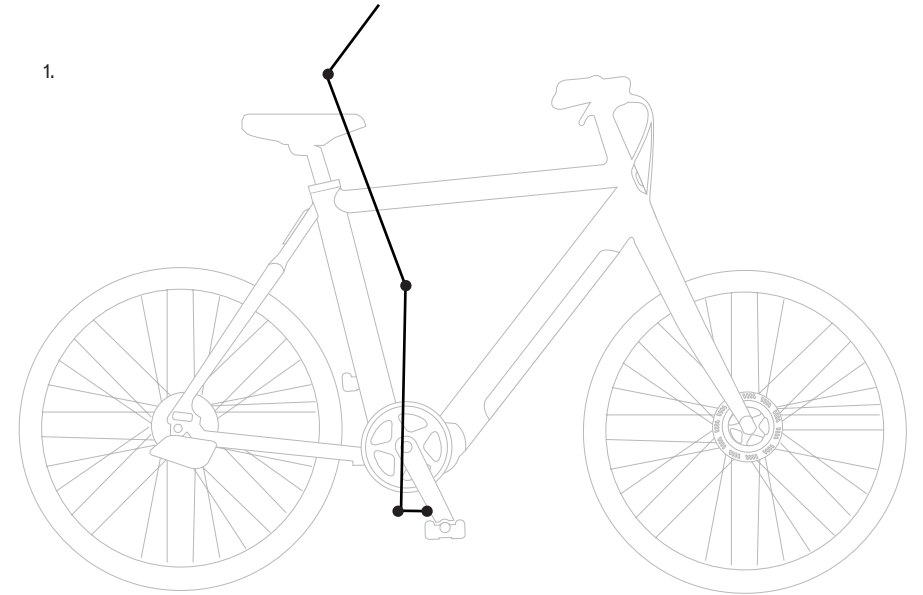

Get to know your bike

VELORETTI

3. Diamond Display

2. Gates Carbon Belt Drive

1. Enviolo hub
Fully automatic
enviolo gears



4. Front identity light
The front light ensures you will ride in complete safety whenever visibility is a priority.

5. Removable battery
Removable, light and compact. The battery has a maximum range of 60-120 km.

6. Hydraulic disc brakes*
Your e-bike is fitted with hydraulic disc brakes. These will give you the best stopping power.

7. BAFANG mid-drive motor
65 Nm torque

*Important message regarding disc brakes
Read the disc brake instructions carefully for necessary and optimal use of the brakes.

Braking in the disc brake pads

Braking in the disc brake pads

To be able to make optimal use of your new Veloretti with disc brakes, it's important that don't forget to properly brake in your disc brakes well first. We explain to you why this 'braking in' is so important and how you can do it best.

Importance of the right start with disc brake

During this process, the resin melts, leaving a thin layer on the brake discs. This layer ensures better operation and longer life of your brakes. In addition, when you brake in, you ensure that the brake pads and discs fit together better and have good contact, so that the brakes do their job even better.

How to brake in your new disc brakes properly

When breaking in your new disc brakes, it is important to let them warm up well, so that the resin can melt. You can do this very easily by accelerating and then firmly braking until you go at walking pace. You should repeat this about 20 times. This way you give the brake pads and discs a good chance to 'fit' to each

other and to be able to brake optimally. Another advantage: this prevents the squeaking of the brakes. The squeaking is caused by pollution (eg oil/grease) or glazing of the brake pads.

Disc brake service

We have a service manual, but in short: for the best functioning of your brakes, of course it is also important to properly maintain your disc brakes.

- The brake pads must be replaced when the pad is only 0.5 mm thick.
- The brakes must also be bled regularly, so that the brake pressure is optimal.
- And have you just installed new pads or brake discs? Do not forget to degrease the discs before you start cycling. You can use a disc brake degreaser for this

The identity light

The identity light

The front light ensures you will ride in complete safety whenever visibility is a priority.

- The default software setting for the lights is 'on' for extra safety.
- The light has a short-throw beam for visibility.
- An external long-throw light (StVZO-approved) is available as an extra option.

This light can be connected to the battery with a cable available from Veloretti. This power outlet is controlled by a dusk sensor fitted inside the Identity light



Diamond Display

Diamond Display

Diamond Display is your Veloretti Electric smart companion for the desired support setting, route mapping or battery status.

Although only the size of a €2 coin (2.57 cm), the Display and Navigation lets you easily see all important riding information.

The Display also connects to your smartphone* via Bluetooth to offer an enhanced product experience.

*The Veloretti Electric app is available for iOS and Android.

A convenient battery

A convenient battery

The battery is integrated into the down tube and is removable. It is easy to take with you, fitting into a regular backpack.

Capacity: 504 Wh

Charging time: 4.7 hours

Range: 60-120 km

Dimensions: L: 46 cm, H: 7.7 cm, W: 6.8 cm,

Weight: charged +/- 3 kg.

Safety: CE

Safety and care instructions

Please follow these guidelines whenever you charge your Veloretti e-bike battery:

- The battery charger is designed for indoor use only. Do not expose the charger to moisture (rain, snow) or high temperatures.
- Use only the original Veloretti charger designed for your e-bike. Do not use other chargers and do not use the Veloretti charger to charge other batteries.
- Store the charger in a cool, dry place. Before use, always check that the

magnetic plugs and connectors are clean. Electrically charged parts can damage the charger or the e-bike's electrical system when you connect it. While charging, the charger may feel quite hot.

- When in use, always put the charger in a well-ventilated place and keep it away from any flammable materials. Children must always be supervised by an adult when you are using this product.
- You should not dispose of the charger with household waste or at a location for recycling electronic devices. If you want to dispose of your Veloretti battery, please contact us. We will arrange for the battery to be recycled free of charge.
- The battery should never be fully going to zero when storing! This will cause a deep negative charge.
- Please be aware that you never store the battery fully dis-charged/at zero. This will cause a deep negative charge and affect the battery capacity.

Releasing the battery

Releasing the battery

1. Make sure the handlebar is set straight (to be able to release the battery and not damage the fender).
2. insert the key and turn it (this unlocks the battery).
3. Use your other hand to twist the release handle.
4. Position your hand underneath the battery.
5. Lift the battery upwards (from the bottom out first) and pull it out the frame.

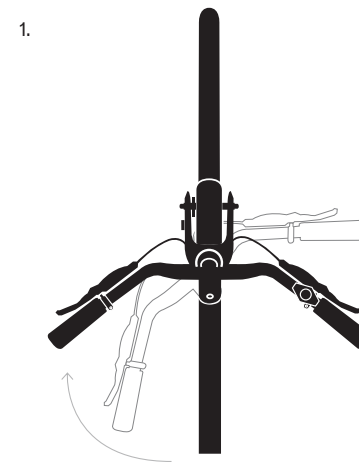

Twist the release handle.

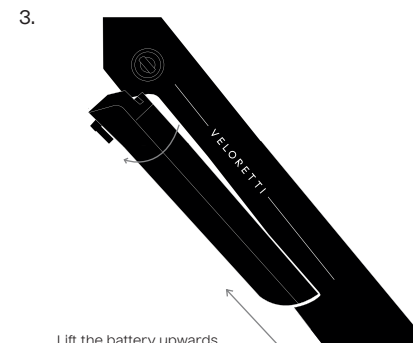

Lift the battery upwards.

More than an electric bike

The app

To fully customise your riding experience, download the Veloretti Electric app. It is available for Android (compatible with Android 4.4 and up) and iOS.



Set-up account.

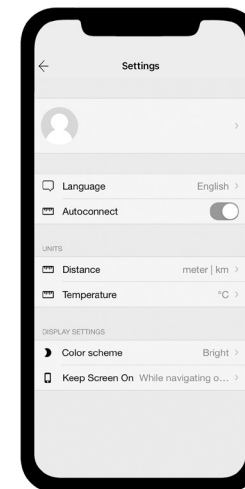

Adjust settings.

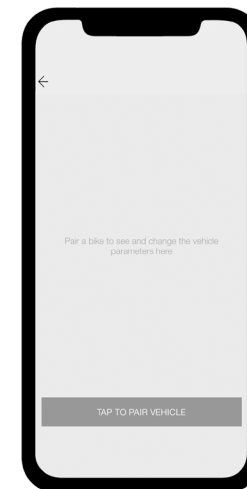

After installing the app, create a user account, or log in with an existing account or using your Facebook account.

Turn on Bluetooth on your device and choose your Veloretti e-bike from the list of available devices. Stand close to your e-bike until the smartphone pairing is finished.

The app

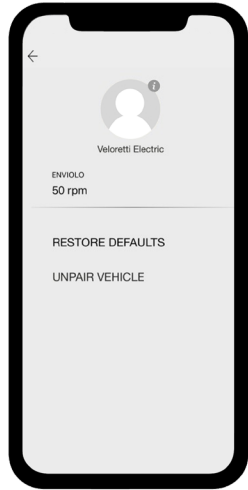

Easily adjust your pedalling rotations with the cadens setting.

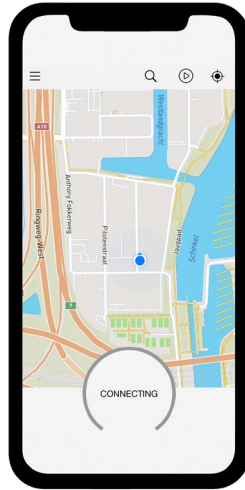

As soon as you are connected to the bike, you will see a map with your location.

Use the menu button to browse through all the different options and settings.

Real-time navigation with route planner.

Use the magnifying glass symbol to enter an address and create a route.

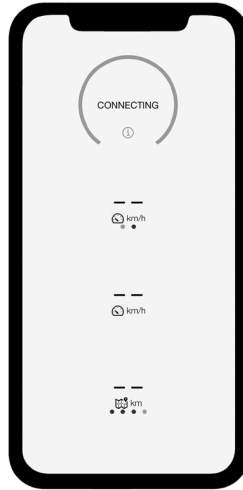

Real-time data:

- See your speed, distance, remaining distance to destination and battery level.

Switch between:

- Speed
- Battery level
- Remaining distance to destination
- Estimated time of arrival
- Duration of current trip
- Distance of current trip
- Clock

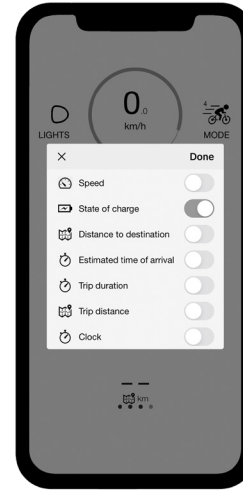

You can use the app to modify the performance parameters of the e-bike's electric motor:

- Increase or decrease the electric motor's power output.
- Change the maximum electric assist level – the speed at which the electrical assist stops helping you.
- Help with the level of assistance in relation to your input

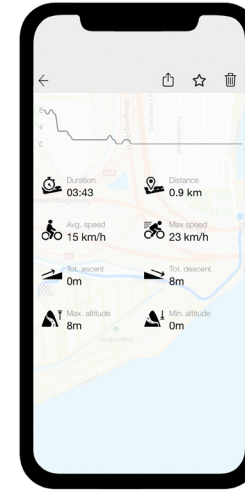

- Turn the lights on or off, or use 'light only' mode.
- Check your remaining battery range.
- Receive updates about your bike and its electronics.
- Download and install the latest firmware.

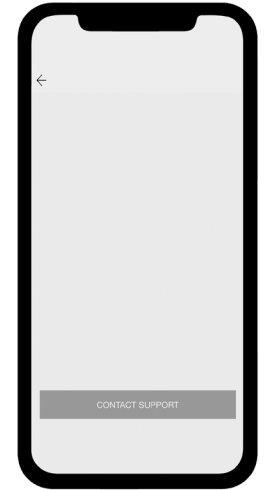

Contact support to solve any problems or service-related questions.

Take care of your bike

Maintenance

- Please note: when riding your e-bike in colder weather, your battery capacity and range may be lower than average. This is perfectly normal and will not impact on the general condition or lifespan of your battery.
- After riding your e-bike in colder weather, allow time for your battery to warm up before charging it.
- Taking care of your Veloretti e-bike is just like maintaining a regular bike. All professional bike shops can perform maintenance on our bikes.
- We advise that you should have your bike checked by a professional after riding the first 500 km. This ensures that everything is properly installed, correctly secured and working as it should. After that, we recommend that the bike should be serviced every 3,000 km.
- If you ride the bike often but do not track the distance travelled, we

recommend that the bike should be serviced by a professional bike shop two or even three times per season. For example, before the start of the season, midway through, then at the end of the season. Je krijgt na 3000km automatisch een service-update vanuit de app.

- In this way, the condition of all important components can be maintained, such as the electric motor, brakes, tyres, crank set and wheel hubs.
- For optimal use and rider experience, it is advised that you calibrate the Enviolo hub every month.

Taking the time to maintain your e-bike is essential for both safety and enjoying the best riding experience.

Checklist

Before you first ride your e-bike:

- Fully charge the battery.
- Check that the battery is securely fitted into the frame.
- Check the tyre pressure. This should be between 3 and 4 bars.
- Check that the brakes are working correctly. Your e-bike is fitted with hydraulic disc brakes. Please note: the left brake lever activates the front brake; the right brake lever activates the rear brake.
- Check the tension of the belt drive. To do so, place your finger on the centre of the belt and press down firmly. The belt should flex between 0.5 cm to 1 cm. Please note: the belt drive does not require lubrication.
- The weight distribution of this e-bike may feel different to other bikes you have owned. Keep this in mind when loading, storing or lifting the bike.
- Try out your bike in a safe, traffic-free environment.

Responsible use checklist

Follow these guidelines to avoid any hazards, risks to your safety, or the safety of other road users:

- Do not use your bike off road. Your city bike features electrical pedal assist technology and is designed to only be used on (paved) roads.
- Do not modify or upgrade your bike with third-party components.
- Please note: any modifications will invalidate the product guarantee. Additionally, the bike may no longer be authorised for use on public roads.
- Do not carry out any maintenance on your bike if you do not have the required knowledge or experience. If you have any questions or concerns, contact Veloretti or a professional bike shop directly.
- If replacement parts are needed, only use components officially approved by Veloretti.

- Remember that braking distances are often longer in damp or wet conditions. Extra care should always be taken in adverse weather conditions.
- Your e-bike's brakes are always more powerful than the electric motor. In dangerous situations, stop pedalling and gently brake to come to a stop in a safe place.
- During intense use, your e-bike's hydraulic disc brakes may become hot. Be careful, as this may result in a loss of braking efficiency.
- Do not start pedalling until you are seated on the saddle and have a firm hold of the handlebars and brake levers.
- Consider the net weight of your load. Do not exceed the carrying capacity of your bike (125kg – including the accessories, baggage and the rider).
- Do not hang heavy bags or objects from your handlebars. This may reduce your ability to steer the bike with the necessary precision and safety.
- Wear appropriate protective equipment. Always wear a helmet. Avoid loose clothing or accessories which can become stuck in the wheels or crank, causing an accident.
- Use appropriate lighting to improve visibility in your immediate environment and to increase your visibility to other road users.
- Always follow the applicable traffic regulations. Also be aware that the regulations related to pedal-assist e-bikes can vary in different countries. Stay informed of changes to the rules and traffic regulations wherever you will ride the bike.
- Before using a bike trailer, check the product compatibility with the trailer's manufacturer.
- Before using a child seat, check the product compatibility with the child seat's manufacturer.
- Before using a pannier rack, check the product compatibility with the pannier rack's manufacturer.

Guarantee

- As consumer, you have a legal guarantee for two full years, following the delivery of your bike. This is in accordance with the conditions set out in law.
- The guarantee covers manufacturing and material defects for all original items (e.g. if the products do not correspond to the description of the product as specified in the user manual, or in the promotional materials for the product).
- The guarantee is only valid for the original owner and is not transferable. Any objections about this guarantee should be addressed directly to Veloretti.
- During the guarantee period, Veloretti will replace or repair the product which is at fault. If the replacement or repair is prohibitive or not possible, or it is not possible to offer this within a reasonable amount of time, you are entitled to request a price reduction or cancel the sales agreement.
- During the first six months of the guarantee period, you are not obliged to prove that the fault already existed at the time of purchase.
- The guarantee does not apply in the following situations:
 1. Incorrect assembly or installation of the product by the user.
 2. Improper or careless use, operation or modification of the product.
 3. The user has not complied with the maintenance requirements of the product, as specified in the product manual (e.g. insufficient brake maintenance).
 4. Normal signs of use (wear and tear such as tires, saddle, grips etc.)
 5. Faults related to the normal use of the product, or the service life of the product, such as a weakened or flat battery that can be replaced by the consumer.
 6. Damage or faults due to an accident.

Instructions for the use and maintenance of your e-bike's battery

- Only charge your battery indoors, placing it on a non-flammable surface.
- Charge your battery using only the official charger supplied by Veloretti. The technical specifications are printed on the charger.
- Charge the battery at room temperature, between 15°C and 25°C.
- Do not expose the battery or charger to direct sunlight while charging.
- Keep the battery and charger away from water or humid conditions while charging. We recommend that you charge the battery in daytime, in a dry room that is fitted with a smoke detector. This should not be your bedroom.
- Before using or charging the battery, check that it is in good visual condition (no corrosion, cracks or other damage). Never open, disassemble or attempt to break the battery.
- Do not use a defective battery or charger.
- Keep the battery and charger out of reach of children.
- Keep the battery away from fire or high temperatures.
- Before cleaning or carrying out maintenance on your e-bike, remove the battery from the frame.
- Avoid storing a fully discharged battery for a long period. This can have a negative and permanent impact on the battery's capacity.
- Remove the battery from your e-bike if you do not intend to use it for a long period.
- For the best performance, ensure the battery goes through a complete cycle of discharging and charging at least once every two months.
- Lithium-ion batteries do not suffer from the so-called 'memory effect'. It is recommended to charge the battery after every ride. Doing so will not negatively impact the condition or lifespan of your battery.

Extra maintenance tips

- Use a damp cloth to clean your e-bike. Your e-bike is not approved for cleaning by means of a steam cleaner, a pressure washer or a garden hose.
- Do not open or touch your e-bike's electrical system. You risk injury to yourself or may cause permanent damage to your e-bike.
- If you have to remove the wheels from your bike, ensure they are securely reinstalled. The front wheel should be installed to a torque of 10 Nm. The rear wheel should be installed to a torque of 35 Nm.
- Brake pads wear out and should be replaced in good time. Only compatible brake pads should be used.
- Check your tyres for signs of wear and tear. Tyres should be replaced in good time. The tyre size is 47-622. If the inner tube needs to be replaced, use size 42-622.
- Like all mechanical products, the components of your e-bike will suffer from general wear and tear over time. The various materials and components will respond differently to this.
- If the lifespan of a component is exceeded, it may suddenly fail. The user may be at risk of injury. Therefore, regularly check all (moving) components of the bike.
- Visually check your bike and its components. Any cracking or discolouration of the most intensively used parts indicates that the part is at the end of its lifespan and must be replaced.
- The belt drive on this e-bike does not require lubrication. Do not use any form of lubricant. Doing so may mean the drive system no longer functions as it should.
- Do visually check the condition of the drive belt and wipe away dirt and dust. The accumulation of dirt can accelerate wear and cause the belt to break unexpectedly.

Make a powerful statement.

@veloretti

veloretti.com



veloretti.com