



# User Manual

For in-house support & response within 24 hours, please contact [info@blackboxmycar.com](mailto:info@blackboxmycar.com) with any questions.



Available on the  
**App Store**



GET IT ON  
**Google Play**

Download the **Cellink Neo Plus app**  to get started

This product is an external power supply, which is used to provide extended dash cam recording when the vehicle is parked, without depleting or damaging the vehicle's battery. This manual outlines the basic steps required to install and use the external battery.

The specifications listed in this manual are subject to change without advanced notice.

## POWERCELL 8 BATTERY

# ABOUT

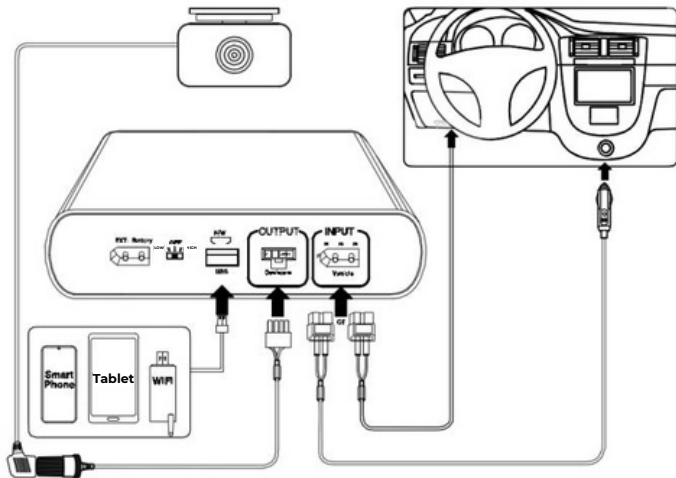

The BlackboxMyCar PowerCell 8 Battery is designed to power your dash cam in Parking Mode for extended periods of time without using your vehicle's battery.

## POWER PROPERTIES

# SUMMARY

- Through **built-in Bluetooth**, users can check the battery status in real-time through the smartphone app.
- When the switch is **Set to HIGH**, the smartphone app allows the user to set the charging current of the product from minimum to maximum current.
- Users can power the battery through **2 different charging methods**; through the cigarette lighter adapter or through the ACC fusebox power connection.
- Charging starts **as soon as the vehicle starts the engine**. If the HIGH on the switch is selected, the users can change the charging current through the smartphone app.
- A **micro controller (MCU)** is built-in to control the current, voltage, and balance of the battery, and the **battery protection circuit module** is built-in for secondary protection to prevent the overcharge, overdischarge and overcurrent.
- Users can extend their power capacity on the BlackboxMyCar PowerCell by connecting it with the **Cellink Neo Extended battery**.
- The smartphone app will warn users if the battery temperature reaches a certain temperature, and the system will automatically stop to **prevent overheating** if the product is in excess of 80°C.
- This battery is created using **Lithium Iron Phosphate (LiFePO4)**, a material that is 3 times more durable and heat resistant compared to lithium ion, providing at least 2,000 battery cycles.
- **Compact design** makes it possible to hide under vehicle seats.



## POWERCELL 8 BATTERY **TERMINAL**

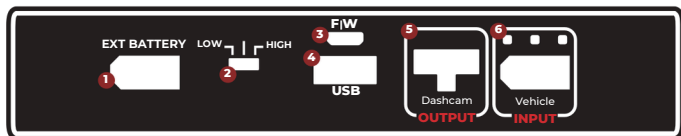

- 1 Extended Battery** Connect the Cellink NEO Extended battery to add more power
- 2 LOW / OFF / HIGH**
  - LOW** Set to **LOW** so that the battery only charges using the Minimum Charge Current with the smartphone app
  - OFF** System power off
  - HIGH** Set to **HIGH** so that the Charge Current can be adjusted between Minimum and Max with the smartphone app
- 3 F/W**  
Connector for firmware update only (Technician Use Only)
- 4 USB**  
5V output connector for charging mobile device like a smartphone
- 5 OUTPUT**  
Discharging connector for connecting to a dash cam
- 6 INPUT**  
Charging connector for ACC Hardwiring Kit or Cigarette Lighter Adapter



## POWERCELL 8 BATTERY **LED DISPLAY**



**Powered On**

R,G and B LEDs are turned on simultaneously and then turned off in the R,G and B order



**Pre-Charging**  
(After Powered On)

Red LED is on after flashing multiple times



**Fully Charged**

Green LED is on



**Bluetooth On**

Blue LED is on after flashing multiple times

# POWERCELL 8 BATTERY GENERAL SPECS

<b>Input Power</b>	<b>LOW</b> Cigarette Lighter Socket	DC 12V~17V Max 8A
	<b>HIGH</b> Fusebox ACC Power	DC 12V~17V Max 13A
<b>Input Power</b>	Dash Cam Connector	DC 11V~14.2V Max 2A
	USB Connector	DC 5V Max 2A
<b>Charging Voltage &amp; Current</b>	<b>LOW</b> Cigarette Lighter Socket	DC 14.2V Max 4.5A
	<b>HIGH</b> Fusebox ACC Power	DC 14.2V Max 8.5A
<b>Charging Time</b>  <b>LOW</b> Fixed Current <b>HIGH</b> Adjusted Current	<b>LOW</b> 5A Charging: Approximately 100 Minutes	
	<b>HIGH</b> 9A Charging: Approximately 50 Minutes	
	<div> <div>LOW</div> <div>OFF</div> <div>HIGH</div> </div> <p>*Set the Charging Current in smartphone app when HIGH is selected</p>	
<b>Product Rating</b>	12.8V / 7,500mAh / 96Wh	
<b>Available Hours</b>	About 24 Hours* *Based on 2CH dashcam within 4Wh power consumption	
<b>Dim &amp; Weight</b>	157mm (W) * 207mm (L) * 39.5mm (H) / 1.67KG	
<b>Build Material</b>	LiFePO4	



# POWERCELL 8 BATTERY INSTALL GUIDE

Please set to **OFF** before installation.

## Charging Method: Cigarette Lighter Socket

When connecting the product using Cigarette Lighter Socket Input Cable

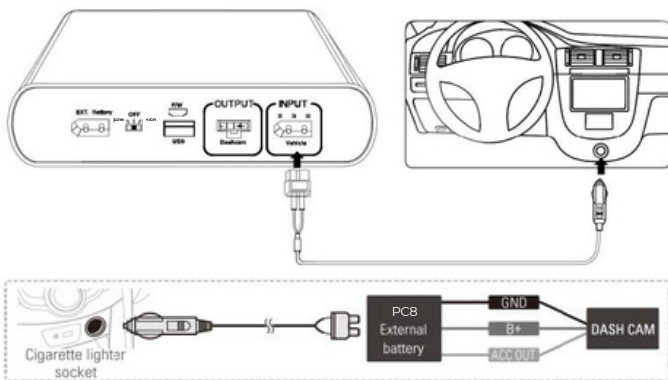

## Charging Method: Fusebox ACC Input Cable

When connecting the product using Fusebox ACC Input Cable

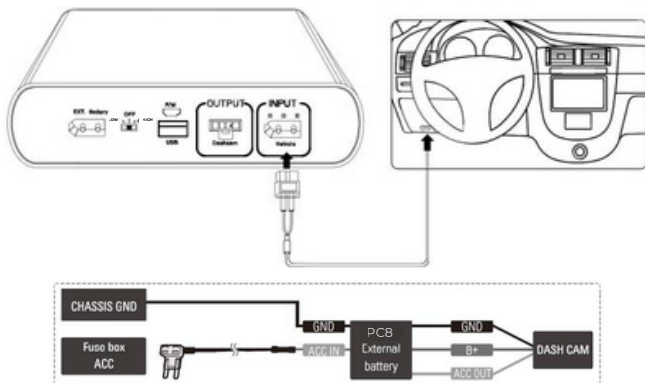

## Charging Method: Fusebox ACC Input Cable

Fusebox ACC input only supplies power when the engine is on.

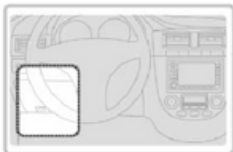

- 1 With the product's power switch in the OFF position, connect the Input Cable for the fusebox and Output Cable to the product's cable connectors.
- 2 Open your vehicle's fuse box, check the fuse standard, and select the correct fuse location for the install.



The fusebox location in the vehicle may vary depending on the manufacturer and model of your vehicle. For more information, refer to your vehicle's manual.

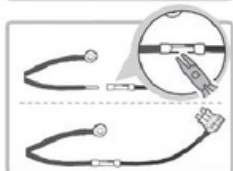

- 3 Insert the Input Cable into the sleeve at the end of the add-a-fuse, and then secure it by squeezing on the sleeve using appropriate tools, such as pliers.
- 4 After removing the original fuse rated for at least 10A in the fuse box, put the ACC fuse provided with product in the add-a-fuse, and then install the ACC add-a-fuse in the fuse box.

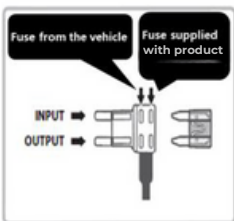

Ensure that the add-a-fuse is installed into an ACC switched fuse position in the fuse box.

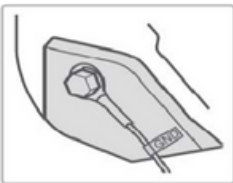

- 5 Find a bolt fixed on the vehicle and connect the ground (GND) cable to the bolt.



If the vehicle's bolt is coated, remove the coating before connecting the ground (GND) cable. Power may not be supplied correctly due to the coating.

### Make sure the product is connected properly

- 1) Fix the product using the provided velcro tape to the car floor
- 2) Turn on the switch & check that the LEDs operate properly

# POWERCELL 8 BATTERY APP GUIDE

## Download the App

Search for "Cellink Neo Plus" and download the app.



## Before Running the App

Turn on the battery you purchased before running the downloaded app. Set to the power switch position is **LOW** or **HIGH**.



LOW



HIGH

# POWERCELL BATTERY CONNECT VIA BLUETOOTH



- 1 When running the app on the smartphone, after loading, appear the **"SEARCHING DEVICE"** and the searched Bluetooth device as shown on the left picture.
- 2 Select your PWC8 device on the screen.
- 3 If you rescan, the connected device is displayed in blue and automatically connected.



Check the code attached to the top of your BlackboxMyCar PowerCell 8 and click the same code on the smartphone to complete the connection.

- 1 Product Settings
- 2 Product Model Name & Bluetooth ID
- 3 Battery Charging State & Internal Temperature
- 4 Present Voltage & Charge Current to Battery
- 5 Present Voltage & Discharge Current to Battery
- 6 Battery Capacity
- 7 Estimated Time for Full Charge
- 8 Leftover Time with Current Power



The app does not always have to be on. However, if its internal temperature is high or input voltage is low, you can receive an alarm message through the app.

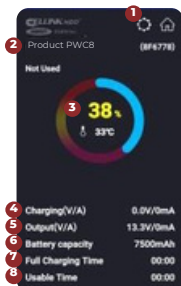



## Product Password Settings

You can enter the product setting screen by tapping the gear icon on the main screen. The password is required to enter the product setting screen. The default password is set to **1234**.

You can set your own password to prevent other users from changing the product settings at will. It is recommended to change the password immediately after purchase.



'0000' cannot be used as a password, but you can set within '0001' ~ '9999'. If you have forgotten your password, please contact our Support Team.

## Product Password Settings

- 1 **Padlock Icon:** Use your own password settings
- 2 **Beep On/Off:** Setting status of battery sound
- 3 **Charging Stop:** The function to stop charging the battery
- 4 **Battery Capacity:** Normal capacity of battery
- 5 **Ext. Battery Capacity:** If you add an extended battery pack, you can enter in the capacity of the added battery.
- 6 **Charging Current:** You can change the charging current when you install the battery to the fusebox and the switch is selected to the HIGH. Just enter the current within 4A ~ 8.5A.

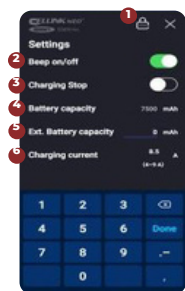

## Warning for High Temperature

The warning screen will be displayed and stop charging or discharging if the internal temperature is more than 80°C to prevent the vehicle's & product's damage.

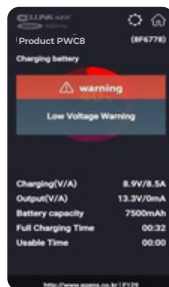

## Warning for Low Input Voltage

This warning screen will be displayed and stop charging if the input voltage drops below 12V to prevent vehicle damage.



## POWERCELL 8 BATTERY **EXTENDED BATTERY**

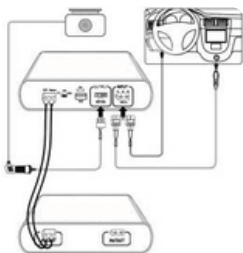

### **Product Password Settings**

If BlackboxMyCar PowerCell 8 needs more capacity, connect the extended battery pack such as the Cellink Neo Extended

The Cellink Neo EXTENDED Battery is designed to add capacity to the BlackboxMyCar PowerCell 8 easily.

### **Extended Battery Installation Guide**

Connect Cellink Neo Extended IN/OUT(Auto)connector to the EXT. Battery connector of BlackboxMyCar PowerCell using the cable provided with the Cellink Neo Extended product.

Once the Cellink Neo Extended is connected to the PowerCell 8, the capacity displayed in the app should automatically update.

## POWERCELL BATTERY **PRECAUTIONS**

Mishandling of BlackboxMyCar PowerCell batteries can lead to degradation of performance and result in problems related to heating, ignition, explosion etc. As such, it is advised to check the following details.

1. When installing on vehicles, please use only the original cable provided with the product.
2. When storing the battery, keep out of direct sunlight and do not store in a high temperature environment such as inside the car in hot weather.
3. Do not place the battery in microwave oven or a place with high pressure.
4. Do not throw or give the battery any types of shocks.
5. Do not repair or remodel the battery on your own.
6. Keep the battery out of contact of water or other liquid.
7. Do not disassemble, compress or drill a hole on the battery using sharp equipment.
8. Keep the battery out of contact of children or pets.
9. When there is a strange smell during use, discontinue using the product and exchange with a new product.
10. When the battery is inflated during use, discontinue using the product and exchange with a new product.
11. Do not use the battery in a static environment as it can affect the performance of protection circuit of the battery.
12. Keep the connection terminal of the charging cable of the battery out of contact with conducting elements.
13. Never use the product for anything else other than the power supply for Dashcam.

## POWERCELL BATTERY **DISPOSAL GUIDE**

1. Don't throw away your batteries, separate them with recycled items.
2. Do not incinerate battery and put in the fire. Heat may cause explosion and fire.
3. Do isolate them each other when disposing the secondary batteries having different electrochemical systems.
4. Dispose of the battery in discharged state to prevent heat by short circuiting.
5. Disposal guidance of batteries may depend on each country and region, therefore dispose batteries in accordance with the regulations for each country and region.



POWERCELL 8 BATTERY

## PRODUCT WARRANTY

- The warranty period of this product is 1 year from the purchase date.
- If the product fails during normal and correct use within the warranty period, our service center will repair the product free of charge.
- Any disassembly, modification or alteration of the product will void the warranty.
- The cost to repair or fix any malfunction or problem caused by incorrect usage during the warranty period may be charged to the consumer.
- The manufacturer shall not be responsible or liable for any loss or damage caused by incorrectly installing and/or using the product.



POWERCELL 8 BATTERY

## CUSTOMER SERVICE

**Manufacturer:** EGENInc.

**Address:** 160-13988 Maycrest Way, Richmond, BC

**Email:** [info@blackboxmycar.com](mailto:info@blackboxmycar.com)

**Phone:** (888) 978 6560

**Website:** [blackboxmycar.com](http://blackboxmycar.com)



**BLACKBOXMYCAR**