



INSTRUCTION MANUAL

Rear Cycle Light with
HD Video Camera

www.fly6.com



CONTENTS

Before using Fly6

Introduction	3
Read This First	4
Safety and Care	5
Overview	6
Product Layout	7
Technical Data	9
Computer Requirements	10

Setting up Fly6

Battery	11
Setting the Date and Time	13
Mounting to Seat Post	14

Operating your Fly6	15
----------------------------------	-----------

Accessing and Using your Footage	17
---	-----------

INTRODUCTION

Congratulations on your purchase of Fly6, which captures 130 degrees of High Definition vision behind you during your ride. It also incorporates latest technology strobe and LED lighting to maintain high visibility during your ride.

In your box, you should have the following:

1 x Fly6	4 x Regular Straps
1 x 5° Angled Alignment Spacer	2 x Extra Length Straps
1 x 10° Angled Alignment Spacer	1 x USB Cable
2 x Standard Alignment Spacer	1 x MicroSD Card
1 x Instruction Manual	1 x Seat Post Aero Attachment
2 x Seat Post Mount	1 x Quick Guide Manual

Functions:

- 130° HD video recording • Audio Recording • Strobe light • LED lights
- Looping record to capture important footage • Rechargeable Lithium Ion battery

READ THIS FIRST

Disclaimer

Fly6 is designed specifically to be used as a rear 'tail' light with video and audio capabilities for bicycles. While every effort has been made to ensure it will fit to most bicycles on the market, it may not fit all bicycles depending on how the bike is set up. Please note that Fly6, its subsidiaries and affiliates, and its distributors are not liable for any consequential damages arising from any malfunction of the device, including memory cards, that results in the failure of an image to be recorded or to be recorded in a way that is machine readable.

Warning Against Copyright Infringement

The images recorded with this camera are intended for personal use. Do not record images that infringe upon copyright laws without the prior permission of the copyright holder. Please be advised that in certain cases the copying of images from performances, exhibitions, or commercial properties by means of a camera or other device may contravene copyright or other legal rights even if the image was shot for personal use.

Safety, operating and care information

As safety and customer satisfaction are most important to us, there are a number of safety, operating and care points we would like to bring to your attention. For more information, please visit: www.fly6.com

Caution

- Warning! No modification of this device is allowed!
- Children should not play with the device
- Do not look directly at the strobe or LED lights when operating
- Do not immerse the product in water or any other liquid
- Refer to web site for care instructions
- Avoid dropping or knocking the product in any way
- Pay attention and care when replacing USB cover to ensure correct seal so water ingress does not occur
- No liability can be accepted for any damage caused by non-compliance with these instructions or any other improper use or mishandling
- The device has a Lithium ion battery. When disposing of this, it should be done in compliance with the rules and regulations appropriate to you

OVERVIEW

Parts List

- 1 Fly6
- 2 Seat Post Mount (x2)
- 3 Standard Alignment Spacer (x2)
- 4 5° Angled Alignment Spacer
- 5 10° Angled Alignment Spacer
- 6 Aero Spacer
- 7 Standard Straps (x4)
- 8 Long Straps (x2)
- 9 MicroSD card (installed in device)

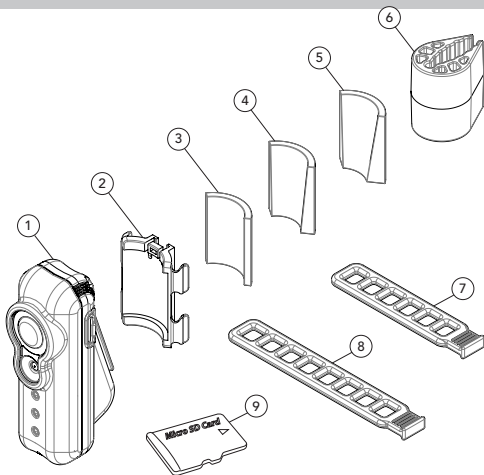

PRODUCT LAYOUT

Front

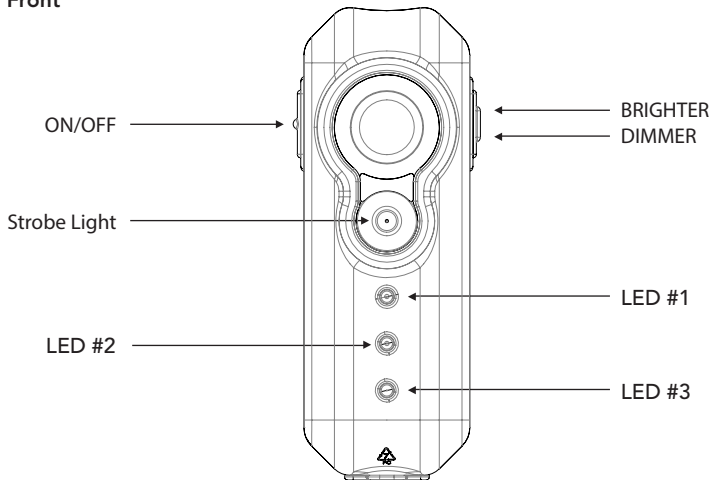

Bottom

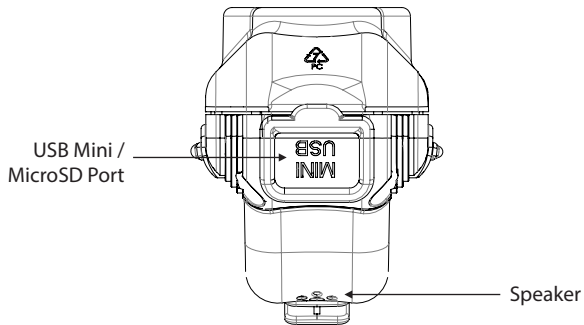

TECHICAL DATA

Fly6 is an internally powered and continuous operation device

Product description	Bicycle Rear HD Camera & tail light
Model	Fly6
Rating	230mA@4V (max)
Power source	Rechargeable Lithium Ion Battery
Battery life	Approx. 5 hours
Ingress protection	IP55
Operating temperature/humidity	0 to 45 degrees
Storage temperature/ humidity	-10 to -70 degrees
Weight	approx. 105 grams

COMPUTER REQUIREMENTS

Minimum requirements

Processor	Pentium 4 or later, or equivalent
OS	Windows (XP, Vista, 7, 8 or later), Macintosh (OS X v10.0 or later)
RAM	256MB
USB Input	2.0 or later

SETTING UP Fly6

Your Fly6 comes partially charged however before using it for the first time, fully charge the device for maximum results.

Charging the Battery

- Connect your Fly6 to any PC or Mac using the supplied USB cable
- LED 2 will illuminate indicating the device is charging
- When LED 2 turns off, your Fly6 is fully charged

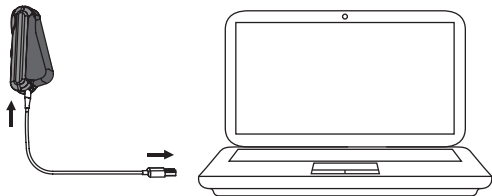

Note: The time to charge from flat to fully charged varies from 3 to 6 hours depending on method of charging i.e. mains power USB (not supplied) or computer USB

Battery Level Indication

Upon powering up your Fly6, an audible battery status will sound, alerting you to the current battery level. This also occurs as you power down, so you know if you have enough battery for your next ride. See below for audible meanings:

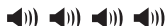

*4 Beeps:
75%+ Charged*



*3 Beeps:
50%+ Charged*



*2 Beeps:
25%+ Charged*

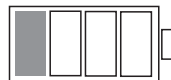

*1 Beep:
5%+ Charged*

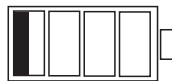

*3 Long Beeps:
Under 5% Charged*

Note: Should your battery deplete to beneath 5% capacity during your ride, 3 long beeps will sound. This indicates your camera has turned off, however the flashing of the tail light will continue for a further 1.5 hrs (approx.) so as to keep you visible for the remainder of your journey.

Setting the Time & Date

- Connect Fly6 to any PC or Mac
- Turn on Fly6 to access file directory
- Open the folder containing CONFIG.TXT using text editor
- Change the date and time to your local time in the following format:
YYYY/MM/DD HH:MM
- Save the file in the **root or main directory** (not in the same folder)
- Remove your Fly6 from the computer
- Turn on to have your new settings take effect

Note: Should you need to adjust Date/Time settings again, download a new CONFIG.TXT file from www.fly6.com

Mounting Fly6™ to Bicycle Seat Post (stem)

- 1 Slide seat post mount onto your Fly6 until you hear a 'click'
- 2 Select the appropriate alignment spacer that aligns your Fly6 perpendicular to the ground
- 3 Peel off backing from adhesive tape to affix selected spacer to seat post mount
- 4 Attach provided straps to seat post mount
- 5 Hold unit onto seat post (stem) and wrap straps around to fasten

Mounting Fly6 with Aero Post (stem)

- 1 Repeat steps 1 - 4 above then fit aero spacer onto seat post prior to step 5

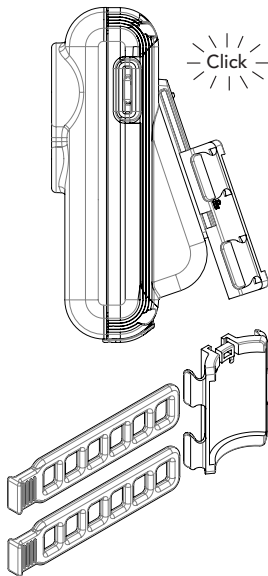

OPERATING YOUR Fly6

Note: Before operating, ensure the USB cover is firmly depressed & seated fully.

On/Off Functions

Turn Device On

- Press and hold Power Button until top bezel LED illuminates - then release
- Power level 'beeps' signal remaining battery

Turn Device Off

- Press and hold Power Button until lights turn off
- Power level 'beeps' signal remaining battery

Flash Sequences

- When your Fly6 is operating
- Press the Power Button briefly to toggle between two flashing sequences

Dimming Functions

- By default the brightness is high at start up
- Press Dimming Button once for low
- Press Dimming Button twice for no Strobe or LED illumination
- Press Dimming Button three times for "super bright".
- Keep pressing to cycle through these options again

Note: Rotating bezel lights are always on when the camera is recording.

Note: To maximise battery life select a dimmer flashing illumination and turn off your Fly6 when not in use.

ACCESSING AND USING YOUR FOOTAGE

Access Footage

After your ride, you can access your footage in two ways:

- Connect to any PC or Mac and turn on your Fly6
- Remove microSD card and read data via PC or Mac

Note: Footage is saved in chronological order in 15 minute (around 800mb) files sizes in .AVI format

Using your Footage

Select the file you want to view and play the .AVI file via your preferred video viewing software.

ADDITIONAL FEATURES

Looping Function

Your Fly6 is designed as a 'set and forget' cycling accessory - all you should need to do is charge it when necessary. As such, the footage is continuously recording onto the microSD card until there is no space left, then it records over the oldest footage until there is no space left then repeats. This way, you never have to worry whether anything is being captured - it just is!

The looping function cannot be turned off. This is to ensure that you do not forget to record your ride. If you want to keep all of your ride footage without looping over it, you will have to get a greater capacity microSD card (up to 32Gb is compatible - this should give you up to 8 hours of recording capacity before the looping function kicks in). Alternatively you can remove the microSD card when the capacity is reached and replace with a new microSD card.

Incident Protection Function

We understand that incidents happen from time to time - hopefully they never happen to you. Fly6 has been designed to save footage from major incidents without being recorded over.

This works when the bicycle (Fly6) is tilted over more than 45 degrees for more than 3 seconds. In this event, Fly6 will trigger a program that will shut down your Fly6 after one hour. When using the supplied 8Gb microSD card, the recorded footage will contain one hour prior to the event and one hour post the event (subject to the device not being damaged).

If your Fly6 tilts over 45 degrees for more than 3 seconds and you don't want the incident protection program to work, do one of two things:

- Turn off, then turn on your device and use normally; or
- When the 3 long beeps sound (indicating your device is shutting down) you should turn your device back on and use normally.

