

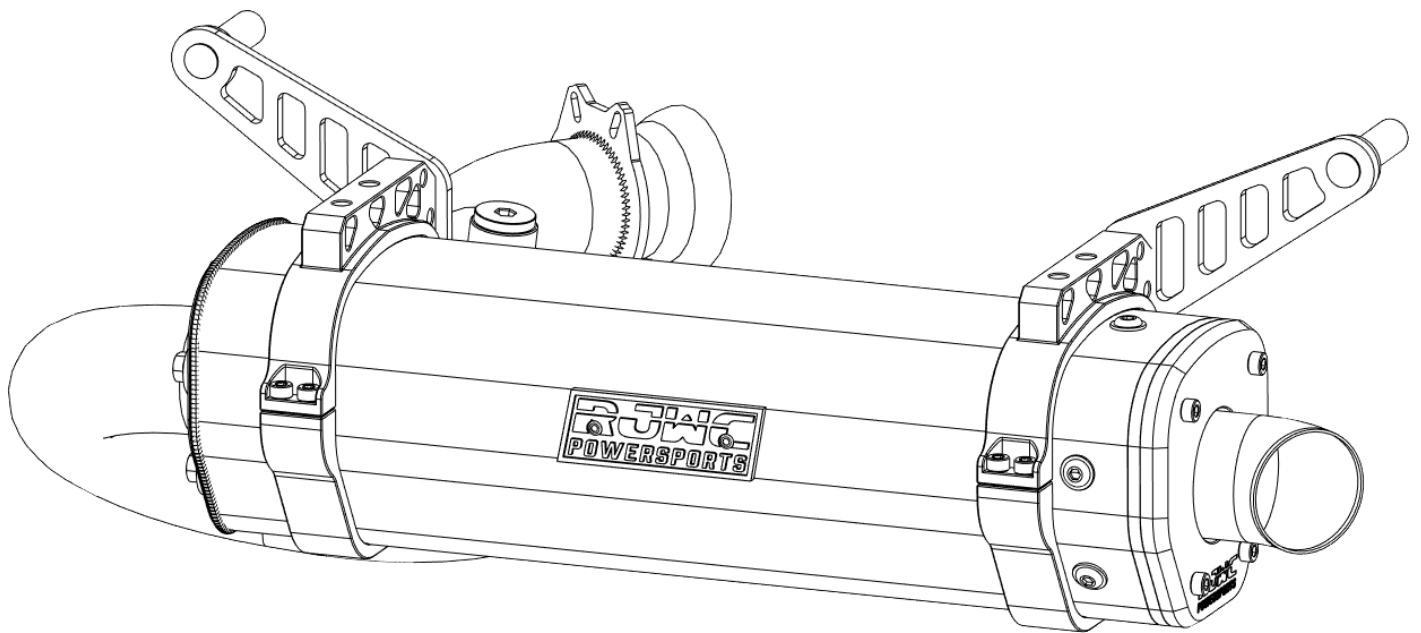

Outlander 850-1000 Single Slipon GEN3



Installation Manual



Important Safety Information - Read Before Installation

WARNING: Before starting the installation of any ATV, UTV, or SXS aftermarket parts, it is important to prioritize safety. Make sure you are using suitable protective gear, this includes but is not limited to safety goggles, gloves and protective clothing.

Ensure your vehicle is on flat, stable ground. Installing parts on uneven or unstable surfaces can potentially lead to injury or damage to the vehicle. The vehicle should be turned off and cooled down before proceeding with the installation. Attempting to install parts on a running or hot vehicle can result in burns or other serious injuries.

After completing installation, it is important to inspect and check the tightness of any and all nuts, screws, and bolts. Failure to properly secure these fasteners can lead to component failure or detachment during riding, posing significant safety risks to both the rider and bystanders. The vehicle should be warmed up and subsequently cooled down to account for any thermal expansion or contraction effects that may affect the tightness of the fasteners.

It is crucial to inspect and tighten screws and bolts as necessary after initial rides, as vibrations and stresses during operation can cause fasteners to loosen over time.

It is important to pay close attention to the condition of the exhaust system and undertake the necessary measures to maintain optimal performance. Failure to properly maintain the exhaust system can result in reduced engine performance and potential safety hazards. Remember to repack exhausts as necessary to ensure efficient exhaust flow and minimize any potential restrictions that could adversely affect performance.

Prior to starting the installation process, it is important to thoroughly read all provided instructions to familiarize yourself with the installation procedures and any specific requirements or precautions. Failure to follow the instructions could result in improper installation or component failure.

Please check your local laws and regulations governing the use of aftermarket parts on your vehicle. Failure to comply with these regulations can result in legal repercussions, fines, or other penalties. Therefore, it is important to research and understand the applicable laws and regulations before installing aftermarket parts on your vehicle. Always ensure that any modifications made to your vehicle comply with local regulations.

Please check and read the full Warranty Information that can be found at:
www.RJWC.se/warranty-information/

Need help? Got a question?

Get in touch at help@RJWCpowersports.com or your closest RJWC Powersports Dealer.

WARNING
Choking Hazard
May Contain Small Parts.
Keep away from children and pets.

Outlander 850-1000 Single Slip-on GEN3 Hardware Kit

Parts Included:

4x Exhaust Spring
2x Bottom Clamp
2x Top Clamp
1x Powdercoated Bracket Set
1x Gasket G2
5x M6x20 Hex Flange Screw
8x M5 A2 Washer
8x M5x16 Cylinder Screw
4x M8x12 Allen Bolt

Optional Parts:

1x APX Spark Arrestor
1x APX Shim Ring

Spark Arrestor & Shim Ring Installation

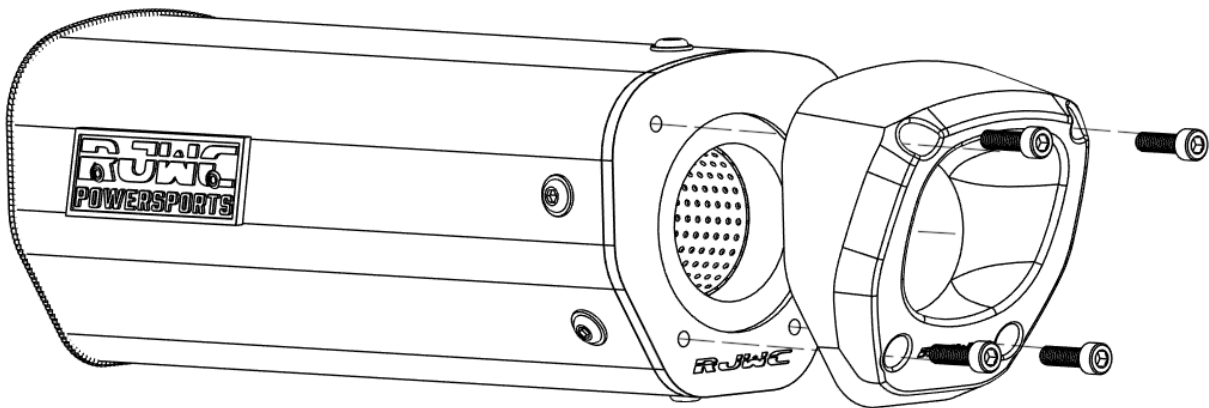

- The Spark Arrestor and Shim Ring do not come pre-installed, they can be found in the Hardware Kit
- To install the Spark Arrestor, start by removing the End Tip. Unscrew the four M6x20 Cylinder Screws in the End Tip to remove it
- You should see a small circular groove, in this groove you need to place the Shim Ring first, then the Spark Arrestor
- With the Shim Ring and Spark Arrestor in place, reinstall the End Tip by screwing back in the M6x20 Cylinder Screws

Important!

- If you want to install a Quiet Core in your exhaust, you need to replace the Shim Ring with the Quiet Core.
- The inner groove can only have **two** extras installed. These can include a; Quiet Core, Turndown Pipe, Spark Arrestor and Shim Ring

Removing the stock exhaust



Step 1 -

- Remove the four springs that connect the stock pipes, keep the gasket safe as this will be re-used when connecting the APX Exhaust



Step 2 -

- With the springs removed, pull the exhaust towards you to remove it from the rubber bushings
- To make this step easier, you can also remove the rear bumper

Note Removal or Modification of the heat shield will be required to clear brackets of the new exhaust when mounting.**

Installation

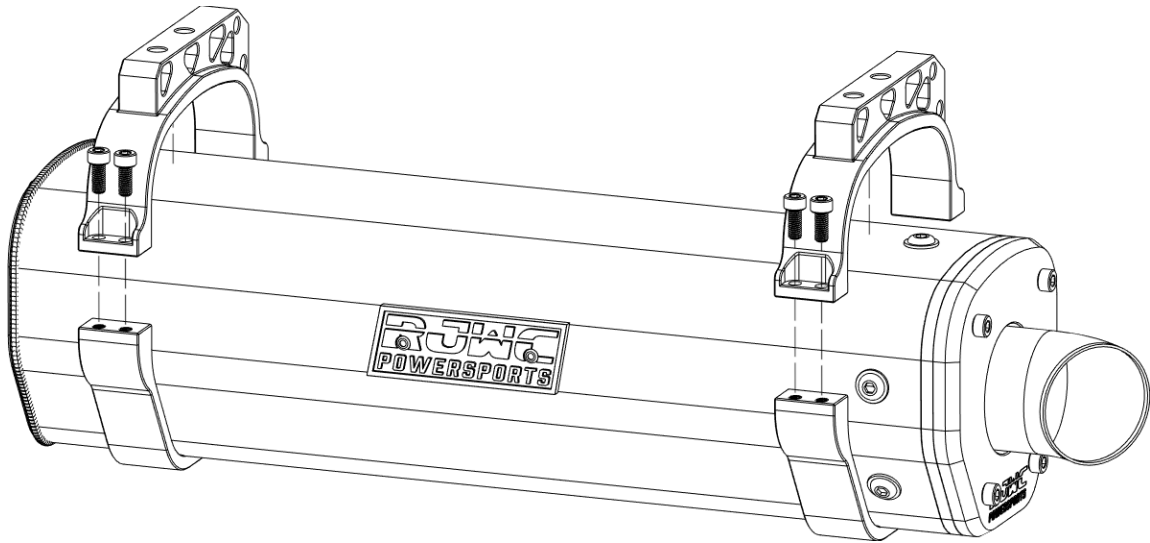

Step 1 -

- Place the 2x Bottom Clamps and 2x Top Clamps as shown in the picture
- Use the 8x M5x16 Cylinder Screws with the 8x M5 A2 Washers to secure the clamps in place

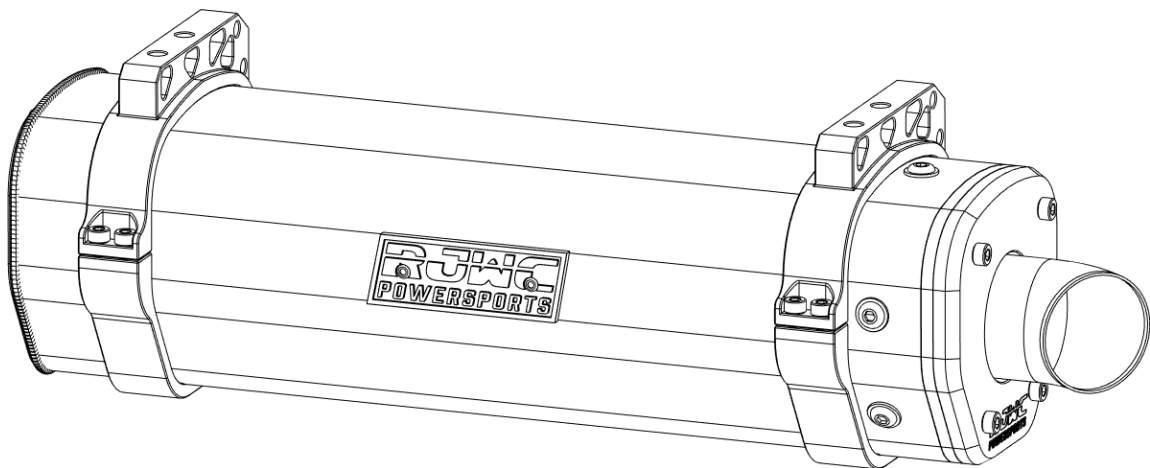

Step 2 -

- Do not tighten the Cylinder Screws fully, as you may need to adjust the positioning of the clamps. When mounting the APX to the frame

Installation

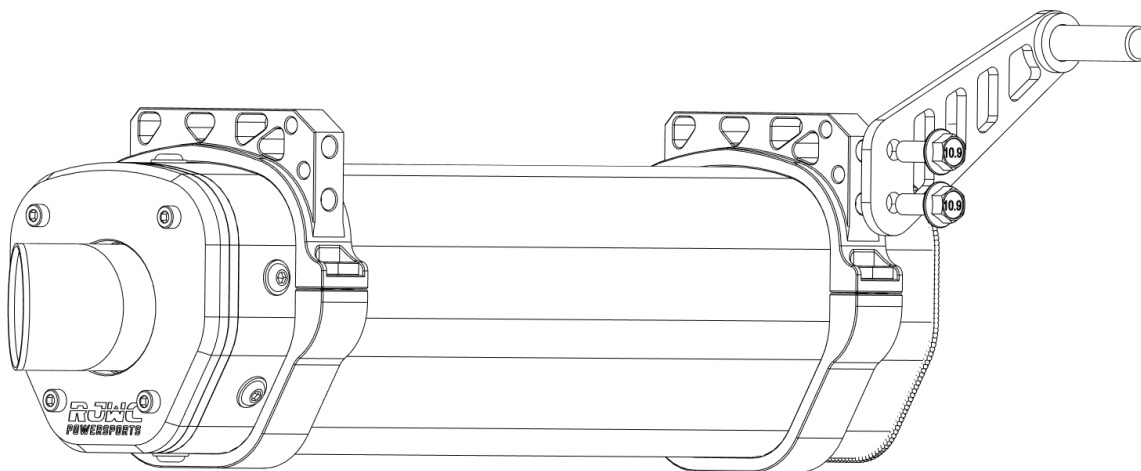

Step 3 -

- Using 2x M8x12 Allen Bolts, line up the Powdercoated Bracket as the picture shows above and tighten both bolts.

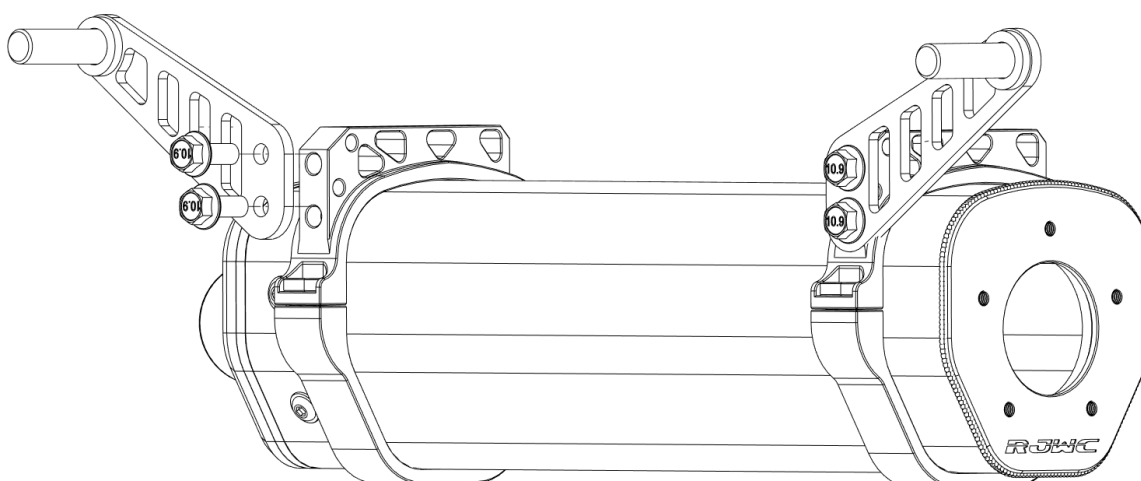

Step 4 -

- Using 2x M8x12 Allen Bolts, line up the second Powdercoated Bracket as the picture shows above and tighten both bolts.

Installation

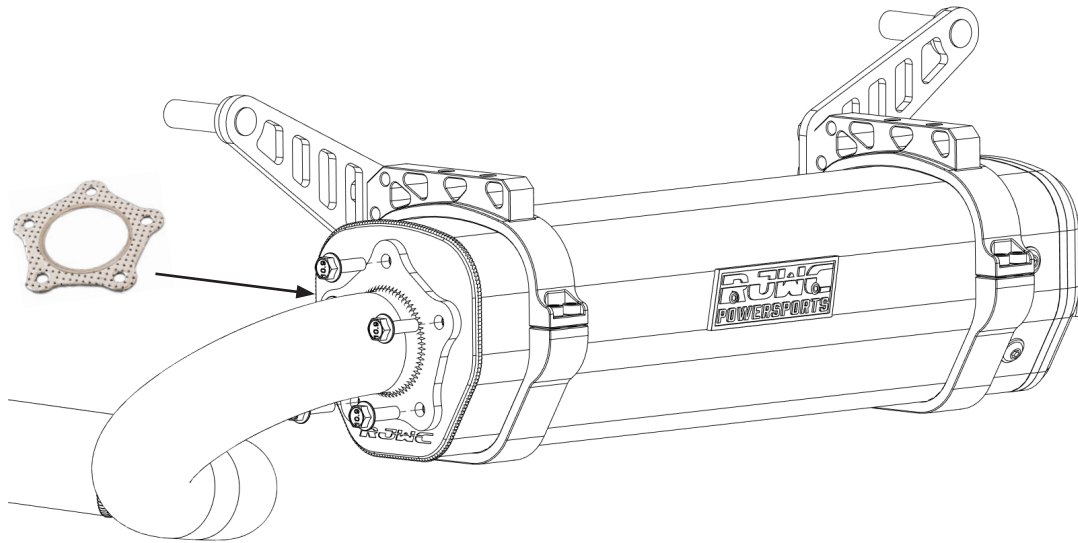

Step 5 -

- Place the G2 Gasket inbetween the pipe and the APX, lining up the holes between all three
- Use 5x M6x20 Hex Flange Screws to secure the pipe to the APX
- The G2 Gasket should be tightly sandwiched between the pipe flange and the APX can



Step 6 -

- To mount the exhaust to the frame, use the same bushings that the stock exhaust was installed into and push the Powdercoated Brackets through the bushings until tight
- You may need to adjust the position of the Top and Bottom Exhaust Clamps, once in position you can fully tighten the M5x16 Cylinder Screws

Installation

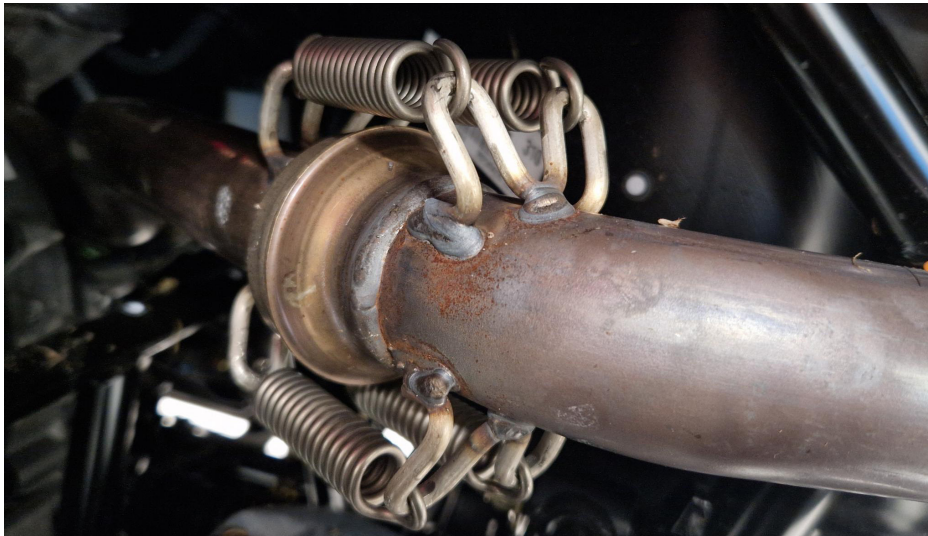

Step 7 -

- Line up the pipes, re-using the stock gasket
- Secure the pipe in place with the 4x Exhaust Springs provided in the Hardware Kit



You have now completed the installation of the Outlander 850-1000 Single Slip-on GEN3.

Don't forget to recheck all bolts and double check and they are tightly secured.

It's important to turn on your machine and let the engine idle to warm up the exhaust, let it cool down and check the tightness of all bolts and screws.

Continue reading for important information regarding Fuel Tuning!



Important Information - Fuel Tuning

The use of an aftermarket performance exhaust requires a crucial step - EFI tuning. RJWC Powersports exhaust systems must be accompanied by a proper re-flashing or use of an EFI Tuner to prevent the engine from running lean, which can result in engine damage. To guarantee a correct air to fuel mixture, make sure to adhere to the manufacturer's recommended settings for your fuel tuner.

Neglecting to properly tune the engine using an EFI tuner when using an RJWC Powersports exhaust will void the exhaust warranty. Any problems arising from the engine not running correctly, such as a lean condition or incorrect air/fuel ratio, will not be considered a valid warranty claim.

Please note that if your vehicle differs from the base model, additional modifications such as a different tune, turndown pipe, or other adjustments may be necessary to achieve a proper fit and optimal performance. All RJWC Powersports exhausts are designed and tested on stock-equipped vehicles.