

Flare® Studio

Instruction Guide

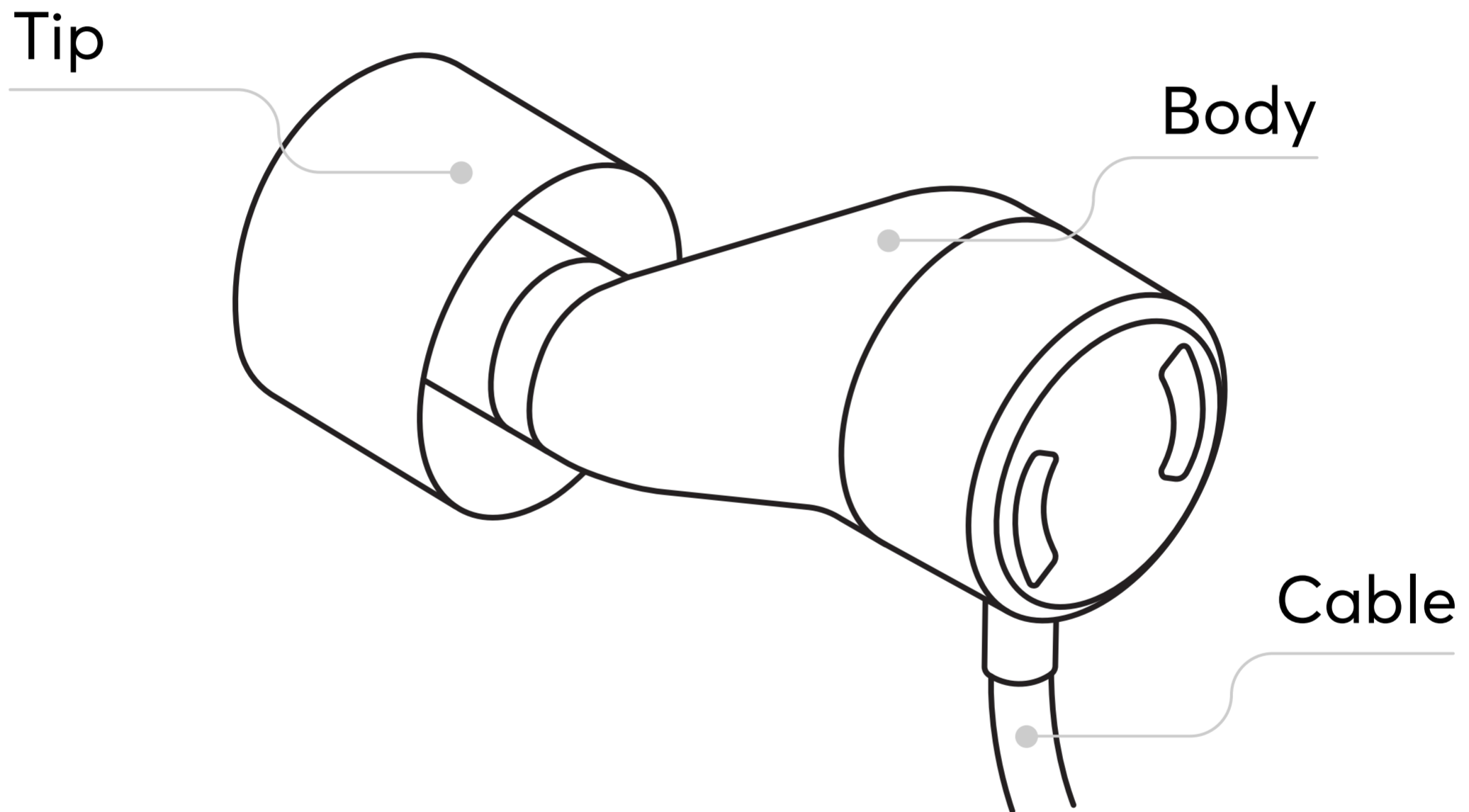

The Flare Studio consists of
a tip, a body and a cable.

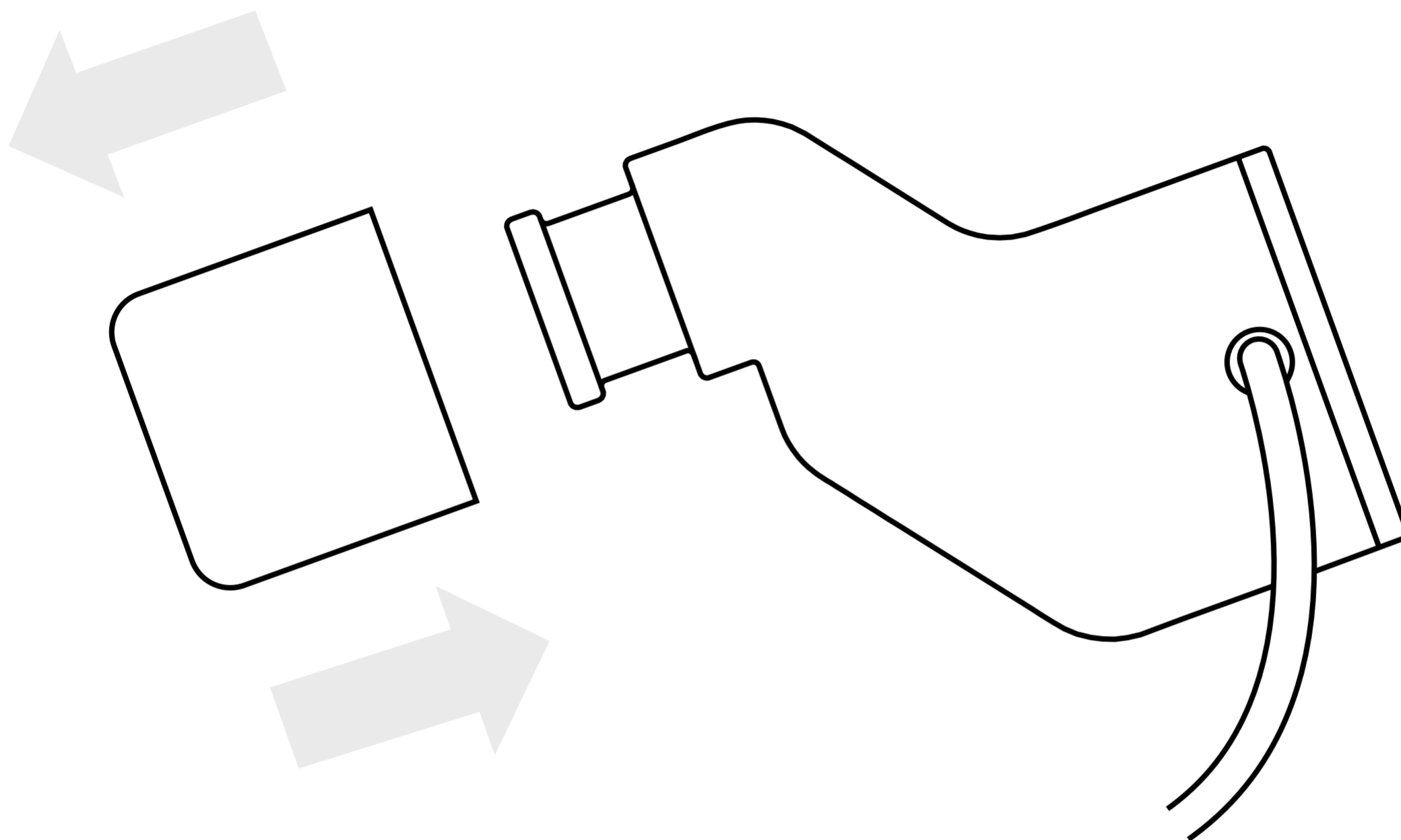

Select a suitable tip size (if you are unsure, start with the smallest tip) and attach it to the body.

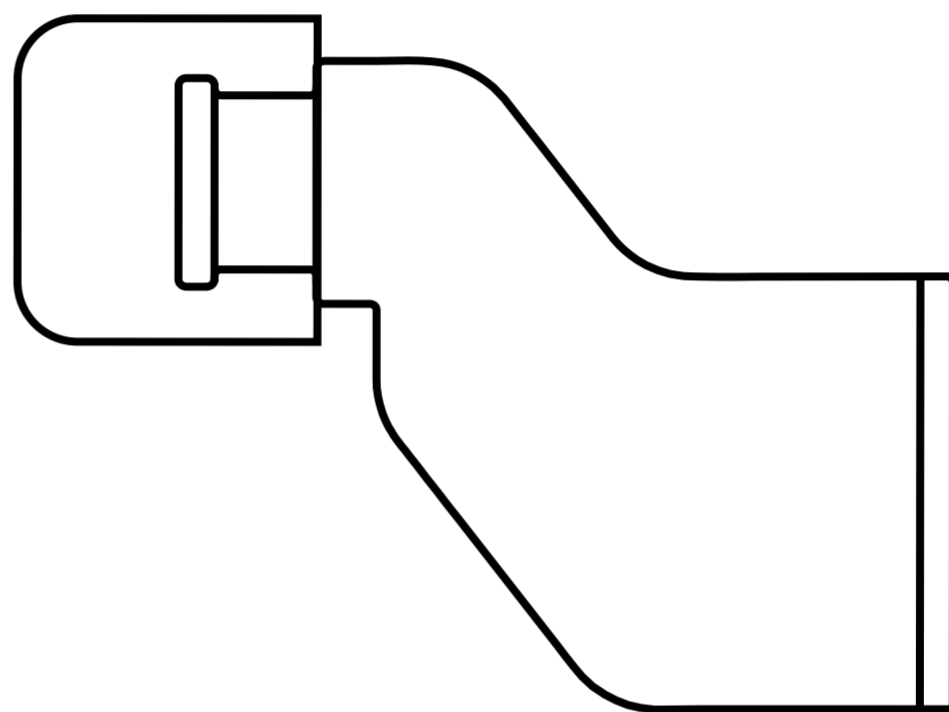
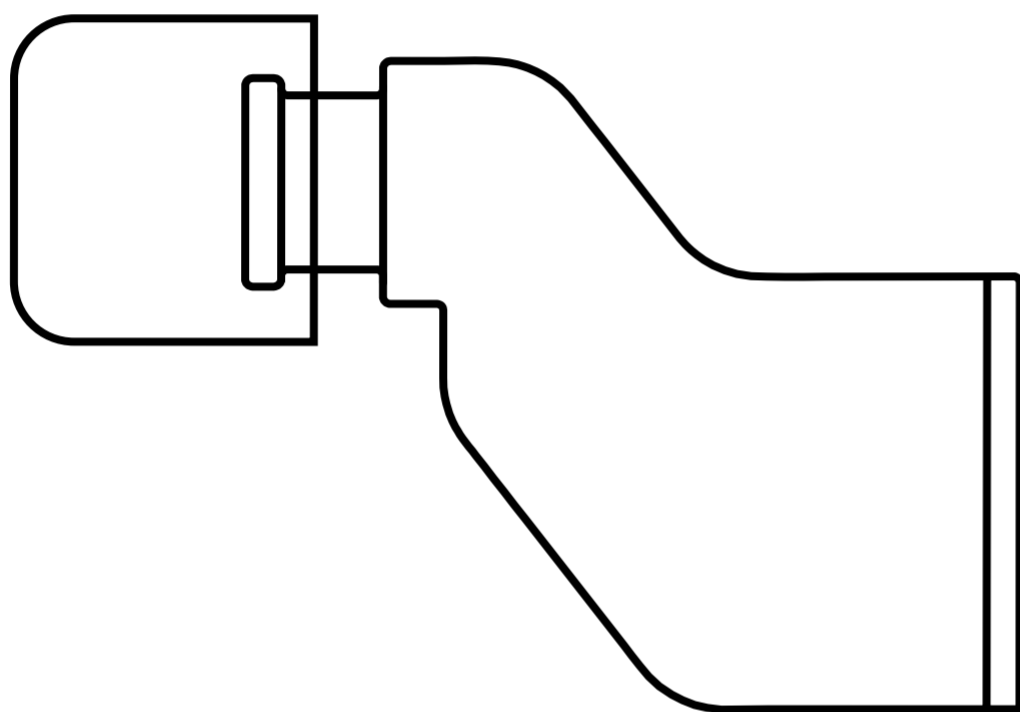

Push the tip on to the earphone and ensure
it is fitted on correctly.

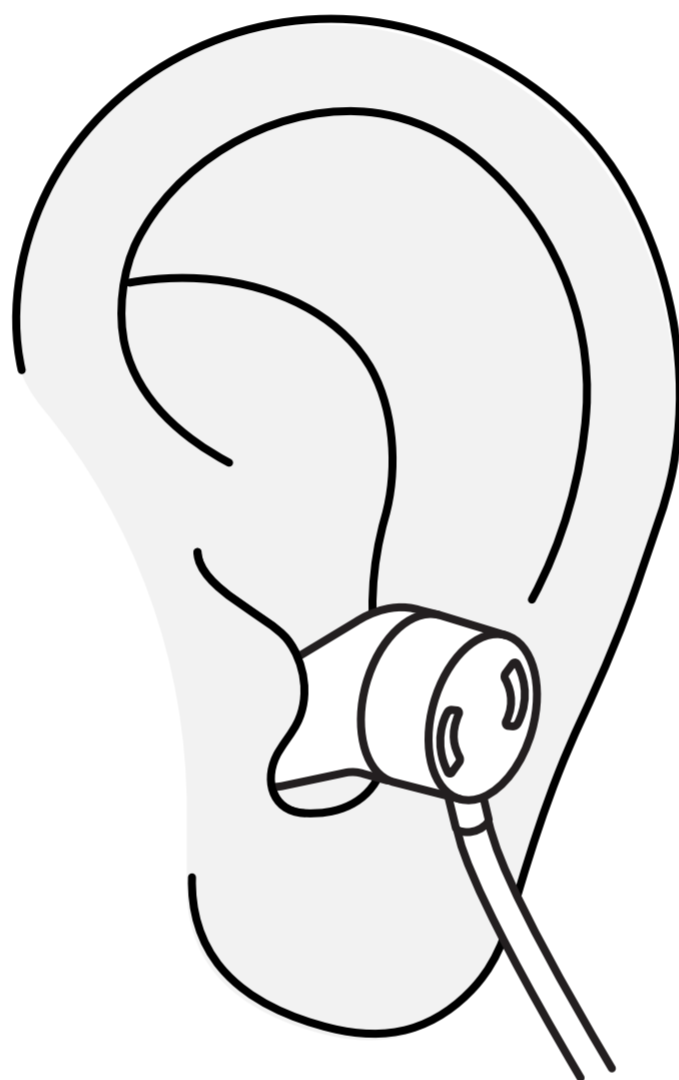

Ensure the cable of the Flare Studio
is hanging down.

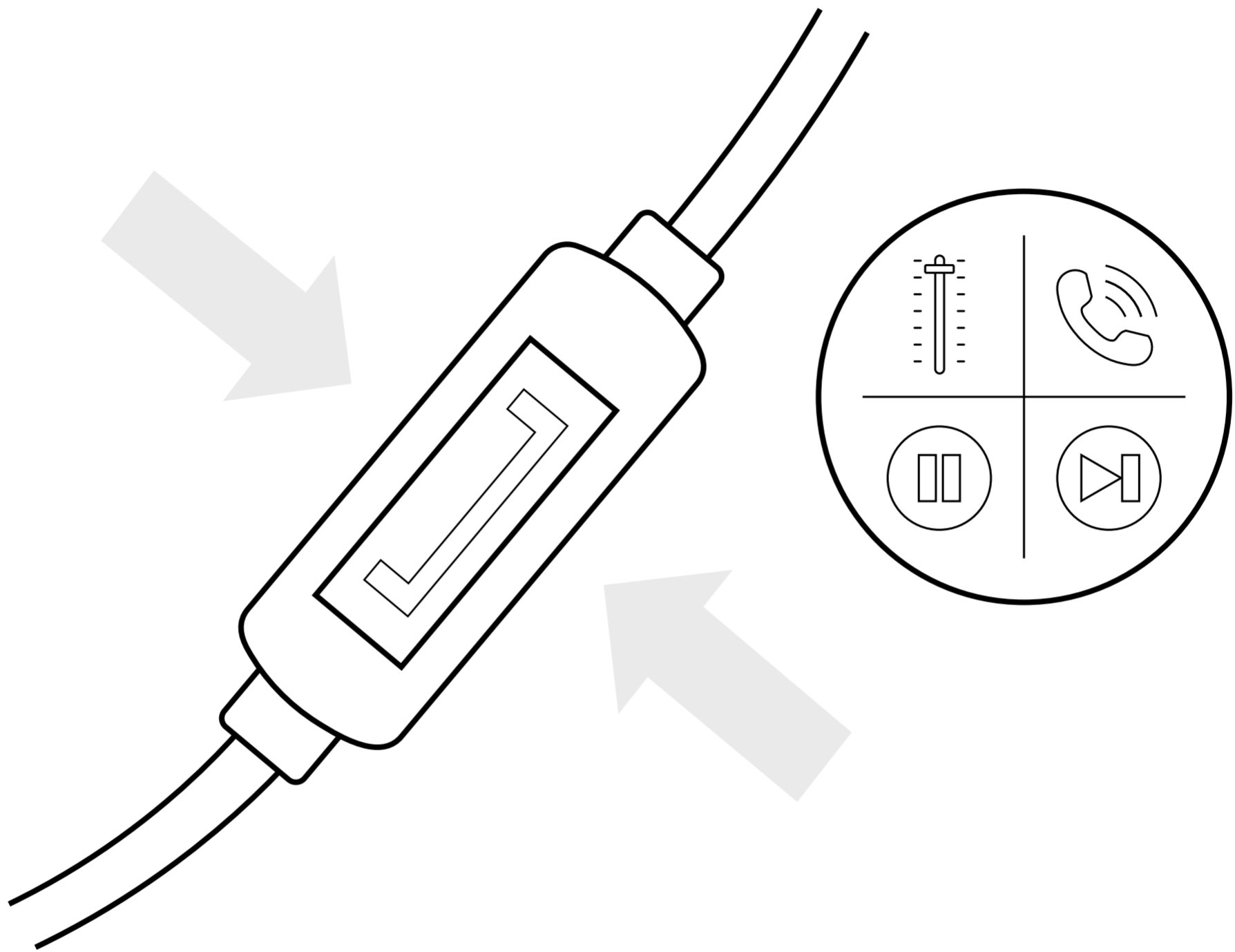

Push the button on cable for an action, such as pause, take a call etc. (Refer to your app for clarification and settings)