

A line art illustration of a bidet sprayer nozzle, shown in profile. The nozzle has a circular spray head with a grid of small circles. The handle is curved and has a textured grip area. The entire illustration is rendered in thin black lines.

Your Top to Bottom Manual

TUSHY HANDHELD BIDET SPRAYER

Installation & User Guide

[HELLOTUSHY.COM](https://www.helloTUSHY.com)

Congratulations!

Welcome to the first Bidet of the rest of your life!

Your hole life is about to change, but first, let's hook this up! This cheeky instruction booklet will walk you through installation step by step. You'll be pooping in luxury in no time.

Online video resources:

Scan the below QR code for a pre-install checklist, installation videos, TUSHY tunes, and more!

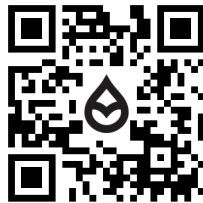

hellotushy.com/handheld

Table of Contents

4 Before You Start

6 Meet Your TUSHY Handheld Bidet

9 Getting This Potty Started

10 Connecting Your TUSHY Handheld Bidet

17 How to Use Your TUSHY Handheld Bidet

19 Frequently Asked Questions

21 Troubleshooting

23 Warranty

25 Warnings & Safety

29 Meet the Poo-Rus

1 Before You Start

Get into the groove.

Let's get this POTTY STARTED! Turn on some rump-shakin' TUSHY Tunes.

We've assembled the perfect tracks to get you in the mood to upgrade your toilet, your booty, and your life.

hellotushy.com/tunes



Check your connection.

What kind of water connection does your toilet have? If you have a flexible hose (left), you're good to go! Do you have a rigid metal or plastic pipe instead (right)? No problem. Visit hellotushy.com/flexhose or your local hardware store to get a flexible hose. You'll want a flexible hose that's 3/8" x 7/8".

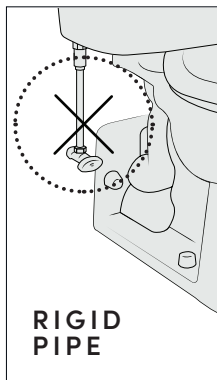
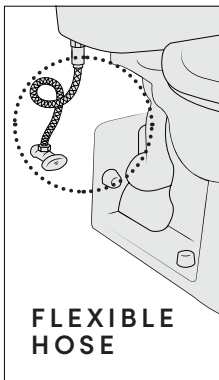

Get comfy.

Lay down a towel for some extra padding for your knees.



Important stuff:

Read all instructions before installing or using the TUSHY. Failure to do so may result in injury or property damage.

- Always turn off the water supply valves before installing or performing maintenance on your TUSHY.
- When tightening connections, make sure they are tight, but be careful not to over-tighten as this could result in leaks or property damage.
- Make sure you check for leaks after installing your TUSHY and periodically thereafter.
- When using your TUSHY, adjust the pressure slowly. Increasing the pressure too fast may lead to discomfort or injury.

If you're not sure about something, please consult a plumber or send us an email at install@hellotushy.com.

2 Meet Your TUSHY Handheld Bidet



Included Parts:

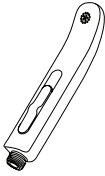

**TUSHY Handheld
Bidet Sprayer**



Shutoff Adapter
($\frac{7}{8}$ " x $\frac{1}{2}$ " x $\frac{7}{8}$ "
compression)

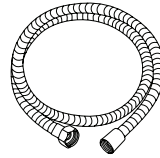

Bidet Hose
(3.9 feet, $\frac{1}{2}$ " to $\frac{1}{2}$ "
compression)



Holder Body



Tank Hook



Suction Cup

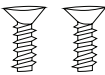

**Hook-mounting
Screws**
(2x)



**Wall-mounting
Screws**
(2x)



Wall Anchors
(2x)

TUSHY TIP

Keep all parts and this manual — you may need them for future maintenance or warranty claims.

You'll Also Need:

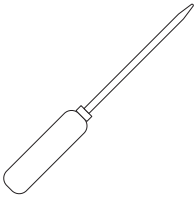

**Phillips Head
Screwdriver**

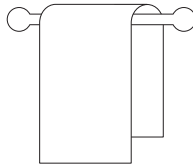

Towels
(for any spills)



Drill
(only if wall-mounting)



Bidet sustainability fact #1

Bidets use about as much water as filling a small glass... but save the water it takes to make a whole toilet-paper roll. Math says your butt is winning.

Your Bidet saves trees. Somewhere, a forest is softly whispering 'thank you.'

Americans flush away 36 billion rolls of TP a year. Congrats on officially opting out.

3 Getting This Potty Started

STEP 1 Turn off your water supply valve.

Turn off the water valve beside the toilet by turning it clockwise.

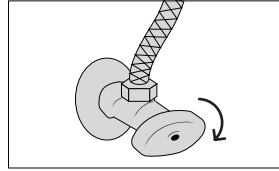

TUSHY TIP

If the valve is tight, there may be some mineral build up (white calcification). If it's stuck, try twisting in one direction then the other, rotating a little further each time until it turns freely.

STEP 2 Empty the toilet tank.

Flush your toilet to drain the tank. Hold down that flusher until the tank empties nearly completely! An inch of water at the bottom of the tank is okay, though.

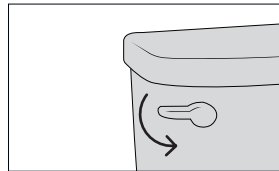

4 Connecting Your TUSHY



- 1 Holder Body
- 2 Bidet Hose
- 3 Shutoff Adapter

- 4 Water Pressure Control Slider
-  Where the poop goes!

STEP 3**Connect to the water line.**

A Disconnect the existing flexible hose from the toilet tank inlet by turning it clockwise when viewed from above. Have a towel ready to catch any residual water.

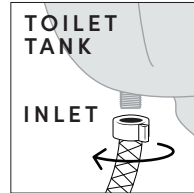
**TUSHY TIP**

Before attaching the Bidet Hose and Shutoff Adapter, check that the black rubber gaskets are present at all ends (both ends of the Bidet Hose, top end of the Shutoff Adapter) and that they are seated properly (sitting flat and not blocking the water hole).

B Screw the existing flexible hose to the bottom of the Shutoff Adapter by turning it clockwise, then attach the top of the Shutoff Adapter to the tank inlet by turning it counterclockwise. Hand-tighten only – do not overtighten.

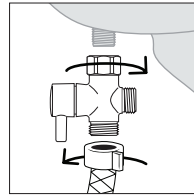

C Screw the hex-end of the provided Bidet Hose to the Shutoff Adapter's side connection by turning it clockwise. Snug with a wrench if necessary – do not overtighten.

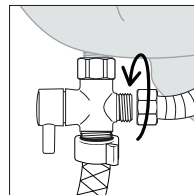
**TUSHY TIP**

Orient the Shutoff Adapter handle so it faces away from the toilet – you'll be closing it after every use by turning it clockwise, so easy access matters.

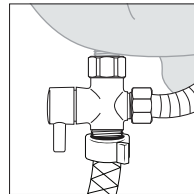

STEP 4**Connect the Handheld Bidet Sprayer.**

Hand-tighten the round end of the Bidet Hose to the water port on the bottom of the TUSHY Handheld Bidet Sprayer by turning it clockwise.

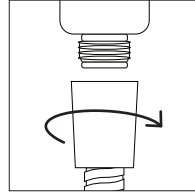
**TUSHY TIP**

You'll know the seal is tight enough when the hose can no longer rotate independently from the end piece. If the hose only turns once before stopping, it may be cross-threaded and not sealed properly. Do not force it – unscrew counterclockwise and reattach until the threads line up properly.

STEP 5**Assemble and mount the Holder.**

Dealer's choice – mount on the toilet tank or on the wall. For tank mounting follow Option 1 (Steps A–C). For wall mounting follow Option 2 (Steps A–C).

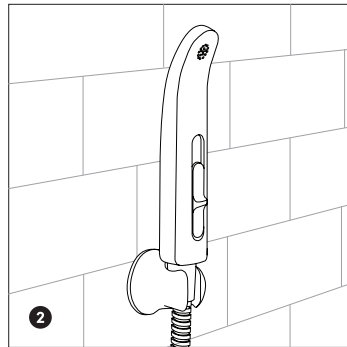
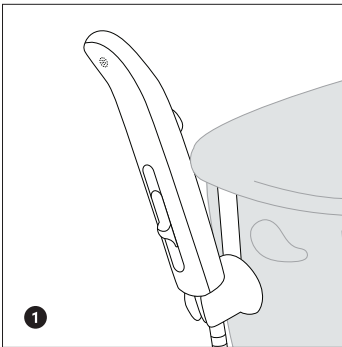

Option 1: Tank Mounting

A Slide the Suction Cup into the slot in the metal hook. Ensure the top of the hook and the suction end of the Suction Cup are facing the same direction.

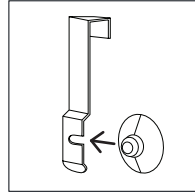

B Place the hook into the Holder Body, ensuring that the hole openings are aligned. Insert the Hook-mounting Screws through the front of the Holder Body, and screw them into the holes in the metal hook. This will also trap the Suction Cup in place.

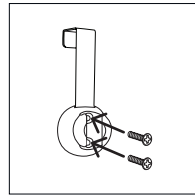
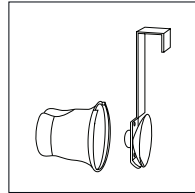

TUSHY TIP

Thread both Hook-mounting Screws partway before fully tightening either one— this keeps the bracket aligned.

C Lift the toilet tank lid and place the Tank Hook over the edge of the tank. Press the Holder Body against the tank to secure the Suction Cup, then replace the tank lid.

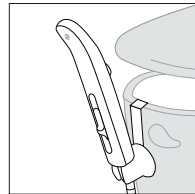

Option 2: Wall Mounting

A Choose your mounting spot. Mark the two places on the wall where you will need to drill, aligned vertically 0.92" (23.5mm) apart. If you have a skinny pencil, you can also place the Holder Body against the wall and mark the locations through the mounting holes.

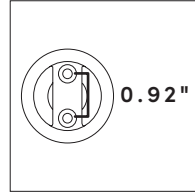

B Drill a .25" (6.5mm) diameter hole at the two locations, at least 1.58" (40mm) deep. Insert the Wall Anchors into the holes, pressing firmly or tapping gently with a hammer if needed.

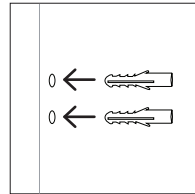

C Insert the Wall-mounting Screws through the front of the Holder Body, then use a screwdriver to turn them clockwise into the Wall Anchors. Make sure the notch on the outer rim of the Holder Body faces upward before fully tightening.

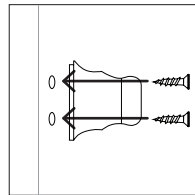

TUSHY TIP

If using a drill, set it to low speed and turn clockwise. Slow and steady.

STEP 6**▲ Check for leaks.****A Prepare for the leak check.**

Before turning the water back on:

- Make sure that the pressure slider on the Bidet is in the **OFF** (bottom) position.
- Make sure the Shutoff Adapter is **OPEN** (handle pointing up).

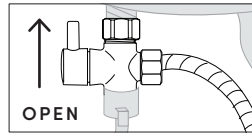
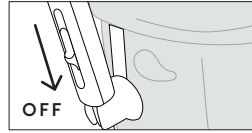
**B Turn the water on to test.**

- Turn the water valve counterclockwise to open, then clockwise to close, one time to pressurize the connections and check for leaks.

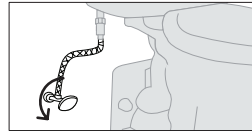
**C Check every connection.**

- Look closely for drips.
- Run your hand along each hose and connection to feel for moisture.

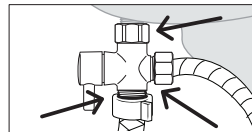
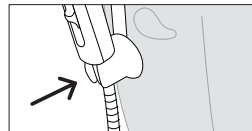

If you are experiencing leaks:

- Make sure the black rubber gasket is placed correctly inside of the Shutoff Adapter and at both ends of the Bidet Hose.
- Make sure the threads are aligned properly.
- Make sure all hoses and adapters are fully tightened clockwise, but remember not to overtighten!

▲ Final leak check

- Turn the water supply valve counterclockwise to open fully.
- Leave a towel or bowl below the connections.
- Check back in about **1 hour** to make sure there are no slow leaks that may not be instantly visible.
- If you see water, return to Step 3 and check the gaskets and thread alignment.

▲ IMPORTANT ▲ When you're finished testing:

- Turn the Shutoff Adapter back to the **CLOSED** position (handle pointing down). Keep this closed until you're ready to spray.

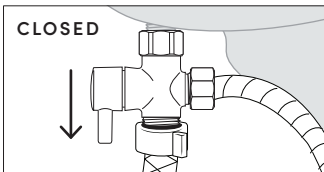

Butt haiku

Cold spray, warm relief
A small gasp, then acceptance
Clean begins anew.

5 How to Use Your TUSHY

Do your doo.

Don't be shy,
everybody poops!



Get ready to spray.

Turn the Shutoff Adapter to the **OPEN** position (handle pointing up) and grab the Handheld Bidet Sprayer out of its holder. Hold the Bidet with your thumb over the slider and position the spray head a couple of inches from the target area.

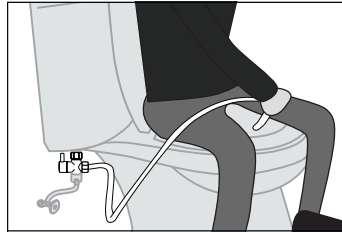
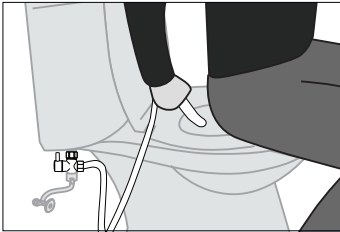

Push the slider:

Slowly push the slider forward to turn the water **ON** – push further for higher pressure. When finished, pull the slider back to its original position to stop the water (you should feel a slight click to confirm it is **OFF**).

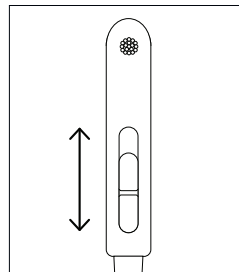

Put it away:

Return the Bidet Sprayer to the holder, then turn the Shutoff Adapter clockwise to the **CLOSED** position (handle pointing down).

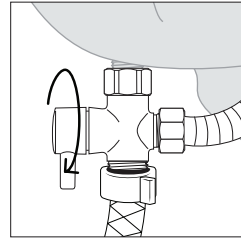

▲ WARNING ▲ Always close the Shutoff Adapter after every use by turning it clockwise until the handle points down. Leaving it open risks flooding if a leak develops.

Spray responsibly.

TUSHY's slider increases from a gentle spritz to a powerful wash to accommodate varying home water pressures. If your water pressure is exceptional, using TUSHY at its top setting (especially for a long time) could cause irritation or other issues. TUSHY is meant to wash away the bad bacteria, not power wash the good bacteria. For best butt health practices, talk to your doctor.

External use only.

TUSHY is designed to wash the body parts you can see. As the water comes from your tap, it is not safe nor recommended to use as a douche or enema—doing so is dangerous and will likely cause bodily harm. For best butt health practices, talk to your doctor.

6 Frequently Asked Questions

Why do I need to close the Shutoff Adapter after each use?

Closing the Shutoff Adapter between uses is a standard practice for all Handheld Bidets. On the slim chance that a leak occurs between the Bidet and the Shutoff Adapter, leaving the Adapter open could result in flooding your bathroom. By closing the Shutoff Adapter after each use, you eliminate this risk.

Ok, but(t) how do I dry off?

If your booty is too busy to air dry, you can pat dry with our super sustainable, 3-ply Bamboo Toilet Paper designed to be extra absorbent. Using TUSHY dramatically reduces the amount of TP needed by 80%. Endless, irritating wiping turns into just a few nice pats when you're using TUSHY! If you lived in Europe, you'd have monogrammed bum towels for the whole family, so school your house guests about the ills of TP and show them the Bidet side of life.

I need an extra doodad to install my TUSHY.

What do I doo?

Just like butts, there is a wide variety of toilets. In an effort to support our sustainability goals, we send you the standard parts in your TUSHY install kit that we anticipate you'll need. Visit hellotushy.com/parts for additional parts.

What else can I use my TUSHY Handheld Bidet Sprayer for?

Great question! While the main function of the TUSHY Handheld Bidet is to clean your booty, there's really no limit to what you do with it. Wash your front, wash your pets, rinse cloth diapers, clean your shower, rinse your hair— whatever you want!

How do I clean my TUSHY Bidet?

Use a neutral pH mild cleaner to wipe down surfaces— avoid spraying liquid directly onto the sprayer body or handle. And if you're looking for a new toilet brush, check out the sleek, eco-friendly TUSHY Brush!

▲ CAUTION ▲ Avoid using harsh chemicals such as bleach or bleach-based products on your TUSHY's water hoses. These can cause the hose to crack and lead to leaks and water damage.

7 Troubleshooting

	PROBLEM	POSSIBLE CAUSES	POSSIBLE SOLUTIONS
1	<p>My roommates, friends, and loved ones won't stop using my TUSHY.</p>	<p>TUSHY's awesomeness.</p>	<p>Buy them TUSHYs for their birthdays.</p>
2	<p>There is leaking from the TUSHY body or hose connections.</p>	<ol style="list-style-type: none"> 1. The black rubber gasket(s) are not properly installed on the hose or Adapter. 2. The Shutoff Adapter or hose were cross-threaded during installation. 3. The Handheld Bidet slider is not in the OFF position. 4. The TUSHY or hose may need to be replaced (very rare). 	<ol style="list-style-type: none"> 1. Make sure the rubber gasket(s) are properly installed on both ends of the Bidet hose and the top of the Shutoff Adapter. 2. Unscrew and reattach the Shutoff Adapter and hose. If the threads were damaged, contact us to request a replacement Adapter. 3. Check that the slider is pushed all the way down on the Bidet body. You should feel a slight click when it is in the OFF position. 4. Contact us via email at install@hellotushy.com to request a replacement part or TUSHY.
3	<p>There's no access to water next to my toilet.</p>	<p>You have a flush-o-meter, skirted, wall-mounted, commercial toilet or a unique plumbing situation that doesn't allow you to access the 3/8" toilet connection needed for installation.</p>	<p>If this applies or you aren't sure, reach out to our team at install@hellotushy.com so we can assist you!</p>

	PROBLEM	POSSIBLE CAUSES	POSSIBLE SOLUTIONS
4	<p>The hose isn't long enough for me to use the Bidet properly.</p>	<ol style="list-style-type: none"> 1. The hose got twisted up during installation. 2. You mounted the Bidet on the opposite side of the toilet from the valve because it fits better or it was blocking the flush handle—or you're severely left-handed. 	<ol style="list-style-type: none"> 1. Take the Bidet out of the holder and extend the hose to its full length, rotating the Bidet to uncurl the hose as you go. 2. Reach out to our team so we can assist you in finding a longer replacement hose!
5	<p>The spray pressure is too strong.</p>	<p>Your home has high water pressure.</p>	<p>First reduce pressure using the slider on the Bidet. If pressure is still too strong, partially close the Shutoff Adapter by turning it clockwise partway to reduce the flow of water.</p>
6	<p>The spray pressure is too weak.</p>	<ol style="list-style-type: none"> 1. The Bidet hose is kinked or twisted which is restricting the flow of water. 2. There is a blockage or misplaced gasket in one of the connectors. 3. Your home has low water pressure. 	<ol style="list-style-type: none"> 1. Check that the Bidet hose is not kinked or bent at too sharp of an angle. Also, untwist the hose if it is tightly coiled. 2. Check all of the connection points on the Bidet Sprayer, Bidet Hose, and Shutoff Adapter. Make sure that there are no foreign objects and that all gaskets are seated properly. 3. Make sure that you are fully opening the Shutoff Adapter and using the Bidet on its highest pressure setting.

8 One Year Limited Warranty

1. TUSHY warrants this product to be free from defects in materials and workmanship under conditions of normal use for a period of one (1) year from the date of purchase. This warranty is extended only to the original purchaser and is not transferable if the original purchaser sells or otherwise transfers the product. TUSHY may require proof of purchase to determine whether a claim falls within the warranty period.

2. To report any product issues and to open a claim under the warranty, contact TUSHY at warranty@hellotushy.com. TUSHY will reach out to you to attempt to help resolve the issue.

3. If a defect covered by this warranty arises, TUSHY's obligations under this warranty are limited to repair or replacement, at TUSHY's option, provided that such products were used in accordance with the instructions. Replacement may be of the same or similar product at TUSHY's discretion and based on availability. TUSHY reserves the right to inspect the product to confirm that the issue is covered by this warranty.

4. TUSHY is not responsible for the cost of return shipping of the product.

5. This warranty does NOT apply to:

- Damage or loss that occurs during shipment.
- Damage, loss or injury resulting from negligent or improper use or the user's failure to follow instructions.
- Damage or loss resulting from modification of the product.
- Damage or loss resulting from normal "wear and tear" of the product.
- Damage based on claims of personal injury or property damage, including, but not limited to, claimed damages that are incidental or consequential in nature.

6. This written warranty is the only warranty made by TUSHY. Repair or replacement as provided under this warranty shall be the exclusive remedy available to the purchaser. TUSHY shall not be responsible for loss of use of the product or for other incidental, special, or consequential damages or expenses incurred by the purchaser or a third party, or for any other expense not specifically stated above. Except to the extent prohibited by applicable law, any implied warranties, including those of merchantability and fitness for a particular purpose, are expressly limited to the duration of this warranty. Some states do not allow limitations, so the above limitation and exclusion may not apply to you.

7. This warranty gives you specific legal rights, and you may also have other rights which vary from state to state.



Bidet sustainability fact #2

Using a Bidet eliminates about 250 lbs of CO₂ per person per year from TP production and transport. Feel free to brag!

One Bidet can save over 500 trees across its lifetime. You're basically running a conservation program from your toilet.

Bidet water use = 1 cup. TP manufacturing water use = 37 gallons per roll. It's giving 'hydration inequality.'

9 Warnings & Safety

Read all instructions before installing or using your TUSHY.

Failure to do so could result in property damage, injury or death. Always turn off the water supply before installing or performing maintenance on your TUSHY.

When tightening connections, make sure they are tight, but be careful not to overtighten as this could result in leaks or property damage. Make sure you check for leaks after installing your TUSHY and periodically thereafter. When using your TUSHY, push the slider slowly. Increasing the pressure too fast may lead to discomfort or injury.

Important Safeguards

Do not attempt to open or perform internal maintenance on the TUSHY as this could result in injury, and will impact the performance of the Bidet as well as void the limited warranty.

▲ HOSE WARNING ▲ Do not fold or crush the water supply hose; do not damage by cutting with a sharp object. Do not yank on the hose; do not suspend additional items from the hose. Doing so may result in water leakage.

▲ STANDING WARNING ▲ Do not stand on the TUSHY. Doing so could result in property damages, injury or death.

▲ WATER HAMMER WARNING ▲ If you hear loud banging in your pipes during installation, stop immediately and consult a licensed plumber. Continuing may damage your plumbing and void your warranty.

▲ EXPOSURE WARNING ▲ Exposure to extreme temperatures, strong chemicals (e.g., bleach, hydrochloric acid, or other harsh cleaning agents), or high water pressure may damage components of the Bidet, leading to malfunctions such as leaks or flooding. Do not use, store, or apply in any way such chemicals around or near the Bidet or its components. If you are concerned you may have, please reach out to install@hellotushy.com for replacement parts. Always follow proper usage and maintenance guidelines to prevent damage. Consult the cleaning instructions in Frequently Asked Questions.

▲ SAFETY WARNING ▲ Do not wrap the Bidet Hose around the neck or any other parts of the body. Do not leave the Bidet or Hose on the floor as a trip hazard. Do not drink water from the Bidet. Do not put any part of the Bidet or its accessories inside the body. Doing so could result in property damages, injury or death.

▲ IMPORTANT ▲

Annual Inspection & Damage Detection

Check your Bidet, Adapter(s), hose(s) and any other parts each year for cracks, leaks, signs of rusting, rips, tears, or any signs of distress/damage. If you find any of these issues, or observe any other signs of damage, turn off your water supply and disconnect the Bidet. Discontinue use and contact us at install@hellotushy.com to obtain replacement parts. We've got your back(side)! If unsure, **it is recommended to replace the hoses and adapters every 4 years** to maintain optimal performance and ensure safety.

10 Meet the TUSHY Poo-Rus

We bend over backwards for your backside. Find a helpful Bidet concierge every day at hellotushy.com — chat with a real pooping human!

Support Center

Self-service more your thing?
Visit hellotushy.com/support

Text Us

Keep us in your back pocket! Text MYTUSHY to 794-54 (US only) or 1 (888) 599-8926 (Canada only). Message us via WhatsApp at 1 (888) 218-8749.

EMAIL US

Say Hi!

Comments! Compliments! Product feedback!
hello@hellotushy.com

Need a Hook-up With the Hook-Up?

Install help, spare parts, and troubleshooting:
install@hellotushy.com

Subscriptions

Change address, change frequency, or cancel by logging in at hellotushy.com

Returns

Send it back?! OK, I guess.
hellotushy.com/returns

@hellotushy   

You did it!

Take a breather and relax with a soothing meditation from TUSHY's founder. Scan the QR code for ultimate booty bliss.



Let's leave the cold seat of the toilet.

Let's travel to a faraway place.
Let's make a return to nature.

Feel her call...

Behind the Manual

PRODUCER **TUSHY**

KEY GRIP **GRAVITY**

BEST BOY **SCREWDRIVER**

PROPS MASTER **TOOLBOX**

LOCATIONS **BATHROOM**

BOOM OPERATOR **YOUR BUTT**

SPECIAL THANKS **TUSHY USERS**



**Bottoms up.
You did this thing.**



Get ready to feel fresher than a spring breeze.

HELLOTUSHY.COM