

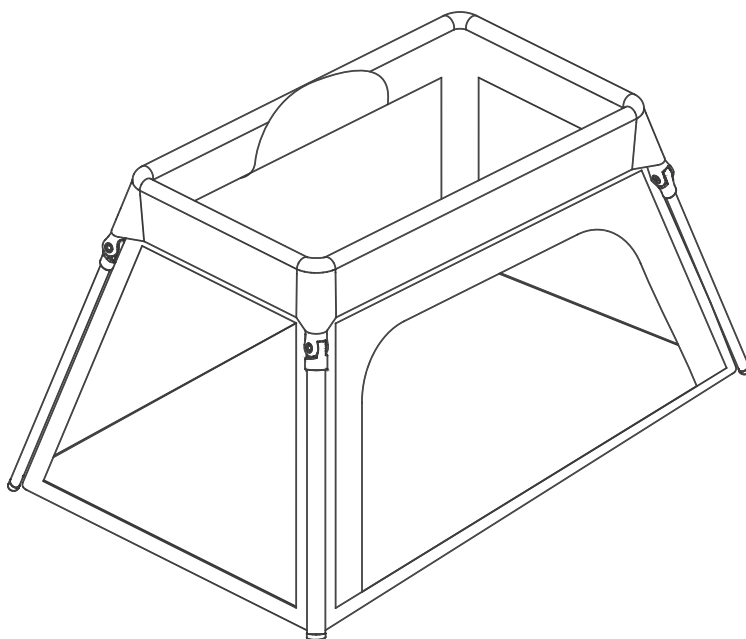

User Manual for

Nipper Nest



IMPORTANT

READ CAREFULLY AND KEEP FOR FUTURE REFERENCE

WARNING

BEFORE USE, REMOVE AND DISPOSE OF ALL PLASTIC BAGS AND PACKAGING MATERIALS AND KEEP THEM OUT OF REACH OF CHILDREN.

THE COT IS INTENDED FOR USE FOR CHILDREN AGED:

From birth up to 24 months.

- **WARNING:** With the newborn mattress accessory attached in the elevated position (crib mode), the cot is designed for use by children from 0-6 months (weighing up to 9kg). Once the child is able to sit, kneel, or pull themselves up, the standard on the floor mattress position is safest.
- **WARNING:** Before using in crib mode (higher bed base) make sure that the zip is completely closed and secured with the buckle.
- **WARNING:** To prevent the risk of fire, do not place the cot near fans, electric bar fires, gas fires or other sources of heat.
- **WARNING:** Do not use the cot if any parts are broken, ripped or missing, and only use spare parts approved by the manufacturer.
- **WARNING:** Do not use more than one mattress in the cot.
- **WARNING:** Only use the mattress sold together with this cot. Do not add a second mattress above this one due to a risk of suffocation.
- Infants can suffocate on soft bedding. Avoid placing a pillow or similar items under a sleeping infant.
- Do not adjust the height of the cot when the child is in it.
- The cot is ready for use only when the locking mechanisms are engaged. Make sure they are securely fixed before using the cot.
- The lowest position of the bed base is the safest. The base should be moved to this position as soon as the baby is old enough to sit up.

- When the child is able to climb over the sides to get out of the cot , this cot is no longer suitable for them.
- All opening and adjustment operations and the installation of accessories must be carried out by an adult.
- Before using always check that both sides of the cot are securely in place and that the cot locking mechanism is engaged.
- Do not move the product when the child is in the cot.
- Do not place more than one child at one time in the cot.
- Do not let other children play unattended close to the cot.
- Do not place the cot on to a sloped surface with your child inside.
- To prevent it becoming trapped, do not place the cot close to walls or obstacles.
- The cot must be kept away from electrical cables and cords: do not position close to windows where cords, curtains or similar could pose a suffocation or choking hazard, To avoid all risks of strangulation, never give children objects with cords or strings attached, or leave them within their reach, Prolonged exposure to direct sunlight can cause the colors of the fabric to fade. After a prolonged exposure of the product to high temperatures, wait a few minutes prior to putting your child in it.
- Do not close the cot when the child is in it.
- Keep the cot out of reach of children when not in use.
- The crib/cradle should be placed on a horizontal floor. Young children should not be allowed to play unsupervised in the vicinity a crib /cradle.

Getting Started

outnabout

Helpline

We hope these instructions help you to enjoy your new cot.

If at any time you are unsure about the safe use of this product please call our helpline before using it on 01234 344 230

Distributed by:

outnabout

Out'n'About ATP Limited
Unit 2D, Kinsbourne Farm,
MK43 8TS, Stagsden
Tel: 01234 344230
Email: info@outnabout.com

Useful Information

Like us on Facebook to keep up to date with all the latest news and offers.



facebook.com/outnaboutuk



twitter.com/outnaboutuk



instagram.com/outnabout_official

Inside the box

outnabout

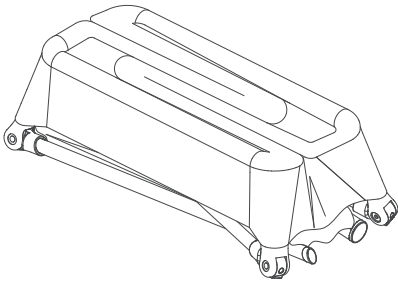

NIPPER NEST

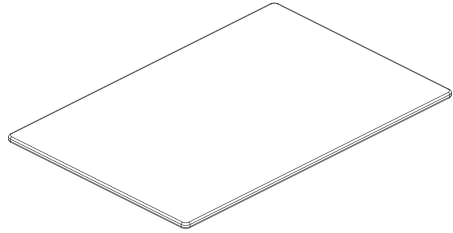

MATTRESS

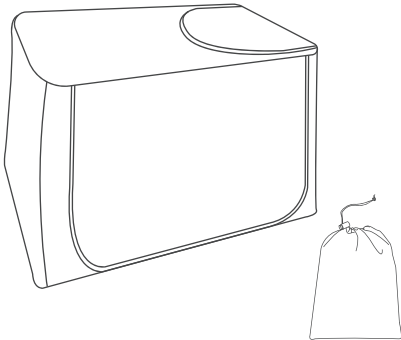

UV COVER AND STORAGE BAG

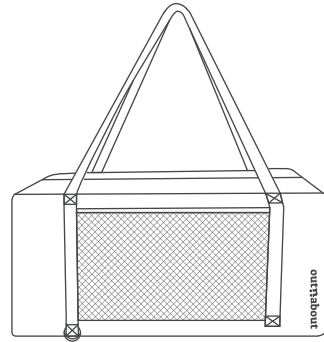

NIPPER NEST TRAVEL BAG



Optional Crib Accessory

outnabout

Crib accessory which includes

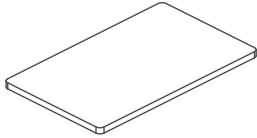

SMALL MATTRESS

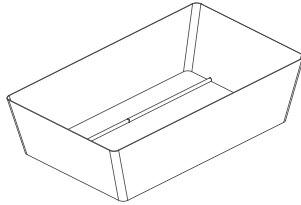

CRIB ACCESSORY

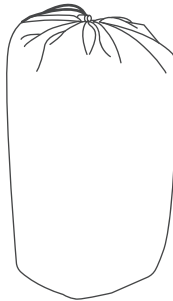
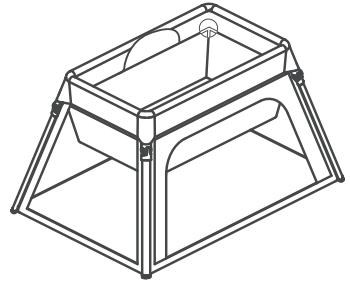

CRIB ACCESSORY STORAGE BAG



Instructions

outnabout

How To Unfold

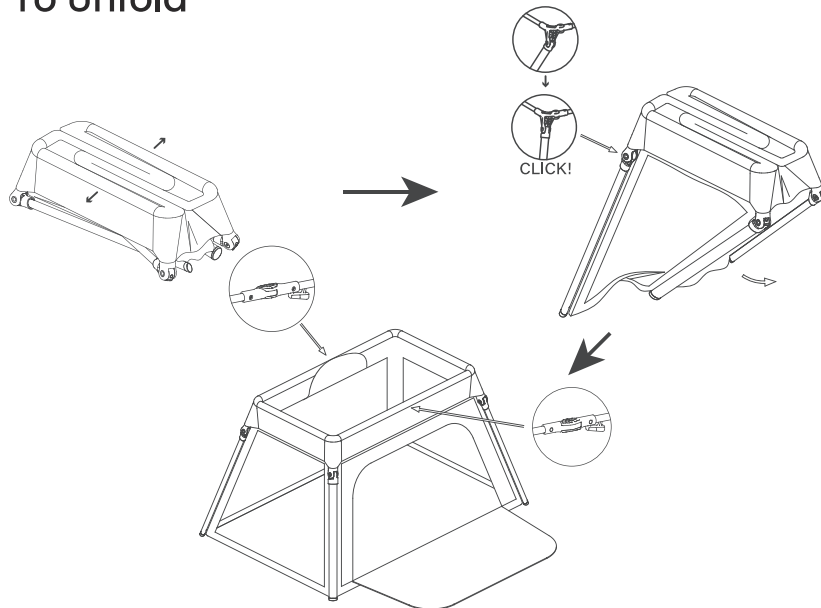

Lift up the cot, open the upper frame, you will hear a "CLICK" when the upper frame is fully opened and locked. Open the four legs one by one, you will hear a "CLICK" when the leg is fully opened and locked.

Playpen Mode

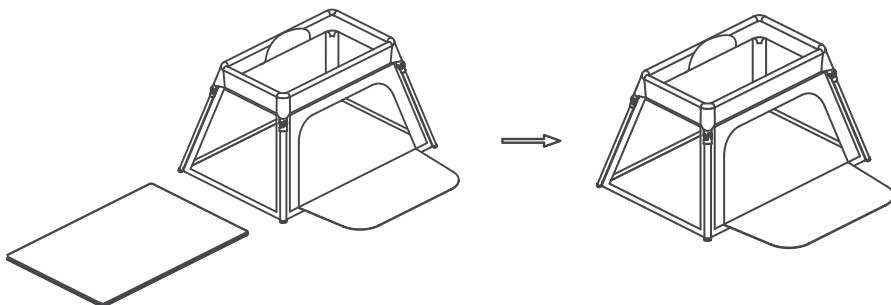

Put the mattress into the Nipper Nest.
For easy access to your child, unzip the side.

Instructions

outnabout

How to use the UV cover

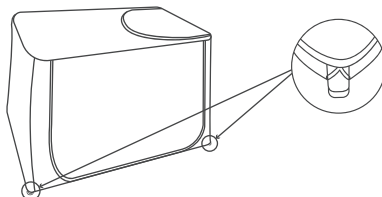

Pull the UV cover over the Nipper Nest and secure four corners with elastic ties. There is a zip cover on the side (for playpen mode) and on the top (for peaking during snoozing). Please note, the UV cover is not suitable for use when the optional crib accessory is installed.

Crib Mode

This requires the optional crib accessory.

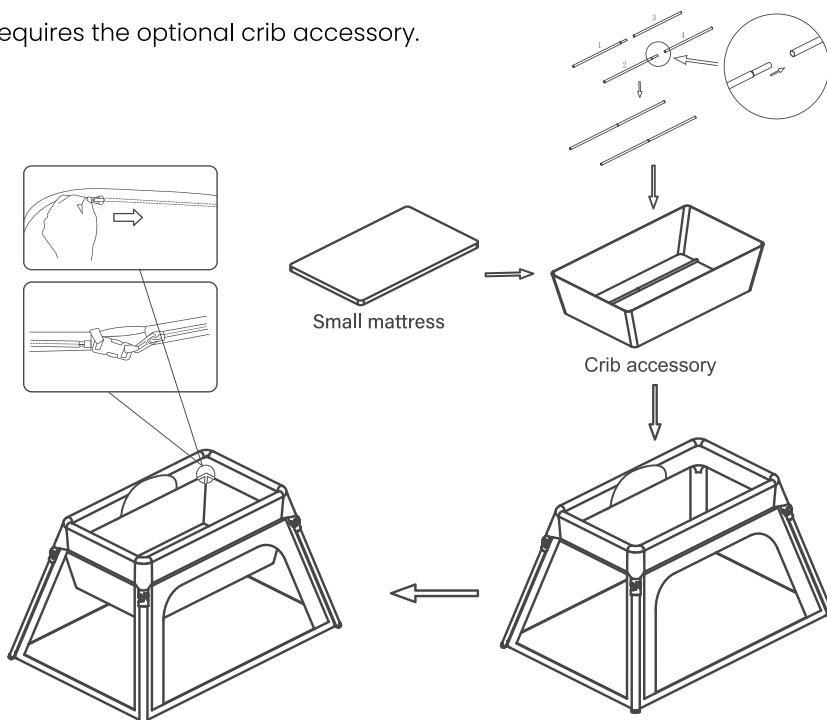

Assemble the crib accessory with the rods provided. Fasten the zip on the crib accessory to the Nipper Nest. Pull the zip all the way round the Nipper Nest. Put the small mattress into the crib accessory.

Instructions

outnabout

How To Fold

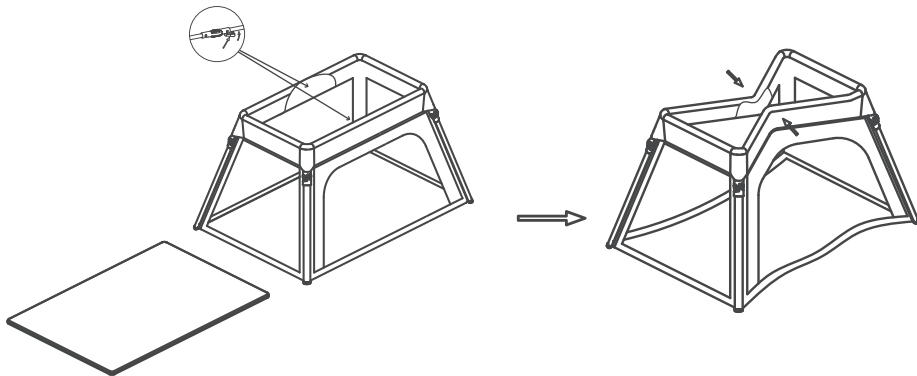

To fold the Nipper Nest, remove the mattress. Press the buttons on the top frame and the fold into a "Z" shape.

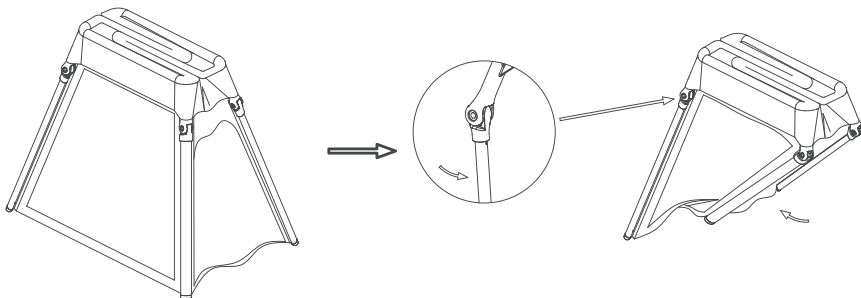

Fold the legs inward one by one.

Instructions

outnabout

How To Fold

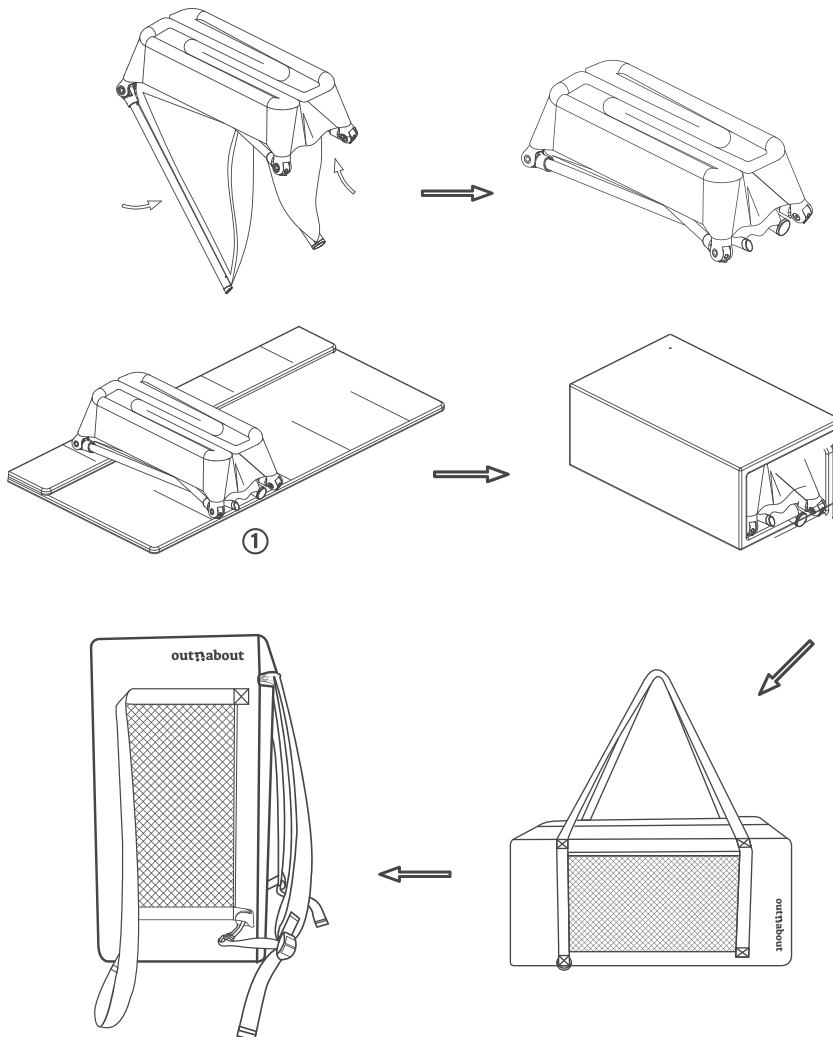

Fold the edges of the mattress as shown in figure 1. Roll the mattress around the Nipper Nest, and use the Velcro on the mattress to fasten the fold. The Nipper Nest will now fit in the travel bag.

Care & Maintenance

outnabout

MAINTENANCE

All of the fittings, other hardware and plastic parts on the product should be inspected periodically to ensure that they are secured properly and not damaged or malfunctioning. The straps and fabric items and their stitching should also be inspected periodically to ensure that they are secured properly and not loose, torn or otherwise damaged.

Any missing, broken, or worn components should be replaced immediately, and the product should not be used until they are replaced. Only original manufacturer's components should be used.

CLEANING

The fabric material on this product can be cleaned using mild household soap or detergent and warm water on a sponge or clean cloth. Always allow the fabric to completely air dry before using the product.

The frame and should always be kept clean and free of dirt and foreign matter, Use a sponge or cloth dampened with warm water and a mild detergent cleaner to clean these parts if necessary.

STORAGE

Direct sunlight may fade fabric. Store indoors to prolong its appearance. DO NOT store outdoors. Always store the product in a dry environment. Store the product in a safe place when not in use (i.e. away from children) DO NOT place heavy objects on top of the product. DO NOT store the product near a direct heat source such as a radiator or open fire.

WARRANTY

To register your Nipper Nest online please go to www.outnabout.com/warranty
It's simple and will only take a minute.



Follow QR code to
register your warranty

This cot complies with:
ASTM F406-24 / EN 12227:2010
EN 1130:2019+AC:2020 / EN 16890:2017+A1:2021

Out'n>About ATP Limited
Unit 2D, Kinsbourne Farm,
MK43 8TS, Stagsden
Tel: 01234 344230
Email: info@outnabout.com



facebook.com/outnaboutuk



twitter.com/outnaboutuk



instagram.com/outnabout_official

www.outnabout.com



Out'n'About ATP Limited
Unit 2D, Kinsbourne Farm,
MK43 8TS, Stagsden
Tel: 01234 344230
Email: info@outnabout.com
www.outnabout.com



facebook.com/outnaboutuk



twitter.com/outnaboutuk



instagram.com/outnabout_official