

capillus Healing Pod

Red Light Therapy

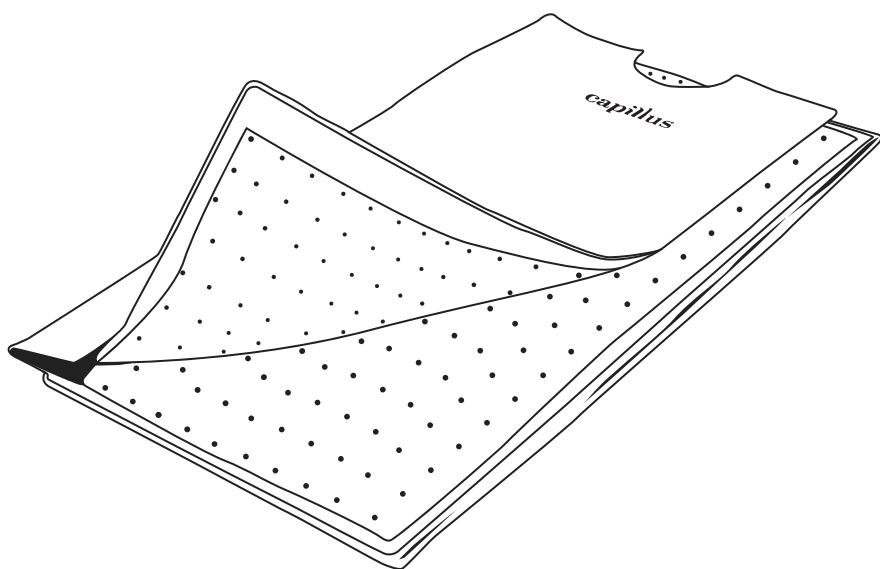

User Manual

Table of Contents

What is in the box _____	1
About the Capillus®Healing Pod _____	2
Indications of Use _____	2
Frequency of Use _____	2
Duration of Use _____	2
Warnings & Precaution _____	3
Safety Labels _____	4
Instructions for Use _____	4
Cleaning Instructions _____	5
Servicing _____	6
Storage Instructions _____	6
Disposal Instructions _____	7
Return Policy _____	7
Manufacturer's Guarantee _____	7
Risk of Loss, Other Terms of Sale _____	10
How to Contact Us _____	10
Device Specifications _____	11

What is in the box

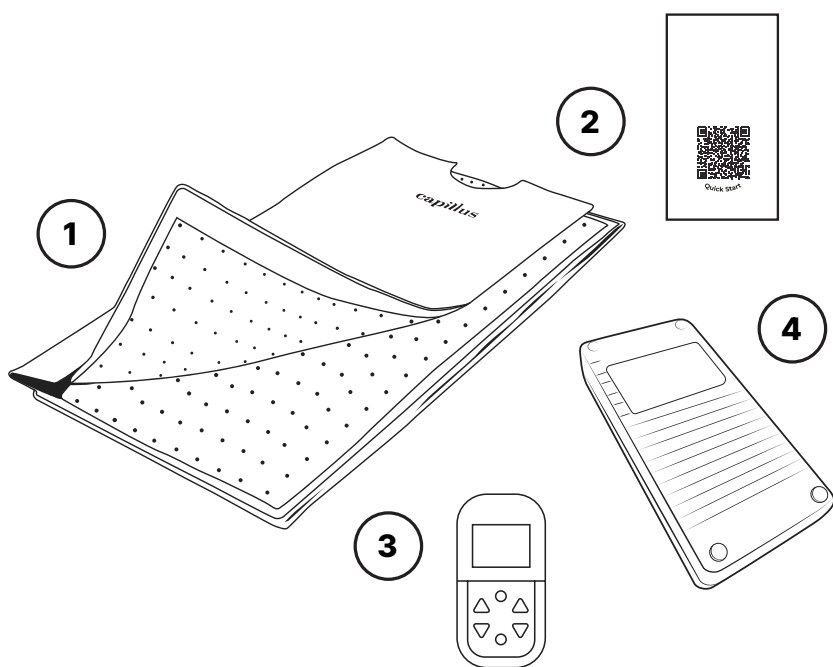

1. Capillus® Healing Pod

3. Remote

2. Manual

4. Power Block

About the Capillus®Healing Pod

Experience a new level of restoration and recovery with the Capillus Healing Pod, an advanced wellness device engineered to bring professional-grade red and near-infrared light therapy into your home. The Capillus Healing Pod represents a significant evolution in whole-body photobiomodulation technology—designed to support your body's natural healing processes, enhance recovery, and promote overall wellbeing in a single, immersive session.

The Capillus Healing Pod is an advanced full-body red and near-infrared light therapy system designed to support recovery, relaxation, and overall wellness from the comfort of your home. Using a carefully engineered array of therapeutic LEDs, the Healing Pod delivers uniform, immersive light exposure to help stimulate the body's natural healing processes.

This manual provides important information to help you safely and effectively use your Capillus Healing Pod. Inside, you'll find guidance on setup, operation, best practices, and care to ensure an optimal experience with every session.

Indications of Use

The Capillus Healing Pod is a non-invasive wellness device that delivers red and near-infrared light therapy to support overall health and wellbeing. It is intended to promote relaxation, improve circulation, support muscle recovery, and encourage the body's natural restorative processes. The Healing Pod is not intended to diagnose, treat, cure, or prevent any disease, and users should consult a healthcare professional before use if they have any medical concerns.

Frequency of Use

For optimal results, the Capillus Healing Pod may be used 3 to 5 times per week, depending on individual wellness goals and comfort level. Each session can be set for 15–30 minutes. Users who are new to light therapy are encouraged to begin with shorter, less frequent sessions and gradually increase use as tolerated. Consistent use over time is recommended to support relaxation, recovery, and overall wellbeing. Always follow recommended guidelines and discontinue use if discomfort occurs.

To ensure the device is used optimally, allow the device to fully cool down before each use. Exceeding the recommended times or frequency may not increase the effect of the device.

Duration of Use

The Capillus® Healing Pod may be used indefinitely, provided it is operated according to its instructions.

Warnings & Precautions

Do not use the Capillus® Healing Pod in:

- Conjunction with medications that are photo sensitizing.
- Products that are photosensitizing.

Immediately stop using the device if you experience any discomfort.

Do not use the Capillus® Healing Pod if you have any of the following medical conditions:

- Retinal and/or macular disease, ocular albinism, or any eye condition that causes sensitivity to light
- Light sensitive skin disorder (e.g., lupus, porphyria)
- Light-induced headaches
- Albinism
- Melasma (i.e., condition that causes patches and spots)

Do not use the Capillus® Healing Pod if you have any of the following conditions:

- Suspicious lesions or skin cancer
- Eczema
- Psoriasis
- Irregularly shaped, new, or changing brown spots
- Broken skin, skin rash, or blisters
- Tissue inflammation
- Skin infection, cold sore, or warts
- Active current outbreak of herpes simplex virus (cold sores)
- History of herpes outbreaks without receiving preventative treatment
- Dermatological treatment where the skin has not fully healed, including neurotoxin, dermal filler, micro needling, laser, or chemical peel

Consult a medical professional before using the Capillus® Healing Pod if:



- You are experiencing skin sensitivity or irritation.
- CAUTION: The light emitted from the Capillus® Healing Pod may be harmful to the eyes. Do not stare at the light source.
- Do not use the Capillus® Healing Pod if it has been left outdoors.
- To avoid the risk of temporary dry skin or hyperpigmentation, do not run back-to-back treatment sessions.

To reduce the risk of fire, thermal and chemical burns, electric shock, serious injury, or death, follow the precautions in this section and the procedures in this manual.

Supervision and Intended users:

- Do not use if any of the conditions listed in the “Warnings & Precautions” apply to you.
- Do not leave the Capillus® Healing Pod unattended when it is powered on.
- The Capillus® Healing Pod is not intended for use by people with reduced physical, sensory, or mental capabilities, or lack of experience and knowledge, unless they have been given supervision or instructions concerning use of the equipment. Please refer to the “Warnings & Precautions” before use.
- The Capillus® Healing Pod is not intended for use by children under 18 years old. Children should be supervised to ensure they do not play with the Capillus® Healing Pod.
- Small parts can be inhaled or swallowed by children—if any small parts break off or detach from the product, dispose of it safely.
- The Capillus® Healing Pod is intended to be used by only one person.

Safety Labels

	Indicates the device should not be disposed of in the normal waste stream; it should be taken to a recycling center for proper disposal.
	Indicates Type BF applied part (60335); B=Healing Pod, F=Floating applied part. No conductive contact with USER.
	Indicates a medical device that needs to be protected from moisture.

Instructions for Use

Please read the Warnings & Precautions and Instructions before first use.

1. Pre-Use (Preparation)

- Review all safety instructions and precautions prior to use.
- **Medical clearance:** Consult your doctor if you have any contraindications listed (e.g., skin diseases, implants, seizures, pregnancy, etc.).
- Unpack the Healing Pod™ and ensure all components are present.
- Ensure the device is on a **flat, dry surface** free from moisture or debris.
- Plug in the controller to the pod, then connect the power adapter to a grounded wall outlet
- Power on the device. Select your preferred light intensity and duration using the control panel.
- Lie inside the blanket, ensuring the LEDs are positioned close to your body.
- Hydrate: Be well-hydrated before your session and plan to drink water afterward.

2. Session Settings

- **Session Length:** 5–30 minutes.
- **Frequency:** 3–4 sessions per week is recommended.
- **Intensity (Power):** Start at **40% or 60%**, increase based on levels of tolerance.
- **Light Mode:** Choose Continuous mode (0 Hz) for a shorter session with full light intensity or select your desired frequency (pulsating mode) and light intensity percentage for your desired comfort.
- Use the built-in timer on the controller to set your session. The device will **turn off automatically** when the timer ends.
- Safety note: If any part of your body gets too warm or you feel uncomfortable, **reduce intensity** or stop the session immediately via the power button.
- During the session, **keep your eyes closed**. Do not look directly at the LEDs.

Cleaning Instructions

If it is necessary to clean the surfaces of your Capillus® Healing Pod, please follow these instructions. Note: The Capillus® Healing Pod has no parts that can be serviced by the user. If service is required, contact Capillus® at 1-888-571-5334.

MAKE SURE THE DEVICE IS TURNED OFF UNPLUG THE CAPILLUS® HEALING POD FROM ANY POWER CORD BEFORE CLEANING.

- After the session ends, unplug the device if you're done.
- Let the Healing Pod cool completely before folding or storing.
- Cleaning: Wipe inside and outside surfaces with a soft cloth or towel. Use a non-toxic gentle soap or cleaning wipe. Avoid harsh chemicals or abrasives.
- Storage:
 - * Store flat or loosely folded.
 - * Avoid creasing the LED panel.
 - * Don't stack heavy objects on top of it.
 - * Keep away from moisture; never submerge the device.
- Do not use excessive pressure or force as this may damage the unit. Do not use acetone or any other solvents on any part of the device. Acetone and other solvents will damage the unit and void the warranty.

Keep It Dry.

- Keep the Capillus® Healing Pod dry. If it gets wet, do not charge or use.
- Do not use the Healing Pod in wet surrounding (e.g., in a bathtub, shower, or swimming pool).
- Do not submerge the Capillus® Healing Pod in water.
- Do not let water run into the Capillus® Healing Pod.
- It is very important to keep the Capillus® Healing Pod dry. Any contact with water could damage the device.
- Do not use or store the Capillus® Healing Pod in the bathroom or near water.
- Do not charge or use the Capillus® Healing Pod if it has been left outdoors.

Servicing

Protect the Battery from Damage.

- Do not try to open the Capillus® Healing Pod or any of its parts including the remote.
- Do not crush, drop, or damage the Capillus® Healing Pod.
- Stop using or disconnect any power cable if the Capillus® Healing Pod feels unusually hot or emits smoke or a bad smell.
- Follow “Disposal Instructions”.

Do Not Repair or Modify.

- Do not attempt to repair or modify the Capillus® Healing Pod.
- Do not crush or dispose of in fire.

Storage Instructions

Transport and Storage Conditions.

- Only transport and store the Capillus® Healing Pod in the following environmental conditions: Keep between 0°C (32°F) and 25°C (77°F).
- Do not use the Capillus® Healing Pod outdoors. Only use the Capillus® Healing Pod indoors under the following environmental conditions Temperature: between 10°C and 30°C.
- A relative humidity range of 15% to 90% atmospheric pressure range of 700 Pa to 1060Pa.

Disposal Instructions

Dispose of it in appropriate waste stream as per local ordinance and regulations.

Return Policy

All www.Capillus.com sales are final. No refunds or exchanges with the exception of the Manufacturer's Guarantee. If you wish to make a return as per above, contact Capillus® at 1 (786) 888-6249 to obtain a Return Material Authorization (RMA). Capillus® will not accept any shipments without an RMA. We recommend that you insure your shipment and register to receive tracking updates. Capillus® will only accept fully functional, like-new devices for returns. Capillus® will provide credit to your credit card or eligible refund via check.

If you received any products in a damaged condition, hang on to your shipment and DO NOT discard any damaged boxes, packaging, or products. Report the damage to us and we will determine if you should return the product for a replacement. You may be asked to provide pictures of your damage to help with the processing of your claim.

International orders will not receive any refunds for the shipping costs paid in the initial order. The refund will only be applicable to the price of the products.

Manufacturer's Guarantee

CAPILLUS OFFERS A ONE-YEAR LIMITED WARRANTY COVERING MANUFACTURING DEFECTS UNDER NORMAL USE CONDITIONS.

IMPORTANT: BY USING THE CAPILLUS HEALING POD YOU ARE AGREEING TO BE BOUND BY THE TERMS OF THE CAPILLUS ONE (1) YEAR LIMITED WARRANTY ("WARRANTY") AS SET OUT BELOW. DO NOT USE YOUR PRODUCT UNTIL YOU HAVE READ THE TERMS OF THE WARRANTY. IF YOU DO NOT AGREE TO THE TERMS OF THE WARRANTY, DO NOT USE THE PRODUCT AND RETURN IT WITHIN THE RETURN PERIOD STATED IN HIGHERDOSE'S RETURN POLICY FOR A REFUND.

HOW CONSUMER LAW RELATES TO THIS WARRANTY

THIS WARRANTY GIVES YOU SPECIFIC LEGAL RIGHTS, AND YOU MAY HAVE OTHER RIGHTS THAT VARY FROM STATE TO STATE (OR BY COUNTRY OR PROVINCE). OTHER THAN AS PERMITTED BY LAW, CAPILLUS DOES NOT EXCLUDE, LIMIT OR SUSPEND OTHER RIGHTS YOU MAY HAVE, INCLUDING THOSE THAT MAY ARISE FROM THE NONCONFORMITY OF A SALES CONTRACT. FOR A FULL UNDERSTANDING OF YOUR RIGHTS YOU SHOULD CONSULT THE LAWS OF YOUR COUNTRY, PROVINCE OR STATE.

WARRANTY LIMITATIONS SUBJECT TO CONSUMER LAW

TO THE EXTENT PERMITTED BY LAW, THIS WARRANTY AND THE REMEDIES SET FORTH ARE EXCLUSIVE AND IN LIEU OF ALL OTHER WARRANTIES, REMEDIES AND CONDITIONS, WHETHER ORAL, WRITTEN, STATUTORY, EXPRESS OR IMPLIED. CAPILLUS DISCLAIMS ALL STATUTORY AND IMPLIED WARRANTIES, INCLUDING WITHOUT LIMITATION, WARRANTIES OF MERCHANTABILITY AND FITNESS FOR A PARTICULAR PURPOSE AND WARRANTIES AGAINST HIDDEN OR LATENT DEFECTS, TO THE EXTENT PERMITTED BY LAW. IN SO FAR AS SUCH WARRANTIES CANNOT BE DISCLAIMED, CAPILLUS LIMITS THE DURATION AND REMEDIES OF SUCH WARRANTIES TO THE DURATION OF THIS EXPRESS WARRANTY AND, AT CAPILLUS'S OPTION, THE REPAIR OR REPLACEMENT SERVICES DESCRIBED BELOW. SOME STATES (COUNTRIES AND PROVINCES) DO NOT ALLOW LIMITATIONS ON HOW LONG AN IMPLIED WARRANTY (OR CONDITION) MAY LAST, SO THE LIMITATION DESCRIBED ABOVE MAY NOT APPLY TO YOU.

WHAT IS COVERED BY THIS WARRANTY?

CURALLUX LLC WARRANTS THE CAPILLUS HEALING POD AGAINST DEFECTS IN MATERIALS AND WORKMANSHIP WHEN USED NORMALLY IN ACCORDANCE WITH CAPILLUS'S PUBLISHED GUIDELINES FOR A PERIOD OF ONE (1) YEAR FROM THE DATE OF ORIGINAL RETAIL PURCHASE BY THE END-USER PURCHASER ("WARRANTY PERIOD"). CAPILLUS'S PUBLISHED GUIDELINES INCLUDE BUT ARE NOT LIMITED INFORMATION CONTAINED IN TECHNICAL SPECIFICATIONS, USER MANUALS AND SERVICE COMMUNICATIONS.

WHAT IS NOT COVERED BY THIS WARRANTY?

CAPILLUS DOES NOT WARRANT THAT THE OPERATION OF THE HEALING POD WILL BE UNINTERRUPTED OR ERROR-FREE. CAPILLUS IS NOT RESPONSIBLE FOR DAMAGE ARISING FROM FAILURE TO FOLLOW INSTRUCTIONS RELATING TO USE OF THE CAPILLUS HEALING POD.

THIS WARRANTY DOES NOT APPLY: (A) TO COSMETIC DAMAGE, INCLUDING BUT NOT LIMITED TO SCRATCHES, DENTS AND BROKEN PLASTIC ON PORTS, CORDS OR CONTROLLERS, UNLESS FAILURE HAS OCCURRED DUE TO A DEFECT IN MATERIALS OR WORKMANSHIP; DAMAGE CAUSED BY OPERATING THE CAPILLUS HEALING POD OUTSIDE CAPILLUS'S PUBLISHED GUIDELINES; (D) TO DAMAGE CAUSED BY SERVICE PERFORMED BY ANYONE WHO IS NOT A REPRESENTATIVE OF CAPILLUS;

WRITTEN PERMISSION OF CAPILLUS; (F) TO DEFECTS CAUSED BY NORMAL WEAR AND TEAR OR OTHERWISE DUE TO THE NORMAL AGING OF THE CAPILLUS HEALING POD; OR (G) IF CAPILLUS RECEIVES INFORMATION FROM RELEVANT PUBLIC AUTHORITIES THAT THE PRODUCT HAS BEEN STOLEN, AND YOU CANNOT PROVE IN ANY WAY THAT YOU ARE THE AUTHORIZED USER OF THE PRODUCT (EG. BY PRESENTING PROOF OF PURCHASE).

YOUR RESPONSIBILITIES

BEFORE RECEIVING WARRANTY SERVICE, CAPILLUS OR ITS AGENTS MAY REQUIRE THAT YOU FURNISH PROOF OF PURCHASE DETAILS, RESPOND TO QUESTIONS DESIGNED TO ASSIST WITH DIAGNOSING POTENTIAL ISSUES AND FOLLOW CAPILLUS'S PROCEDURES FOR OBTAINING WARRANTY SERVICE.

FOLLOWING WARRANTY SERVICE YOUR CAPILLUS HEALING POD OR A REPLACEMENT ITEM WILL BE RETURNED TO YOU, SUBJECT TO APPLICABLE PRODUCT MODEL UPDATES AND AVAILABILITY.

IMPORTANT: DO NOT ATTEMPT TO REPAIR THE CAPILLUS HEALING POD, THE CONTROLLER OR ANY OTHER ASPECT OF THE PRODUCT. ATTEMPTING TO REPAIR

THE PRODUCT IS DANGEROUS AND MAY CAUSE DAMAGE THAT IS NOT COVERED BY THIS WARRANTY. ONLY CAPILLUS SHOULD PERFORM SERVICE ON THE PRODUCT.

NO COMMERCIAL USE

THE CAPILLUS HEALING POD IS DESIGNED AND INTENDED ONLY FOR HOME USE. CAPILLUS HEALING POD IS NOT INTENDED TO BE USED IN ANY COMMERCIAL OR INSTITUTIONAL SETTING OR APPLICATION. THESE INCLUDE BUT ARE NOT LIMITED TO: COMMERCIAL GYMS, COMMERCIAL SPAS, DEPARTMENTS, GOVERNMENT AGENCIES, APARTMENT/RETIREMENT/ CONDOMINIUM COMMUNITIES, HOTELS, CRUISE SHIPS, SCHOOLS OR UNIVERSITIES.

USING THE CAPILLUS HEALING POD IN A COMMERCIAL OR INSTITUTIONAL SETTING WILL VOID THE PRODUCT'S WARRANTY AND MAY OPEN THE OWNER OF THE PROPERTY TO UNNECESSARY RISKS.

LIMITATION OF LIABILITY

EXCEPT AS PROVIDED IN THIS WARRANTY AND TO THE MAXIMUM EXTENT PERMITTED BY LAW, CAPILLUS IS NOT RESPONSIBLE FOR DIRECT, SPECIAL, INCIDENTAL OR CONSEQUENTIAL DAMAGES RESULTING FROM ANY BREACH OF WARRANTY OR CONDITION, OR UNDER ANY OTHER LEGAL THEORY, INCLUDING BUT NOT LIMITED TO LOSS OF USE; LOSS OF REVENUE; LOSS OF ACTUAL OR ANTICIPATED PROFITS (INCLUDING LOSS OF PROFITS ON CONTRACTS); LOSS OF THE USE OF MONEY;

LOSS OF ANTICIPATED SAVINGS; LOSS OF BUSINESS; LOSS OF OPPORTUNITY; LOSS OF GOODWILL; LOSS OF REPUTATION; OR ANY INDIRECT OR CONSEQUENTIAL LOSS OR DAMAGE HOWSOEVER CAUSED INCLUDING THE REPLACEMENT OF EQUIPMENT AND PROPERTY. THE FOREGOING LIMITATION SHALL NOT APPLY TO DEATH OR PERSONAL INJURY CLAIMS, OR ANY STATUTORY LIABILITY FOR INTENTIONAL AND GROSS NEGLIGENT ACTS AND/OR OMISSIONS. SOME STATES (COUNTRIES AND PROVINCES) DO NOT ALLOW THE EXCLUSION OR LIMITATION OF INCIDENTAL OR CONSEQUENTIAL DAMAGES, SO THE ABOVE LIMITATION OR EXCLUSION MAY NOT APPLY TO YOU.

GENERAL

NO RESELLER, AGENT, OR EMPLOYEE IS AUTHORIZED TO MAKE ANY MODIFICATION, EXTENSION, OR ADDITION TO THIS WARRANTY. IF ANY TERM IS HELD TO BE ILLEGAL OR UNENFORCEABLE, THE LEGALITY OR ENFORCEABILITY OF THE REMAINING TERMS SHALL NOT BE AFFECTED OR IMPAIRED. THIS WARRANTY IS GOVERNED BY AND CONSTRUED UNDER THE LAWS OF THE STATE OF FLORIDA, UNITED STATES. CAPILLUS OR ITS SUCCESSOR IN TITLE IS THE WARRANTOR UNDER THIS WARRANTY.

For support of warranty inquiries:

Capillus Customer Care Email: support@capillus.com Phone: (786) 888-6249

Hours: Monday–Friday, 9:00 AM – 5:00 PM EST

Please register your product at: www.capillus.com/warranty

Legal Notices

The Capillus Healing Pod™ is an FDA Class II medical device under product code ILY. It complies with FCC, CE, and RoHS standards.

Capillus LLC

1715 NW 82nd Ave, Miami, FL 33126 USA

All rights reserved.

Risk of Loss, Other Terms of Sale

The risk of loss and title for items purchased by you pass to you upon our delivery of the items to the carrier. We do not take title to returned items until the item arrives at our fulfillment center. At our discretion, a refund may be issued without requiring a return. In this situation, we do not take title to the refunded item.

NO RESALE. Buyer shall use the device delivered to buyer for the buyer's user only, and shall not resell, transfer, exchange, or otherwise assign the device without first obtaining the prior written consent of Capillus®, which consent may be granted or withheld by Capillus® in its sole discretion.

Contact Us

Address:

**Curallux, LLC
1715 NW 82 Ave,
Miami, FL 33126**

Customer Service:

**Email: info@Capillus.com
Phone: 1-888-571-5334
web: capillus.com**

Device Specifications

Product Name:	Capillus® Healing Pod
Model:	HEALING POD-2026A
Power Output:	320 W
Device Dimensions:	180 cm × 80 cm
Light Source Wavelength:	Red 660nm, Near-Infrared 850nm
Timer:	Up to 30-mins sessions
Number of LEDs:	10,720 LED diodes
Weight:	20 lbs.
Power Supply Input:	100-240 V, 50/60 Hz. 5A
Output:	48V, 7A
Material:	Medical-grade TPU and EVA

