



dote

bedside crib

by Baby Elegance



Dote Bedside Crib user manual

PLEASE READ THE FOLLOWING INSTRUCTIONS AND WARNINGS
CAREFULLY BEFORE USE AND KEEP FOR FUTURE REFERENCE.



safety information

PLEASE READ THE INSTRUCTIONS BEFORE ASSEMBLY AND KEEP THEM FOR FUTURE REFERENCE

WARNINGS

- Always follow the manufacturer's instructions before assembling or using this bedside sleeper.
- Read all instructions carefully before assembly and use of this bedside sleeper.
- The correct use and maintenance of this product is essential.
- **DO NOT** use this bedside crib with a child who weighs more than 9kg or has reached approximately 6 months of age. Please discontinue use when your child can sit, kneel, or pull itself up.
- **DO NOT** use or leave the bedside crib near open fires, naked flames, electric bar fires, gas fires, stoves, heaters, or barbecues.
- **DO NOT** place items that could cause choking within reach of your baby such as medication, coins, string, elastic, small toys, and other small objects.
- **DO NOT** leave the crib near trailing or hanging cords, leads and flexes such as curtain cords, electrical cords or leads.
- **DO NOT** use the body of the bedside crib without its frame.
- The bedside crib should be placed on a level floor.
- Young children should not be allowed to play unsupervised in the vicinity of the bedside crib.
- The bedside crib should always be locked in the fixed position when in use.
- **DO NOT** use parts or accessories other than those tested and approved by Baby Elegance.
- Check the manual for a list of required parts. ALWAYS check parts regularly for tightness of screws, nuts, and other fasteners - tighten if required.
- If the side does not connect firmly or there are holes in the mesh sides, please discontinue use immediately and seek repair.



BEDSIDE SLEEPER MODE

WARNINGS

- The bedside sleeper is suitable for an infant up to approximately 6 months of age. Please discontinue use when your child can sit, kneel, or pull itself up.
- The bedside sleeper is only suitable to use with adult beds that are between 56 and 70 centimetres in height from floor to top of the adult mattress.
- The top of the mattress should be no higher than the line marked on the inside of the bedside sleeper.

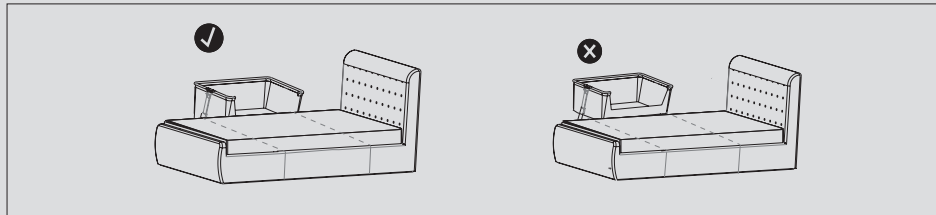

- The 2 attachment straps must always be used in bedside sleeper mode.
- Mattress, box spring, and bed frame must share the same width. This product cannot attach to an adult bed if the frame is bigger than the box spring.

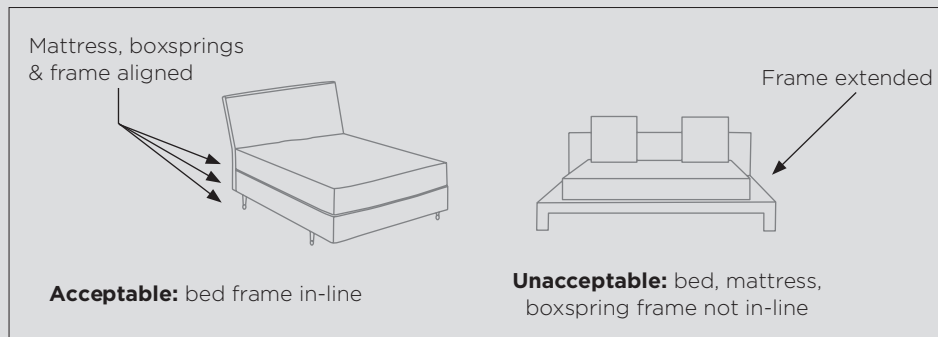



safety information

ENTRAPMENT HAZARD

- To prevent death from entrapment, the bedside sleeper must be properly secured to adult bed using the connecting straps.

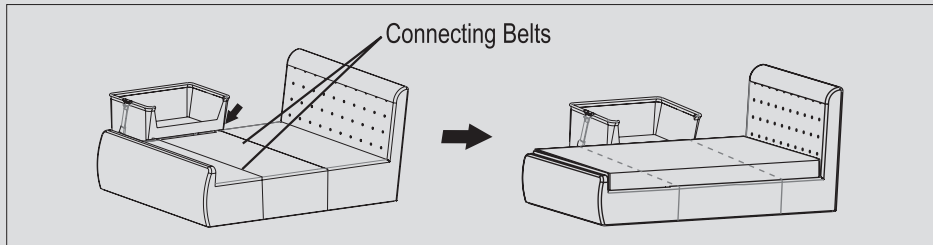

- There must be no more than a 1/2 inch (13mm) gap between bedside sleeper and adult bed.
- Check tightness before each use by pulling bedside sleeper away from adult bed.
- If gap exceeds 1/2 inch (13mm), DO NOT use product.
- **DO NOT** fill the gap with pillows, blankets, or other items that are suffocation hazards.



TO AVOID INJURY OR DEATH

WARNINGS

- Make sure children are kept at a distance while you assemble and disassemble the beside crib.
- ALWAYS apply the brakes when using the crib.
- **DO NOT** leave your child unattended.
- Only use the mattress supplied by the manufacturer. Unsafe mattresses can cause death.
- **DO NOT** add any extra mattresses as it may cause suffocation & death.



TO AVOID INJURY OR DEATH

WARNINGS

- Please discontinue use when your child can sit, kneel, or pull itself up.
- Check that the assembly of the bedside crib is correct and safe.
- Check that all folding parts and locking devices are fully engaged before placing child in the bedside crib.
- **DO NOT** place more than one child in the bedside crib at the same time.
- **DO NOT** use your bedside crib if any part is torn, broken, or missing.
- Bedside crib with padded rails should not be used if the covering fabric has been bitten through.
- To reduce the risk of SIDS, paediatricians recommend healthy infants be placed on their backs to sleep, unless otherwise advised by your doctor.

FALL HAZARD

WARNINGS

- When using as a free-standing crib, never leave baby without the top horizontal rail installed in the upper most position.
- **DO NOT** place toys or other objects in the crib, which could provide a step or foothold for the child to climb out.
- Please discontinue use when your child can sit, kneel, or pull itself up or has reached the maximum weight of 9 kilograms, whichever comes first.
- To avoid the infant's neck being caught on the top rail next to the bed, the rail must be no higher than the adult bed mattress.
- ALWAYS raise the side of the sleeper when not fastened to the adult bed.

MATTRESS SIZE

- Using the wrong size mattress may create hazardous gaps that could result in suffocation or reduce the side height causing your child to fall out of the bedside sleeper.

This product is not intended for commercial use.



baby elegance

components

**PLEASE CHECK THAT YOU HAVE ALL THE COMPONENTS LISTED
BELOW BEFORE STARTING ASSEMBLY**

A



B



C



D



E



- A) Bassinet
- B) Mattress Pad
- C) Side Frame x2
- D) Bassinet Support
- E) Support Bar



assembling the crib/bassinet

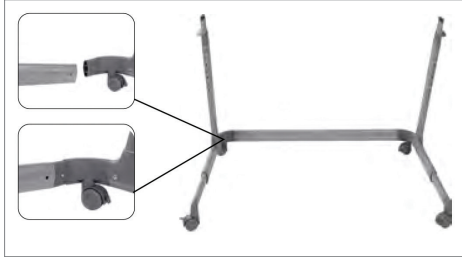

1. Connect the side frames to the support bar and click them into place.



2. Insert the bassinet into the side frames until they click into place.



3. Insert the support bar of bassinet bottom into the side frame until they click into place .



4. Insert the bassinet support into the bassinet sleeves.

Insert the bassinet support into the locks underneath the bassinet until they lock and click into place.

WARNING: THE BASSINET SUPPORT SHOULD NOT BE EXPOSED WHEN PROPERLY INSTALLED.



baby elegance



4. There is a zipper to connect the A buckle with the B buckle, please fasten it and connect the A velcro with B velcro.

WARNING: YOU MUST UNDO AND RELEASE THE VELCRO BEFORE ADJUSTING THE HEIGHT.



5. Place the mattress pad into the bassinet with the padded side up. Pull the velcro straps underneath the mattress pad and velcro them underneath the bassinet.



to adjust height

The bassinet can be adjusted to 6 different height positions.



To adjust the height:

- 1) Pivot the safety lock.
- 2) Pull on the handles on both sides at the same time.
- 3) Lift or lower the bassinet to the desired height.

WARNING: BOTH SIDES OF THE BASSINET MUST BE ADJUSTED TO THE SAME HEIGHT. IIF THE RIGHT LEG IS IN POSITION 1, THE LEFT LEG MUST ALSO BE IN POSITION 1.

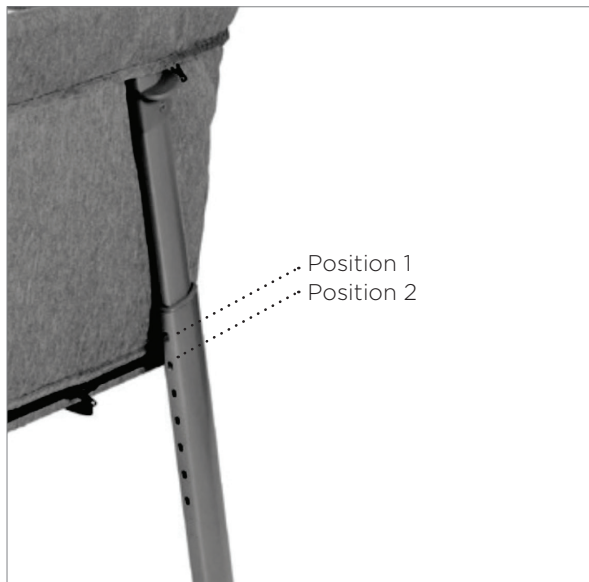



baby elegance

to switch to bedside sleeper mode



1. Open the zipper and slide the release button to open the 4th side of the bassinet.

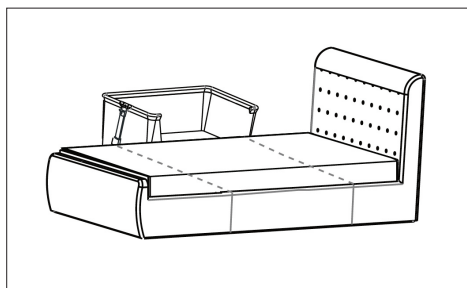

2. Fasten the connecting belt buckles around the frame of the adult bed.



3. Fasten the connecting belt buckles on the side of the bedside sleeper.

Insert the connecting belt into the fixed straps on both sides of the bassinet.

Fasten the buckles until they click and lock into place.

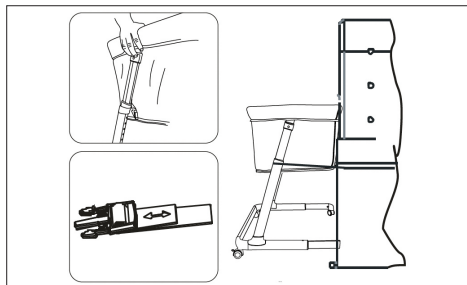

4. Adjust the height of the bassinet - as explained on page 9)

Tighten the connecting belts.

Ensure buckles are securely fastened before use.

WARNING: PLEASE ADHERE TO THE WARNINGS AND INSTRUCTIONS AT THE BEGINNING OF THE MANUAL.



locking and unlocking the wheels

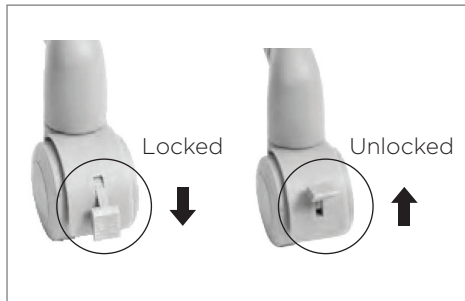

To lock and unlock the wheels

Push down the clip to lock the wheels.

Lift the clip upwards to unlock.

WARNING: ALWAYS APPLY THE LOCK WHEN IN USE.

care and maintenance

- To prolong the life of your bedside sleeper keep it clean and do not leave it in direct sunlight for extended periods of time.
- Removable fabric covers and trims may be cleaned using warm water with a household soap or mild detergent. Allow it to dry fully, preferably away from direct sunlight.
- Non removable fabric covers and trims may be spot cleaned using a damp sponge with soap or mild detergent. Allow it to dry completely before folding or storing away.
- **DO NOT** dry clean or use bleach.
- **DO NOT** machine wash, tumble or spin dry, unless indicated on care labelling.
- In some climates the covers and trims may be affected by mould and mildew. To help prevent this occurring, do not fold or store the product if damp or wet. Always store the product in a well-ventilated area.
- Regularly inspect and maintain your product to ensure all components are working correctly. Discontinue use if any parts become damaged or broken.
DO NOT use parts or accessories other than those tested and approved by Baby Elegance.



Baby Elegance, Dublin, Ireland
www.babyelegance.com