

Allta Bedside Crib

Instruction manual



by

Baby Elegance®

IMPORTANT: PLEASE READ THE FOLLOWING INSTRUCTIONS AND WARNINGS CAREFULLY BEFORE USE AND KEEP FOR FUTURE REFERENCE.

**PLEASE READ THE INSTRUCTIONS BEFORE ASSEMBLY
AND KEEP THEM FOR FUTURE REFERENCE
WARNINGS**

- Always follow the manufacturer's instructions before assembling or using this bedside sleeper.
- Read all instructions carefully before assembly and use of this bedside sleeper.
- The correct use and maintenance of this product is essential.
- **DO NOT** use this bedside crib with a child who weighs more than 9kg or has reached approximately 6 months of age. Please discontinue use when your child can sit, kneel, or pull itself up.
- **DO NOT** use or leave the bedside crib near open fires, naked flames, electric bar fires, gas fires, stoves, heaters, or barbecues.
- **DO NOT** place items that could cause choking within reach of your baby such as medication, coins, string, elastic, small toys, and other small objects.
- **DO NOT** leave the crib near trailing or hanging cords, leads and flexes such as curtain cords, electrical cords or leads.
- **DO NOT** use the body of the bedside crib without its frame.
- The bedside crib should be placed on a level floor.
- Young children should not be allowed to play unsupervised in the vicinity of the bedside crib.
- The bedside crib should always be locked in the fixed position when in use.
- **DO NOT** use parts or accessories other than those tested and approved by Baby Elegance.
- Check the manual for a list of required parts. ALWAYS check parts regularly for tightness of screws, nuts, and other fasteners - tighten if required.
- If the side does not connect firmly or there are holes in the mesh sides, please discontinue use immediately and seek repair.
- This product is not intended for commercial use.

**This product has been tested and meets all requirements of
EN 1130:2019+AC:2020 and EN 16890:2017+A1:2021**

BEDSIDE SLEEPER MODE

WARNINGS

- The bedside sleeper is suitable for an infant up to approximately 6 months of age. Please discontinue use when your child can sit, kneel, or pull itself up.
- The bedside sleeper is only suitable to use with adult beds that are between 56 and 70 centimetres in height from floor to top of the adult mattress.
- The top of the mattress should be no higher than the line marked on the inside of the bedside sleeper.

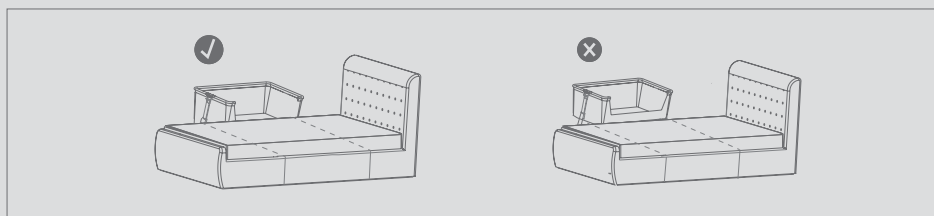

- The 2 attachment straps must always be used in bedside sleeper mode.
- Mattress, box spring, and bed frame must share the same width. This product cannot attach to an adult bed if the frame is bigger than the box spring.



ENTRAPMENT HAZARD

- To prevent death from entrapment, the bedside sleeper must be properly secured to adult bed using the connecting straps. connecting Belts.
- Pass the crib's mounting straps under the bed's mattress and hook the ends over the adult's bed frame on the opposite side of the bed. The ends must be upright between the bed frame and the mattress.
- Secure the mounting straps to the crib using the clasps (fig. 10b).
- Tighten the mounting straps and make sure this keeps the crib stable and firmly attached to the adult's bed.

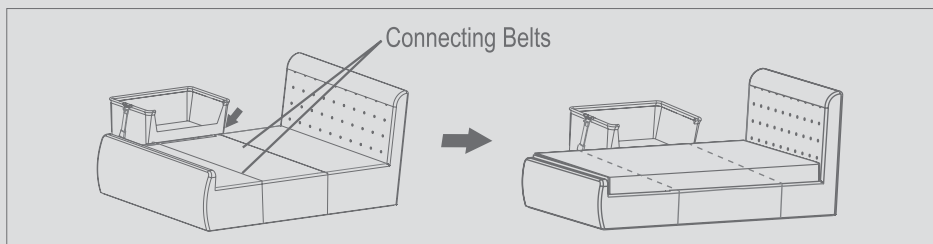

- There must be no more than a 1/2 inch (13mm) gap between bedside sleeper and adult bed.
- Check tightness before each use by pulling bedside sleeper away from adult bed.
- If gap exceeds 1/2 inch (13mm), **DO NOT** use product.
- **DO NOT** fill the gap with pillows, blankets, or other items that are suffocation hazards.



TO AVOID INJURY OR DEATH WARNINGS

- Please discontinue use when your child can sit, kneel, or pull itself up.
- Check that the assembly of the bedside crib is correct and safe.

Check that all folding parts and locking devices are fully engaged before placing child in the bedside crib.

- **DO NOT** place more than one child in the bedside crib at the same time.
- **DO NOT** use your bedside crib if any part is torn, broken, or missing.
- Bedside crib with padded rails should not be used if the covering fabric has been bitten through.
- To reduce the risk of SIDS, paediatricians recommend healthy infants be placed on their backs to sleep, unless otherwise advised by your doctor.

FALL HAZARD

WARNINGS

- When using as a free-standing crib, never leave baby without the top horizontal rail installed in the upper most position.
- **DO NOT** place toys or other objects in the crib, which could provide a step or foothold for the child to climb out.
- Please discontinue use when your child can sit, kneel, or pull itself up or has reached the maximum weight of 9 kilograms, whichever comes first.
- To avoid the infant's neck being caught on the top rail next to the bed, the rail must be no higher than the adult bed mattress.
- **ALWAYS** raise the side of the sleeper when not fastened to the adult bed.

MATTRESS SIZE

- Using the wrong size mattress may create hazardous gaps that could result in suffocation or reduce the side height causing your child to fall out of the bedside sleeper.
- Only use the mattress supplied by the manufacturer. Unsafe mattresses can cause death.
- **DO NOT** add any extra mattresses as it may cause suffocation & death.

PLEASE CHECK THAT YOU HAVE ALL THE COMPONENTS LISTED BELOW BEFORE STARTING ASSEMBLY

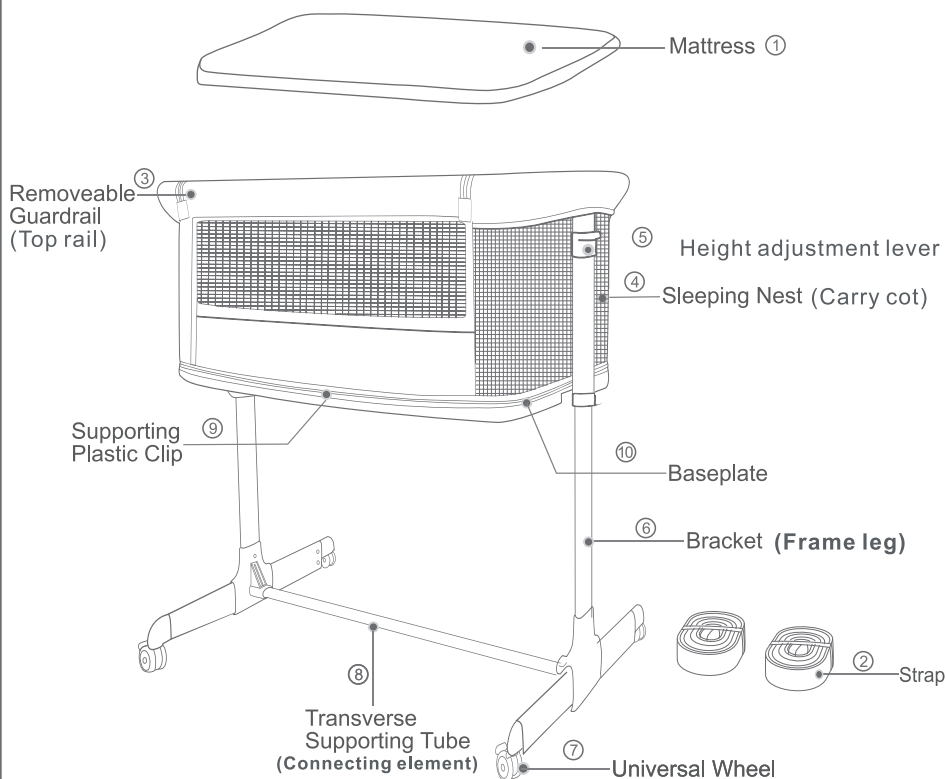

1. Mattress
2. Mounting straps
3. Top handrail
4. Carrycot
5. Height adjustment lever

6. Frame leg
7. Universal wheel
8. Connecting element
9. Supporting plastic clip
10. Baseplate

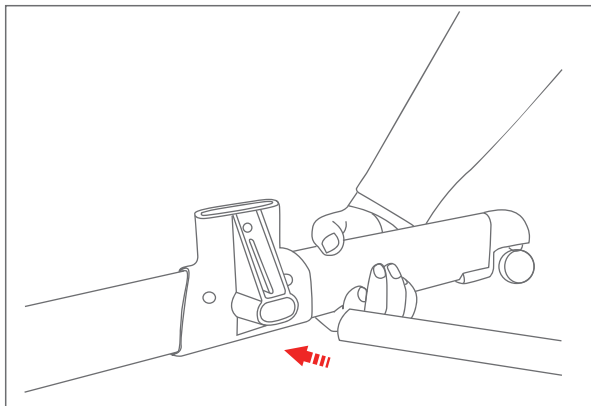

1. Insert the transverse supporting tube into the plastic joint until you hear a clicking sound.

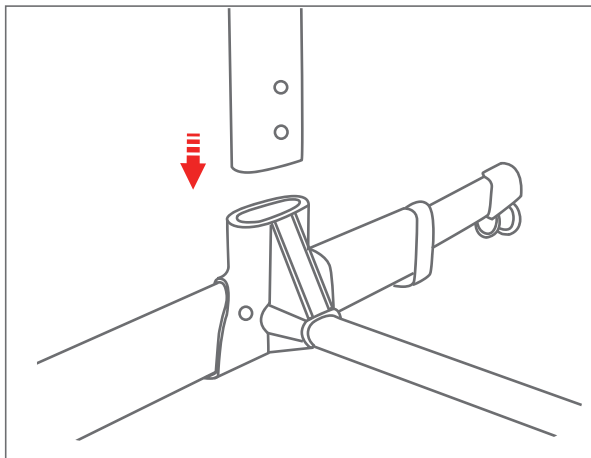

2. Insert the Bracket tube into the plastic joint until you hear a clicking sound.

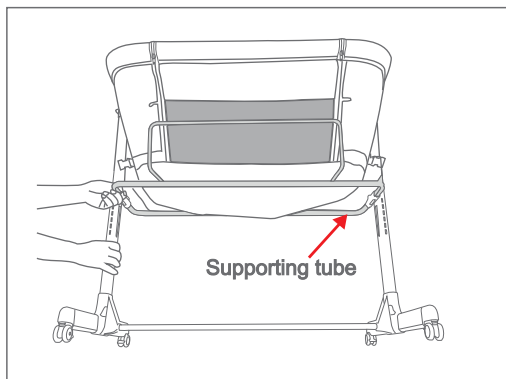

3. Insert the supporting tube into the joint until you hear a clicking sound, then insert iron rod into the bassinet set.

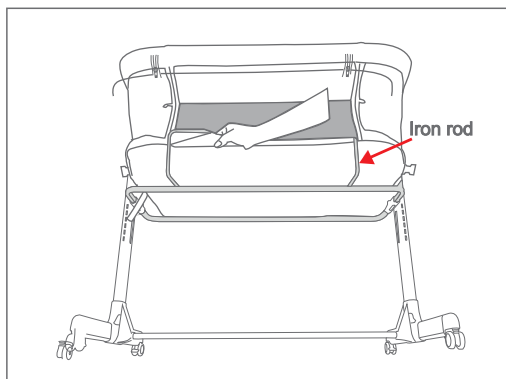

4. Insert the iron rod into the cloth cover.

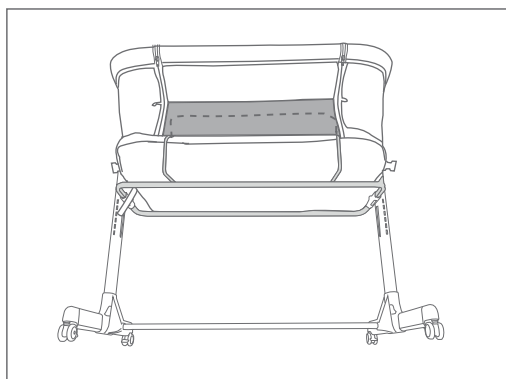

WARNING

The iron rod which marked in dotted line should be hidden in the cover.

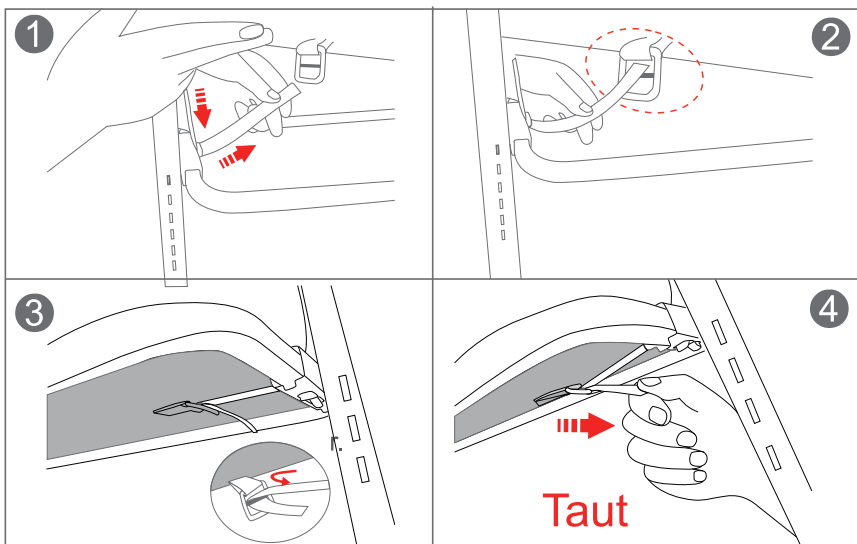
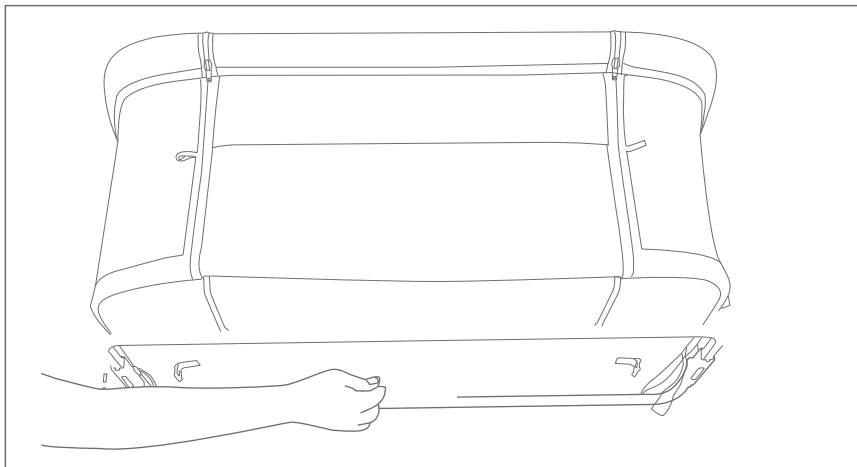

- Put the ribbon passes through the square hole and fix into D-ring tightly.

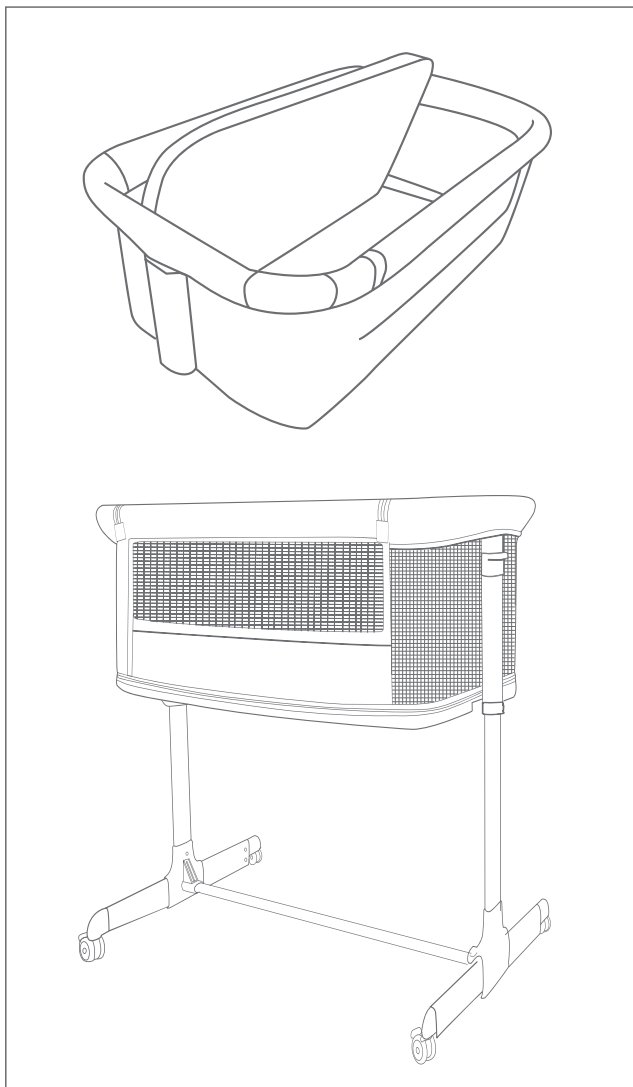

- Place the mattress then keep it flat, the bedside sleeper is fully installed.

Height setting

To change the crib's height, press the height adjustment levers on both ends of the crib (fig. 11) and set the carrycot at the desired height. There are seven crib height settings available. The crib allows setting a different height of each of its ends.

WARNING: The maximum permitted tilt of the crib carrycot is a difference of two setting levels. Always keep the baby's head in the crib on the higher end of the carrycot.

WARNING: When adjusting the height position, make sure the angle of the inclination of the bassinet base end to end (head to feet) shall not be greater than 10° . Or the difference between left and right gears of height shall be smaller than 2°

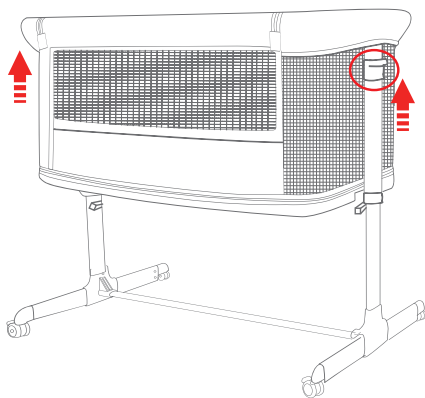

- Lift up the plastic height adjust handle both sides, then it comes higher.

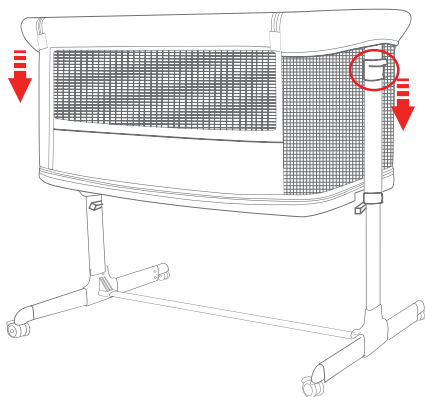

- Lift up the plastic height adjust handle both sides, then pull down the nest, it comes lower as you need.

WARNING

- When using the bedside bed function, the drop side rail that must be removed and kept well.
- When fixing the bedside bed, the short guardrail edge must be closely fitted with the adult mattress to avoid any gap.
- This product can only be used with beds and/or mattresses which have straight edges. Do not use this product with any beds and/or mattresses which are rounded or with water beds.

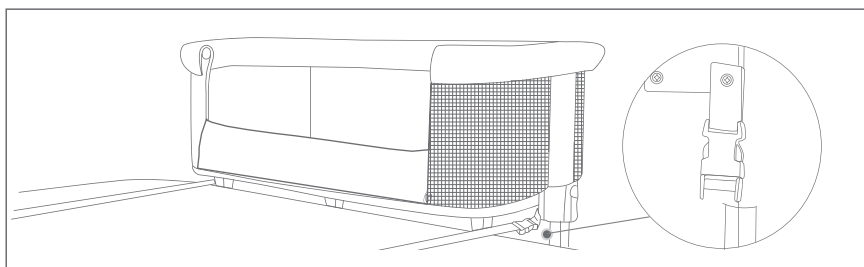

Caution!

- When used as a bedside sleeper, the carrycot's bottom must be parallel to the ground. There shall be no difference in height between the crib's ends.
- Before each use, make sure there is no gap between the adult's bed mattress and the side of the crib.

How to use the brake:

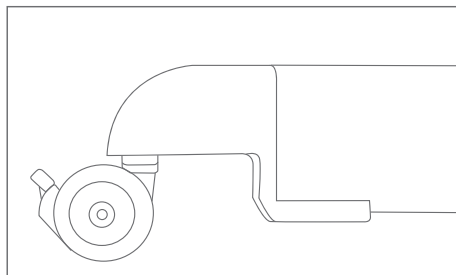
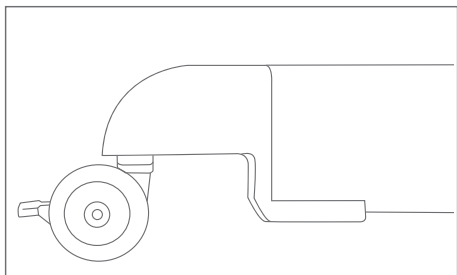

- •To lock the crib wheels, press down the brake tabs on each of the wheels.
- •To release the wheels, lift the brake tabs.

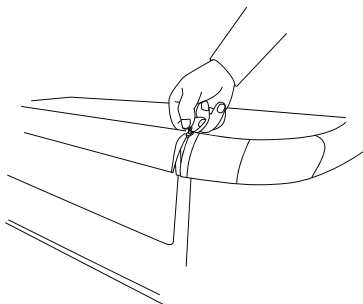

- Unzip the zipper both sides of guardrail.

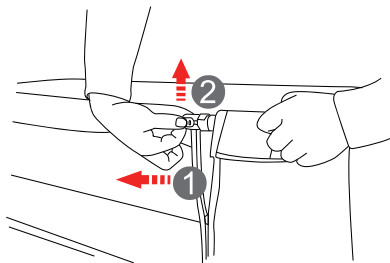

- Push the button as indicated by the arrow on the button, then upwards the top rail.

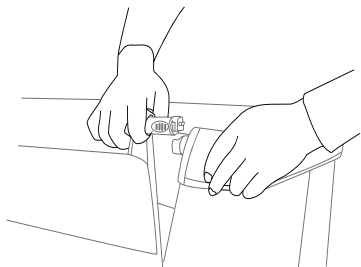

- Remove the ends of the guardrail.

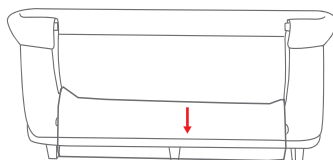

- Take down the guardrail tube and lay it flat.

Danger! - Always completely raise the drop side when not attached to the adult's bed!

Storage:

- To prevent mold formation, store the product after it has dried, and **DO NOT** place it in a humid environment.
- Clean the plastic and metal part with a wet cloth or with a mild detergent. **DO NOT** use solvents, ammonia or benzene.
- Dry metal parts as soon as they encounter water to avoid the formation of rust.
- Keep all the parts clean.



Do not dry clean



Maximum 100°F
Permanent press cycle



Do not Iron



Flat dry



When your children can sit, kneel or crawl, **DO NOT** use the crib.



Filler: resin cotton

100% polyester

WARNING: Keep away from fire!

Cleaning and maintenance:

1. The carrycot covering and the mattress case can be hand washed in 30°C.
2. Clean the metal and plastic parts with a damp cloth and a mild detergent.
3. Never clean any part of the crib with abrasives, ammonia, bleach, or alcohol.
4. Store the crib in a dry place, away from heat and moisture. Avoid direct exposure to sunlight.

Baby Elegance®

Please don't hesitate to contact us for any more information on this product
hello@babyelegance.com

This product is manufactured in China
Made in China imported by Baby Elegance

Baby Elegance
205 Northwest Business Park
Ballycoolin
Dublin 15
Ireland



**UK
CA**
Baby Elegance
International House
142 Cromwell Road
London
SW7 4EF