

Air² Travel cot

Instruction manual



by

Baby Elegance®

IMPORTANT: PLEASE READ THE FOLLOWING INSTRUCTIONS AND WARNINGS CAREFULLY BEFORE USE AND KEEP FOR FUTURE REFERENCE.

Product Information

Features:

- Lightweight and compact design!
- Easy to assemble, fold and pack away.
- Mesh sides are soft on falls and great for visibility.
- Perfect for overnight stays and holidays.
- Fits into it's handy storage bag making it a great fit in the car.

Use and maintenance:

- Suitable for children from Birth to 36 months and less than 15kg.
- Check the cot regularly for signs of damage.
- Hand wash only. Do not machine wash.
- Please note: Your childs safety is your responsibility. Please ensure you check the travel cot regularly for defects or damage.

THIS PRODUCT IS MADE IN COMPLIANCE WITH BRITISH REGULATIONS (BS 5852: 1982 Part II & BS 7177).

THIS PRODUCT IS MADE IN COMPLIANCE WITH EN716-1:2017.

WARNINGS

- Adult assembly required, sponge clean only.
- Keep small parts out of the reach of children under 36 months because of possible choking hazard.
- Be aware of the risk of open fire and other sources of heat such as electric bar fires, gas fires, etc. in the near vicinity of the cot.
- **DO NOT** use the cot if any part is broken, torn or missing and use only spare parts approved by the manufacturer.
- **DO NOT** leave anything in the cot or place the cot close to anything that could provide a foot hold or present danger of suffocation or strangulation, e.g. strings, blind/curtain cords, etc.
- Failure to extend the top rails and lock them securely creates a safety risk. ALWAYS check the rails are fully engaged before use.
- **DO NOT** use this cot when the child is able to climb out of the cot to prevent injury from falls.
- **DO NOT** use this cot without the mattress provided.
- **DO NOT** use more than one mattress in the cot.
- Do not use any mattresses which are not approved by the manufacturer.
- Only use the mattress sold with this cot, do not add a second mattress, this is a suffocation hazard.
- Keep this travel cot away from trailing cords or flexes.
- **DO NOT** leave your child unattended.
- Only use this cot with one child at a time.
- **DO NOT** move the product with the child inside.
- **DO NOT** use the cot without base.
- Ensure that the cot is fully erected and all the locking mechanisms engaged before placing your child in this cot.
- All assembly fittings should always be tightened properly. Fittings and parts should be checked regularly and retightened as necessary. If you find any issues with your travel cot, please contact Venture using the provided channels.

WARNINGS

Failure to follow these warnings and the instructions could result in serious injury or death. Please read Instruction Manual before set-up. If you misplace your Instruction Manual, **NEVER** use this product. Contact dealers for a replacement Instruction Manual.

- Only applies to children under the age of 3.
- If the child can climb out or with the height more than 35 inches (890mm) or the weight more than 15KG, please stop using this product.
- Child can become entrapped and die when improvised netting or covers are placed on top of product. Never add such items to confine child in product.
- When child is able to pull to a standing position, remove any objects, such as large toys, in the travel cot that could serve as steps for climbing out.
- Always provide the supervision necessary for the continued safety of your child. When used for playing, never leave child unattended.
- To reduce the risk of SIDS, pediatricians recommend healthy infants be placed on their backs to sleep, unless otherwise advised by your physician.
- **NEVER** use this product if there are any loose or missing fasteners, loose joints broken parts or torn mesh/fabric. Check product before assembly and periodically during use. Contact dealers for replacement parts. Never substitute parts. Do not use water filled mattress. Do not use mats.

WARNING

SUFFOCATION HAZARD:

Infant can suffocate:

- In gaps between an extra pad and side of the travel cot.
- In gaps between a mattress too small or thick and product sides on soft bedding.

NEVER add a mattress, pillow, comforter, or padding.

NEVER use plastic shipping bags or other plastic film as mattress covers not sold and intended for that purpose. They can cause suffocation.

WARNINGS CONTINUED

- Strings and cords can cause strangulation! Keep strings and cords away from child.
- **NEVER** place product near a window where cords from blinds or drapes can strangle a child.
- **NEVER** hang strings on or over the play yard and canopy.
- **NEVER** place items with a string around a child's neck, such as hood strings, pacifier cords, etc.
- **NEVER** attach strings to toys.
- To avoid danger or suffocation, keep this buggy bag away from babies and children.
- Drawing the attention of the user to the risk of leaving anything in the cot which could provide a foothold or create a danger of suffocation or strangulation.
- All assembly fittings should always be tightened properly.
- Do not use the cot if any part is broken, torn or missing and use only.
- Spare parts approved by the manufacturer.
- Accessories which are not approved by the manufacturer shall not be used.
- If a child can become entangled within the cot, there is a risk of strangulation.
- If a child can get a length or loop of cord, etc. wrapped around its neck, its airways could become restricted and brain damage could result.

WARNING:

TO AVOID DANGER OF SUFFOCATION, REMOVE PLASTIC COVER BEFORE USING THIS ARTICLE. THIS COVER SHALL BE DESTROYED OR KEPT AWAY FROM CHILDREN.

PLEASE CHECK THAT YOU HAVE ALL THE COMPONENTS LISTED
BELOW BEFORE STARTING ASSEMBLY

1 x Carry Bag

A

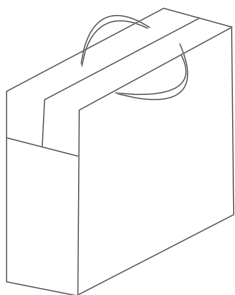

2 X Mattress

B

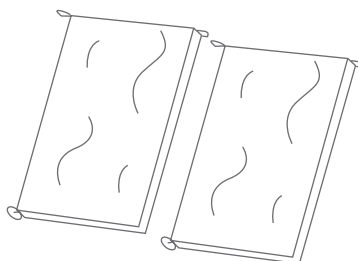

1 x Travel Cot

C

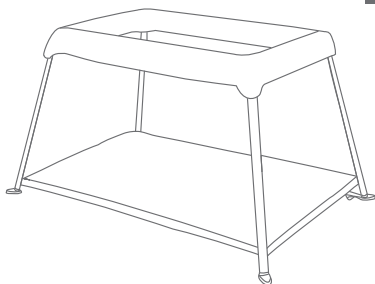

4 x Bassinet Tubes

D

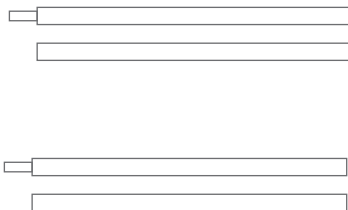

1 x Bassinet

E

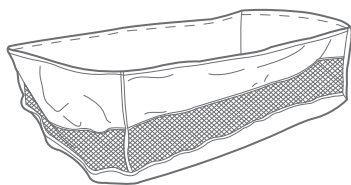

1. Remove the travel cot, mattress and bag containing the legs from the carry bag.

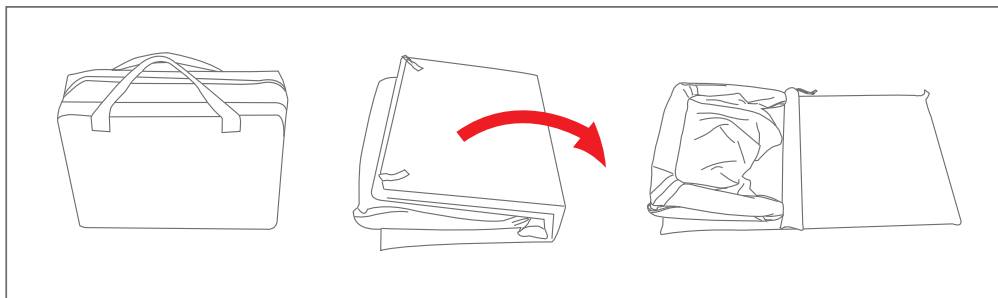

2. Unfold the travel cot frame until a click is heard to indicate that the frame is locked into place. Then flip the frame upside down. Zip the mattress together using the zip.

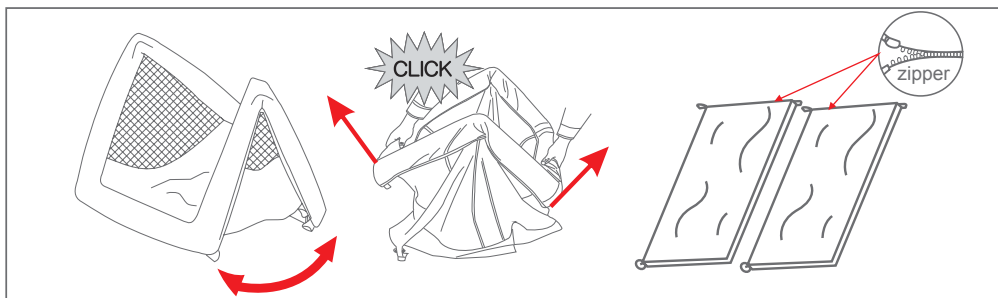

3. Unfold the legs from the centre until a click is heard to lock into place.

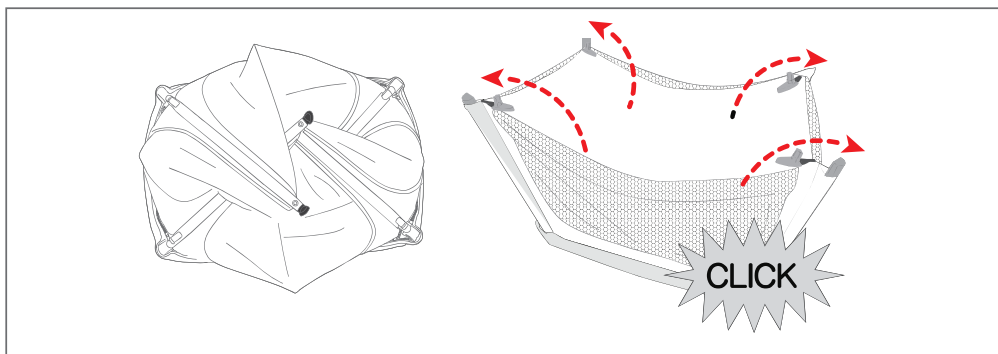

4. Attach the feet to the holes on the end of each support leg and turn the cot upright again.

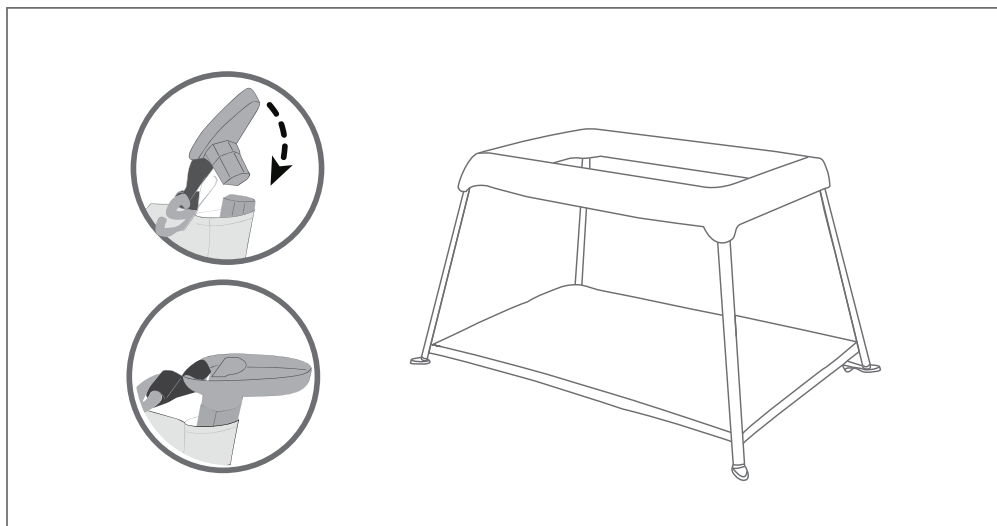

5. Insert the mattress into the cot as seen below and rotate the mattress inside the cot, when the mattress is in place inside the cot. Attach the mattress to the cot by hooking the mattress onto the legs.

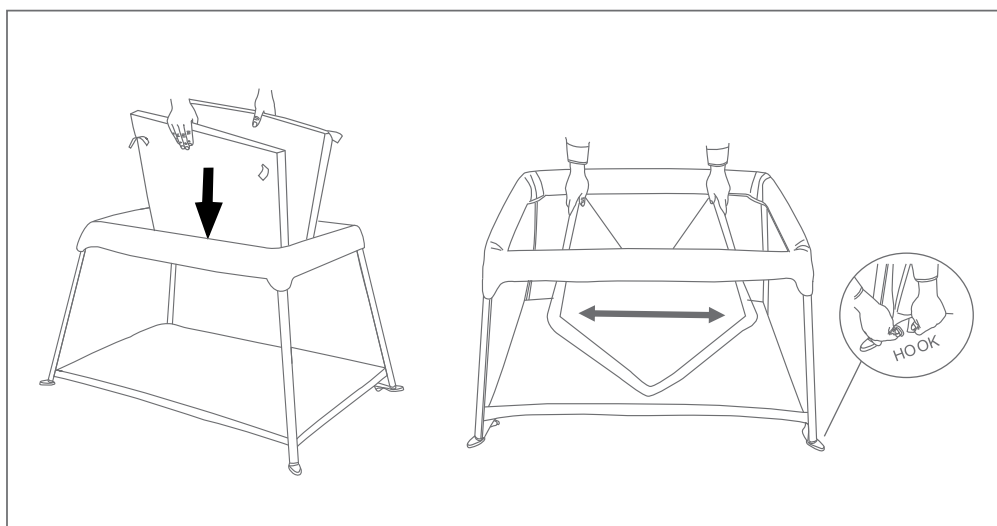

Adding the bassinet:

Take the mattress half with four velcro straps and place into the bassinet. Thread the Velcro through the bottom hole of the bassinet one by one,

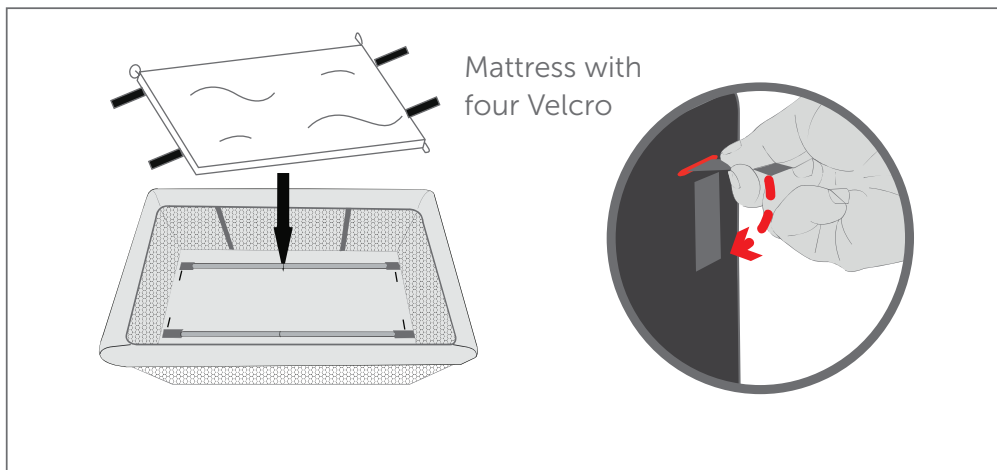

The travel cot is now ready for use, please ensure you check the item regularly for signs of damages or defects. and then secure it to the bottom of the bassinet.

Packing down the cot is easy. Simply disassemble

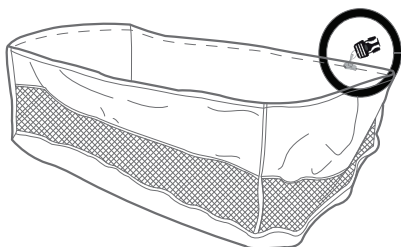

Zip the zipper as below figure

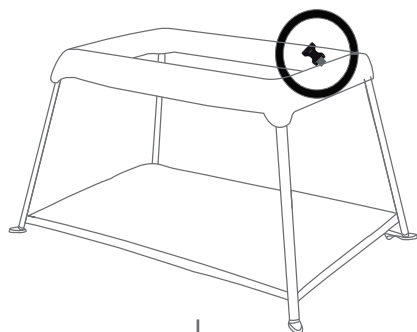
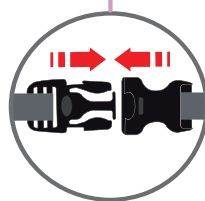
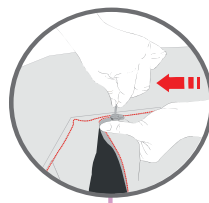

Connect the tubes as below figure shows

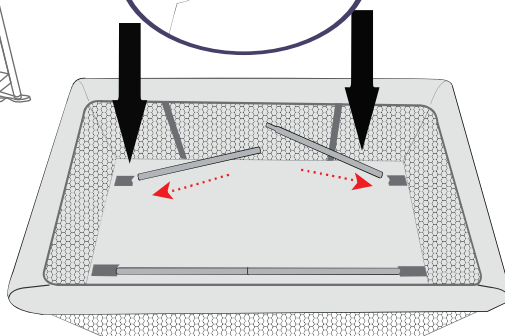
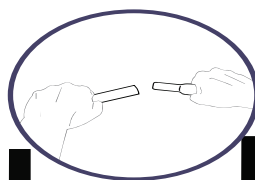
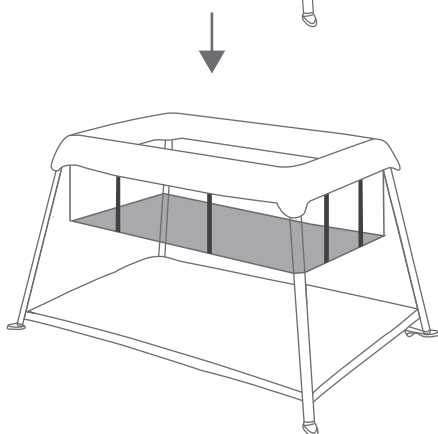

Baby Elegance®

Please don't hesitate to contact us for any more information on this product
hello@babyelegance.com

This product is manufactured in China
Made in China imported by Baby Elegance

Baby Elegance
205 Northwest Business Park
Ballycoolin
Dublin 15
Ireland



Baby Elegance
International House
142 Cromwell Road
London
SW7 4EF