

4.2 ODU Assembly

Step	Reference picture
step1: Remove the PCB Cover , valve Cover and top cover	
<p>A</p> <p>1). Unfix one screw on the PCB cover, you can take the cover out from unit.</p> <p>2). Unfix one screw on the valve cover, you can take it out easily.</p>	 <p>The diagram shows a side view of the ODU unit with the PCB cover and valve cover removed. The PCB cover is shown as a small rectangular piece with a screw. The valve cover is shown as a larger rectangular piece with a screw. The main unit has a large fan on the left and a control panel on the right.</p>
<p>B</p> <p>Unfix screws btw the top cover with front panel, left and right plate, then you can take the top cover out.</p>	 <p>The diagram shows the ODU unit with the top cover removed. The top cover is shown as a long, thin rectangular piece. The main unit has a large fan on the left and a control panel on the right. Screws are shown being removed from the top cover.</p>
step2: Disassemble the Fan Guard and Front Panel	
<p>A</p> <p>Unfix screws on front panel with fan guard.</p>	 <p>The diagram shows the ODU unit with the fan guard and front panel removed. The fan guard is shown as a circular piece with a fan. The front panel is shown as a rectangular piece. The main unit has a large fan on the left and a control panel on the right. Screws are shown being removed from the front panel.</p>

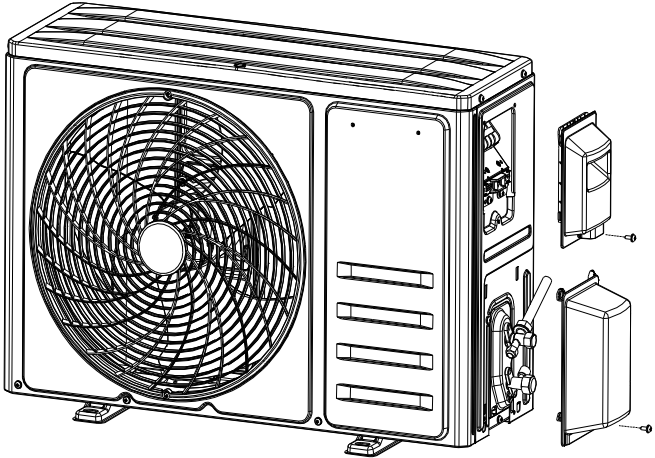

step3: Disassemble the Left and Right plate.

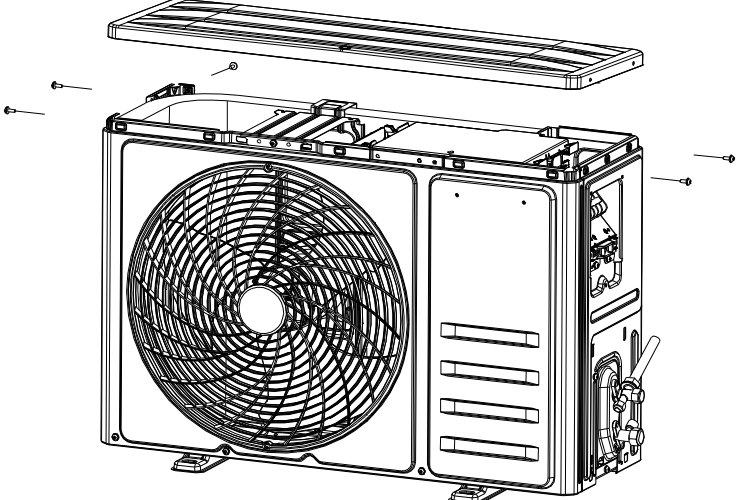
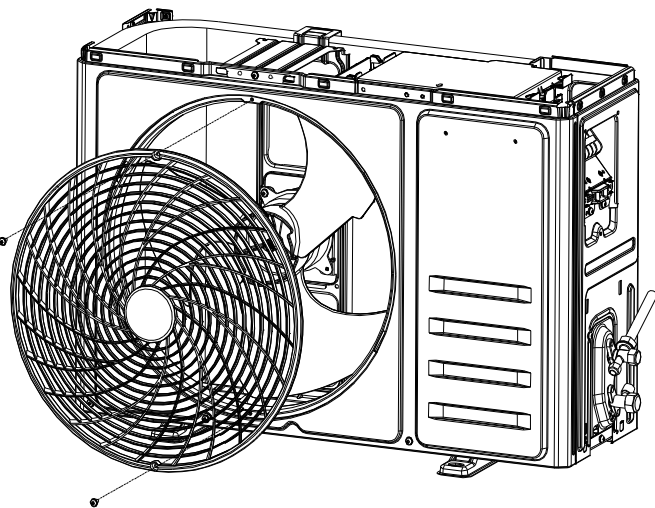
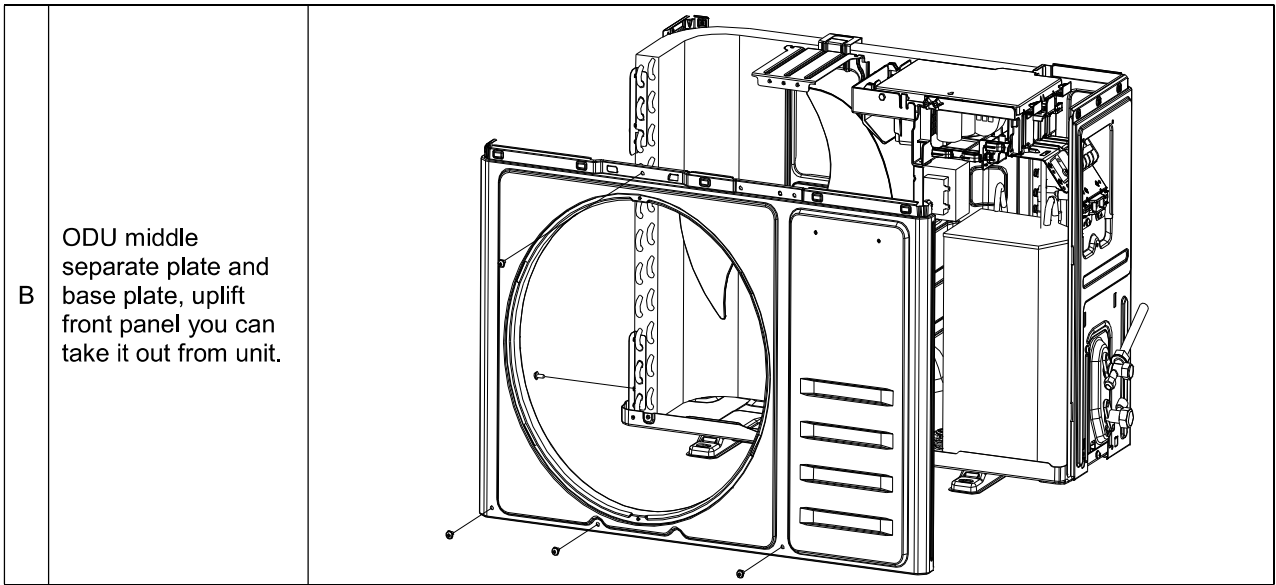
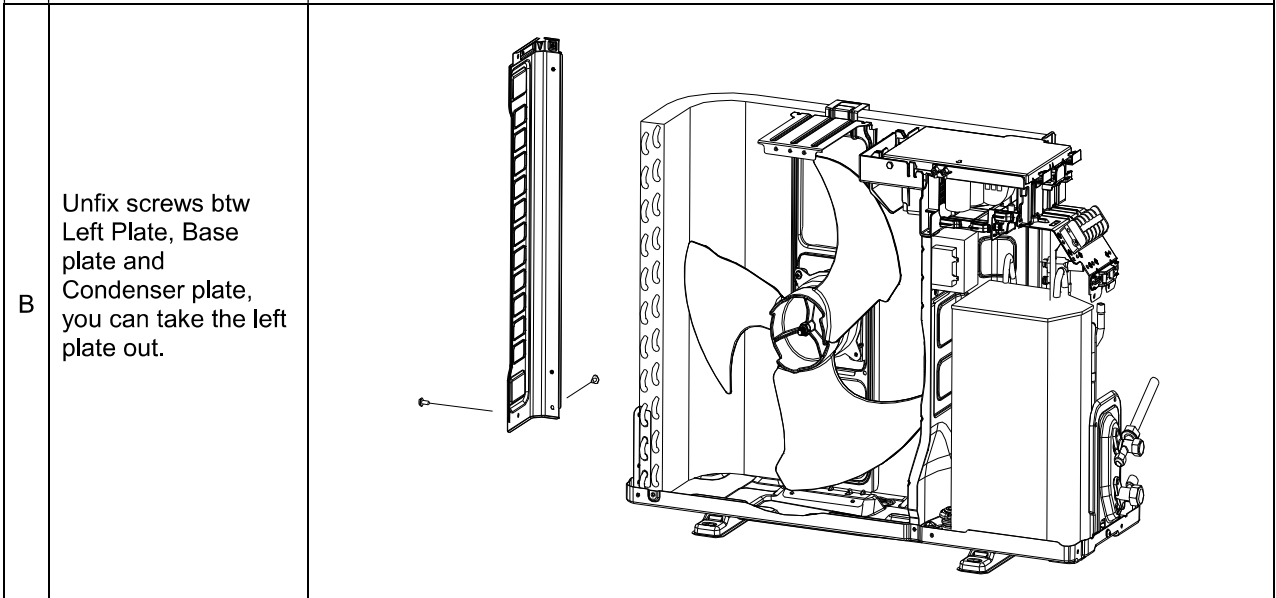
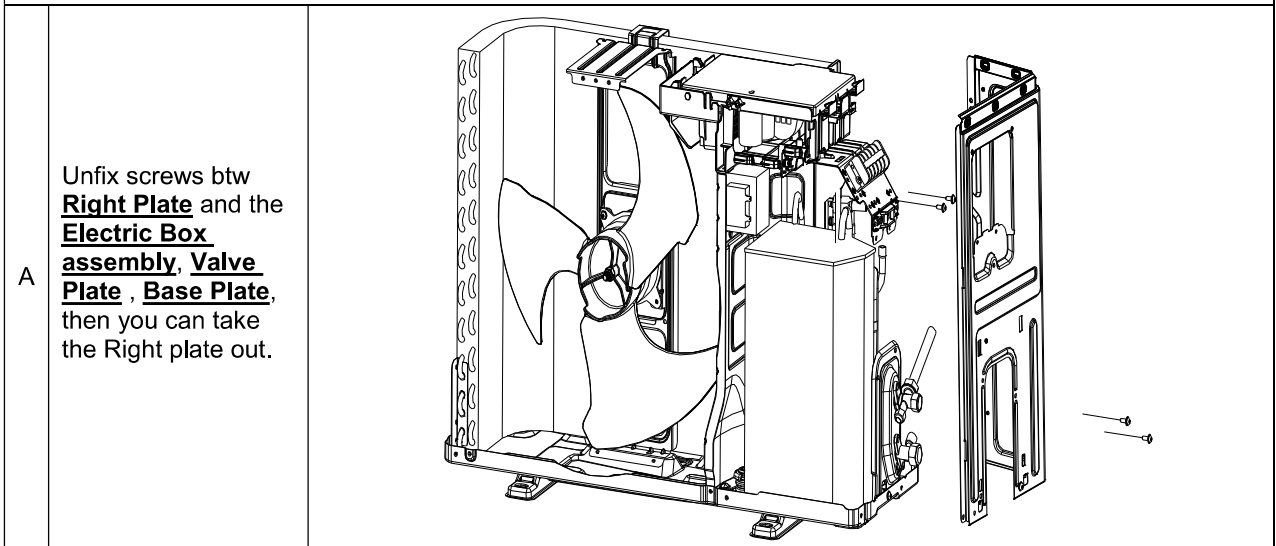

step4: Disassemble the Axis Fan Blade

A

Unscrew the fan blade nut, and take the blade out.

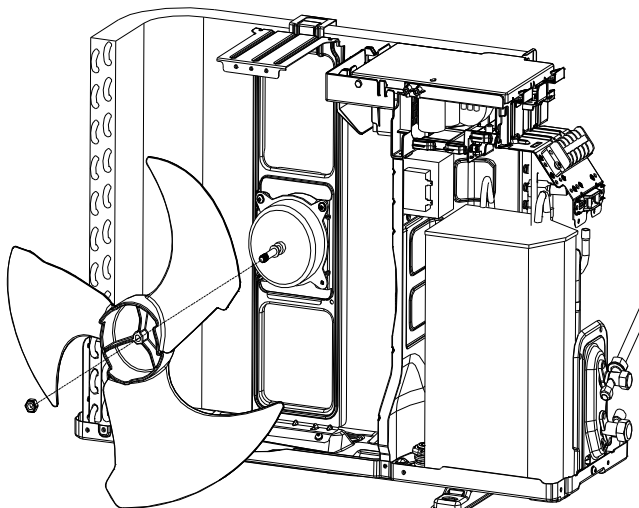

step5: Disassemble the electric box

Unfix screw btw Electric Box and motor supporter etc. loosen the wiring clamp, then you can take the control box out.

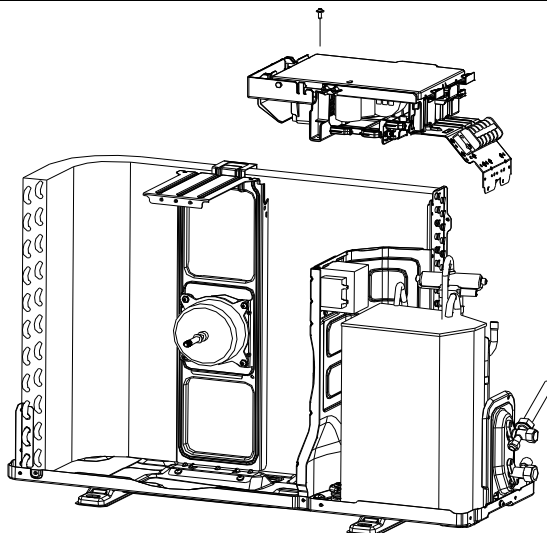

step6: take out the noise cotton

A

Shown as picture to take the cotton out

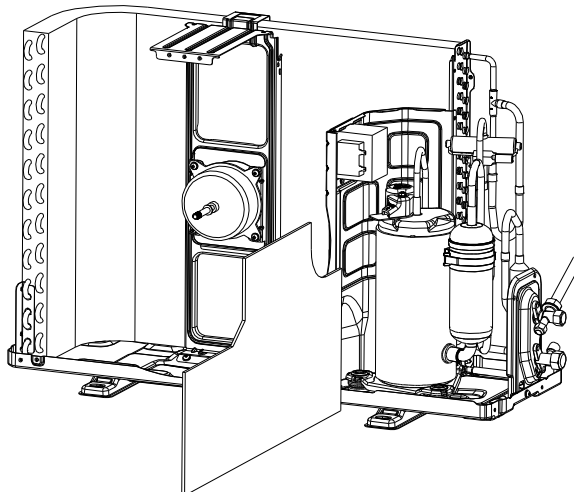

step7: Disassemble the separate plate

Unfix the screw btw separate plate and unit, and take it out

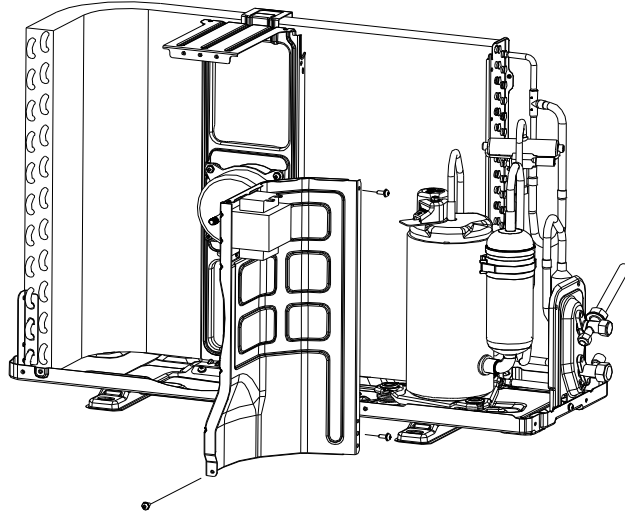

step8: Disassemble the 2 and 3-way valve

Unfix screw btw Valve plate and base, you can take the 2-way and 3-way valve out by welding.

Note:
 1). The welding can only place while no gas in the unit.
 2). Pay attention to the fire to prevent any injury.

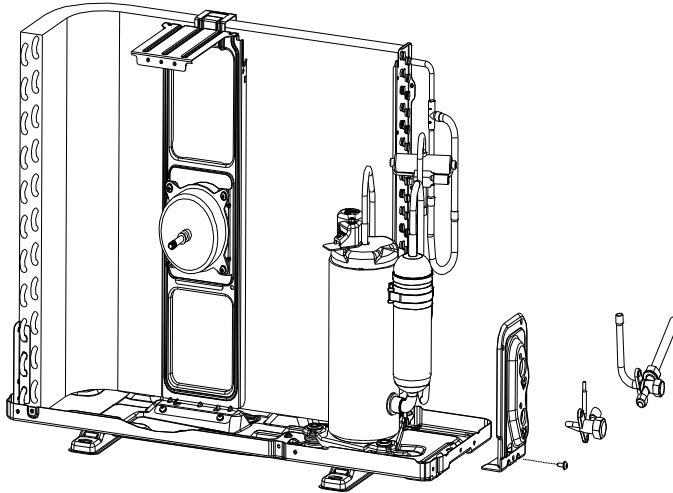

step9: Disassemble the 4-way valve assembly

Take the 4-way valve out from system by welding. Make sure no hurt to the compressor and nameplate, etc.

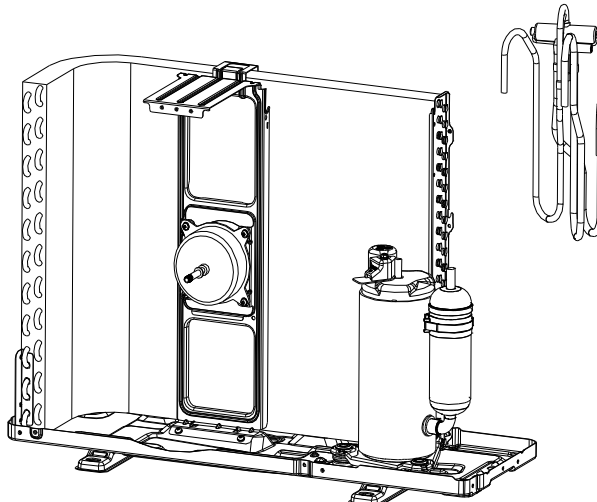

step10: Disassemble the compressor.

Unscrew the nuts and take the compressor out.

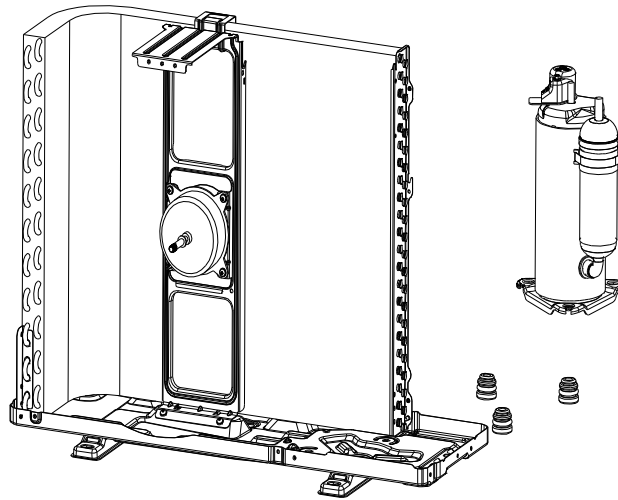

step11: Remove the fan motor and fan supporter.

Unfix screws btw fan motor with supporter, and supporter with base plate.

Note:
Pay attention to the motor wiring, it can't be taken out by force.

