

# 小宠-智能止吠器TC-005 说明书V1.0 通用英文

A6-105\*148

## SMART BARK TRAINING COLLAR

## USER MANUAL V1.0

### TC-005

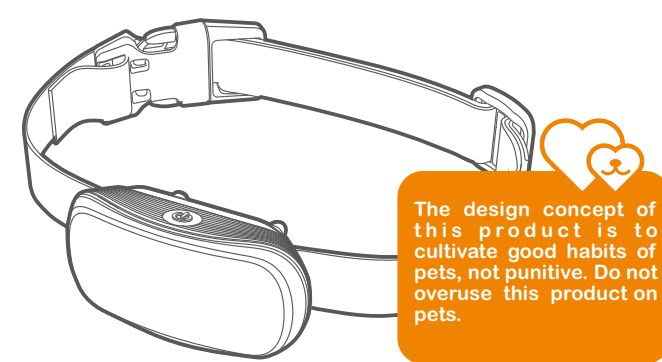

The design concept of this product is to cultivate good habits of pets, not punitive. Do not overuse this product on pets.

**NOTICE** Please Read The User Manual Carefully Before Use and Keep It in A Safe Place!

### Explanation of Attention Words and Symbols Used in This Guide

- !** This is the safety alert symbol. It is used to alert you to potential personal injury hazards. Obey all safety messages that follow this symbol to avoid possible injury or death.
- WARNING** **WARNING** indicates a hazardous situation which, if not avoided, could result in death or serious injury.
- CAUTION** **CAUTION**, used with the safety alert symbol, indicates a hazardous situation which, if not avoided, could result in minor or moderate injury.
- CAUTION** **CAUTION**, without the safety alert symbol, is used to address practices not related to personal injury.
- NOTICE** **NOTICE** is used to address practices not related to personal injury.
- PROHIBITED** **PROHIBITED** indicates that the operation is prohibited.

### Safety Instructions

- WARNING** It is forbidden to be used on aggressive dogs. An aggressive dog may cause serious injury or even death to the owner or others. If you are not sure whether this product is suitable for your dog, please consult a professional dog trainer.

1

Children are prohibited from playing with this product. Keep collar away from children.

**CAUTION** Please make sure your dog is healthy before using the product. If you are unsure about this, please consult your veterinarian.

When the collar is turned on, the human body should not directly touch the E-Shock contact of the product.

If rash or sore is found at the contact location of E-Shock probe, please stop using this product until the skin recovers.

Collar wearing time should not exceed 12 hours per day, and please adjust the wearing position every 1-2 hours.

This product is suitable for dogs over weighing more than 8 pounds and the age of 6 months.

It is forbidden to use this product as a matching collar for pet leashes.

### CAUTION

It is important to check the E-Shock neck contact probe area of the dog's neck every day for Rashes&Sores.

The long hair around the dog's throat can be properly shortened, but it is not recommended to be completely shaved.

2

Remove the collar before vigorous play with the dog.

### What's in the Box

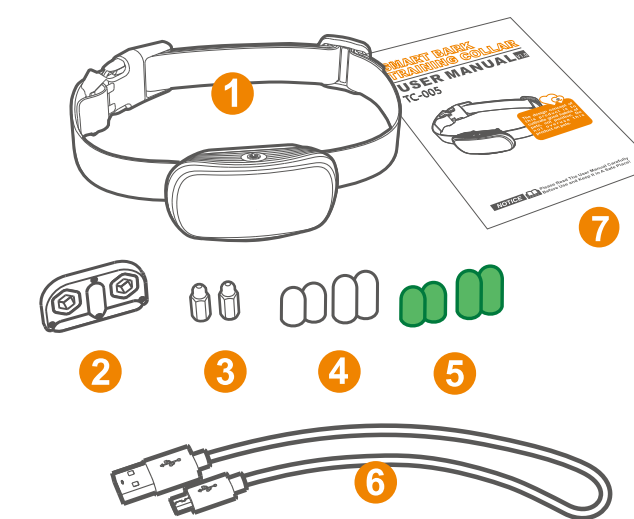

- Smart Bark Training Collar
- Test Unit & Probe Driver
- Long E-Shock Probes
- Conductive Probe Cover(Black)
- Non-Conductive Probe Cover(Green)
- USB Charging Cable
- User Manual

\* The shorter E-Shock probe has been assembled on the collar.

3

### Learn About Your Collar

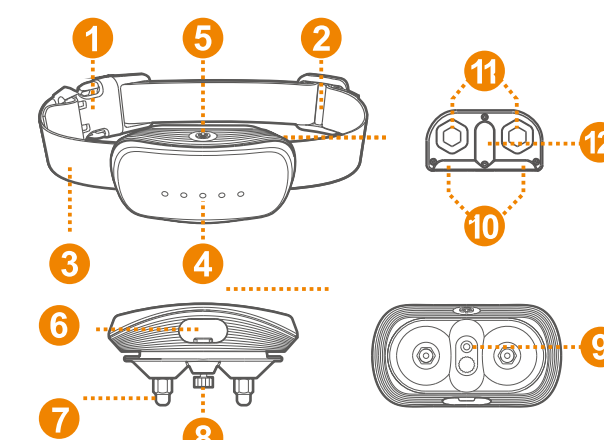

- Buckle
- Slider Buckle
- Adjustable Strap
- LED Display
- Power ON/OFF/Checking /Setting
- Rubber Plug / USB
- Charging Port
- E-Shock Probe
- Screw
- Sound Sensor
- Test Contact
- Mount
- Test Light

### Main Features Introduction

#### 1. Triggering feature



4

### 2. Training features



#### 3. Smart Training Loop

If the dog barks continuously, the collar will be triggered continuously, and the stimulation will be strengthened successively. 5 triggers form a cycle, and each trigger interval is within 30. After once cycle, the collar will force a 1-minute pause to protect the pet even if the dog is still barking.

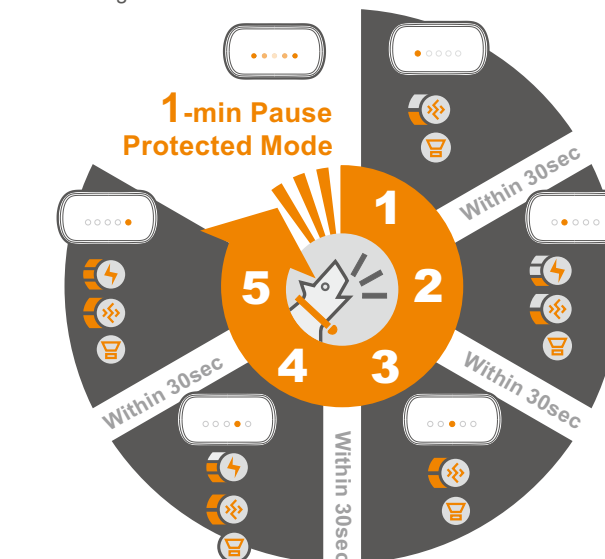

5

### Start Using Collar

#### 1. Charge the collar first

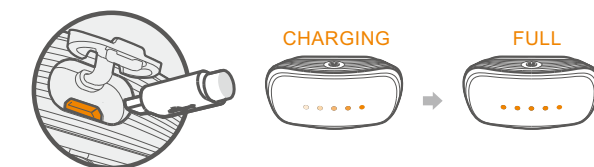

- Use the USB charging cable to charge the product.
- A dynamic flow light is displayed along with charging. All LEDs will light up when fully charged.
- It can be charged in both off-state and on-state.

#### 2. Power on Collar

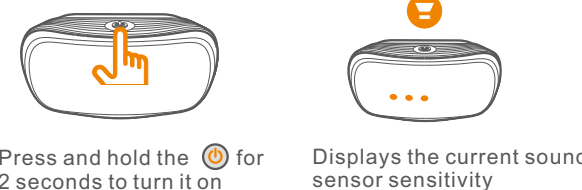

Displays the current sound sensor sensitivity

#### 3. Power off Collar

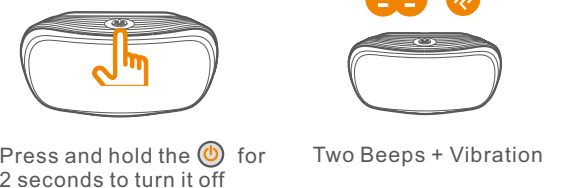

Two Beeps + Vibration

#### 4. View and Adjust Sound Sensor Sensitivity

6



In standby mode, click the [S] to display the sensitivity level.

**NOTE:** The factory default sensitivity is 5, which is the highest level. Please adjust the sensitivity level appropriately to suit specific usage scenarios.

### Test The Collar Features

#### 1. Blow into the sound sensor to trigger the product and the training loop is executed.

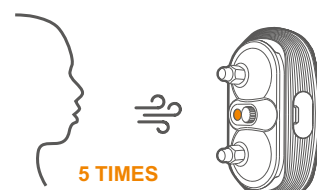

#### 2. According to the illustration on page 5, you need to blow 5 times to test whether all the features are working properly, and each interval cannot exceed 30 seconds.

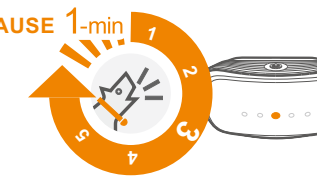

7

#### 3. The second, fourth, and fifth triggers need to use the test unit to test the E-Shock level. The higher the E-Shock level is, the brighter the light gets.

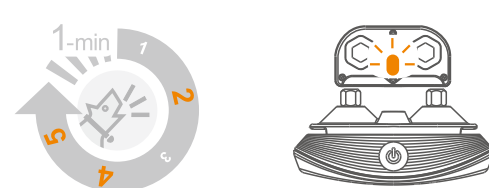

#### 4. During the pause, if you continue to blow, the Pause Dynamics indicator will illuminate.

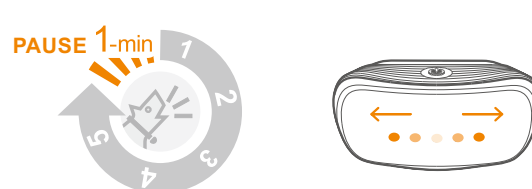

8

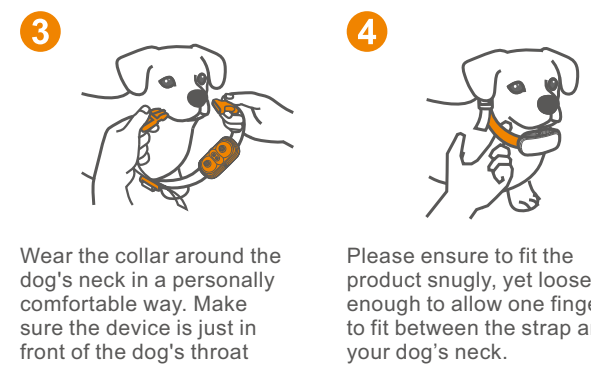

**NOTE:** Proper use of the slide buckle can prevent the collar from becoming loose around your pet's neck.

### Battery & Charging

When the power is sufficient, the middle led light flashes every 5 seconds, and it is in standby state.

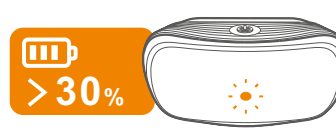

If the power is less than 30%, the LED lights at both ends flash every 5 seconds, indicating that charging is required.

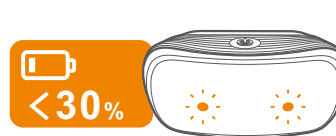

9

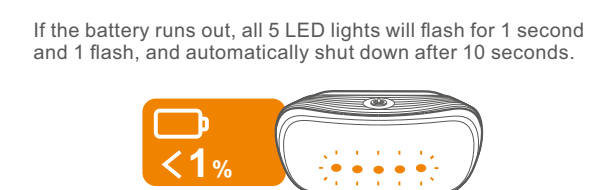

- Use the USB charging cable to charge the product.
- A dynamic flow light is displayed along with charging. All 5 LEDs will light up when fully charged.
- It can be charged in both off-state and on-state.

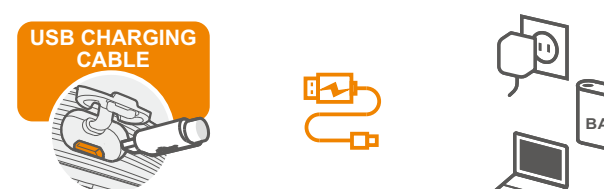

### How to "Turn-off" The E-Shock Function

The function of the E-Shock can be "turned off" by using an insulating silicone sleeve.

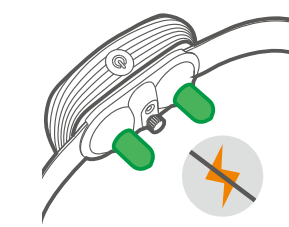

10

### Replace Strap

1. Distinguish the outer and inner surface of the strap, loosen the strap fixing screw, and insert the strap into the strap slot.

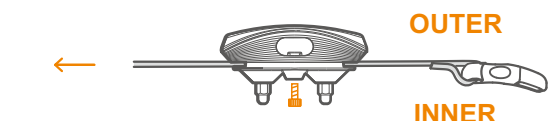

2. Install buckle and slider buckle on the strap.

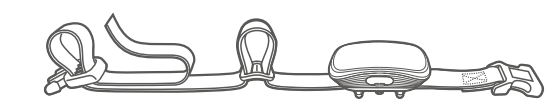

3. The receiver can be fixed on the webbing by tightening the screws with finger.

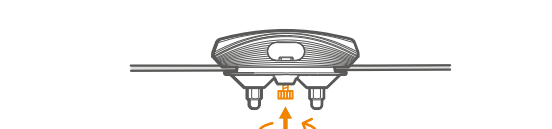

### Replace Probe

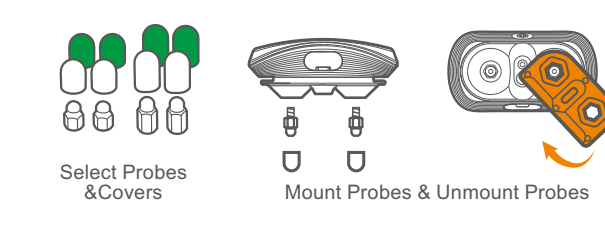

11

### How to Protect The Skin of Neck

#### About "Collar Sores"

The milliamps generated from the receiver of training collars simply cannot generate enough heat necessary to do tissue damage. The real problem comes from inappropriate wear of the collar receiver to skin.

Pressure necrosis, or what many in the industry call "collar sores", can happen if the receiver is not being worn properly. They also occur if the collar is kept on the dog for too long of a period of time.

There are two reasons:

- Improper fit
- Improper wear time

Please pay attention to your dog's neck when you begin using a training collar. A few times throughout the day take a peek and see how the skin looks. Make sure the fit is correct and notice if there is the beginning signs of redness. If so, move the receiver to the opposite side of the neck or take the collar off for a bit to increase airflow and circulation to the skin.

### CAUTION

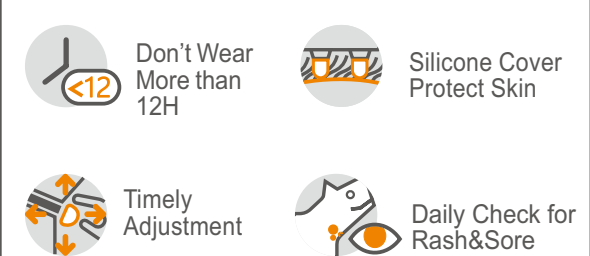

12

### LED Indication Meaning Table

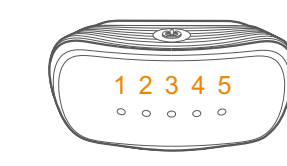

STATUS	LED FLASHING MODE AND MEANING
Off State	All lights off.
Standby Mode	The middle LED flashes once every 5 seconds.
Sensitivity Indicator	From left to right, 5 light positions correspond to 5 levels.
Execution Order of Training Loop	During the execution of the training loop, the LED position corresponds to the number of executions, so only one LED is on during the whole process.
The Pause of Training Loop	During the pause, nothing is displayed. If there is a trigger, the divergent lighting prompts to pause status.
Charging	When the charging cable is plugged in, the 5 lights start to flow dynamically from left to right.
Fully Charged	All 5 lights are on.
Low Battery	The LEDs at both ends flash once every 5 seconds.
Out Of The Battery	5 lights are all on and flash slowly, and the product shut down after flashing for 10 seconds.

### FAQ

- Q:** Is the bark control collar safe and humane?  
**A:** All training methods will not cause any direct harm to the pet's body, but make them feel extremely uncomfortable. But even so, do not overuse this product on pets. Please refer to all **WARNING** and **CAUTION** contents in the manual.

13

- Q:** Why does the collar not work when the dog barks?  
**A:** There may be three reasons for this problem. The first is that the trigger sensitivity is not high enough, so try to increase the trigger sensitivity. Second, the probe does not touch the skin, so try to adjust the belt tightness to ensure good skin contact. Third, use the test board to test the E-Shock function again.
- Q:** Other dog barking sounds or other ambient noise can trigger the collar.  
**A:** It is possible, but the probability is lower. We optimized the dog barking waveform recognition technology to enhance the ability to resist false triggers. If a false trigger occurs, please adjust the sensitivity setting appropriately.

### Troubleshooting

If the product is abnormal during use, you can do the following:

- Check Collar Wearing** Make sure the collar is tight enough and the device is in the correct position.
- Increase Sensitivity** Adjust the sensitivity setting to suit the usage scenario.
- Test Product** Check if the product is working properly and do the necessary tests.
- Contact Dealer** For more questions, please contact your local or online dealer.

14

### Terms of Use & Limitation of Liability

- Terms of Use** Your use of this product means that you accept all terms, conditions and statements in this manual.
- Correct Use** This product is designed for pets that need training. Proper use includes reviewing the entire User Manual included with the product and any specific "Caution" statements.
- Prohibition of illegal or Prohibited Use** This product is only suitable for pets. This training device is not intended to harm or provoke pets. Using this product not in accordance with the instruction manual may violate local laws.
- Scope of Responsibility** The manufacturer is not responsible for any related damages, direct, indirect, punitive, non-major, and other indirect losses caused by incorrect use or abuse of this product. The buyer bears all risks and responsibilities of using this product.
- Modification of Terms and Conditions** The manufacturer reserves the right to change the terms, conditions and notices related to this product.

### Certification Statements

**FC**  
This device complies with Part 15 of the FCC Rules. Operation is subject to the following two conditions:  
(1) This device must not cause harmful interference, and  
(2) This device must accept any interference received, including interference that may cause undesired operation.

15

**Warning:** Changes or modifications not expressly approved by the party responsible for compliance could void the user's authority to operate the equipment.

**Note:** This equipment has been tested and found to comply with the limits for a Class B digital device, pursuant to Part 15 of the FCC Rules. These limits are designed to provide reasonable protection against harmful interference in a residential installation. This equipment generates uses and can radiate radio frequency energy and, if not installed and used in accordance with the instructions, may cause harmful interference to radio communications.

However, there is no guarantee that interference will not occur in a particular installation. If this equipment does cause harmful interference to radio or television reception, which can be determined by turning the equipment off and on, the user is encouraged to try to correct the interference by one or more of the following measures:

- Reorient or relocate the receiving antenna.
- Increase the separation between the equipment and receiver.
- Connect the equipment into an outlet on a circuit different from that to which the receiver is connected.
- Consult the dealer or an experienced radio/TV technician for help.



The company declares under its own responsibility that this product complies with the basic requirements of CE (2014/30/EU) and RoHS (2011/65/EU). Without the approval of our company or the distributor, unauthorized changes or modifications to the equipment may violate the CE regulations, may cause the user to lose the right to operate the equipment, and invalidate the warranty.

16

### Specifications

Product name :	Smart Bark Training Collar
Product model :	TC-005
Operating voltage :	3.7V
Battery capacity :	300mAh
Rated input :	DC 5V / 1A
Waterproof rating :	IP67
Operating temperature :	-10°C~+50°C
Storage temperature :	-20°C~+60°C
Device volume :	72mm*37mm*38mm
Net weight :	86g

Designed and Manufactured in China Version:1.0

17