

WEBSTER QUEEN Bed

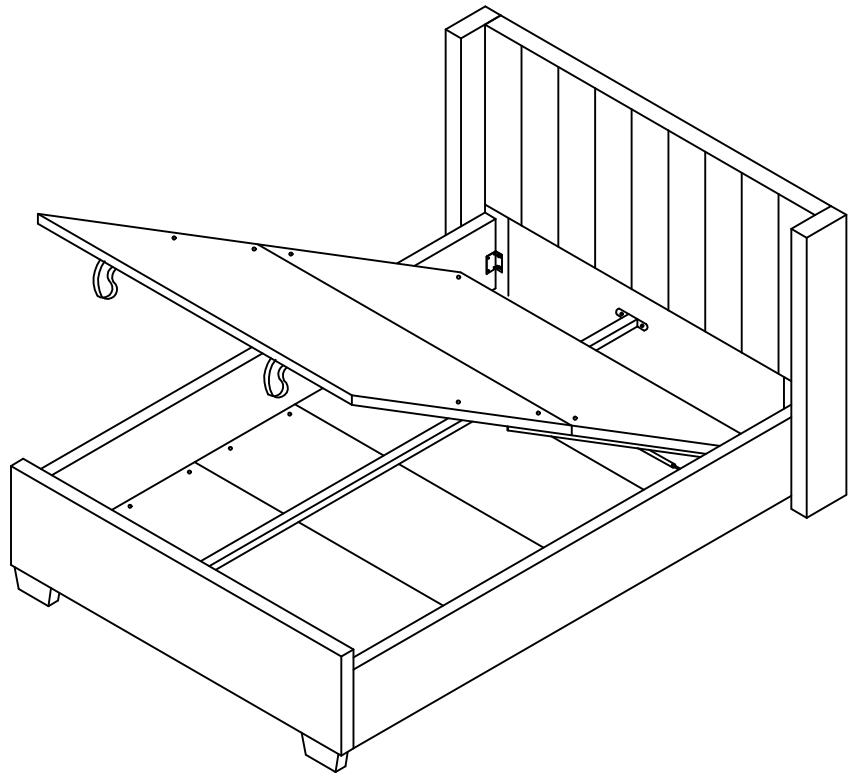

- Please do not throw away any of the packaging or instructions until you have checked all the components and hardware and have successfully completed the assembly.
- Before starting the assembly, please spend a short time looking through this leaflet.
- We suggest building your item on a soft surface such as a rug or carpet, or even the packaging this item arrived in. This will help protect the product and your floor!
- Please only use the appropriate tools needed for each task as indicated or mentioned.
- Ensure you have 2 people if your product is heavy or large, or awkward for you.
- Assemble all components loosely until the final stages.
- Keep the assembly tools with the instructions. Depending on use, it will be necessary to perform maintenance or upkeep on your product.
- Please keep small pieces out of reach of small children.
- If you encounter any issues or concerns before, during or after assembly, be they large, small or strange, please let us know at customercare@b2cfurniture.com.au. We have a dedicated support team with solutions and remedies ready to put them into action for you.
- Final step, enjoy your furniture!

WEBSTER QUEEN Bed

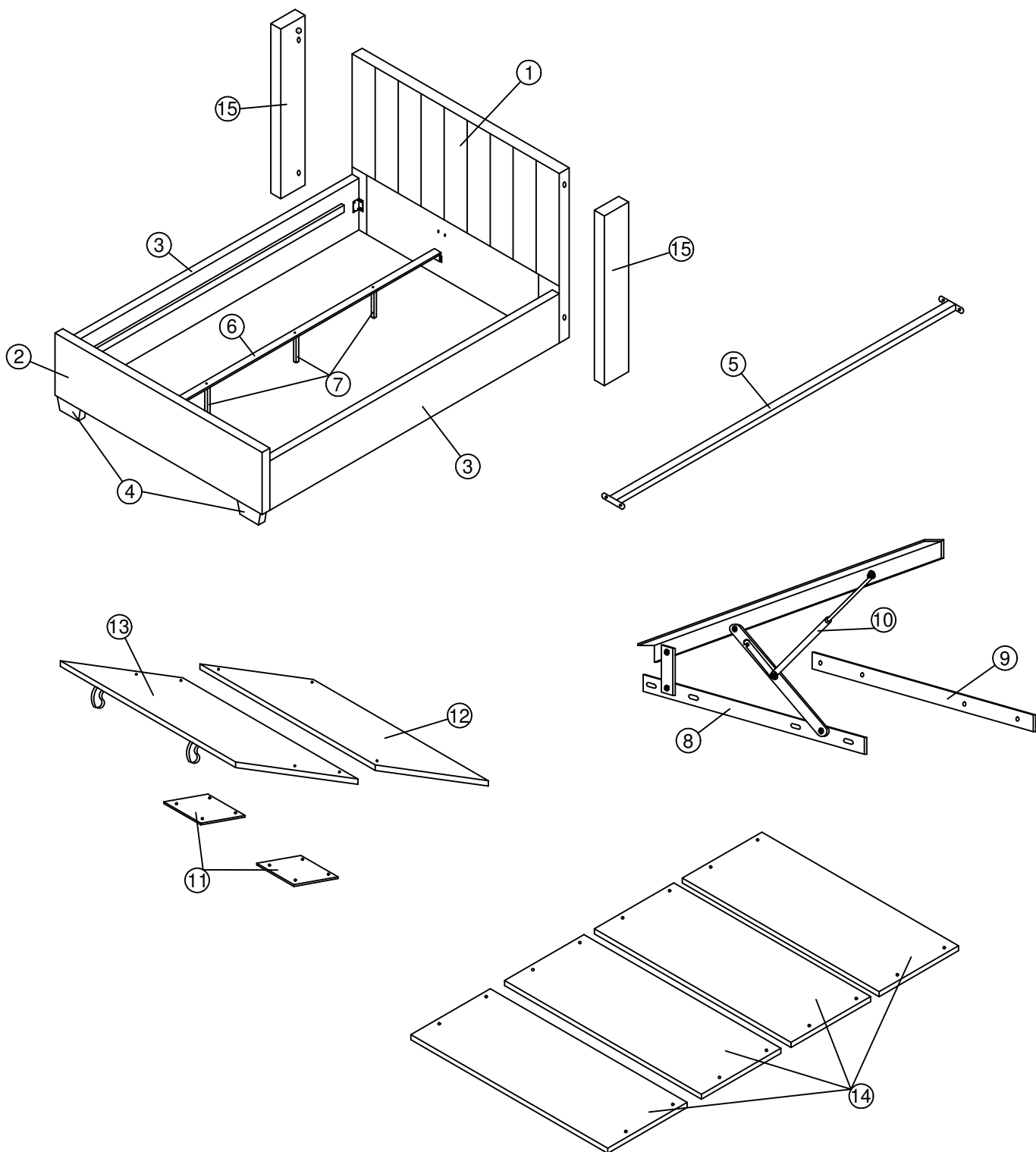

① Headboard (1)	② Footboard (1)	③ Side Rail L/R (2)	④ Leg (2)	⑤ Metal Center Rail (1)
⑥ Wooden Center Rail (1)	⑦ Support Leg (3)	⑧ Pump Mounting Bracket (2)	⑨ Bracket Base (2)	⑩ Gas Spring (2)
⑪ Wooden Frame Bracket (2)	⑫ Wooden Frame (1) (Hole are Different)	⑬ Wooden Frame (1) (Hole are Different)	⑭ Bottom Panel (4)	⑮ Side Wing (2)

 M6 x 30mm A (4)	 M6 x 40mm B (11)	 M6 x 50mm C (6)
 M8 x 60mm D (8)	 M6 Spring Washer E (16)	 M6 Flat Washer F (16)
 M8 Spring Washer G (16)	 M8 Flat Washer H (16)	 M8 Hex Nut I (8)
 CSK M4 x 25mm J (24)	 M4 K (1)	 M5 L (1)
 M8 Spanner M (1)	 Small Adjuster N (3)	 M8 x 20mm O (8)

● M6
● M8



1.

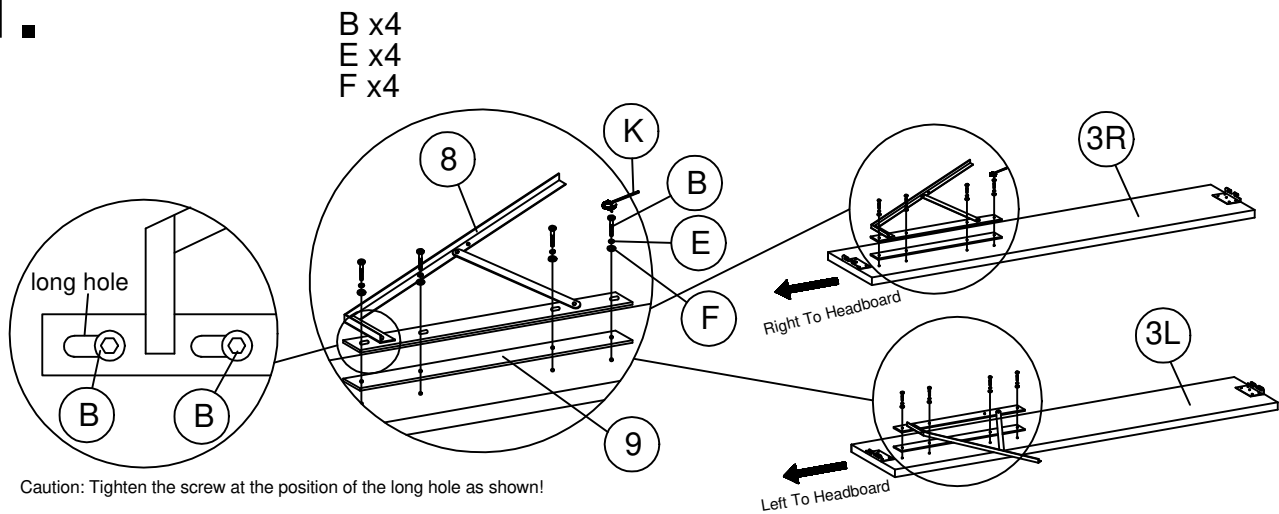

Attach the pump mounting bracket (8) and bracket base (9) to the both side rail (3) using hardware parts B , E , F and K.

2.

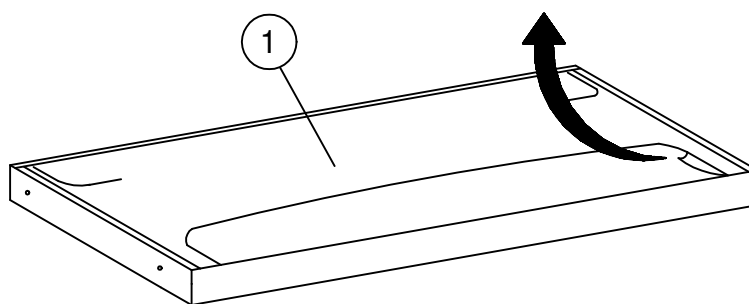

BACK VIEW

Attention: Zip the black non-woven fabric after take out the parts !!

Unzip the black non-woven fabric on the back of headboard and take out side wing (15) out.

3.

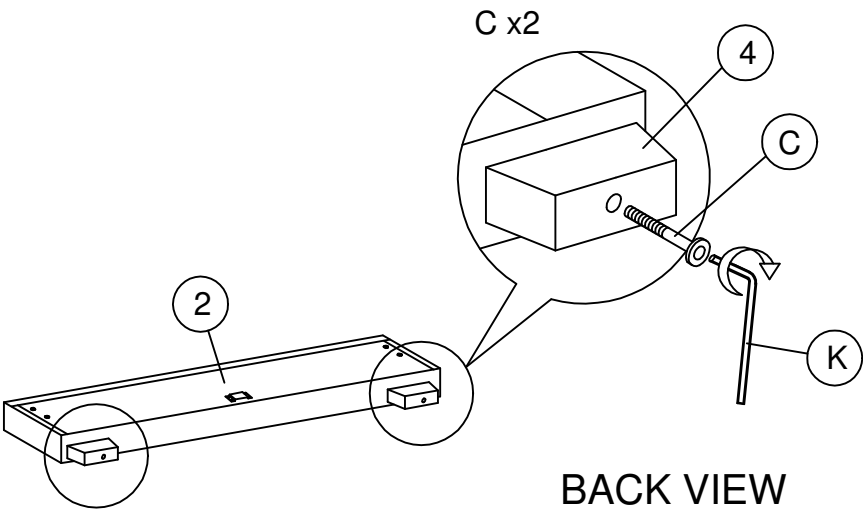

Attach the legs (4) to the footboard (2) as shown.

4.

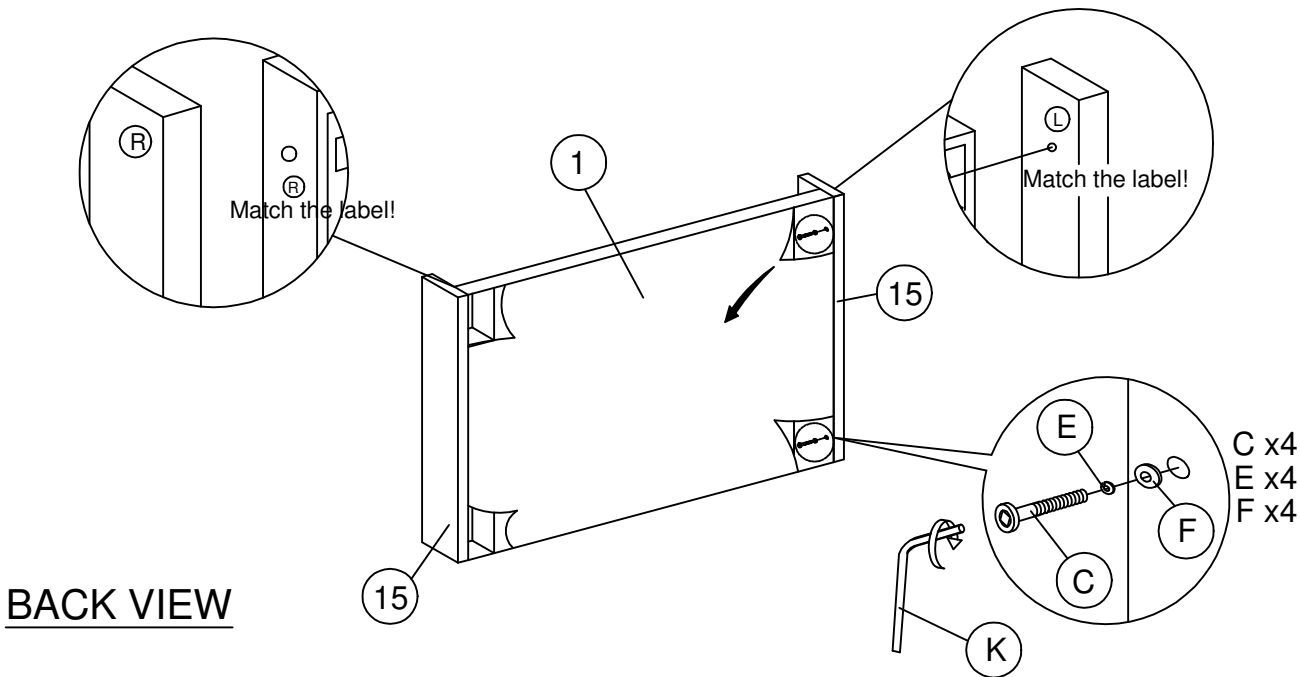

Attach the side wing (15) to the headboard (1).

5.

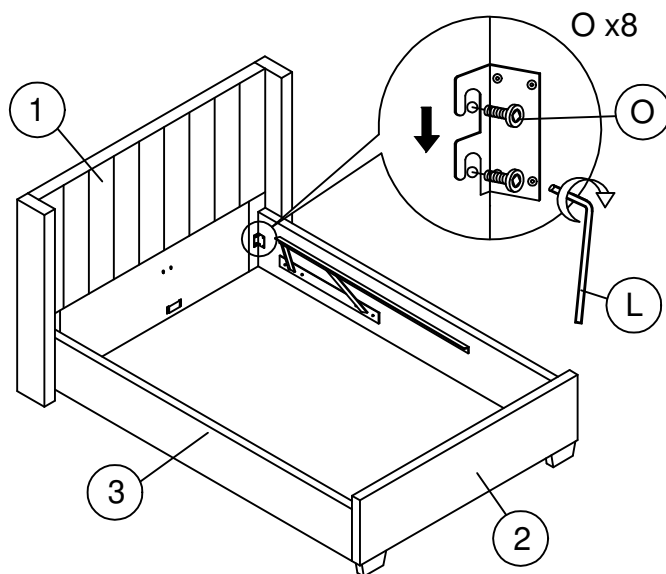

Attach the side rails (3) by pushing the brackets down into place and secure the bolts using hardware part L as shown.

6.

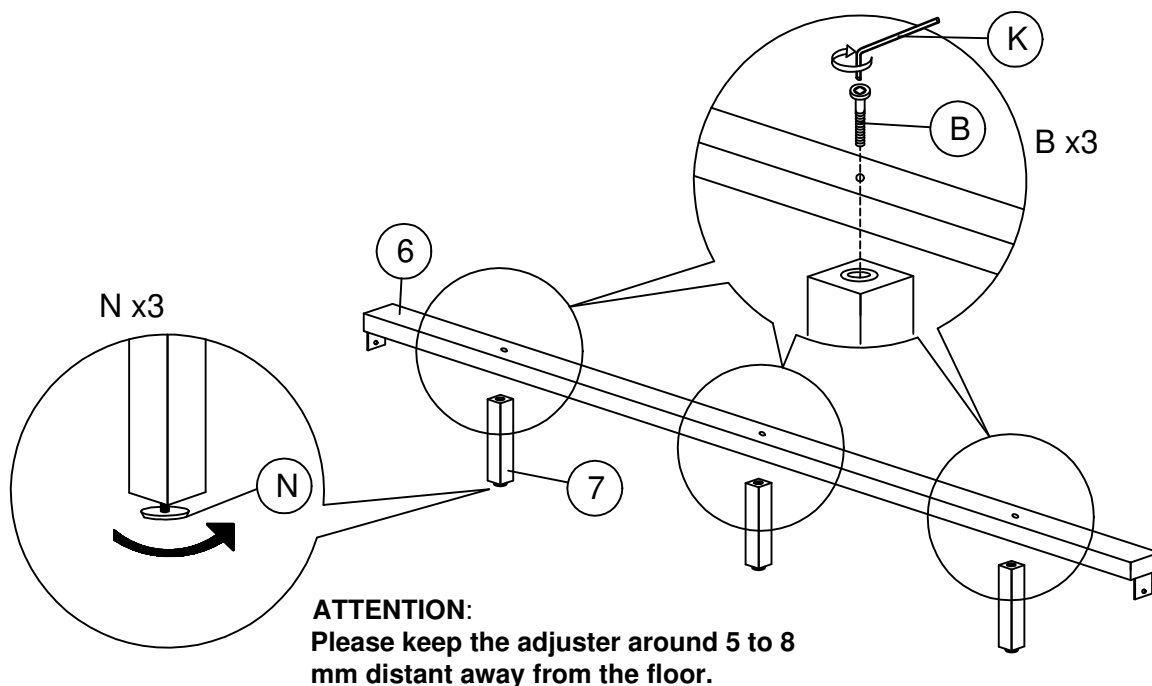

Attach the support legs (7) to the centre rail (6) using hardware parts B and K.

7.

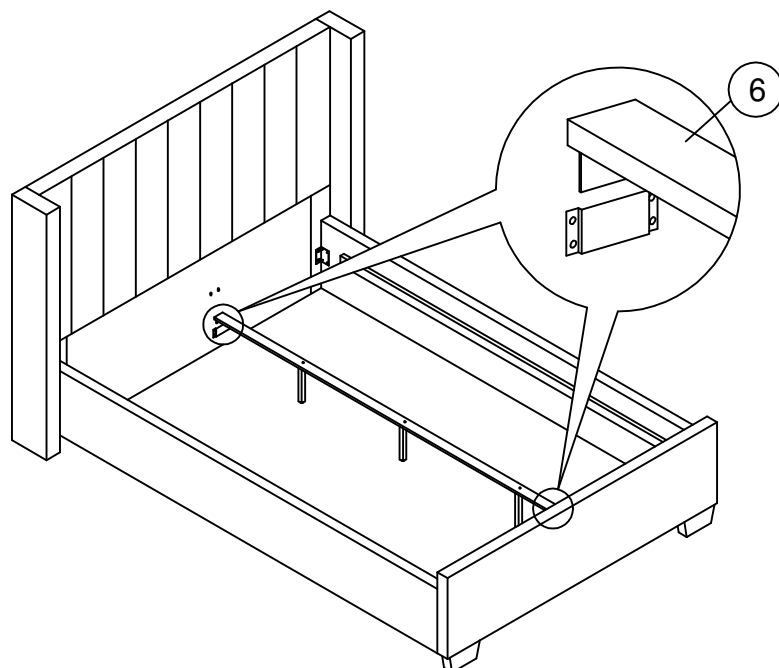

Insert the centre rail (6) to the headboard (1) and footboard (2).

8.

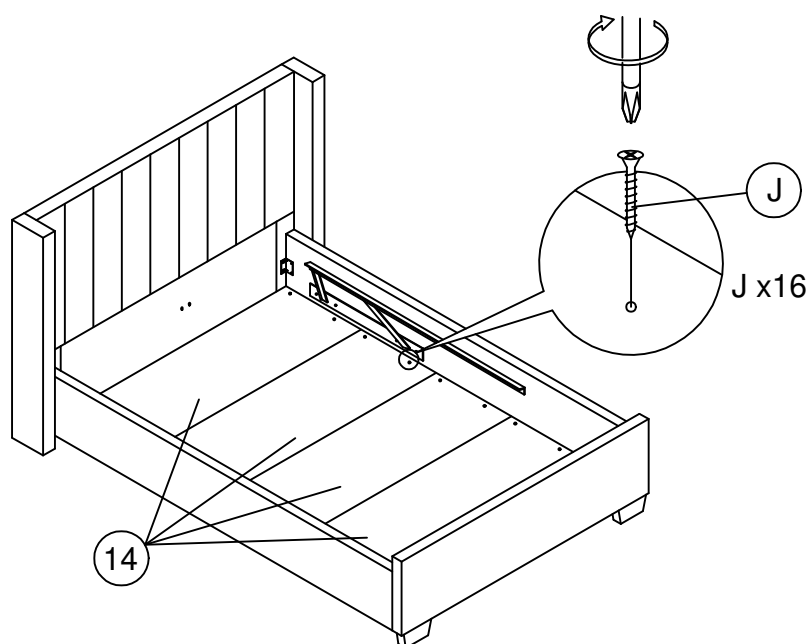

Insert the bottom panel (14) to the below frame and secure using hardware part J and a screwdriver (not provided).

9.

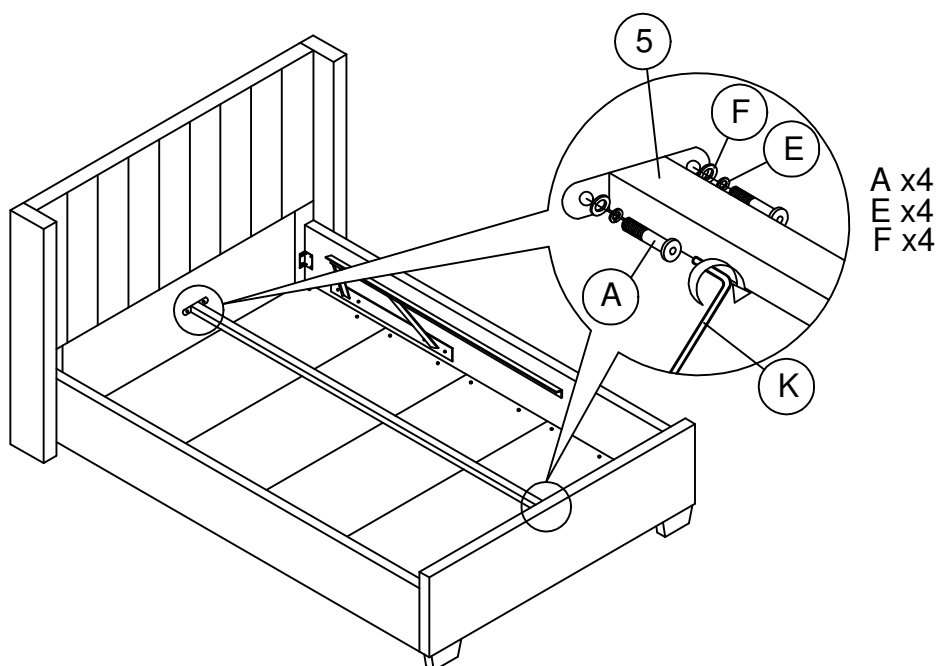

Insert the centre rail (5) to the headend (1) and footend (2) and secure using hardware part A and K.

10.

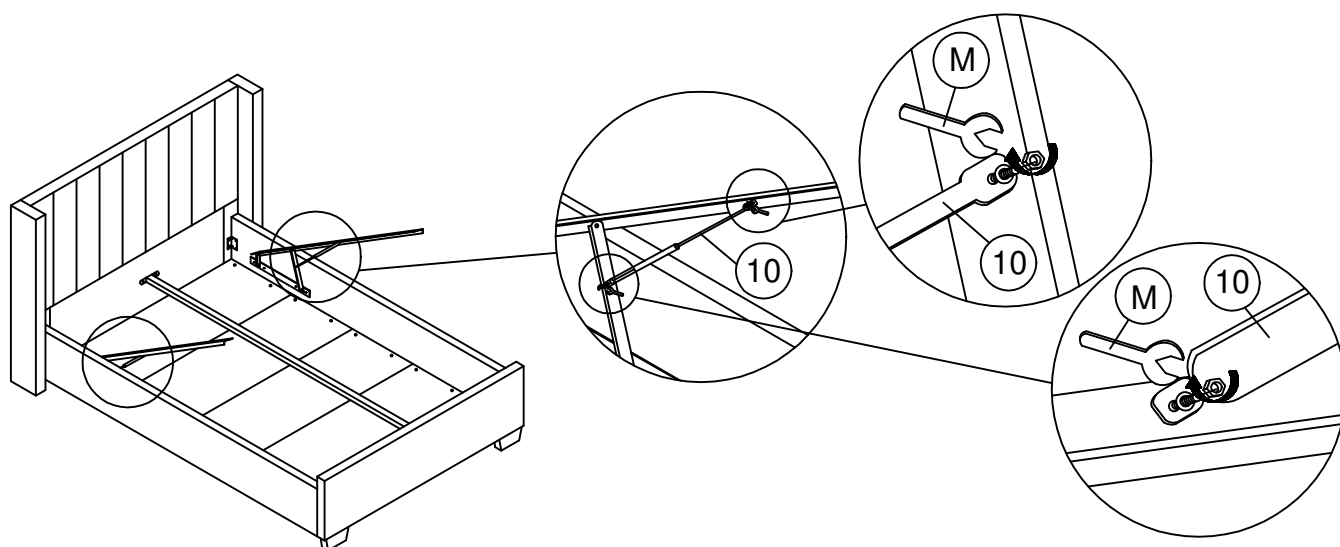

Unscrew the Pre-attached hex-nut of gas spring (10) and attach it back again as shown. Please fully tighten the nut.

11.

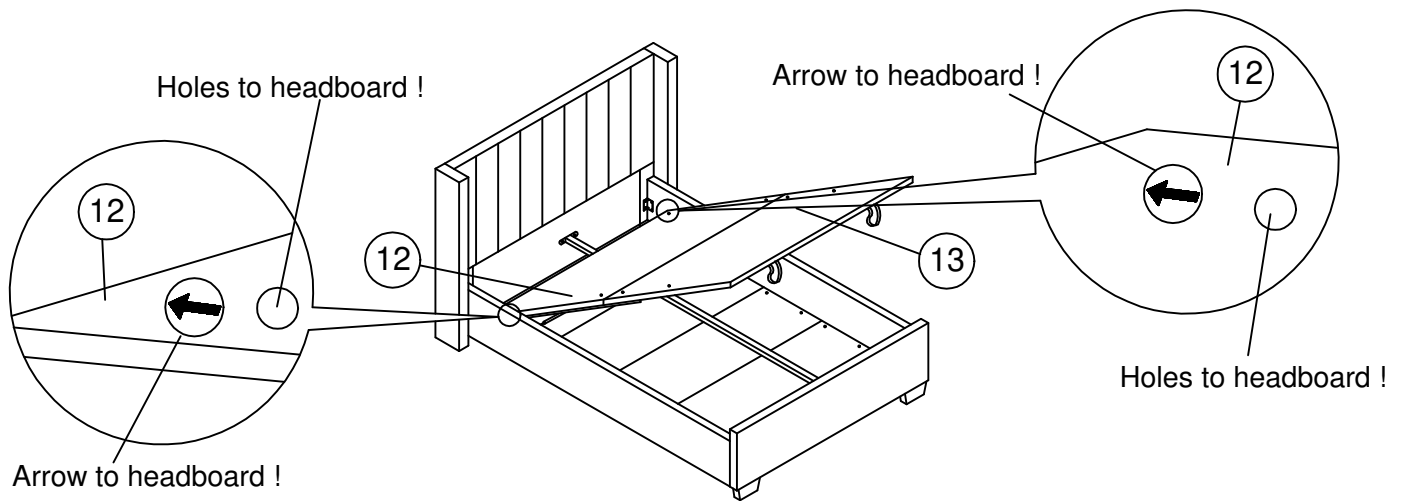

Must place the wooden frame (12 & 13) in correct position (please follow the position as shown in diagram).

12.

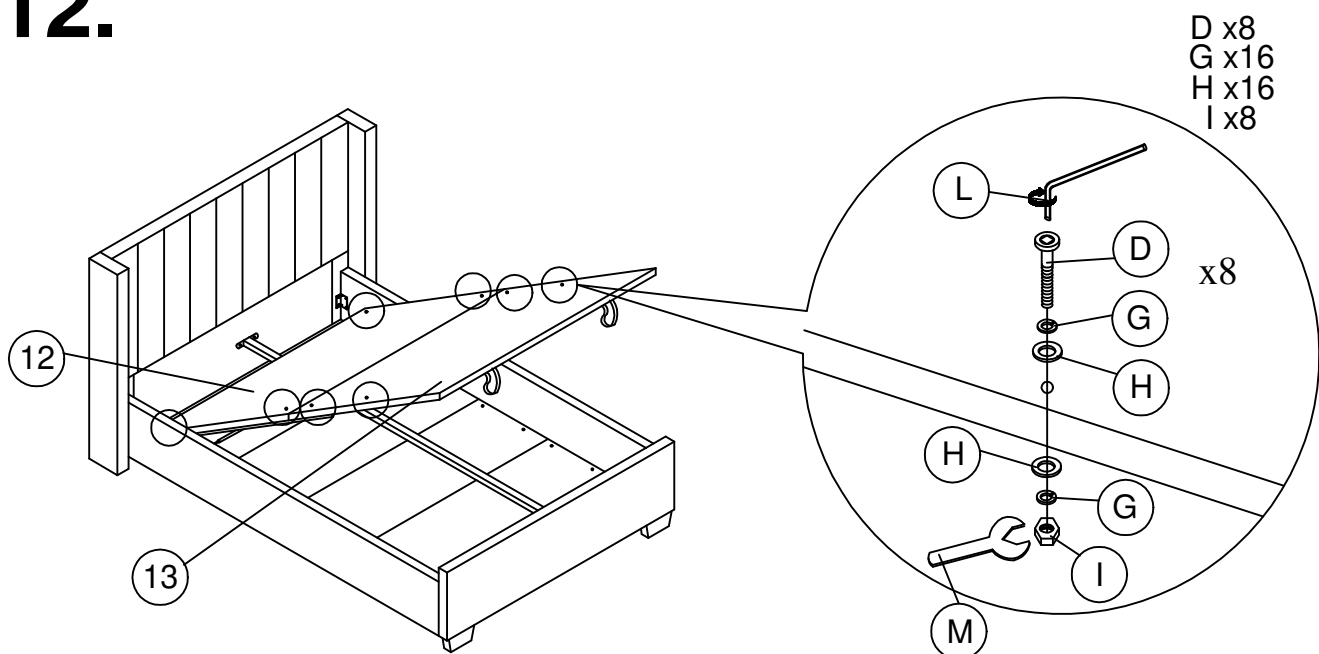

Assembly the wooden frame (12) and wooden frame (13) to the bracket and tighten all the fitting accordingly.

13.

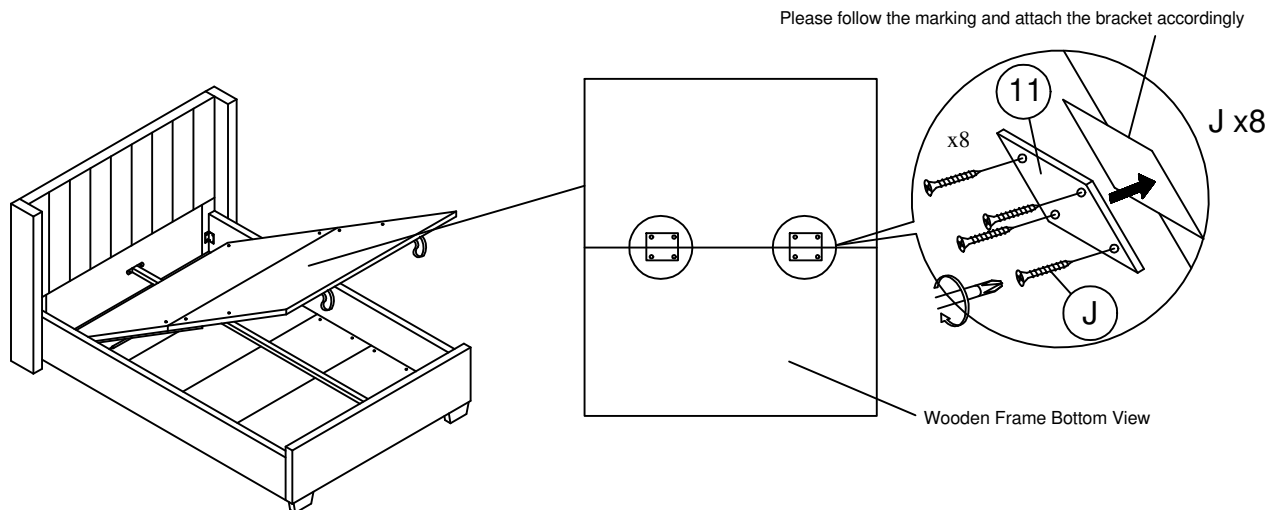

Attach the wooden frame bracket (11) to the wooden frame using hardware parts J and a screwdriver (not provided).

14.

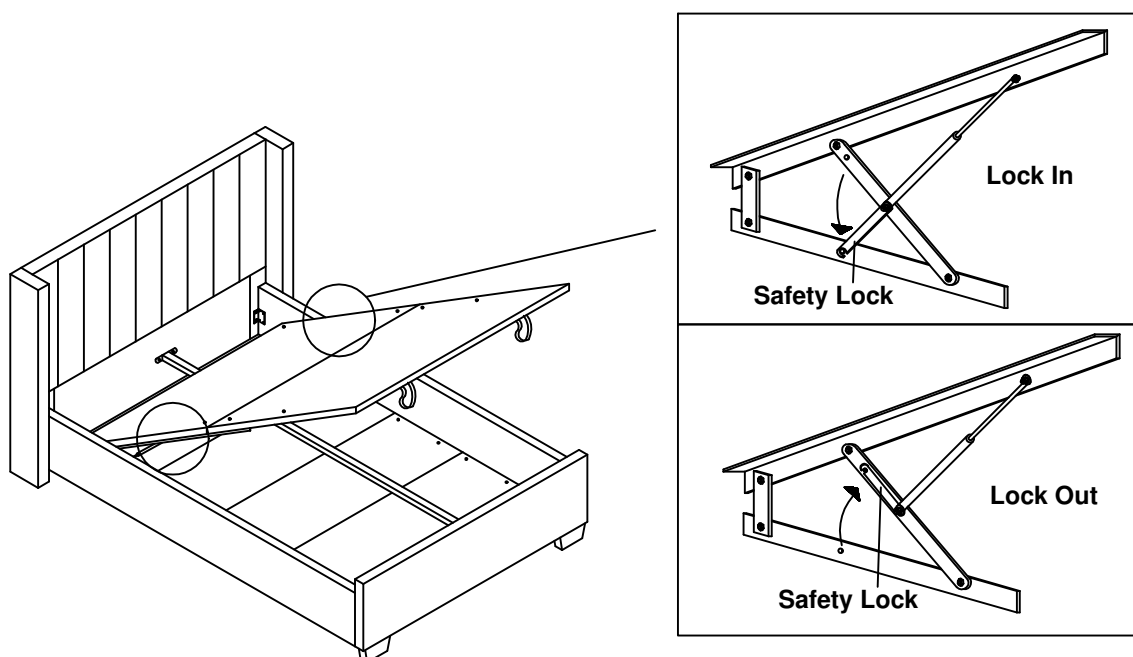

Please use the safety lock for safety purpose.